



PRECINCT SUMMARY STATEMENT

(IEC-8)

State Form 13332 (R7/7-06)

Indiana Election Commission (IC 3-11-1.5-15)

Name of County LAKE

INSTRUCTIONS: See Indiana Code 3-11-1.5-25 for periods during which precinct boundary changes may NOT take effect.

Indiana Code 3-11-1.5-15 requires that a county include the following items in a proposed precinct establishment order submitted to the Indiana Election Division:

1. A map of each precinct to be established by the proposed order. A county may submit these maps in electronic form.
2. A description of the boundaries of each precinct to be established by the proposed order that identifies any census blocks located entirely within the precinct.
3. An estimated number of voters in each precinct to be established by the proposed order, based on the registration records maintained by the county voter registration office.
4. A statement designating a polling place for the precinct that complies with the polling place accessibility requirements.
5. Any additional information required by rules adopted by the Indiana Election Commission under IC 4-22-2.

General Precinct Information

1. Name Of Proposed Precinct <u>SCH - 9</u>	2. Is this a new precinct? <input checked="" type="checkbox"/> Yes <input type="checkbox"/> No	3. Election Division & STFID Number (To Be Completed By Election Division)
4. District Information Congressional <u>1</u> Indiana Senate <u>6</u> Indiana House <u>15</u>		
5. Number Of Active Voters (IC 3-5-2-1.7) <u>1090</u>	6. Number Of Inactive Voters <u>191</u>	7. Number Of Registered Voters (Must Equal Total Of Active And Inactive Voters) <u>1281</u>
8. Total Number Of Precincts In The County If Submission Is Approved Voting Precincts _____ Non-Voting Precincts _____		
9. Date Of County Executive's Adopted Order		10. Date Of First Election After Precincts Are Approved MAY 8, 2018
11. Precincts Affected By This Proposed Order (Complete a Precinct Summary Statement for each precinct. Please note that when changing boundaries of one precinct you will need to complete a separate IEC-8 for any other precinct affected by the change.) <u>SCH-9 + SCH 5</u>		
12. List Any Attached Documents (i.e. map 6 of 20 maps, etc.)		

CENSUS BLOCK LISTING AND MAPS

Does any portion of the newly established precinct split or divide any of the following?	Yes	No
13. School Corporation District Boundary		X
14. City or Town Boundary		X
15. City or Town Council District Boundary		X
16. Census Block Boundary		X
17. Other (Please Describe)		X

Method of Voting

18. <input type="checkbox"/> Optical Scan Ballot Card <input type="checkbox"/> Electronic <input checked="" type="checkbox"/> Combination (Please Specify): _____
19. What is the designated location and address for the polling place for this precinct? <u>SCHERERVILLE TOWN HALL</u> <u>10 E. JOLIET ST</u> <u>SCHERERVILLE, IN 46375</u> (NOTE: This designation of a polling place remains in effect until later action by the county executive under state law.)
20. Does this polling place meet Indiana's polling place accessibility requirements? <input checked="" type="checkbox"/> Yes <input type="checkbox"/> No

Precinct Change Reason

21. Briefly state the reason for the precinct change. (Attach additional sheet if necessary.) <u>SENATE BILL 220</u> <u>COMBINING SCH-9 + SCH-5</u>
--

Additional Information

22. Name and Contact Information Of County Election Staff Person Who Prepared This Form: <u>GENNY GASPAROVIC 219-755-3812</u>
23. Does the county have access to Geographic Information System (GIS)? <input checked="" type="checkbox"/> Yes <input type="checkbox"/> No Name and Contact Information Of County GIS Staff: <u>Annette Mellady 219-755-3795</u>
24. Does the county use Census Tiger files? <input type="checkbox"/> Yes <input checked="" type="checkbox"/> No
25. Type Of Geographic Files Used by County (If Known By Staff Of The Indiana Election Division Or Office Of Census Data)

SCHERERVILLE

- Railroad Centerline
- Water Lines
- Road Centerline

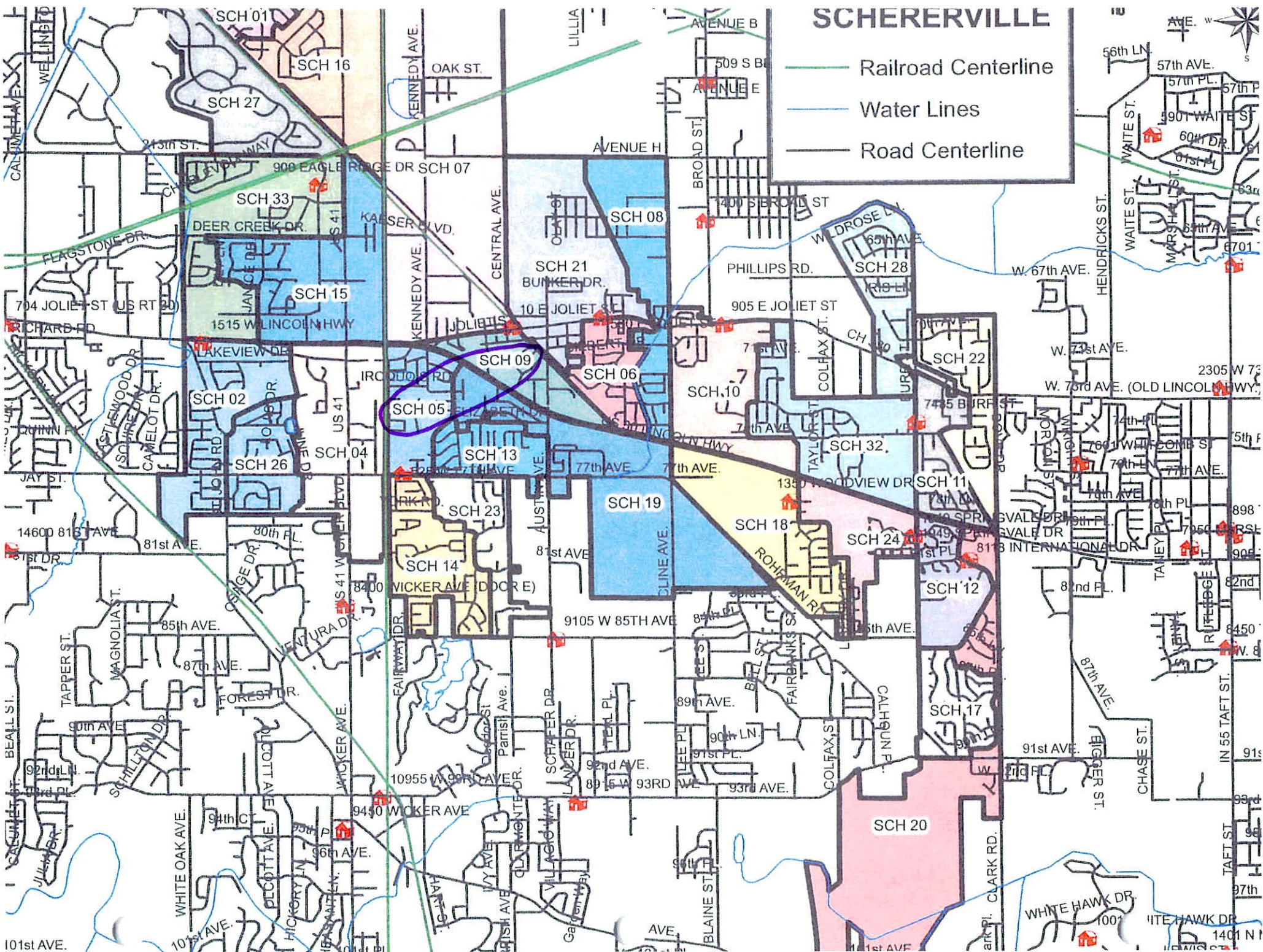

SCHERERVILLE
PRECINCT 09

180890427042050

180890427042048

180890427042045

180890427041024

180890427042037

180890427042035

180890427042036

180890427042038

180890427042041

180890427042051

180890427041027

180890427042046

180890427042049

180890427042047

SCHERERVILLE
PRECINCT 05

180890427022006

180890427023031

180890427023033

180890427023032

180890427023030

180890427023029

180890427023036

180890427023034

180890427023035

180890427023011

180890427023037

180890427023010

180890427022005

180890427022004

180890427023012

180890427022000