



PRECINCT SUMMARY STATEMENT

(IEC-8)

State Form 13332 (R7/7-06)

Indiana Election Commission (IC 3-11-1.5-15) Name of County LAKE

INSTRUCTIONS: See Indiana Code 3-11-1.5-25 for periods during which precinct boundary changes may NOT take effect.
 Indiana Code 3-11-1.5-15 requires that a county include the following items in a proposed precinct establishment order submitted to the Indiana Election Division:

1. A map of each precinct to be established by the proposed order. A county may submit these maps in electronic form.
2. A description of the boundaries of each precinct to be established by the proposed order that identifies any census blocks located entirely within the precinct.
3. An estimated number of voters in each precinct to be established by the proposed order, based on the registration records maintained by the county voter registration office.
4. A statement designating a polling place for the precinct that complies with the polling place accessibility requirements.
5. Any additional information required by rules adopted by the Indiana Election Commission under IC 4-22-2.

General Precinct Information

1. Name Of Proposed Precinct G3-16 2. Is this a new precinct? Yes No 3. Election Division & STFID Number (To Be Completed By Election Division)

4. District Information
 Congressional 1 Indiana Senate 3 Indiana House 2

5. Number Of Active Voters (IC 3-5-2-1.7) 1,061 6. Number Of Inactive Voters 83 7. Number Of Registered Voters (Must Equal Total Of Active And Inactive Voters) 1,144

8. Total Number Of Precincts In The County If Submission Is Approved
 _____ Voting Precincts _____ Non-Voting Precincts

9. Date Of County Executive's Adopted Order _____ 10. Date Of First Election After Precincts Are Approved
 MAY 8, 2018

11. Precincts Affected By This Proposed Order (Complete a Precinct Summary Statement for each precinct. Please note that when changing boundaries of one precinct you will need to complete a separate IEC-8 for any other precinct affected by the change.)
G3-16 & G3-4

12. List Any Attached Documents (i.e. map 6 of 20 maps, etc.)

CENSUS BLOCK LISTING AND MAPS

Does any portion of the newly established precinct split or divide any of the following?	Yes	No
13. School Corporation District Boundary		X
14. City or Town Boundary		X
15. City or Town Council District Boundary		X
16. Census Block Boundary		X
17. Other (Please Describe)		X

Method of Voting

18. Optical Scan Ballot Card Electronic Combination (Please Specify): _____

19. What is the designated location and address for the polling place for this precinct?
TOLLESTON PARK PAVILION
1709 EILSWORTH PL
GARY IN
 (NOTE: This designation of a polling place remains in effect until later action by the county executive under state law.)

20. Does this polling place meet Indiana's polling place accessibility requirements? Yes No

Precinct Change Reason

21. Briefly state the reason for the precinct change. (Attach additional sheet if necessary.)
SENATE BILL 220 - Combine G3-16 & G3-4

Additional Information

22. Name and Contact Information Of County Election Staff Person Who Prepared This Form:
GENNY GASPAROVIC 219-755-3812

23. Does the county have access to Geographic Information System (GIS)? Yes No
 Name and Contact Information Of County GIS Staff: Annette Mellady 219-755-3795



24. Does the county use Census Tiger files? Yes No

State Office Use Only

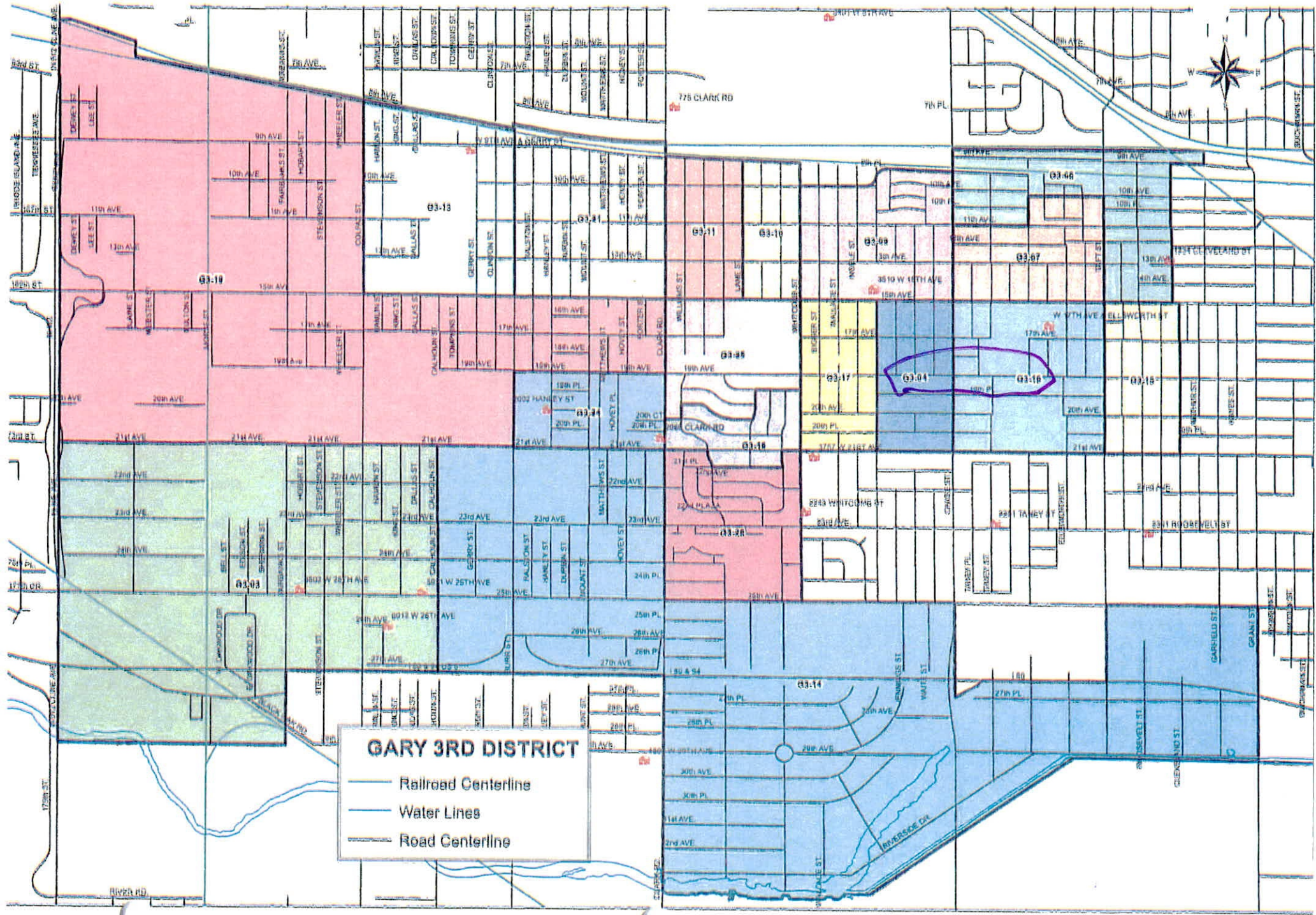
25. Type Of Geographic Files Used by County (If Known By Staff Of The Indiana Election Division Or Office Of Census Data)



GARY 3RD DISTRICT

-  Railroad Centerline
-  Water Lines
-  Road Centerline

GARY PRECINCT

3-04

180890111002004
180890111002017
180890111002019
180890111002000
180890111002020
180890111002022
180890111003001
180890111002045
180890111002035
180890111002033
180890111003000
180890111002036
180890111002034
180890111002023
180890111002021
180890111002001
180890111002018
180890111002003
180890111002005
180890111002037
180890111002007
180890111003002
180890111002002
180890111002006

GARY PRECINCT

3-16

180890112005061
180890112005026
180890112005060
180890112004001
180890112005068
180890112004008
180890112005064
180890112004003
180890112005027

180890112005041
180890112005045
180890112005024
180890112005050
180890112002035
180890112005065
180890112004000
180890112002040
180890112004004
180890112004005
180890112005031
180890112005028
180890112005069
180890112005055
180890112005046
180890112005047
180890112005030
180890112005048
180890112004002
180890112002037
180890112002033
180890112005071
180890112005044
180890112005070
180890112005062
180890112005025
180890112004006
180890112002034
180890112002036
180890112005029
180890112004009
180890112005042
180890112005049
180890112004007
180890112005056
180890112005066

GARY PRECINCT
3-16

180890112005057

180890112005023

180890112005043

180890112005063

180890112005051

180890112005067

180890112004010

2