



PRECINCT SUMMARY STATEMENT

(IEC-8)

State Form 13332 (R7/7-06)

Indiana Election Commission (IC 3-11-1.5-15) Name of County LAKE

INSTRUCTIONS: See Indiana Code 3-11-1.5-25 for periods during which precinct boundary changes may NOT take effect.
 Indiana Code 3-11-1.5-15 requires that a county include the following items in a proposed precinct establishment order submitted to the Indiana Election Division:

1. A map of each precinct to be established by the proposed order. A county may submit these maps in electronic form.
2. A description of the boundaries of each precinct to be established by the proposed order that identifies any census blocks located entirely within the precinct.
3. An estimated number of voters in each precinct to be established by the proposed order, based on the registration records maintained by the county voter registration office.
4. A statement designating a polling place for the precinct that complies with the polling place accessibility requirements.
5. Any additional information required by rules adopted by the Indiana Election Commission under IC 4-22-2.

General Precinct Information

1. Name Of Proposed Precinct <u>G 3-15</u>		2. Is this a new precinct? <input checked="" type="checkbox"/> Yes <input type="checkbox"/> No		3. Election Division & STFID Number (To Be Completed By Election Division)	
4. District Information Congressional <u>1</u> Indiana Senate <u>3</u> Indiana House <u>2</u>					
5. Number Of Active Voters (IC 3-5-2-1.7) <u>1,247</u>		6. Number Of Inactive Voters <u>299</u>		7. Number Of Registered Voters (Must Equal Total Of Active And Inactive Voters) <u>1,546</u>	
8. Total Number Of Precincts In The County If Submission Is Approved Voting Precincts _____ Non-Voting Precincts _____					
9. Date Of County Executive's Adopted Order			10. Date Of First Election After Precincts Are Approved MAY 8, 2018		

11. Precincts Affected By This Proposed Order (Complete a Precinct Summary Statement for each precinct. Please note that when changing boundaries of one precinct you will need to complete a separate IEC-8 for any other precinct affected by the change.)

G3-15, G3-6 & G3-7

12. List Any Attached Documents (i.e. map 6 of 20 maps, etc.)

CENSUS BLOCK LISTING AND MAPS

Does any portion of the newly established precinct split or divide any of the following?	Yes	No
13. School Corporation District Boundary		X
14. City or Town Boundary		X
15. City or Town Council District Boundary		X
16. Census Block Boundary		X
17. Other (Please Describe)		X

Method of Voting

18. Optical Scan Ballot Card Electronic Combination (Please Specify): _____

19. What is the designated location and address for the polling place for this precinct?

BEVERIDGE SCHOOL
1234 CLEVELAND
GARY IN

(NOTE: This designation of a polling place remains in effect until later action by the county executive under state law.)

20. Does this polling place meet Indiana's polling place accessibility requirements? Yes No

Precinct Change Reason

21. Briefly state the reason for the precinct change. (Attach additional sheet if necessary.)

SENATE BILL 220 - Combine G3-15, G3-6 & G3-7

Additional Information

22. Name and Contact Information Of County Election Staff Person Who Prepared This Form:

GENNY GASPAROVIC 219-755-3812

23. Does the county have access to Geographic Information System (GIS)? Yes No

Name and Contact Information Of County GIS Staff: **Annette Mellady 219-755-3795**

24. Does the county use Census Tiger files? Yes No

State Office Use Only

25. Type Of Geographic Files Used by County (If Known By Staff Of The Indiana Election Division Or Office Of Census Data)

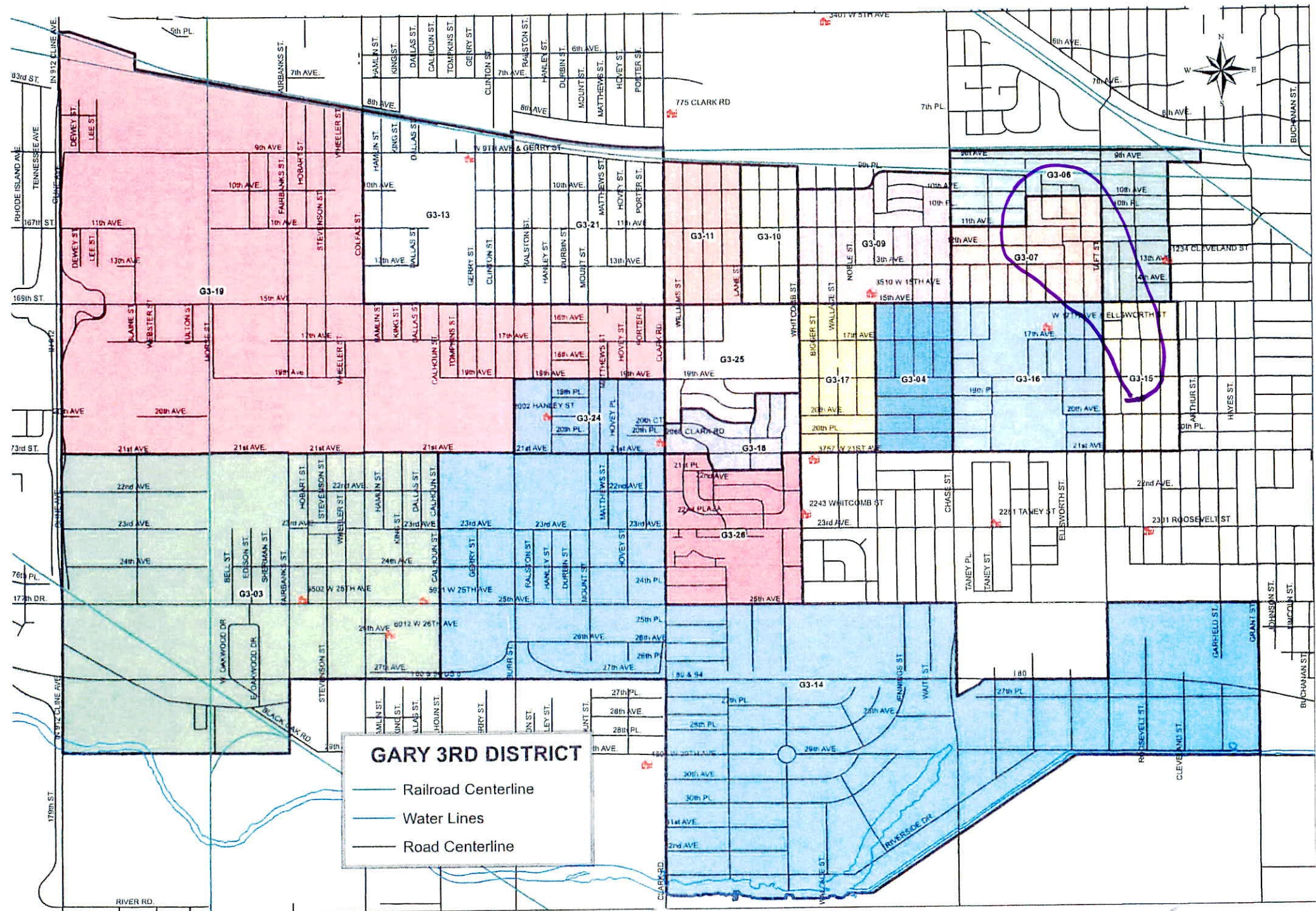

GARY 3RD DISTRICT

- Railroad Centerline
- Water Lines
- Road Centerline

GARY PRECINCT

3-06

180890109001002

180890109002006

180890109002002

180890109002003

180890109002010

180890109002004

180890109002012

180890109002037

180890109002035

180890109002023

180890109001007

180890109001006

180890109002005

180890109001024

180890109001016

180890109001001

180890109001005

180890109001008

180890109001014

180890109001017

180890109001039

180890112001009

180890109001041

180890112001005

180890112001012

180890112001006

180890112001018

180890112001007

180890112001010

180890109002013

180890109002039

180890112001011

180890109002009

180890109002011

180890109002036

180890109002038

180890109001040

180890112001008

180890112005001

180890109001022

180890109002025

180890109002016

GARY PRECINCT
3-06

2

180890109002024

180890112005000

180890109002007

180890109001037

180890109002001

180890109002008

180890109002014

180890112005033

180890109002020

180890109001038

180890109002000

180890109002015

180890109001015

180890109001025

180890109001023

GARY PRECINCT
3-07

180890109002026
180890109002067
180890109002047
180890112005017
180890109002059
180890109002062
180890109002033
180890112005012
180890112005011
180890109002018
180890109002027
180890112005009
180890112005007
180890112005005
180890109002040
180890109002029
180890109002031
180890109002042
180890112005034
180890109002034
180890109002041
180890109002043
180890112005036
180890109002044
180890112005021
180890112005006
180890109002051
180890109002056
180890112005022
180890112005035
180890109002058

180890112005010
180890109002054
180890109002046
180890109002049
180890112005016
180890109002052
180890109002063
180890109002055
180890109002053
180890112005002
180890112005003
180890109002048

GARY PRECINCT
3-07

180890109002019
180890109002021
180890112005015
180890109002057
180890109002017
180890109002060
180890112005013
180890109002028
180890112005014
180890109002030
180890109002061
180890109002022
180890112005020
180890109002045
180890109002065
180890109002064
180890109002032
180890109002050
180890109002066
180890112005018
180890112005019
180890112005008
180890112005004

2

GARY PRECINCT

3-15

180890112005037
180890112005040
180890112001033
180890112001043
180890112001041
180890112001059
180890112005053
180890112005058
180890112002032
180890112002016
180890112002012
180890112002014
180890112002018
180890112002030

180890112005052
180890112002011
180890112005059
180890112002013
180890112002031
180890112002019
180890112002015
180890112002029
180890112002009
180890112005038
180890112002017
180890112005032
180890112001036
180890112001038
180890112001044
180890112001042
180890112001034
180890112001031
180890112001032
180890112001062
180890112001035
180890112001040
180890112001045
180890112005054
180890112005039
180890112001037
180890112002010
180890112001039
180890112002007
180890112002008