

EQUAL ACCESS TODAY?

to COURSES?
to QUALITY?

ACCESS:
EQUITY..

WILL EVERY PATHWAY
be OFFERED EVERYWHERE?

DESIGN for
1 DIPLOMA?

Separate, but
connected
issues..



WHAT WILL be
AVAILABLE AT LAUNCH,
VS. FUTURE VERSIONS?

HOW to MAINTAIN LOCAL
SELF-DETERMINATION?
FLEXIBILITY?

TECHNOLOGY:
WHAT'S AVAILABLE
ONLINE?

THANK YOU!

WHAT have we made so far?
SPED..

LIFE AFTER HIGH SCHOOL

ITERATION IS PART of the MODEL!

OUTCOMES..

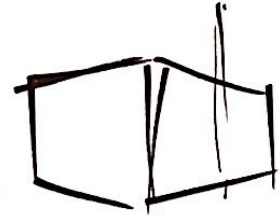

COLLEGE IS AN OPTION... NOT THE OPTION

MANY WAYS to GET THERE!



THIS HAS BROUGHT PEOPLE together!

Structure & flexibility

e.g.:
INDUSTRY CERTIFICATION

RECOGNIZING the REALITY of COMPLEX WORK SKILLS

WORK ETHIC CERTIFICATE

How do we magnify WHAT'S going right?

INCREDIBLE DIVERSITY of STUDENTS



(B) NCLB ESSA

WHAT ARE the NEEDS of the 21st GEN. STUDENT?

How do we support the STUDENTS who AREN'T ATTAINING CURRENT DIPLOMA?

WE'VE LISTENED
to a LOT of PEOPLE!

STUDENTS | TEACHERS
PARENTS
EXPERTS

ACCESS to
PATHWAYS

NO CONSTITUTIONAL
REQUIREMENT

OPPORTUNITY
to LEARN

ACCOUNTABILITY
SYSTEM

IS the 'TEST'
FAIR?

POTENTIALITY

COR?

WILL
CONTINUE
to

REVIEW as APPROPRIATE..

POLICY, NOT LEGAL

- LOCAL IMPLEMENTATION
- AFFIRMATION
 - DESIGN for an EVOLVING FUTURE
 - EQUITY
 - RELEVANT
 - SIMPLE
 - START EARLY
 - APPLIED LEARNING
 - PORTFOLIO
 - TEACH STUDENTS HOW TO LEARN
 - FLEXIBLE/RIGOROUS
 - OUTCOMES-BASED
 - TRANSPARENCY & COMMUNICATION

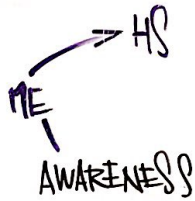

WHO'S LOOKING AT IT?
↑ ECAs
THOSE THINGS VALUED OUTSIDE K-12...

ACCOUNTABILITY



SOLUTIONS →

IF ST. REQ. HAVE TO REMEDIATE... Boo.
* WHAT'S OUR RESPONSE TO TESTING??
ASSESSMENTS CAN BE DESIGNED TO DO 1 THING...

- WORK ETHIC CERTIFICATE
- TECHNICAL SKILLS
- SOFT / CORE SKILLS
- 1 PATHWAY
- APPRENTICESHIP
- GPA
- WORK-BASED LEARNING
- CTE CONCENTRATORS - PATHWAY? - COMPLETOR - ACCESS...
- MULTI-LINGUAL PROFICIENCY
- INDUSTRY-RECOGNIZED CREDENTIALS
- EXTRA-CURRICULAR LEADERSHIP
- LONG-TERM JOB

METRICS?

work product

experience within curriculum...

DESIGN REQUIREMENTS & PRINCIPLES...

MANY WILL CUT ACROSS

10.20.32.4.1.5 (C)

GRAD PATHWAYS

1 ECAS - VALUE? + Higher.ed ACCEPTANCE? APPLIES 6.30.2018
NOT A STANDALONE PATHWAY

2 ^{COLLEGE ENTRANCE} NATIONALLY RECOGNIZED ASSESSMENTS - ACT/SAT
NOT STANDALONE... - \$... MULTIPLE ATTEMPTS -

3 ^{ACC. PLACER} IB EXAMS 4-7
NOT STANDALONE PATHWAY } HONORS DIPLOMA... PARTICIPATION?

4 AP EXAMS } TRANSCRIPTED CREDITS
SAT/ACT ECA?

5 DUAL CREDIT } COLLEGE ACCEPTANCE? MEASURE WHEN?
PAIR W. SAT/ACT... OR GPA & COURSE SEL.

6 INDUSTRY REQ. CREDITS } PROCESS FOR ADDING/CHANGING the UST
CERTIFICATES

7 ASVAB, SCORE TSD., + enlistment (ACCEPTANCE?)

8 ANY OTHER PATHWAY est. by SBOE

SP
F
3
3
3
NOT VALUED
equally...

WHAT IS A PATHWAY?

How does it GET ASSESSED?

How does it RELATE to a DIPLOMA?

A WAY to POST-SECONDARY OPPORTUNITY..



SOMETHING toward POST-SECONDARY

IF WE WANT STUDENTS to VALUE the ASSESSMENT, IT SHOULD HAVE VALUE BEYOND INDIANA H.S.

HIGH-STAKES TESTS..

ECA

CURRENTLY, A PATHWAY COMPONENT ELEMENT?

IF IT'S IN STATE ACCOUNTABILITY MEASURES..

◦ ACADEMIC ASSESSMENTS

◦ CREDENTIALS

◦ CAPSTONE

FEDERAL REQ.

GETTING out of AN UNPRODUCTIVE REMEDIATION CYCLE..

- CHANGE STATE LAW?

- CHANGE RE-TAKE RULES?

SKILLS MODEL

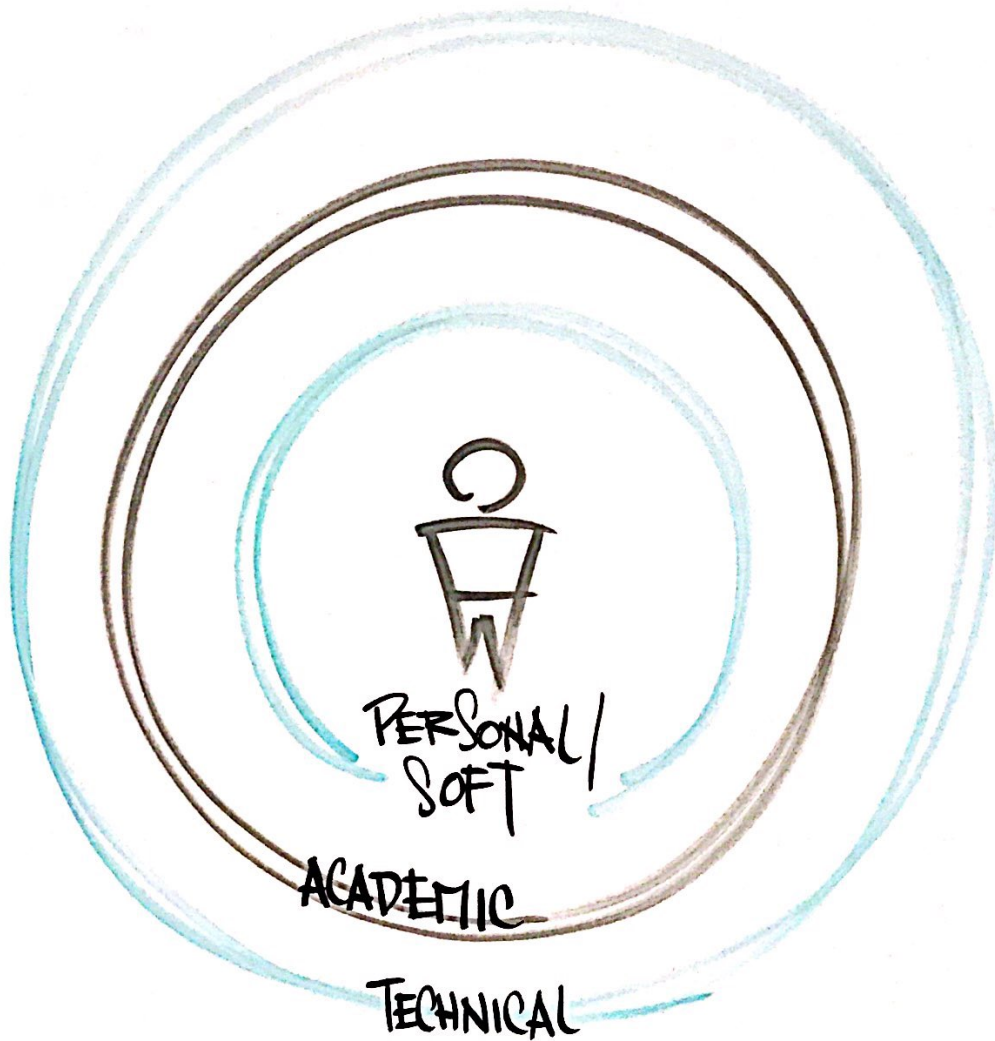

CORE FOUNDATIONAL

K-12

How will these be implemented?
• MEASURED?
• INCENTED?

FRAMEWORK

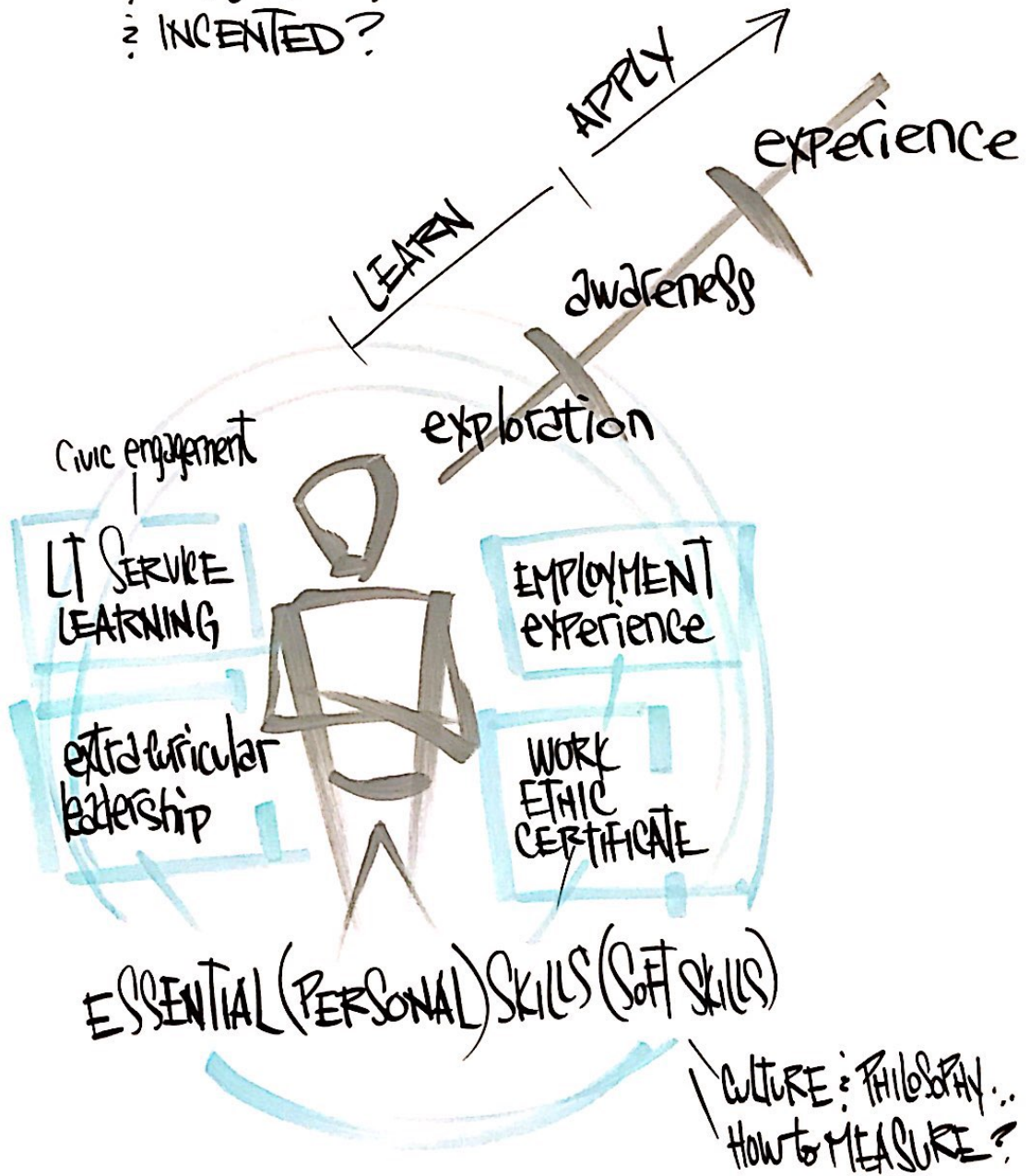

TYPES of LEARNING:

- CLASSROOM
- WORK-BASED ... INTERNSHIP
- SERVICE



PERSONAL / SOFT SKILLS