



HAZARDOUS AND REGULATED MATERIALS INSPECTION REPORT

Genesis Convention Center – Parking Garage
401 Adams Street
Parcel ID: 45-08-282-001
Gary, Indiana 46402

Prepared for:

Northwest Indiana Regional Development Authority
9800 Connecticut Drive
Crown Point, Indiana 46307
Client Reference: Gary Blight Elimination Program

Prepared by:

Egis
48797 Alpha Drive, Suite 130
Wixom, MI 48393
Egis Project ID: 240100
May 6, 2025

TABLE OF CONTENTS

1.0	Introduction.....	1
1.1	Certification	1
2.0	Description of Structure.....	2
2.1	Accessibility Limitations	2
3.0	General Inspection Methodology	3
4.0	Laboratory Analytical Results.....	4
5.0	Other Hazardous and/or Regulated Materials	5
6.0	Conclusions and Recommendations.....	7
7.0	Limitations	7

ATTACHMENTS

Attachment 1 – Laboratory Analytical Report

Attachment 2 – Figures

Attachment 3 – Photographic Log

1.0 INTRODUCTION

Egis has been contracted by Northwest Indiana Regional Development Authority (the RDA) to provide industrial hygiene services for commercial properties in the City of Gary. Egis industrial hygienists are conducting hazardous and regulated materials (HRM) inspections of commercial buildings and associated exterior portions of properties for select properties in the City of Gary. The properties to be inspected by Egis are included in a portfolio of work provided by the RDA, in concurrence with City of Gary governance, for the Gary Blight Elimination Program.

To facilitate demolition of blighted buildings, Egis has completed a supplementary HRM inspection (including asbestos) of a four-story parking garage located at 401 Adams Street, Gary, Indiana (Site) commonly referred to as the Genisis Convention Center Parking Garage. The HRM inspection was conducted on February 21, 2025, and April 14, 2025. During the inspection bulk material samples were collected, and quantities of suspect asbestos-containing materials (ACM) were estimated where applicable. This inspection also included identification and quantification of other hazardous and/or regulated materials (ORM) within the building structure and in exterior portions of the Site.

1.1 CERTIFICATION

The asbestos inspection was conducted by State of Indiana (SOI) Accredited Asbestos Inspectors identified below.

TABLE 1.1.1 – Asbestos Inspectors	
Inspector Name and SOI Accreditation Number	Contact Information
Connor Beausejour - 19A015957	beausejour.connor@egis-group.com / (248) 863-2938
Andrew Ketchum - 19A015961	andrew.ketchum@egis-group.com / (248) 829-0900
Keith Ventimiglia -19A015969	keith.ventimiglia@egis-group.com / (248) 459-5090

2.0 DESCRIPTION OF STRUCTURE

The structure is approximately 120,000 square feet in size. It is a four-story concrete structure with a poured "crawlspace".

Property information and a description of the structure(s) and other improvements are provided below. Information was gathered from the site reconnaissance and review of municipal records.

TABLE 2.0.1 – PROPERTY INFORMATION	
Parcel Number	45-08-282-001.000-004
Square Footage	120,000 square feet
Foundation Type	Poured Crawlpace
Building Type	Commercial Building
Exterior Description	Concrete structure
Secondary structure(s)	NA
Pavement/Hardscape	Sidewalk

2.1 ACCESSIBILITY LIMITATIONS

As part of conducting the HRM inspection, Egis asbestos inspectors assessed the condition of the structure holistically, beginning with the foundation and structural members, and specifically by exterior area (EA) and functional space (FS) for safe accessibility. EA and FS may be considered inaccessible as a result of fire damage, water damage, and/or an unstable foundation. Egis asbestos inspectors made reasonable efforts to sample (by reaching through doorways or windows), or assume, and quantify, any suspect ACM visible from outside the structure that is located in an EA or FS determined to be inaccessible. See Table 2.1.1 below for a summary of inaccessibility.

TABLE 2.1.1 ACCESSIBILITY LIMITATIONS		
Space Designation	Inaccessibility Determination	Reason
FS7	Completely Inaccessible	Room access was barricaded with steel sheet which was secured to the building.

3.0 GENERAL INSPECTION METHODOLOGY

This inspection provides information on the presence of Asbestos Containing Materials (ACMs) in accordance with the National Emission Standard for a Hazardous Air Pollutant (NESHAP) for Asbestos, 40 CFR 61 Subpart M. The Clean Air Act (CAA) requires the U.S. Environmental Protection Agency (EPA) to develop and enforce regulations to protect the public from exposure to airborne contaminants that are known to be hazardous to human health. The U.S. EPA established the NESHAP under the authority of Section 112 of the CAA, and asbestos was one of the first hazardous air pollutants regulated.

NESHAP requires thorough inspection of the facility for asbestos, including Category I and Category II non-friable ACM. ACM is material containing more than 1% asbestos as determined using the methods specified in Appendix E, subpart E, 40 CFR part 763, section 1, Polarized Light Microscopy (PLM). The NESHAP classifies ACM as friable or non-friable. Per 40 CFR 61, Subpart M, friable ACM is that which, when dry, may be crumbled, pulverized, or reduced to powder by hand pressure. Non-friable ACM is ACM that, when dry, cannot be crumbled, pulverized, or reduced to powder by hand pressure.

Non-friable ACM is further classified as Category I or Category II. Category I and Category II ACM are distinguished from each other by their potential to release fibers when damaged. Examples of Category I non-friable ACM include but are not limited to: asbestos containing packing, gaskets, resilient floor coverings, resilient floor covering mastic and asphalt roofing products containing more than 1% asbestos as determined using PLM/EPA Method 600R. Category II ACM includes all other non-friable ACM, such as asbestos-cement (A/C) shingles, A/C tiles, and Transite® boards or panels containing more than 1% asbestos. Generally, Category II ACM is more likely to become friable when damaged than Category I ACM. The applicability of NESHAP to Category I and II ACM depends on:

- (1) the condition of the material at the time of demolition or renovation
- (2) the nature of the operation to which the material will be subjected
- (3) the amount of ACM involved

ACM regulated under NESHAP are identified as Regulated ACMs (RACMs). RACM is defined in §61.141 of the NESHAP and includes:

- (1) Friable ACM
- (2) Category I non-friable ACM that has become friable
- (3) Category I non-friable ACM that will be or has been subjected to sanding, grinding, cutting, or abrading
- (4) Category II non-friable ACM that has already been or is likely to become crumbled, pulverized, or reduced to powder by forces expected to act on the material during demolition or renovation operations regulated by EPA 40 CFR 61 Subpart M, NESHAP for Asbestos

The determination of suspect ACMs was based on visual examination, material age and professional experience. Specifically, materials similar in color and texture were classified into homogenous areas. A homogeneous area is an area of surfacing material (SM), thermal system insulation material (TSI), or miscellaneous material (MM) that is uniform in color, texture, and/or date of installation. The appropriate number of samples were collected from suspect material in each established homogenous area. Egis implemented the “3-5-7” rule of sampling surfacing materials required by the Asbestos Hazard Emergency Response Act (AHERA). Samples were analyzed by PLM via EPA Method 600/R-93/116, by EMSL Laboratories, an NVLAP accredited laboratory.

4.0 LABORATORY ANALYTICAL RESULTS

Thirty-eight (38) bulk materials (homogenous areas [HA]) identified as suspect ACM were sampled and submitted for laboratory analysis and one HAs tested positive for the presence of asbestos fibers greater than 1% by weight. One material was assumed positive as ACM. Table 4.0.1 below provides details for these ACM. Bulk materials were analyzed for asbestos pursuant to EPA Method 600/R-93/116 using PLM, unless otherwise indicated. Bulk material samples that tested between a trace amount and one percent (1%) asbestos were point counted (400-point counts; EPA 600/R-93/116) to confirm the result. A copy of the laboratory analytical report is provided as *Attachment 1, Laboratory Analytical Report*. Figures depicting the building layout and sample locations are included as *Attachment 2, Figures*. A photographic log that documents the inspection is provided as *Attachment 3, Photographic Log*.

TABLE 4.0.1 – LABORATORY ANALYTICAL RESULTS

Sample ID	Material Description	Assumed	Material Type	Location(s) (FS/EA)	Estimated Quantity	ACM Category
24	Transite - Transite panels with Wall Sheeting	N	MM	FS17	150 SF	Non-Friable - Category 2
NA	Fire Door - Metal	YES	MM	EA1; EA2; EA4; FS4; FS5; FS7; FS8; FS13; FS15	20 UNITS	Non-Friable - Category 2

5.0 OTHER HAZARDOUS AND/OR REGULATED MATERIALS

In addition to inspecting the structure(s) for ACMs pursuant to the NESHAP for Asbestos, 40 CFR 61 Subpart M, Egis conducted a visual, non-intrusive inspection of hazardous and/or regulated materials, which did not involve testing. Egis has attempted to accurately quantify the number of hazardous and/or regulated materials that may require decontamination or disposal prior to demolition. Further inspecting, testing, sampling, and/or remediation of any conditions inspected or noted in this report, including actual quantities, remain the sole responsibility of others. Potential hazardous and/or regulated materials addressed by the inspection include, but are not limited to, the following:

- (1) Refrigerants and related chemicals (40 CFR 82);
- (2) Solid wastes which exhibit any of the characteristics of ignitability, corrosivity, reactivity, or toxicity (40 CFR 261.20 – 261.24);
- (3) Hazardous wastes (40 CFR 261.31, 261.32) and discarded commercial chemical products (40 CFR 261.33 & Part 111, Public Act 451 of 1994, as amended);
- (4) Universal wastes, including batteries, pesticides, mercury-containing products, and certain household wastes (40 CFR 273);
- (5) PCB-containing products (40 CFR 761);
- (6) Scrap tires (IC 13-20-14-4);
- (7) Medical or Infectious Wastes (IC 16-41-16 and 410 IAC 1-3-22);
- (8) Electronic Waste (IC 13-20.5)

Lead-based paint (LBP) may be present on the site and is a hazardous substance. Its condition, handling and disposal are regulated by federal, state, and local agencies. LBP does not pose a health threat unless particles are disturbed, become airborne and are inhaled or ingested. Contractors and their employers that will be disturbing the building during demolition should follow all applicable requirements in the OSHA Lead in Construction Standard.

Further testing may be required of debris generated from demolition activities to determine whether the debris should be disposed of as hazardous waste under the Resource Conservation and Recovery Act (RCRA) in accordance with 40-CFR Part 261 Subpart C.

Table 5.0.1 below summarizes other regulated materials (ORM) that were observed at the Site by Egis field staff the day of the inspection.

TABLE 5.0.1 – OTHER REGULATED MATERIALS			
Material Description	Location (FS/EA)	Estimated Quantity	Additional Information
FLUORESCENT LAMP	FS1 - FS13	320 UNITS	4' fluorescent bulbs
BALLASTS	FS1 - FS13	200 UNITS	

TABLE 5.0.1 – OTHER REGULATED MATERIALS

Material Description	Location (FS/EA)	Estimated Quantity	Additional Information
HIGH PRESSURE SODIUM LIGHT BULBS	FS1 - FS12	300 UNITS	Sodium or mercury vapor light bulbs

6.0 CONCLUSIONS AND RECOMMENDATIONS

The Indiana Department of Environmental Management (IDEM) Air Quality Division requires formal notification of demolition activities for all structures with, or without, regulated asbestos containing materials (RACM) by using state form *Notification of Demolition and Renovation Operations (State Form 44593, available on the IDEM Agency Forms page)*. Notifications must be made at least 10 business days prior to start of work.

Laboratory results for bulk material samples collected during the HRM inspection indicate several building materials are ACMs and are subject to proper abatement and/or disposal based upon planned demolition activities. Refer to 4.0.1 – Laboratory Analytical Results, for a list of all confirmed and assumed ACMs.

7.0 LIMITATIONS

Egis BLN USA, Inc. sampled portions of the roof that could be accessed safely. If sample collection and friability assessment could not be completed for a suspect material, then the material should be considered a friable ACM, and managed in accordance with the applicable regulations governing such material. However, if later the asbestos removal contractor or demolition contractor gains access to the roof, the friability can be assessed, and samples collected (where applicable and determined necessary by said contractor). This secondary assessment will provide the necessary information to determine if the roofing material can remain in place, or if it is required (in part or whole) to be removed prior to demolition. Egis BLN USA, Inc. is not responsible for this secondary inspection unless specifically requested to do so.

The conclusions of this report are based solely upon observations made during this evaluation. This report is intended to present a professional opinion of potential asbestos containing materials that may or may not be present at the project property. Our opinions should not be construed as relating to health and safety issues directly. Should additional information become available, this information should be reviewed, and the conclusions herein modified as appropriate. In addition, this report should not be construed as verification of compliance by the present owners or operators of the Site with federal, state, or local laws and regulations. Egis BLN USA, Inc. is responsible to perform services in a professional manner, consistent with typical industry practice. The conclusions drawn based on this evaluation are deemed as appropriate by Egis BLN USA, Inc. in the exercise of professional judgment.

Our observations did not indicate conditions existing beyond those discussed, although it is possible, limitation of scope or the standard practice precluded recognition of asbestos containing materials present at the site, such as inaccessible and/or confined spaces of the structure. Egis BLN USA, Inc. staff do not enter confined spaces as part of the inspection process. Confined spaces include crawlspaces and attics or any other such space where there is limited ingress and egress.

Egis BLN USA, Inc. reserves the right to determine when and where a confined space may be present and use professional judgment when deciding upon entry. We cannot be held liable for materials that may be present in these spaces and unable to be reported as part of our inspection process. The presence of confined spaces will be reported as applicable, and all limitations expressed herein will apply. Any confined spaces encountered during the inspection are identified in Table 2.1.1 – Accessibility Limitations.

We cannot be held liable for consequential damages, if it is determined in the future that contamination of some type is present at the site. This report should not be considered as a recommendation to purchase, sell, or develop the Site, and the opinions expressed herein are not legal opinions. To evaluate the information contained in this report, the reader must understand the limitations associated with this assessment. Specifically, the services for this project have been performed in general conformance with the contract negotiated between the RDA and Egis

BLN USA, Inc. This report was prepared for the benefit and exclusive use of the RDA, its agents and assigns. Any third-party use of this report or reliance upon the information and opinions therein is the sole responsibility of the third party. Egis BLN USA, Inc. has no responsibility for any damages that may be suffered by a third party because of any decision made or action taken by a third party based on this report.

ATTACHMENT 1 – LABORATORY REPORT



EMSL Analytical, Inc.

200 Route 130 North Cinnaminson, NJ 08077
Phone/Fax: (800) 220-3675 / (856) 786-5974
<http://www.EMSL.com> / cinnasblab@EMSL.com

EMSL Order ID: 042503429
Customer ID: BLNL75
Customer PO: 240100
Project ID:

Attn: Detroit Project Group
Egis BLN USA Inc
51151 W. Pontiac Trail
Wixom, MI 48393
Phone: (313) 408-4893
Fax:
Collected: 2/21/2025
Received: 2/25/2025
Analyzed: 2/27/2025
Proj: IC-009 - 401 Adams/Garage / RDA Program

Summary Test Report for Asbestos Analysis of Bulk Material

Client Sample ID: 1A **Lab Sample ID:** 042503429-0001

Sample Description: EA 1, 2, 3 ,4/Concrete - Exterior decorative concrete slabs

TEST	Analyzed Date	Color	Non-Asbestos		Asbestos	Comment
			Fibrous	Non-Fibrous		
PLM	2/25/2025	Gray	0.0%	100.0%	None Detected	

Client Sample ID: 1B **Lab Sample ID:** 042503429-0002

Sample Description: EA 1, 2, 3 ,4/Concrete - Exterior decorative concrete slabs

TEST	Analyzed Date	Color	Non-Asbestos		Asbestos	Comment
			Fibrous	Non-Fibrous		
PLM	2/25/2025	Gray	0.0%	100.0%	None Detected	

Client Sample ID: 1C **Lab Sample ID:** 042503429-0003

Sample Description: EA 1, 2, 3 ,4/Concrete - Exterior decorative concrete slabs

TEST	Analyzed Date	Color	Non-Asbestos		Asbestos	Comment
			Fibrous	Non-Fibrous		
PLM	2/25/2025	Gray	0.0%	100.0%	None Detected	

Client Sample ID: 2A **Lab Sample ID:** 042503429-0004

Sample Description: EA 1, 2, 3 ,4/Concrete - Exterior footing, at base of building

TEST	Analyzed Date	Color	Non-Asbestos		Asbestos	Comment
			Fibrous	Non-Fibrous		
PLM	2/25/2025	Gray	0.0%	100.0%	None Detected	

Client Sample ID: 2B **Lab Sample ID:** 042503429-0005

Sample Description: EA 1, 2, 3 ,4/Concrete - Exterior footing, at base of building

TEST	Analyzed Date	Color	Non-Asbestos		Asbestos	Comment
			Fibrous	Non-Fibrous		
PLM	2/25/2025	Gray	0.0%	100.0%	None Detected	

Client Sample ID: 2C **Lab Sample ID:** 042503429-0006

Sample Description: EA 1, 2, 3 ,4/Concrete - Exterior footing, at base of building

TEST	Analyzed Date	Color	Non-Asbestos		Asbestos	Comment
			Fibrous	Non-Fibrous		
PLM	2/25/2025	Gray	0.0%	100.0%	None Detected	

Client Sample ID: 3A **Lab Sample ID:** 042503429-0007

Sample Description: EA 1, 2, 3 ,4/Exterior_Caulk - Gray, flexible, at base of decorative concrete and exterior footings

TEST	Analyzed Date	Color	Non-Asbestos		Asbestos	Comment
			Fibrous	Non-Fibrous		
PLM	2/25/2025	Gray	0.0%	100.0%	None Detected	



EMSL Analytical, Inc.

200 Route 130 North Cinnaminson, NJ 08077
Phone/Fax: (800) 220-3675 / (856) 786-5974
<http://www.EMSL.com> / cinnasblab@EMSL.com

EMSL Order ID: 042503429
Customer ID: BLNL75
Customer PO: 240100
Project ID:

Summary Test Report for Asbestos Analysis of Bulk Material

Client Sample ID: 3B **Lab Sample ID:** 042503429-0008

Sample Description: EA 1, 2, 3 ,4/Exterior_Caulk - Gray, flexible, at base of decorative concrete and exterior footings

TEST	Analyzed Date	Color	Non-Asbestos		Asbestos	Comment
			Fibrous	Non-Fibrous		
PLM	2/25/2025	Gray	0.0%	100.0%	None Detected	

Client Sample ID: 3C **Lab Sample ID:** 042503429-0009

Sample Description: EA 1, 2, 3 ,4/Exterior_Caulk - Gray, flexible, at base of decorative concrete and exterior footings

TEST	Analyzed Date	Color	Non-Asbestos		Asbestos	Comment
			Fibrous	Non-Fibrous		
PLM	2/25/2025	Gray	0.0%	100.0%	None Detected	

Client Sample ID: 4A **Lab Sample ID:** 042503429-0010

Sample Description: EA 1, 2, 3 ,4 & FS 1, FS 2, FS 3, FS 6, FS 8, FS 10, FS 11, FS 12/Concrete - Concrete columns, exterior & interior

TEST	Analyzed Date	Color	Non-Asbestos		Asbestos	Comment
			Fibrous	Non-Fibrous		
PLM	2/25/2025	Gray	0.0%	100.0%	None Detected	

Client Sample ID: 4B **Lab Sample ID:** 042503429-0011

Sample Description: EA 1, 2, 3 ,4 & FS 1, FS 2, FS 3, FS 6, FS 8, FS 10, FS 11, FS 12/Concrete - Concrete columns, exterior & interior

TEST	Analyzed Date	Color	Non-Asbestos		Asbestos	Comment
			Fibrous	Non-Fibrous		
PLM	2/25/2025	Gray	0.0%	100.0%	None Detected	

Client Sample ID: 4C **Lab Sample ID:** 042503429-0012

Sample Description: EA 1, 2, 3 ,4 & FS 1, FS 2, FS 3, FS 6, FS 8, FS 10, FS 11, FS 12/Concrete - Concrete columns, exterior & interior

TEST	Analyzed Date	Color	Non-Asbestos		Asbestos	Comment
			Fibrous	Non-Fibrous		
PLM	2/25/2025	Gray	0.0%	100.0%	None Detected	

Client Sample ID: 5A **Lab Sample ID:** 042503429-0013

Sample Description: EA 4/Exterior_Caulk - Gray, brittle, at short metal doors

TEST	Analyzed Date	Color	Non-Asbestos		Asbestos	Comment
			Fibrous	Non-Fibrous		
PLM	2/25/2025	Gray	0.0%	100.0%	None Detected	

Client Sample ID: 5B **Lab Sample ID:** 042503429-0014

Sample Description: EA 4/Exterior_Caulk - Gray, brittle, at short metal doors

TEST	Analyzed Date	Color	Non-Asbestos		Asbestos	Comment
			Fibrous	Non-Fibrous		
PLM	2/25/2025	Gray	0.0%	100.0%	None Detected	

Client Sample ID: 5C **Lab Sample ID:** 042503429-0015

Sample Description: EA 4/Exterior_Caulk - Gray, brittle, at short metal doors

TEST	Analyzed Date	Color	Non-Asbestos		Asbestos	Comment
			Fibrous	Non-Fibrous		
PLM	2/25/2025	Gray	0.0%	100.0%	None Detected	



EMSL Analytical, Inc.

200 Route 130 North Cinnaminson, NJ 08077
Phone/Fax: (800) 220-3675 / (856) 786-5974
<http://www.EMSL.com> / cinnasblab@EMSL.com

EMSL Order ID: 042503429
Customer ID: BLNL75
Customer PO: 240100
Project ID:

Summary Test Report for Asbestos Analysis of Bulk Material

Client Sample ID: 6A **Lab Sample ID:** 042503429-0016

Sample Description: EA 1, EA 2/Exterior_Caulk - Gray, flexible. On exterior and interior metal doors and windows

TEST	Analyzed Date	Color	Non-Asbestos		Asbestos	Comment
			Fibrous	Non-Fibrous		
PLM	2/25/2025	Gray	0.0%	100.0%	None Detected	

Client Sample ID: 6B **Lab Sample ID:** 042503429-0017

Sample Description: EA 1, EA 2/Exterior_Caulk - Gray, flexible. On exterior and interior metal doors and windows

TEST	Analyzed Date	Color	Non-Asbestos		Asbestos	Comment
			Fibrous	Non-Fibrous		
PLM	2/25/2025	Gray	0.0%	100.0%	None Detected	

Client Sample ID: 6C **Lab Sample ID:** 042503429-0018

Sample Description: EA 1, EA 2/Exterior_Caulk - Gray, flexible. On exterior and interior metal doors and windows

TEST	Analyzed Date	Color	Non-Asbestos		Asbestos	Comment
			Fibrous	Non-Fibrous		
PLM	2/25/2025	Gray	0.0%	100.0%	None Detected	

Client Sample ID: 7A **Lab Sample ID:** 042503429-0019

Sample Description: EA 1/Brick_Mortar - Exterior ridged gray brick w/mortar

TEST	Analyzed Date	Color	Non-Asbestos		Asbestos	Comment
			Fibrous	Non-Fibrous		
PLM	2/25/2025	Gray	0.0%	100.0%	None Detected	

Client Sample ID: 7B **Lab Sample ID:** 042503429-0020

Sample Description: EA 1/Brick_Mortar - Exterior ridged gray brick w/mortar

TEST	Analyzed Date	Color	Non-Asbestos		Asbestos	Comment
			Fibrous	Non-Fibrous		
PLM	2/25/2025	Gray	0.0%	100.0%	None Detected	

Client Sample ID: 7C **Lab Sample ID:** 042503429-0021

Sample Description: EA 1/Brick_Mortar - Exterior ridged gray brick w/mortar

TEST	Analyzed Date	Color	Non-Asbestos		Asbestos	Comment
			Fibrous	Non-Fibrous		
PLM	2/25/2025	Gray	0.0%	100.0%	None Detected	

Client Sample ID: 8A **Lab Sample ID:** 042503429-0022

Sample Description: EA 1/Concrete - Retaining walls

TEST	Analyzed Date	Color	Non-Asbestos		Asbestos	Comment
			Fibrous	Non-Fibrous		
PLM	2/26/2025	Gray	0.0%	100.0%	None Detected	

Client Sample ID: 8B **Lab Sample ID:** 042503429-0023

Sample Description: EA 1/Concrete - Retaining walls

TEST	Analyzed Date	Color	Non-Asbestos		Asbestos	Comment
			Fibrous	Non-Fibrous		
PLM	2/26/2025	Gray	0.0%	100.0%	None Detected	



EMSL Analytical, Inc.

200 Route 130 North Cinnaminson, NJ 08077
Phone/Fax: (800) 220-3675 / (856) 786-5974
<http://www.EMSL.com> / cinnasblab@EMSL.com

EMSL Order ID: 042503429
Customer ID: BLNL75
Customer PO: 240100
Project ID:

Summary Test Report for Asbestos Analysis of Bulk Material

Client Sample ID: 8C **Lab Sample ID:** 042503429-0024

Sample Description: EA 1/Concrete - Retaining walls

TEST	Analyzed Date	Color	Non-Asbestos		Asbestos	Comment
			Fibrous	Non-Fibrous		
PLM	2/26/2025	Gray	0.0%	100.0%	None Detected	

Client Sample ID: 9A **Lab Sample ID:** 042503429-0025

Sample Description: EA 1/Block_Mortar - Cinder block w/mortar

TEST	Analyzed Date	Color	Non-Asbestos		Asbestos	Comment
			Fibrous	Non-Fibrous		
PLM	2/26/2025	Gray	0.0%	100.0%	None Detected	

Client Sample ID: 9B **Lab Sample ID:** 042503429-0026

Sample Description: EA 1/Block_Mortar - Cinder block w/mortar

TEST	Analyzed Date	Color	Non-Asbestos		Asbestos	Comment
			Fibrous	Non-Fibrous		
PLM	2/26/2025	Gray	0.0%	100.0%	None Detected	

Client Sample ID: 9C **Lab Sample ID:** 042503429-0027

Sample Description: EA 1/Block_Mortar - Cinder block w/mortar

TEST	Analyzed Date	Color	Non-Asbestos		Asbestos	Comment
			Fibrous	Non-Fibrous		
PLM	2/26/2025	Gray	0.0%	100.0%	None Detected	

Client Sample ID: 10A **Lab Sample ID:** 042503429-0028

Sample Description: FS 1, FS 2, FS 3, FS 6, FS 8, FS 10, FS 11, FS 12, FS 14/Concrete - Interior pavement surface

TEST	Analyzed Date	Color	Non-Asbestos		Asbestos	Comment
			Fibrous	Non-Fibrous		
PLM	2/26/2025	Gray	0.0%	100.0%	None Detected	

Client Sample ID: 10B **Lab Sample ID:** 042503429-0029

Sample Description: FS 1, FS 2, FS 3, FS 6, FS 8, FS 10, FS 11, FS 12, FS 14/Concrete - Interior pavement surface

TEST	Analyzed Date	Color	Non-Asbestos		Asbestos	Comment
			Fibrous	Non-Fibrous		
PLM	2/26/2025	Gray	0.0%	100.0%	None Detected	

Client Sample ID: 10C **Lab Sample ID:** 042503429-0030

Sample Description: FS 1, FS 2, FS 3, FS 6, FS 8, FS 10, FS 11, FS 12, FS 14/Concrete - Interior pavement surface

TEST	Analyzed Date	Color	Non-Asbestos		Asbestos	Comment
			Fibrous	Non-Fibrous		
PLM	2/26/2025	Gray	0.0%	100.0%	None Detected	

Client Sample ID: 10D **Lab Sample ID:** 042503429-0031

Sample Description: FS 1, FS 2, FS 3, FS 6, FS 8, FS 10, FS 11, FS 12, FS 14/Concrete - Interior pavement surface

TEST	Analyzed Date	Color	Non-Asbestos		Asbestos	Comment
			Fibrous	Non-Fibrous		
PLM	2/26/2025	Gray	0.0%	100.0%	None Detected	



EMSL Analytical, Inc.

200 Route 130 North Cinnaminson, NJ 08077
Phone/Fax: (800) 220-3675 / (856) 786-5974
<http://www.EMSL.com> / cinnasblab@EMSL.com

EMSL Order ID: 042503429
Customer ID: BLNL75
Customer PO: 240100
Project ID:

Summary Test Report for Asbestos Analysis of Bulk Material

Client Sample ID: 10E **Lab Sample ID:** 042503429-0032

Sample Description: FS 1, FS 2, FS 3, FS 6, FS 8, FS 10, FS 11, FS 12, FS 14/Concrete - Interior pavement surface

TEST	Analyzed Date	Color	Non-Asbestos		Asbestos	Comment
			Fibrous	Non-Fibrous		
PLM	2/26/2025	Gray	0.0%	100.0%	None Detected	

Client Sample ID: 11A **Lab Sample ID:** 042503429-0033

Sample Description: FS 1, FS 2, FS 3, FS 6, FS 8, FS 10, FS 11, FS 12, FS 14/Concrete - Precast concrete decking ceiling, ridged

TEST	Analyzed Date	Color	Non-Asbestos		Asbestos	Comment
			Fibrous	Non-Fibrous		
PLM	2/26/2025	Gray	0.0%	100.0%	None Detected	

Client Sample ID: 11B **Lab Sample ID:** 042503429-0034

Sample Description: FS 1, FS 2, FS 3, FS 6, FS 8, FS 10, FS 11, FS 12, FS 14/Concrete - Precast concrete decking ceiling, ridged

TEST	Analyzed Date	Color	Non-Asbestos		Asbestos	Comment
			Fibrous	Non-Fibrous		
PLM	2/26/2025	Gray	0.0%	100.0%	None Detected	

Client Sample ID: 11C **Lab Sample ID:** 042503429-0035

Sample Description: FS 1, FS 2, FS 3, FS 6, FS 8, FS 10, FS 11, FS 12, FS 14/Concrete - Precast concrete decking ceiling, ridged

TEST	Analyzed Date	Color	Non-Asbestos		Asbestos	Comment
			Fibrous	Non-Fibrous		
PLM	2/26/2025	Gray	0.0%	100.0%	None Detected	

Client Sample ID: 11D **Lab Sample ID:** 042503429-0036

Sample Description: FS 1, FS 2, FS 3, FS 6, FS 8, FS 10, FS 11, FS 12, FS 14/Concrete - Precast concrete decking ceiling, ridged

TEST	Analyzed Date	Color	Non-Asbestos		Asbestos	Comment
			Fibrous	Non-Fibrous		
PLM	2/26/2025	Gray	0.0%	100.0%	None Detected	

Client Sample ID: 11E **Lab Sample ID:** 042503429-0037

Sample Description: FS 1, FS 2, FS 3, FS 6, FS 8, FS 10, FS 11, FS 12, FS 14/Concrete - Precast concrete decking ceiling, ridged

TEST	Analyzed Date	Color	Non-Asbestos		Asbestos	Comment
			Fibrous	Non-Fibrous		
PLM	2/26/2025	Gray	0.0%	100.0%	None Detected	

Client Sample ID: 12A-Block **Lab Sample ID:** 042503429-0038

Sample Description: FS 1, FS 4, FS 5, FS 7, FS 15/Block_Mortar - Interior Wall Block with Mortar at stairwells

TEST	Analyzed Date	Color	Non-Asbestos		Asbestos	Comment
			Fibrous	Non-Fibrous		
PLM	2/26/2025	Gray	0.0%	100.0%	None Detected	

Client Sample ID: 12A-Mortar **Lab Sample ID:** 042503429-0038A

Sample Description: FS 1, FS 4, FS 5, FS 7, FS 15/Block_Mortar - Interior Wall Block with Mortar at stairwells

TEST	Analyzed Date	Color	Non-Asbestos		Asbestos	Comment
			Fibrous	Non-Fibrous		
PLM	2/26/2025	Gray	0.0%	100.0%	None Detected	



EMSL Analytical, Inc.

200 Route 130 North Cinnaminson, NJ 08077
Phone/Fax: (800) 220-3675 / (856) 786-5974
<http://www.EMSL.com> / cinnasblab@EMSL.com

EMSL Order ID: 042503429
Customer ID: BLNL75
Customer PO: 240100
Project ID:

Summary Test Report for Asbestos Analysis of Bulk Material

Client Sample ID: 12B-Block **Lab Sample ID:** 042503429-0039

Sample Description: FS 1, FS 4, FS 5, FS 7, FS 15/Block_Mortar - Interior Wall Block with Mortar at stairwells

TEST	Analyzed Date	Color	Non-Asbestos		Asbestos	Comment
			Fibrous	Non-Fibrous		
PLM	2/26/2025	Gray	0.0%	100.0%	None Detected	

Client Sample ID: 12B-Mortar **Lab Sample ID:** 042503429-0039A

Sample Description: FS 1, FS 4, FS 5, FS 7, FS 15/Block_Mortar - Interior Wall Block with Mortar at stairwells

TEST	Analyzed Date	Color	Non-Asbestos		Asbestos	Comment
			Fibrous	Non-Fibrous		
PLM	2/26/2025	Gray	0.0%	100.0%	None Detected	

Client Sample ID: 12C-Block **Lab Sample ID:** 042503429-0040

Sample Description: FS 1, FS 4, FS 5, FS 7, FS 15/Block_Mortar - Interior Wall Block with Mortar at stairwells

TEST	Analyzed Date	Color	Non-Asbestos		Asbestos	Comment
			Fibrous	Non-Fibrous		
PLM	2/26/2025	Gray	0.0%	100.0%	None Detected	

Client Sample ID: 12C-Mortar **Lab Sample ID:** 042503429-0040A

Sample Description: FS 1, FS 4, FS 5, FS 7, FS 15/Block_Mortar - Interior Wall Block with Mortar at stairwells

TEST	Analyzed Date	Color	Non-Asbestos		Asbestos	Comment
			Fibrous	Non-Fibrous		
PLM	2/26/2025	Gray	0.0%	100.0%	None Detected	

Client Sample ID: 12D-Block **Lab Sample ID:** 042503429-0041

Sample Description: FS 1, FS 4, FS 5, FS 7, FS 15/Block_Mortar - Interior Wall Block with Mortar at stairwells

TEST	Analyzed Date	Color	Non-Asbestos		Asbestos	Comment
			Fibrous	Non-Fibrous		
PLM	2/26/2025	Gray	0.0%	100.0%	None Detected	

Client Sample ID: 12D-Mortar **Lab Sample ID:** 042503429-0041A

Sample Description: FS 1, FS 4, FS 5, FS 7, FS 15/Block_Mortar - Interior Wall Block with Mortar at stairwells

TEST	Analyzed Date	Color	Non-Asbestos		Asbestos	Comment
			Fibrous	Non-Fibrous		
PLM	2/26/2025	Gray	0.0%	100.0%	None Detected	

Client Sample ID: 12E-Block **Lab Sample ID:** 042503429-0042

Sample Description: FS 1, FS 4, FS 5, FS 7, FS 15/Block_Mortar - Interior Wall Block with Mortar at stairwells

TEST	Analyzed Date	Color	Non-Asbestos		Asbestos	Comment
			Fibrous	Non-Fibrous		
PLM	2/26/2025	Gray	0.0%	100.0%	None Detected	

Client Sample ID: 12E-Mortar **Lab Sample ID:** 042503429-0042A

Sample Description: FS 1, FS 4, FS 5, FS 7, FS 15/Block_Mortar - Interior Wall Block with Mortar at stairwells

TEST	Analyzed Date	Color	Non-Asbestos		Asbestos	Comment
			Fibrous	Non-Fibrous		
PLM	2/26/2025	Gray	0.0%	100.0%	None Detected	



EMSL Analytical, Inc.

200 Route 130 North Cinnaminson, NJ 08077
Phone/Fax: (800) 220-3675 / (856) 786-5974
<http://www.EMSL.com> / cinnasblab@EMSL.com

EMSL Order ID: 042503429
Customer ID: BLNL75
Customer PO: 240100
Project ID:

Summary Test Report for Asbestos Analysis of Bulk Material

Client Sample ID: 13A **Lab Sample ID:** 042503429-0043

Sample Description: FS 2, FS 4, FS 15/Ceiling_Panel - 2X2, white, pinholes & fissures

TEST	Analyzed Date	Color	Non-Asbestos		Asbestos	Comment
			Fibrous	Non-Fibrous		
PLM	2/26/2025	Gray	70.0%	30.0%	None Detected	

Client Sample ID: 13B **Lab Sample ID:** 042503429-0044

Sample Description: FS 2, FS 4, FS 15/Ceiling_Panel - 2X2, white, pinholes & fissures

TEST	Analyzed Date	Color	Non-Asbestos		Asbestos	Comment
			Fibrous	Non-Fibrous		
PLM	2/26/2025	Brown	60.0%	40.0%	None Detected	

Client Sample ID: 13C **Lab Sample ID:** 042503429-0045

Sample Description: FS 2, FS 4, FS 15/Ceiling_Panel - 2X2, white, pinholes & fissures

TEST	Analyzed Date	Color	Non-Asbestos		Asbestos	Comment
			Fibrous	Non-Fibrous		
PLM	2/26/2025	Gray	70.0%	30.0%	None Detected	

Client Sample ID: 14A **Lab Sample ID:** 042503429-0046

Sample Description: FS 1, FS 2, FS 3, FS 6, FS 8, FS 10, FS 11, FS 12, FS 14/Concrete - Parking garage interior curbs

TEST	Analyzed Date	Color	Non-Asbestos		Asbestos	Comment
			Fibrous	Non-Fibrous		
PLM	2/26/2025				Not Submitted	

Client Sample ID: 14B **Lab Sample ID:** 042503429-0047

Sample Description: FS 1, FS 2, FS 3, FS 6, FS 8, FS 10, FS 11, FS 12, FS 14/Concrete - Parking garage interior curbs

TEST	Analyzed Date	Color	Non-Asbestos		Asbestos	Comment
			Fibrous	Non-Fibrous		
PLM	2/26/2025	Gray	0.0%	100.0%	None Detected	

Client Sample ID: 14C **Lab Sample ID:** 042503429-0048

Sample Description: FS 1, FS 2, FS 3, FS 6, FS 8, FS 10, FS 11, FS 12, FS 14/Concrete - Parking garage interior curbs

TEST	Analyzed Date	Color	Non-Asbestos		Asbestos	Comment
			Fibrous	Non-Fibrous		
PLM	2/26/2025	Gray	0.0%	100.0%	None Detected	

Client Sample ID: 14D **Lab Sample ID:** 042503429-0049

Sample Description: FS 1, FS 2, FS 3, FS 6, FS 8, FS 10, FS 11, FS 12, FS 14/Concrete - Parking garage interior curbs

TEST	Analyzed Date	Color	Non-Asbestos		Asbestos	Comment
			Fibrous	Non-Fibrous		
PLM	2/26/2025				Not Submitted	

Client Sample ID: 14E **Lab Sample ID:** 042503429-0050

Sample Description: FS 1, FS 2, FS 3, FS 6, FS 8, FS 10, FS 11, FS 12, FS 14/Concrete - Parking garage interior curbs

TEST	Analyzed Date	Color	Non-Asbestos		Asbestos	Comment
			Fibrous	Non-Fibrous		
PLM	2/26/2025	Gray	0.0%	100.0%	None Detected	



EMSL Analytical, Inc.

200 Route 130 North Cinnaminson, NJ 08077
Phone/Fax: (800) 220-3675 / (856) 786-5974
<http://www.EMSL.com> / cinnasblab@EMSL.com

EMSL Order ID: 042503429
Customer ID: BLNL75
Customer PO: 240100
Project ID:

Summary Test Report for Asbestos Analysis of Bulk Material

Client Sample ID: 15A-Wallboard **Lab Sample ID:** 042503429-0051

Sample Description: FS 8/Wallboard - with Mud

TEST	Analyzed Date	Color	Non-Asbestos		Asbestos	Comment
			Fibrous	Non-Fibrous		
PLM	2/27/2025	Brown/White	10.0%	90.0%	None Detected	Paper and gypsum layers included in analysis.

Client Sample ID: 15A-Mud **Lab Sample ID:** 042503429-0051A

Sample Description: FS 8/Wallboard - with Mud

TEST	Analyzed Date	Color	Non-Asbestos		Asbestos	Comment
			Fibrous	Non-Fibrous		
PLM	2/27/2025	White	0.0%	100.0%	None Detected	

Client Sample ID: 15B-Wallboard **Lab Sample ID:** 042503429-0052

Sample Description: FS 8/Wallboard - with Mud

TEST	Analyzed Date	Color	Non-Asbestos		Asbestos	Comment
			Fibrous	Non-Fibrous		
PLM	2/27/2025	Brown/White	10.0%	90.0%	None Detected	Paper and gypsum layers included in analysis.

Client Sample ID: 15B-Mud **Lab Sample ID:** 042503429-0052A

Sample Description: FS 8/Wallboard - with Mud

TEST	Analyzed Date	Color	Non-Asbestos		Asbestos	Comment
			Fibrous	Non-Fibrous		
PLM	2/27/2025	White	0.0%	100.0%	None Detected	

Client Sample ID: 15C-Wallboard **Lab Sample ID:** 042503429-0053

Sample Description: FS 8/Wallboard - with Mud

TEST	Analyzed Date	Color	Non-Asbestos		Asbestos	Comment
			Fibrous	Non-Fibrous		
PLM	2/27/2025	Brown/White	10.0%	90.0%	None Detected	Paper and gypsum layers included in analysis.

Client Sample ID: 15C-Mud **Lab Sample ID:** 042503429-0053A

Sample Description: FS 8/Wallboard - with Mud

TEST	Analyzed Date	Color	Non-Asbestos		Asbestos	Comment
			Fibrous	Non-Fibrous		
PLM	2/27/2025	White	0.0%	100.0%	None Detected	

Client Sample ID: 16A **Lab Sample ID:** 042503429-0054

Sample Description: FS 1, FS 2, FS 3, FS 6, FS 8, FS 10, FS 11, FS 12, FS 14/Interior_Caulk - Gray,used as expansion joint in concrete paving

TEST	Analyzed Date	Color	Non-Asbestos		Asbestos	Comment
			Fibrous	Non-Fibrous		
PLM	2/27/2025	Gray	0.0%	100.0%	None Detected	

Client Sample ID: 16B **Lab Sample ID:** 042503429-0055

Sample Description: FS 1, FS 2, FS 3, FS 6, FS 8, FS 10, FS 11, FS 12, FS 14/Interior_Caulk - Gray,used as expansion joint in concrete paving

TEST	Analyzed Date	Color	Non-Asbestos		Asbestos	Comment
			Fibrous	Non-Fibrous		
PLM	2/27/2025	Gray	0.0%	100.0%	None Detected	



EMSL Analytical, Inc.

200 Route 130 North Cinnaminson, NJ 08077
Phone/Fax: (800) 220-3675 / (856) 786-5974
<http://www.EMSL.com> / cinnasblab@EMSL.com

EMSL Order ID: 042503429
Customer ID: BLNL75
Customer PO: 240100
Project ID:

Summary Test Report for Asbestos Analysis of Bulk Material

Client Sample ID: 16C **Lab Sample ID:** 042503429-0056

Sample Description: FS 1, FS 2, FS 3, FS 6, FS 8, FS 10, FS 11, FS 12, FS 14/Interior_Caulk - Gray,used as expansion joint in concrete paving

TEST	Analyzed Date	Color	Non-Asbestos		Asbestos	Comment
			Fibrous	Non-Fibrous		
PLM	2/27/2025	Gray	0.0%	100.0%	None Detected	

Client Sample ID: 17A **Lab Sample ID:** 042503429-0057

Sample Description: FS 2, FS 3, FS 6, FS 8, FS 10, FS 11, FS 12/Heat_Shield - Light Fixtures, along interior center wall

TEST	Analyzed Date	Color	Non-Asbestos		Asbestos	Comment
			Fibrous	Non-Fibrous		
PLM	2/27/2025	Tan	90.0%	10.0%	None Detected	

Client Sample ID: 17B **Lab Sample ID:** 042503429-0058

Sample Description: FS 2, FS 3, FS 6, FS 8, FS 10, FS 11, FS 12/Heat_Shield - Light Fixtures, along interior center wall

TEST	Analyzed Date	Color	Non-Asbestos		Asbestos	Comment
			Fibrous	Non-Fibrous		
PLM	2/27/2025	Tan	90.0%	10.0%	None Detected	

Client Sample ID: 17C **Lab Sample ID:** 042503429-0059

Sample Description: FS 2, FS 3, FS 6, FS 8, FS 10, FS 11, FS 12/Heat_Shield - Light Fixtures, along interior center wall

TEST	Analyzed Date	Color	Non-Asbestos		Asbestos	Comment
			Fibrous	Non-Fibrous		
PLM	2/27/2025	Tan	90.0%	10.0%	None Detected	

Client Sample ID: 18A-Canvas **Lab Sample ID:** 042503429-0060

Sample Description: FS 5/Fire Hose - Canvas fire hose w/ black rubber interior

TEST	Analyzed Date	Color	Non-Asbestos		Asbestos	Comment
			Fibrous	Non-Fibrous		
PLM	2/27/2025	White	95.0%	5.0%	None Detected	

Client Sample ID: 18A-Rubber **Lab Sample ID:** 042503429-0060A

Sample Description: FS 5/Fire Hose - Canvas fire hose w/ black rubber interior

TEST	Analyzed Date	Color	Non-Asbestos		Asbestos	Comment
			Fibrous	Non-Fibrous		
PLM	2/27/2025	Black	0.0%	100.0%	None Detected	

Client Sample ID: 18B-Canvas **Lab Sample ID:** 042503429-0061

Sample Description: FS 5/Fire Hose - Canvas fire hose w/ black rubber interior

TEST	Analyzed Date	Color	Non-Asbestos		Asbestos	Comment
			Fibrous	Non-Fibrous		
PLM	2/27/2025	White	95.0%	5.0%	None Detected	

Client Sample ID: 18B-Rubber **Lab Sample ID:** 042503429-0061A

Sample Description: FS 5/Fire Hose - Canvas fire hose w/ black rubber interior

TEST	Analyzed Date	Color	Non-Asbestos		Asbestos	Comment
			Fibrous	Non-Fibrous		
PLM	2/27/2025	Black	0.0%	100.0%	None Detected	



EMSL Analytical, Inc.

200 Route 130 North Cinnaminson, NJ 08077
Phone/Fax: (800) 220-3675 / (856) 786-5974
<http://www.EMSL.com> / cinnasblab@EMSL.com

EMSL Order ID: 042503429
Customer ID: BLNL75
Customer PO: 240100
Project ID:

Summary Test Report for Asbestos Analysis of Bulk Material

Client Sample ID: 18C-Canvas **Lab Sample ID:** 042503429-0062

Sample Description: FS 5/Fire Hose - Canvas fire hose w/ black rubber interior

TEST	Analyzed Date	Color	Non-Asbestos		Asbestos	Comment
			Fibrous	Non-Fibrous		
PLM	2/27/2025	White	95.0%	5.0%	None Detected	

Client Sample ID: 18C-Rubber **Lab Sample ID:** 042503429-0062A

Sample Description: FS 5/Fire Hose - Canvas fire hose w/ black rubber interior

TEST	Analyzed Date	Color	Non-Asbestos		Asbestos	Comment
			Fibrous	Non-Fibrous		
PLM	2/27/2025	Black	0.0%	100.0%	None Detected	

Client Sample ID: 19A **Lab Sample ID:** 042503429-0063

Sample Description: FS 12, FS 14/Exterior_Caulk - On metal at roof parapets

TEST	Analyzed Date	Color	Non-Asbestos		Asbestos	Comment
			Fibrous	Non-Fibrous		
PLM	2/27/2025	Gray	0.0%	100.0%	None Detected	

Client Sample ID: 19B **Lab Sample ID:** 042503429-0064

Sample Description: FS 12, FS 14/Exterior_Caulk - On metal at roof parapets

TEST	Analyzed Date	Color	Non-Asbestos		Asbestos	Comment
			Fibrous	Non-Fibrous		
PLM	2/27/2025	Gray	0.0%	100.0%	None Detected	

Client Sample ID: 19C **Lab Sample ID:** 042503429-0065

Sample Description: FS 12, FS 14/Exterior_Caulk - On metal at roof parapets

TEST	Analyzed Date	Color	Non-Asbestos		Asbestos	Comment
			Fibrous	Non-Fibrous		
PLM	2/27/2025	Gray	0.0%	100.0%	None Detected	



EMSL Analytical, Inc.

200 Route 130 North Cinnaminson, NJ 08077
Phone/Fax: (800) 220-3675 / (856) 786-5974
<http://www.EMSL.com> / cinnasblab@EMSL.com

EMSL Order ID:	042503429
Customer ID:	BLNL75
Customer PO:	240100
Project ID:	

Summary Test Report for Asbestos Analysis of Bulk Material

Analyst(s): _____

Tom Hanes PLM (74)

Reviewed and approved by:

Samantha Rundstrom, Laboratory Manager
or Other Approved Signatory

EMSL maintains liability limited to cost of analysis. Interpretation and use of test results are the responsibility of the client. This is a summary report; official reports are available on LabConnect or upon request and relates only to the samples reported above, and may not be reproduced, except in full, without written approval by EMSL. EMSL bears no responsibility for sample collection activities or analytical method limitations. The report reflects the samples as received. Results are generated from the field sampling data (sampling volumes and areas, locations, etc.) provided by the client on the Chain of Custody. Samples are within quality control criteria and met method specifications unless otherwise noted. The above analyses were performed in general compliance with Appendix E to Subpart E of 40 CFR (previously EPA 600/M4-82-020 "Interim Method") but augmented with procedures outlined in the 1993 ("final") version of the method. This report must not be used by the client to claim product certification, approval, or endorsement by NVLAP, NIST or any agency of the federal government. Non-friable organically bound materials present a problem matrix and therefore EMSL recommends gravimetric reduction prior to analysis. Unless requested by the client, building materials manufactured with multiple layers (i.e. linoleum, wallboard, etc.) are reported as a single sample. Estimation of uncertainty is available on request.

Samples analyzed by EMSL Analytical, Inc. Depew, NY NVLAP Lab Code 200056-0

Initial report from: 02/27/2025 15:39:48



Asbestos Bulk Building Materials - Chain of Custody

EMSL Order Number / Lab Use Only

EMSL Analytical, Inc.
200 Route 130 North
Cinnaminson, NJ 08077

EMSL ANALYTICAL, INC.
TESTING LABS • PRODUCTS • TRAINING

#042503429

PHONE (800) 220-3675
EMAIL CinnAsblab@EMSL.com

Customer Information	Customer ID: BLNL75	Billing ID: BLNL75	
	Company Name: Egis	Company Name: Egis	
	Contact Name: Craig Willey	Billing Contact: Ryan Jones	
	Street Address: 48797 Alpha Drive	Street Address: 8320 Craig Street	
	City, State, Zip: Wixom, MI 48393 Country: USA	City, State, Zip: Indianapolis, IN 46250 Country: USA	
	Phone: (248) 863-2934	Phone: (248) 863-2762	
Email(s) for Report: DETROIT-DEMO-EDD-EMPLOYEES.EGIS-US@egis-group.com	Email(s) for Invoice: Ryan.JONES@egis-group.com; Beth.Senn@egis-group.com		

Project Information		Purchase Order	
Project Name/No: IC-009 - 401 Adams/Garage ()		240100-RDA Program	
EMSL LIMS Project ID: (if applicable, EMSL will provide)	US State where samples collected: MICHIGAN	State of Connecticut (CT) must select project location: <input type="checkbox"/> Commercial (Taxable) <input type="checkbox"/> Residential (Non-Taxable)	
Sampled By Name: Andrew Ketchum	Sampled By Signature: <i>[Signature]</i>	Date Sample: 2/21/2025	No. of Samples: 65

Turn-Around-Time (TAT)

72 Hours

Please call ahead for large projects and/or turnaround times 6 Hours or Less. *32 Hour TAT available for select tests only; samples must be submitted by 11:30am.

Test Selection

PLM - Bulk (reporting limit)

PLM EPA 600/R-93/116 (<1%)

TEM - Bulk

Other Tests (please specify)

Point Count all samples ≤1% asbestos
Point Count NOB material samples ≤1% asbestos by PLM EPA
NOB-EPA/600/R-93/116 w/ Gravimetric Reduction (TRL 0.5%)

FedEx # 2856 4326 2876

Positive Stop - Clearly Identified Homogeneous Areas

Sample Number	HA Number	Sample Location	Material Description
1 - A, B, C	CC	EA 1, 2, 3, 4	Concrete - Exterior decorative concrete slabs
2 - A, B, C	CC	EA 1, 2, 3, 4	Concrete - Exterior footing, at base of building
3 - A, B, C	EC	EA 1, 2, 3, 4	Exterior_Caulk - Gray, flexible, at base of decorative concrete and exterior footings
4 - A, B, C	CC	EA 1, 2, 3, 4 & FS 1, FS 2, FS 3, FS 6, FS 8, FS 10, FS 11, FS 12	Concrete - Concrete columns, exterior & interior
5 - A, B, C	EC	EA 4	Exterior_Caulk - Gray, brittle, at short metal doors
6 - A, B, C	EC	EA 1, EA 2	Exterior_Caulk - Gray, flexible. On exterior and interior metal doors and windows
7 - A, B, C	BM	EA 1	Brick_Mortar - Exterior ridged gray brick w/mortar
8 - A, B, C	CC	EA 1	Concrete - Retaining walls

Special Instructions and/or Regulatory Requirements (Sample Specifications, Processing Methods, Limits of Detection, etc.)

Please provide EDD in CSV format

Method of Shipment: Lab Location Depew, NY		Sample Condition Upon Receipt:	
Relinquished by: <i>[Signature]</i>	Date/Time: 02/25/25 1330	Received by:	Date/Time:
Relinquished by:	Date/Time:	Received by:	Date/Time:

RECEIVED

FEB 25 2025

9:22am
Fed-X

BY: *[Signature]*



EMSL Analytical, Inc.

200 Route 130 North Cinnaminson, NJ 08077
Phone/Fax: (800) 220-3675 / (856) 786-5974
<http://www.EMSL.com> / cinnasblab@EMSL.com

EMSL Order ID: 042507186
Customer ID: BLNL75
Customer PO: 240100
Project ID:

Attn: Detroit Project Group
Egis BLN USA Inc
51151 W. Pontiac Trail
Wixom, MI 48393
Phone: (313) 408-4893
Fax:
Collected: 4/14/2025
Received: 4/16/2025
Analyzed: 4/21/2025
Proj: IC-009 - 401 Adams - Garage / RDA Program

Summary Test Report for Asbestos Analysis of Bulk Material

Client Sample ID: 20A **Lab Sample ID:** 042507186-0001

Sample Description: FS 17/Ceiling_Panel - 2x2, White with Grooves

TEST	Analyzed Date	Color	Non-Asbestos		Asbestos	Comment
			Fibrous	Non-Fibrous		
PLM	4/18/2025	Brown/Gray	85.0%	15.0%	None Detected	

Client Sample ID: 20B **Lab Sample ID:** 042507186-0002

Sample Description: FS 17/Ceiling_Panel - 2x2, White with Grooves

TEST	Analyzed Date	Color	Non-Asbestos		Asbestos	Comment
			Fibrous	Non-Fibrous		
PLM	4/18/2025	Brown/Gray	80.0%	20.0%	None Detected	

Client Sample ID: 20C **Lab Sample ID:** 042507186-0003

Sample Description: FS 17/Ceiling_Panel - 2x2, White with Grooves

TEST	Analyzed Date	Color	Non-Asbestos		Asbestos	Comment
			Fibrous	Non-Fibrous		
PLM	4/21/2025	Brown/Gray	75.0%	25.0%	None Detected	

Client Sample ID: 21A **Lab Sample ID:** 042507186-0004

Sample Description: FS 17/Concrete - Office Flooring

TEST	Analyzed Date	Color	Non-Asbestos		Asbestos	Comment
			Fibrous	Non-Fibrous		
PLM	4/18/2025	Gray	0.0%	100.0%	None Detected	

Client Sample ID: 21B **Lab Sample ID:** 042507186-0005

Sample Description: FS 17/Concrete - Office Flooring

TEST	Analyzed Date	Color	Non-Asbestos		Asbestos	Comment
			Fibrous	Non-Fibrous		
PLM	4/18/2025	Gray	0.0%	100.0%	None Detected	

Client Sample ID: 21C **Lab Sample ID:** 042507186-0006

Sample Description: FS 17/Concrete - Office Flooring

TEST	Analyzed Date	Color	Non-Asbestos		Asbestos	Comment
			Fibrous	Non-Fibrous		
PLM	4/21/2025	Gray	0.0%	100.0%	None Detected	

Client Sample ID: 22A- Wall Block **Lab Sample ID:** 042507186-0007

Sample Description: FS 17/Block_Mortar - Interior Wall Block with Mortar

TEST	Analyzed Date	Color	Non-Asbestos		Asbestos	Comment
			Fibrous	Non-Fibrous		
PLM	4/18/2025	Gray	0.0%	100.0%	None Detected	



EMSL Analytical, Inc.

200 Route 130 North Cinnaminson, NJ 08077
Phone/Fax: (800) 220-3675 / (856) 786-5974
<http://www.EMSL.com> / cinnasblab@EMSL.com

EMSL Order ID: 042507186
Customer ID: BLNL75
Customer PO: 240100
Project ID:

Summary Test Report for Asbestos Analysis of Bulk Material

Client Sample ID: 22A- Mortar **Lab Sample ID:** 042507186-0007A

Sample Description: FS 17/Block_Mortar - Interior Wall Block with Mortar

TEST	Analyzed Date	Color	Non-Asbestos		Asbestos	Comment
			Fibrous	Non-Fibrous		
PLM	4/18/2025	Gray	0.0%	100.0%	None Detected	

Client Sample ID: 22B- Wall Block **Lab Sample ID:** 042507186-0008

Sample Description: FS 17/Block_Mortar - Interior Wall Block with Mortar

TEST	Analyzed Date	Color	Non-Asbestos		Asbestos	Comment
			Fibrous	Non-Fibrous		
PLM	4/18/2025	Gray	0.0%	100.0%	None Detected	

Client Sample ID: 22B- Mortar **Lab Sample ID:** 042507186-0008A

Sample Description: FS 17/Block_Mortar - Interior Wall Block with Mortar

TEST	Analyzed Date	Color	Non-Asbestos		Asbestos	Comment
			Fibrous	Non-Fibrous		
PLM	4/18/2025	Gray	0.0%	100.0%	None Detected	

Client Sample ID: 22C- Wall Block **Lab Sample ID:** 042507186-0009

Sample Description: FS 17/Block_Mortar - Interior Wall Block with Mortar

TEST	Analyzed Date	Color	Non-Asbestos		Asbestos	Comment
			Fibrous	Non-Fibrous		
PLM	4/21/2025	Gray	0.0%	100.0%	None Detected	

Client Sample ID: 22C- Mortar **Lab Sample ID:** 042507186-0009A

Sample Description: FS 17/Block_Mortar - Interior Wall Block with Mortar

TEST	Analyzed Date	Color	Non-Asbestos		Asbestos	Comment
			Fibrous	Non-Fibrous		
PLM	4/21/2025	Gray	0.0%	100.0%	None Detected	

Client Sample ID: 23A **Lab Sample ID:** 042507186-0010

Sample Description: FS 17/Concrete - Interior Walls

TEST	Analyzed Date	Color	Non-Asbestos		Asbestos	Comment
			Fibrous	Non-Fibrous		
PLM	4/18/2025	Gray	0.0%	100.0%	None Detected	

Client Sample ID: 23B **Lab Sample ID:** 042507186-0011

Sample Description: FS 17/Concrete - Interior Walls

TEST	Analyzed Date	Color	Non-Asbestos		Asbestos	Comment
			Fibrous	Non-Fibrous		
PLM	4/18/2025	Gray	0.0%	100.0%	None Detected	

Client Sample ID: 23C **Lab Sample ID:** 042507186-0012

Sample Description: FS 17/Concrete - Interior Walls

TEST	Analyzed Date	Color	Non-Asbestos		Asbestos	Comment
			Fibrous	Non-Fibrous		
PLM	4/21/2025	Gray	0.0%	100.0%	None Detected	



EMSL Analytical, Inc.

200 Route 130 North Cinnaminson, NJ 08077
Phone/Fax: (800) 220-3675 / (856) 786-5974
<http://www.EMSL.com> / cinnasblab@EMSL.com

EMSL Order ID: 042507186
Customer ID: BLNL75
Customer PO: 240100
Project ID:

Summary Test Report for Asbestos Analysis of Bulk Material

Client Sample ID: 24A- Transit Panels **Lab Sample ID:** 042507186-0013

Sample Description: FS 17/Transite - Transit Panels with Wall Sheeting

TEST	Analyzed Date	Color	Non-Asbestos		Asbestos	Comment
			Fibrous	Non-Fibrous		
PLM	4/18/2025	Gray/Tan	0.0%	80.0%	20% Chrysotile	

Client Sample ID: 24A- Wall Sheeting **Lab Sample ID:** 042507186-0013A

Sample Description: FS 17/Transite - Transit Panels with Wall Sheeting

TEST	Analyzed Date	Color	Non-Asbestos		Asbestos	Comment
			Fibrous	Non-Fibrous		
PLM	4/18/2025	Brown	65.0%	35.0%	None Detected	

Client Sample ID: 24B- Transit Panels **Lab Sample ID:** 042507186-0014

Sample Description: FS 17/Transite - Transit Panels with Wall Sheeting

TEST	Analyzed Date	Color	Non-Asbestos		Asbestos	Comment
			Fibrous	Non-Fibrous		
PLM	4/21/2025				Positive Stop (Not Analyzed)	

Client Sample ID: 24B- Wall Sheeting **Lab Sample ID:** 042507186-0014A

Sample Description: FS 17/Transite - Transit Panels with Wall Sheeting

TEST	Analyzed Date	Color	Non-Asbestos		Asbestos	Comment
			Fibrous	Non-Fibrous		
PLM	4/18/2025	Brown	65.0%	35.0%	None Detected	

Client Sample ID: 24C- Transit Panels **Lab Sample ID:** 042507186-0015

Sample Description: FS 17/Transite - Transit Panels with Wall Sheeting

TEST	Analyzed Date	Color	Non-Asbestos		Asbestos	Comment
			Fibrous	Non-Fibrous		
PLM	4/21/2025				Positive Stop (Not Analyzed)	

Client Sample ID: 24C- Wall Sheeting **Lab Sample ID:** 042507186-0015A

Sample Description: FS 17/Transite - Transit Panels with Wall Sheeting

TEST	Analyzed Date	Color	Non-Asbestos		Asbestos	Comment
			Fibrous	Non-Fibrous		
PLM	4/21/2025	Brown	65.0%	35.0%	None Detected	

Client Sample ID: 25A **Lab Sample ID:** 042507186-0016

Sample Description: FS 17/Interior_Caulk - Around Windows

TEST	Analyzed Date	Color	Non-Asbestos		Asbestos	Comment
			Fibrous	Non-Fibrous		
PLM	4/18/2025	Silver	0.0%	100.0%	None Detected	

Client Sample ID: 25B **Lab Sample ID:** 042507186-0017

Sample Description: FS 17/Interior_Caulk - Around Windows

TEST	Analyzed Date	Color	Non-Asbestos		Asbestos	Comment
			Fibrous	Non-Fibrous		
PLM	4/18/2025	Silver	0.0%	100.0%	None Detected	



EMSL Analytical, Inc.

200 Route 130 North Cinnaminson, NJ 08077
Phone/Fax: (800) 220-3675 / (856) 786-5974
<http://www.EMSL.com> / cinnasblab@EMSL.com

EMSL Order ID: 042507186
Customer ID: BLNL75
Customer PO: 240100
Project ID:

Summary Test Report for Asbestos Analysis of Bulk Material

Client Sample ID: 25C **Lab Sample ID:** 042507186-0018

Sample Description: FS 17/Interior_Caulk - Around Windows

TEST	Analyzed Date	Color	Non-Asbestos		Asbestos	Comment
			Fibrous	Non-Fibrous		
PLM	4/21/2025	Silver	0.0%	100.0%	None Detected	

Client Sample ID: 26A **Lab Sample ID:** 042507186-0019

Sample Description: FS 16/Concrete - Crawlspace Flooring and Walls

TEST	Analyzed Date	Color	Non-Asbestos		Asbestos	Comment
			Fibrous	Non-Fibrous		
PLM	4/21/2025	Gray	0.0%	100.0%	None Detected	

Client Sample ID: 26B **Lab Sample ID:** 042507186-0020

Sample Description: FS 16/Concrete - Crawlspace Flooring and Walls

TEST	Analyzed Date	Color	Non-Asbestos		Asbestos	Comment
			Fibrous	Non-Fibrous		
PLM	4/21/2025	Gray	0.0%	100.0%	None Detected	

Client Sample ID: 26C **Lab Sample ID:** 042507186-0021

Sample Description: FS 16/Concrete - Crawlspace Flooring and Walls

TEST	Analyzed Date	Color	Non-Asbestos		Asbestos	Comment
			Fibrous	Non-Fibrous		
PLM	4/21/2025	Gray	0.0%	100.0%	None Detected	

Client Sample ID: 27A **Lab Sample ID:** 042507186-0022

Sample Description: FS 16/Penetration-Mud - Around Joints and Electrical Connections

TEST	Analyzed Date	Color	Non-Asbestos		Asbestos	Comment
			Fibrous	Non-Fibrous		
PLM	4/21/2025	Gray/White	0.0%	100.0%	None Detected	

Client Sample ID: 27B **Lab Sample ID:** 042507186-0023

Sample Description: FS 16/Penetration-Mud - Around Joints and Electrical Connections

TEST	Analyzed Date	Color	Non-Asbestos		Asbestos	Comment
			Fibrous	Non-Fibrous		
PLM	4/21/2025	Gray/White	0.0%	100.0%	None Detected	

Client Sample ID: 27C **Lab Sample ID:** 042507186-0024

Sample Description: FS 16/Penetration-Mud - Around Joints and Electrical Connections

TEST	Analyzed Date	Color	Non-Asbestos		Asbestos	Comment
			Fibrous	Non-Fibrous		
PLM	4/21/2025	Gray/White	0.0%	100.0%	None Detected	

Client Sample ID: 28A **Lab Sample ID:** 042507186-0025

Sample Description: FS 20/Concrete - Sky Bridge Flooring

TEST	Analyzed Date	Color	Non-Asbestos		Asbestos	Comment
			Fibrous	Non-Fibrous		
PLM	4/21/2025	Gray	0.0%	100.0%	None Detected	



EMSL Analytical, Inc.

200 Route 130 North Cinnaminson, NJ 08077
Phone/Fax: (800) 220-3675 / (856) 786-5974
<http://www.EMSL.com> / cinnasblab@EMSL.com

EMSL Order ID: 042507186
Customer ID: BLNL75
Customer PO: 240100
Project ID:

Summary Test Report for Asbestos Analysis of Bulk Material

Client Sample ID: 28B **Lab Sample ID:** 042507186-0026

Sample Description: FS 20/Concrete - Sky Bridge Flooring

TEST	Analyzed Date	Color	Non-Asbestos		Asbestos	Comment
			Fibrous	Non-Fibrous		
PLM	4/21/2025	Gray	0.0%	100.0%	None Detected	

Client Sample ID: 28C **Lab Sample ID:** 042507186-0027

Sample Description: FS 20/Concrete - Sky Bridge Flooring

TEST	Analyzed Date	Color	Non-Asbestos		Asbestos	Comment
			Fibrous	Non-Fibrous		
PLM	4/21/2025	Gray	0.0%	100.0%	None Detected	

Client Sample ID: 29A **Lab Sample ID:** 042507186-0028

Sample Description: FS 20/Joint Sealant - in Between Concrete Segments

TEST	Analyzed Date	Color	Non-Asbestos		Asbestos	Comment
			Fibrous	Non-Fibrous		
PLM	4/21/2025	Gray/Beige	70.0%	30.0%	None Detected	

Client Sample ID: 29B **Lab Sample ID:** 042507186-0029

Sample Description: FS 20/Joint Sealant - in Between Concrete Segments

TEST	Analyzed Date	Color	Non-Asbestos		Asbestos	Comment
			Fibrous	Non-Fibrous		
PLM	4/21/2025	Gray/Beige	70.0%	30.0%	None Detected	

Client Sample ID: 29C **Lab Sample ID:** 042507186-0030

Sample Description: FS 20/Joint Sealant - in Between Concrete Segments

TEST	Analyzed Date	Color	Non-Asbestos		Asbestos	Comment
			Fibrous	Non-Fibrous		
PLM	4/21/2025	Gray	70.0%	30.0%	None Detected	

Client Sample ID: 30A- Cove Base **Lab Sample ID:** 042507186-0031

Sample Description: FS 20/Cove_Base - with Adhesive

TEST	Analyzed Date	Color	Non-Asbestos		Asbestos	Comment
			Fibrous	Non-Fibrous		
PLM	4/21/2025	Gray	0.0%	100.0%	None Detected	

Client Sample ID: 30A- Mastic **Lab Sample ID:** 042507186-0031A

Sample Description: FS 20/Cove_Base - with Adhesive

TEST	Analyzed Date	Color	Non-Asbestos		Asbestos	Comment
			Fibrous	Non-Fibrous		
PLM	4/21/2025	Yellow	0.0%	100.0%	None Detected	

Client Sample ID: 30B- Cove Base **Lab Sample ID:** 042507186-0032

Sample Description: FS 20/Cove_Base - with Adhesive

TEST	Analyzed Date	Color	Non-Asbestos		Asbestos	Comment
			Fibrous	Non-Fibrous		
PLM	4/21/2025	Gray	0.0%	100.0%	None Detected	



EMSL Analytical, Inc.

200 Route 130 North Cinnaminson, NJ 08077
Phone/Fax: (800) 220-3675 / (856) 786-5974
<http://www.EMSL.com> / cinnasblab@EMSL.com

EMSL Order ID: 042507186
Customer ID: BLNL75
Customer PO: 240100
Project ID:

Summary Test Report for Asbestos Analysis of Bulk Material

Client Sample ID: 30B- Mastic **Lab Sample ID:** 042507186-0032A

Sample Description: FS 20/Cove_Base - with Adhesive

TEST	Analyzed Date	Color	Non-Asbestos		Asbestos	Comment
			Fibrous	Non-Fibrous		
PLM	4/21/2025	Yellow	0.0%	100.0%	None Detected	

Client Sample ID: 30C- Cove Base **Lab Sample ID:** 042507186-0033

Sample Description: FS 20/Cove_Base - with Adhesive

TEST	Analyzed Date	Color	Non-Asbestos		Asbestos	Comment
			Fibrous	Non-Fibrous		
PLM	4/21/2025	Gray	0.0%	100.0%	None Detected	

Client Sample ID: 30C- Mastic **Lab Sample ID:** 042507186-0033A

Sample Description: FS 20/Cove_Base - with Adhesive

TEST	Analyzed Date	Color	Non-Asbestos		Asbestos	Comment
			Fibrous	Non-Fibrous		
PLM	4/21/2025	Yellow	0.0%	100.0%	None Detected	

Client Sample ID: 31A-Mud **Lab Sample ID:** 042507186-0034

Sample Description: FS 20/Wallboard - with Mud & Tape

TEST	Analyzed Date	Color	Non-Asbestos		Asbestos	Comment
			Fibrous	Non-Fibrous		
PLM	4/21/2025	White	0.0%	100.0%	None Detected	

Client Sample ID: 31A-Wallboard **Lab Sample ID:** 042507186-0034A

Sample Description: FS 20/Wallboard - with Mud & Tape

TEST	Analyzed Date	Color	Non-Asbestos		Asbestos	Comment
			Fibrous	Non-Fibrous		
PLM	4/21/2025	Tan/White	15.0%	85.0%	None Detected	

Client Sample ID: 31B-Mud **Lab Sample ID:** 042507186-0035

Sample Description: FS 20/Wallboard - with Mud & Tape

TEST	Analyzed Date	Color	Non-Asbestos		Asbestos	Comment
			Fibrous	Non-Fibrous		
PLM	4/21/2025	White	0.0%	100.0%	None Detected	

Client Sample ID: 31B-Wallboard **Lab Sample ID:** 042507186-0035A

Sample Description: FS 20/Wallboard - with Mud & Tape

TEST	Analyzed Date	Color	Non-Asbestos		Asbestos	Comment
			Fibrous	Non-Fibrous		
PLM	4/21/2025	Tan/White	15.0%	85.0%	None Detected	

Client Sample ID: 31C-Mud **Lab Sample ID:** 042507186-0036

Sample Description: FS 20/Wallboard - with Mud & Tape

TEST	Analyzed Date	Color	Non-Asbestos		Asbestos	Comment
			Fibrous	Non-Fibrous		
PLM	4/21/2025	White	0.0%	100.0%	None Detected	



EMSL Analytical, Inc.

200 Route 130 North Cinnaminson, NJ 08077
Phone/Fax: (800) 220-3675 / (856) 786-5974
<http://www.EMSL.com> / cinnaslab@EMSL.com

EMSL Order ID: 042507186
Customer ID: BLNL75
Customer PO: 240100
Project ID:

Summary Test Report for Asbestos Analysis of Bulk Material

Client Sample ID: 31C-Wallboard **Lab Sample ID:** 042507186-0036A

Sample Description: FS 20/Wallboard - with Mud & Tape

TEST	Analyzed Date	Color	Non-Asbestos		Asbestos	Comment
			Fibrous	Non-Fibrous		
PLM	4/21/2025	Tan/White	15.0%	85.0%	None Detected	

Client Sample ID: 32A **Lab Sample ID:** 042507186-0037

Sample Description: FS 20/Interior_Caulk - Around Windows

TEST	Analyzed Date	Color	Non-Asbestos		Asbestos	Comment
			Fibrous	Non-Fibrous		
PLM	4/21/2025	White	0.0%	100.0%	None Detected	

Client Sample ID: 32B **Lab Sample ID:** 042507186-0038

Sample Description: FS 20/Interior_Caulk - Around Windows

TEST	Analyzed Date	Color	Non-Asbestos		Asbestos	Comment
			Fibrous	Non-Fibrous		
PLM	4/21/2025	White	0.0%	100.0%	None Detected	

Client Sample ID: 32C **Lab Sample ID:** 042507186-0039

Sample Description: FS 20/Interior_Caulk - Around Windows

TEST	Analyzed Date	Color	Non-Asbestos		Asbestos	Comment
			Fibrous	Non-Fibrous		
PLM	4/21/2025	White	0.0%	100.0%	None Detected	

Client Sample ID: 33A-Rubber Flooring **Lab Sample ID:** 042507186-0040

Sample Description: FS 20/Rubber - Matting on SkyBridge Flooring

TEST	Analyzed Date	Color	Non-Asbestos		Asbestos	Comment
			Fibrous	Non-Fibrous		
PLM	4/21/2025	Black/Blue	0.0%	100.0%	None Detected	

Client Sample ID: 33A-Leveler **Lab Sample ID:** 042507186-0040A

Sample Description: FS 20/Rubber - Matting on SkyBridge Flooring

TEST	Analyzed Date	Color	Non-Asbestos		Asbestos	Comment
			Fibrous	Non-Fibrous		
PLM	4/21/2025	Gray	0.0%	100.0%	None Detected	

Client Sample ID: 33B-Rubber Flooring **Lab Sample ID:** 042507186-0041

Sample Description: FS 20/Rubber - Matting on SkyBridge Flooring

TEST	Analyzed Date	Color	Non-Asbestos		Asbestos	Comment
			Fibrous	Non-Fibrous		
PLM	4/21/2025	Black/Blue	0.0%	100.0%	None Detected	

Client Sample ID: 33B-Leveler **Lab Sample ID:** 042507186-0041A

Sample Description: FS 20/Rubber - Matting on SkyBridge Flooring

TEST	Analyzed Date	Color	Non-Asbestos		Asbestos	Comment
			Fibrous	Non-Fibrous		
PLM	4/21/2025	Gray	0.0%	100.0%	None Detected	



EMSL Analytical, Inc.

200 Route 130 North Cinnaminson, NJ 08077
Phone/Fax: (800) 220-3675 / (856) 786-5974
<http://www.EMSL.com> / cinnasblab@EMSL.com

EMSL Order ID: 042507186
Customer ID: BLNL75
Customer PO: 240100
Project ID:

Summary Test Report for Asbestos Analysis of Bulk Material

Client Sample ID: 33C-Rubber Flooring **Lab Sample ID:** 042507186-0042

Sample Description: FS 20/Rubber - Matting on SkyBridge Flooring

TEST	Analyzed Date	Color	Non-Asbestos		Asbestos	Comment
			Fibrous	Non-Fibrous		
PLM	4/21/2025	Black/Blue	0.0%	100.0%	None Detected	

Client Sample ID: 33C-Leveler **Lab Sample ID:** 042507186-0042A

Sample Description: FS 20/Rubber - Matting on SkyBridge Flooring

TEST	Analyzed Date	Color	Non-Asbestos		Asbestos	Comment
			Fibrous	Non-Fibrous		
PLM	4/21/2025	Gray	0.0%	100.0%	None Detected	

Client Sample ID: 34A **Lab Sample ID:** 042507186-0043

Sample Description: FS 20/Exterior_Caulk - Seam Sealant on Concrete Segments

TEST	Analyzed Date	Color	Non-Asbestos		Asbestos	Comment
			Fibrous	Non-Fibrous		
PLM	4/21/2025	White	0.0%	100.0%	None Detected	

Client Sample ID: 34B **Lab Sample ID:** 042507186-0044

Sample Description: FS 20/Exterior_Caulk - Seam Sealant on Concrete Segments

TEST	Analyzed Date	Color	Non-Asbestos		Asbestos	Comment
			Fibrous	Non-Fibrous		
PLM	4/21/2025	White	0.0%	100.0%	None Detected	

Client Sample ID: 34C **Lab Sample ID:** 042507186-0045

Sample Description: FS 20/Exterior_Caulk - Seam Sealant on Concrete Segments

TEST	Analyzed Date	Color	Non-Asbestos		Asbestos	Comment
			Fibrous	Non-Fibrous		
PLM	4/21/2025	White	0.0%	100.0%	None Detected	

Client Sample ID: 35A **Lab Sample ID:** 042507186-0046

Sample Description: FS 20/Concrete - Foundation Walls - SkyBridge

TEST	Analyzed Date	Color	Non-Asbestos		Asbestos	Comment
			Fibrous	Non-Fibrous		
PLM	4/21/2025	Gray	0.0%	100.0%	None Detected	

Client Sample ID: 35B **Lab Sample ID:** 042507186-0047

Sample Description: FS 20/Concrete - Foundation Walls - SkyBridge

TEST	Analyzed Date	Color	Non-Asbestos		Asbestos	Comment
			Fibrous	Non-Fibrous		
PLM	4/21/2025	Gray	0.0%	100.0%	None Detected	

Client Sample ID: 35C **Lab Sample ID:** 042507186-0048

Sample Description: FS 20/Concrete - Foundation Walls - SkyBridge

TEST	Analyzed Date	Color	Non-Asbestos		Asbestos	Comment
			Fibrous	Non-Fibrous		
PLM	4/21/2025	Gray	0.0%	100.0%	None Detected	



EMSL Analytical, Inc.

200 Route 130 North Cinnaminson, NJ 08077
Phone/Fax: (800) 220-3675 / (856) 786-5974
<http://www.EMSL.com> / cinnasblab@EMSL.com

EMSL Order ID: 042507186
Customer ID: BLNL75
Customer PO: 240100
Project ID:

Summary Test Report for Asbestos Analysis of Bulk Material

Client Sample ID: 36A **Lab Sample ID:** 042507186-0049

Sample Description: FS 20/Concrete - Foundation Walls-SkyBridge bottom Portion

TEST	Analyzed Date	Color	Non-Asbestos		Asbestos	Comment
			Fibrous	Non-Fibrous		
PLM	4/21/2025	Gray	0.0%	100.0%	None Detected	

Client Sample ID: 36B **Lab Sample ID:** 042507186-0050

Sample Description: FS 20/Concrete - Foundation Walls-SkyBridge bottom Portion

TEST	Analyzed Date	Color	Non-Asbestos		Asbestos	Comment
			Fibrous	Non-Fibrous		
PLM	4/21/2025	Gray	0.0%	100.0%	None Detected	

Client Sample ID: 36C **Lab Sample ID:** 042507186-0051

Sample Description: FS 20/Concrete - Foundation Walls-SkyBridge bottom Portion

TEST	Analyzed Date	Color	Non-Asbestos		Asbestos	Comment
			Fibrous	Non-Fibrous		
PLM	4/21/2025	Gray	0.0%	100.0%	None Detected	

Client Sample ID: 37A-Roofing Material 1 **Lab Sample ID:** 042507186-0052

Sample Description: EA 5/Roofing_Material - Flat Roof Materials

TEST	Analyzed Date	Color	Non-Asbestos		Asbestos	Comment
			Fibrous	Non-Fibrous		
PLM	4/21/2025	White/Black	18.0%	82.0%	None Detected	

Client Sample ID: 37A-Roofing Material 2 **Lab Sample ID:** 042507186-0052A

Sample Description: EA 5/Roofing_Material - Flat Roof Materials

TEST	Analyzed Date	Color	Non-Asbestos		Asbestos	Comment
			Fibrous	Non-Fibrous		
PLM	4/21/2025	Brown	75.0%	25.0%	None Detected	

Client Sample ID: 37B-Roofing Material 1 **Lab Sample ID:** 042507186-0053

Sample Description: EA 5/Roofing_Material - Flat Roof Materials

TEST	Analyzed Date	Color	Non-Asbestos		Asbestos	Comment
			Fibrous	Non-Fibrous		
PLM	4/21/2025	Black	0.0%	100.0%	None Detected	

Client Sample ID: 37B-Roofing Material 2 **Lab Sample ID:** 042507186-0053A

Sample Description: EA 5/Roofing_Material - Flat Roof Materials

TEST	Analyzed Date	Color	Non-Asbestos		Asbestos	Comment
			Fibrous	Non-Fibrous		
PLM	4/21/2025	Brown	80.0%	20.0%	None Detected	

Client Sample ID: 37C-Roofing Material 1 **Lab Sample ID:** 042507186-0054

Sample Description: EA 5/Roofing_Material - Flat Roof Materials

TEST	Analyzed Date	Color	Non-Asbestos		Asbestos	Comment
			Fibrous	Non-Fibrous		
PLM	4/21/2025	Black	0.0%	100.0%	None Detected	



EMSL Analytical, Inc.

200 Route 130 North Cinnaminson, NJ 08077
Phone/Fax: (800) 220-3675 / (856) 786-5974
<http://www.EMSL.com> / cinnasblab@EMSL.com

EMSL Order ID: 042507186
Customer ID: BLNL75
Customer PO: 240100
Project ID:

Summary Test Report for Asbestos Analysis of Bulk Material

Client Sample ID: 37C-Roofing Material 2 **Lab Sample ID:** 042507186-0054A

Sample Description: EA 5/Roofing_Material - Flat Roof Materials

TEST	Analyzed Date	Color	Non-Asbestos		Asbestos	Comment
			Fibrous	Non-Fibrous		
PLM	4/21/2025	Brown	80.0%	20.0%	None Detected	

Client Sample ID: 38A **Lab Sample ID:** 042507186-0055

Sample Description: EA 5/Roofing_Material - Flashing

TEST	Analyzed Date	Color	Non-Asbestos		Asbestos	Comment
			Fibrous	Non-Fibrous		
PLM	4/21/2025	Black	0.0%	100.0%	None Detected	

Client Sample ID: 38B **Lab Sample ID:** 042507186-0056

Sample Description: EA 5/Roofing_Material - Flashing

TEST	Analyzed Date	Color	Non-Asbestos		Asbestos	Comment
			Fibrous	Non-Fibrous		
PLM	4/21/2025	Black	0.0%	100.0%	None Detected	

Client Sample ID: 38C **Lab Sample ID:** 042507186-0057

Sample Description: EA 5/Roofing_Material - Flashing

TEST	Analyzed Date	Color	Non-Asbestos		Asbestos	Comment
			Fibrous	Non-Fibrous		
PLM	4/21/2025	Black	0.0%	100.0%	None Detected	

Analyst(s):

Carson Carothers PLM (24)
Nicole Cheramie PLM (49)

Reviewed and approved by:

Samantha Rundstrom, Laboratory Manager
or Other Approved Signatory

EMSL maintains liability limited to cost of analysis. Interpretation and use of test results are the responsibility of the client. This is a summary report; official reports are available on LabConnect or upon request and relates only to the samples reported above, and may not be reproduced, except in full, without written approval by EMSL. EMSL bears no responsibility for sample collection activities or analytical method limitations. The report reflects the samples as received. Results are generated from the field sampling data (sampling volumes and areas, locations, etc.) provided by the client on the Chain of Custody. Samples are within quality control criteria and met method specifications unless otherwise noted. The above analyses were performed in general compliance with Appendix E to Subpart E of 40 CFR (previously EPA 600/M4-82-020 "Interim Method") but augmented with procedures outlined in the 1993 ("final") version of the method. This report must not be used by the client to claim product certification, approval, or endorsement by NVLAP, NIST or any agency of the federal government. Non-friable organically bound materials present a problem matrix and therefore EMSL recommends gravimetric reduction prior to analysis. Unless requested by the client, building materials manufactured with multiple layers (i.e. linoleum, wallboard, etc.) are reported as a single sample. Estimation of uncertainty is available on request.

Samples analyzed by EMSL Analytical, Inc. Carrollton, TX NVLAP Lab Code 600111-0, TX 300456, CO AL-25037

Initial report from: 04/21/2025 18:06:54



Asbestos Bulk Building Materials - Chain of Custody

EMSL Order Number / Lab Use Only

EMSL Analytical, Inc.
200 Route 130 North
Cinnaminson, NJ 08077

EMSL ANALYTICAL, INC.
TESTING LABS • PRODUCTS • TRAINING

PHONE: (800) 220-3675
EMAIL: CinnAsblab@EMSL.com

Customer Information	Customer ID:	BLNL75		Billing Information	Billing ID:	BLNL75			
	Company Name:	Egis			Company Name:	Egis			
	Contact Name:	Craig Willey			Billing Contact:	Ryan Jones			
	Street Address:	48797 Alpha Drive			Street Address:	8320 Craig Street			
	City, State, Zip:	Wixom, MI 48393	Country:		USA	City, State, Zip:	Indianapolis, IN 46250	Country:	USA
	Phone:	(248) 863-2934			Phone:	(248) 863-2762			
Email(s) for Report:	DETROIT-DEMO-EDD-EMPLOYEES.EGIS-US@egis-group.com		Email(s) for Invoice:	Ryan.JONES@egis-group.com; Beth.Senn@egis-group.com					

Project Information				
Project Name/No:	IC-009 - 401 Adams/Garage (#20-38)		Purchase Order:	240100-RDA Program
EMSL LIMS Project ID: (if applicable, EMSL will provide)	US State where samples collected:	State of Connecticut (CT) must select project location:		
	MICHIGAN	<input type="checkbox"/> Commercial (Taxable) <input type="checkbox"/> Residential (Non-Taxable)		
Sampled By Name:	Sampled By Signature:	Date Sample	No. of Samples	
Keith Ventimiglia		4/14/2025	57	

Turn-Around-Time (TAT)

72 Hours

Please call ahead for large projects and/or turnaround times 6 Hours or Less. *32 Hour TAT available for select tests only; samples must be submitted by 11:30am.

Test Selection	
<u>PLM - Bulk (reporting limit)</u> <input checked="" type="checkbox"/> PLM EPA 600/R-93/116 (<1%)	<u>TEM - Bulk</u> Other Tests (please specify) <div style="border: 1px solid black; padding: 5px; margin-top: 5px;"> Point Count all samples ≤1% asbestos Point Count NOB material samples ≤1% asbestos by PLM EPA NOB-EPA/600/R-93/116 w/ Gravimetric Reduction (TRL 0.5%) </div>
FedEx # 79172222270	<input checked="" type="checkbox"/> Positive Stop - Clearly Identified Homogeneous Areas

Sample Number	HA Number	Sample Location	Material Description
20 - A, B, C	CP	FS 17	Ceiling_Panel - 2X2, White with Grooves
21 - A, B, C	CC	FS 17	Concrete - Office Flooring
22 - A, B, C	BM	FS 17	Block_Mortar - Interior Wall Block with Mortar
23 - A, B, C	CC	FS 17	Concrete - Interior walls
24 - A, B, C	TS	FS 17	Transite - Transite panels with Wall Sheeting
25 - A, B, C	IC	FS 17	Interior_Caulk - Around windows
26 - A, B, C	CC	FS 16	Concrete - Crawlspace Flooring and Walls
27 - A, B, C	PM	FS 16	Penetration_Mud - Around joints and electrical connections

Special Instructions and/or Regulatory Requirements (Sample Specifications, Processing Methods, Limits of Detection, etc.)

Please provide EDD in CSV format

Method of Shipment:	Lab Location Cinnaminson, NJ	Sample Condition Upon Receipt:	
Relinquished by:	<i>Craig Willey</i> Date/Time:	Received by:	Date/Time
Relinquished by:	Date/Time:	Received by:	Date/Time



Asbestos Bulk Building Materials - Chain of Custody

EMSL Order Number / Lab Use Only

EMSL Analytical, Inc.
200 Route 130 North
Cinnaminson, NJ 08077

PHONE: (800) 220-3675
EMAIL: CinnAsblab@EMSL.com

EMSL ANALYTICAL, INC.
TESTING LABS • PRODUCTS • TRAINING

Additional Pages of the Chain of Custody are only necessary if needed for additional sample

IC-009 - 401 Adams/Garage ()

Special Instructions and/or Regulatory Requirements (Sample Specifications, Processing Methods, Limits of Detection, etc.)

Sample Number	HA Number	Sample Location	Material Description
28 - A, B, C	CC	FS 20	Concrete - Sky bridge Flooring
29 - A, B, C		FS 20	Joint Sealant - In between Concrete segments
30 - A, B, C	CB	FS 20	Cove_Base - with Adhesive
31 - A, B, C	WB	FS 20	Wallboard - with Mud & Tape
32 - A, B, C	IC	FS 20	Interior_Caulk - Around Windows
33 - A, B, C		FS 20	Rubber - Matting on SkyBridge flooring
34 - A, B, C	EC	FS 20	Exterior_Caulk - Seam Sealant on concrete segments
35 - A, B, C	CC	FS 20	Concrete - Foundation Walls- SkyBridge
36 - A, B, C	CC	FS 20	Concrete - Foundation Walls- SkyBridge bottom portion
37 - A, B, C	RM	EA 5	Roofing_Material - Flat Roof Materials
38 - A, B, C	RM	EA 5	Roofing_Material - Flashing

Method of Shipment:		Sample Condition Upon Receipt:	
Relinquished by: <i>Craig Willey</i>	Date/Time:	Received by:	Date/Time
Relinquished by:	Date/Time:	Received by:	Date/Time

ATTACHMENT 2 – FIGURES

EA3

Adams Street

EA2

EA4

EA1

4th Avenue

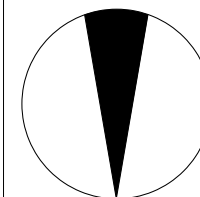
Assumed Materials

Fire Door - Metal: EA1; EA2; EA4; FS4; FS5; FS7; FS8; FS13; FS15

Legend

- Sample location
- ACM Sample location
- ⇒ Ramp direction
- ▨ Functional space inaccessible
- ▧ Staircase

Approximate Building Area 30,000 SF

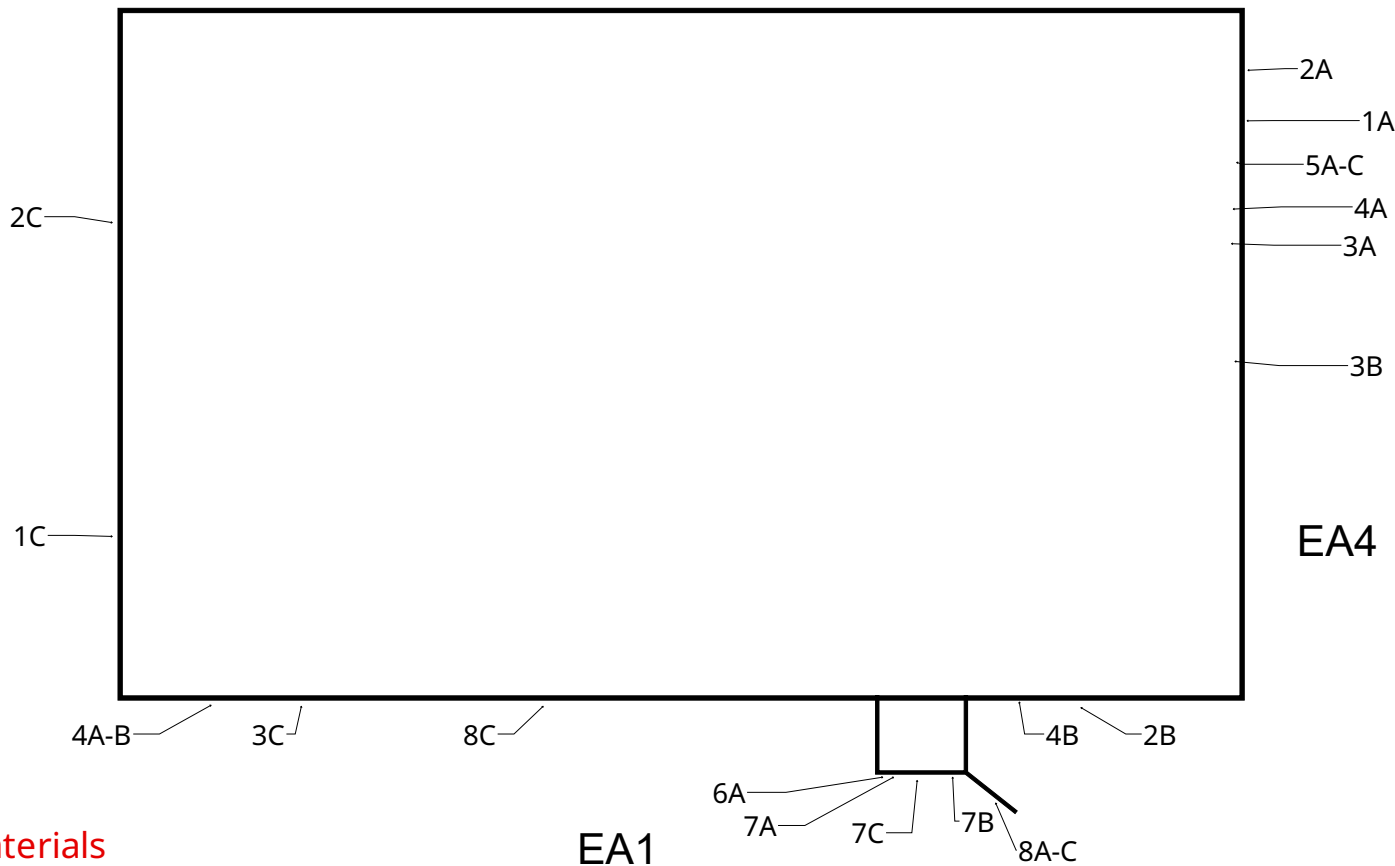


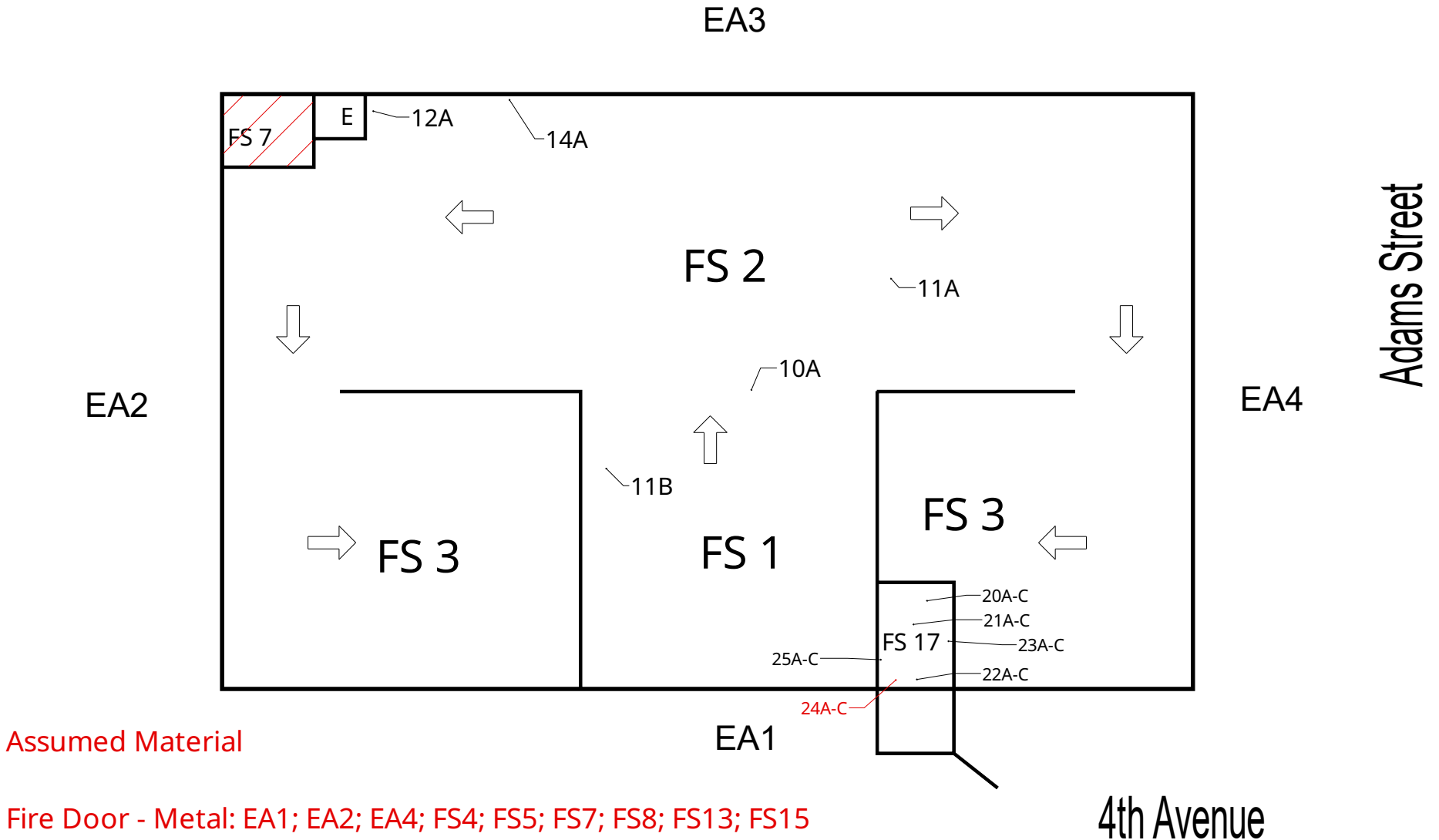
N






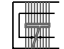

Figure 1 - Exterior
401 Adams Street
Gary, Indiana 46402

DATE: 03/18/25	DRAWN BY: CB	PROJECT NO. 240100
-------------------	-----------------	-----------------------





Legend

-  Sample location
-  ACM Sample location
-  Functional space inaccessible
-  Staircase
-  Ramp Direction

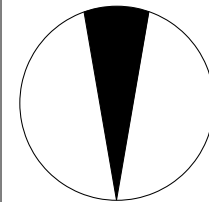
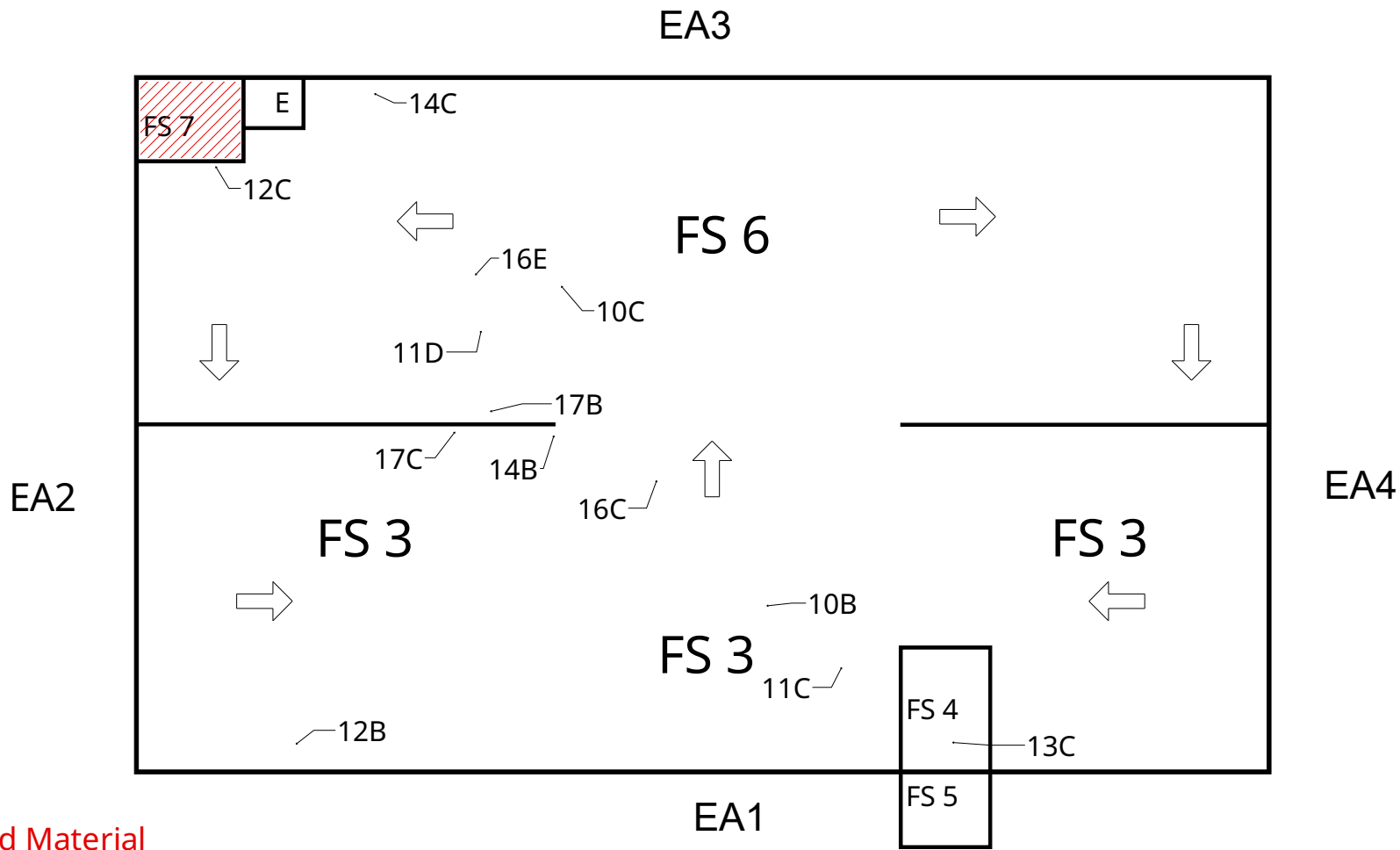


Figure 2 - 1st Floor
401 Adams Street
Gary, Indiana 46402

Approximate Building Area 30,000 SF

N

DATE: 3/18/25	DRAWN BY: CB	PROJECT NO. 240100
------------------	-----------------	-----------------------






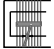

Assumed Material

Fire Door - Metal: EA1; EA2; EA4; FS4; FS5; FS7; FS8; FS13; FS15

4th Avenue

Adams Street

Legend

-  Sample location
-  ACM Sample location
-  Functional space inaccessible
-  Staircase
-  Ramp direction

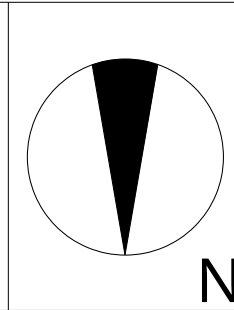


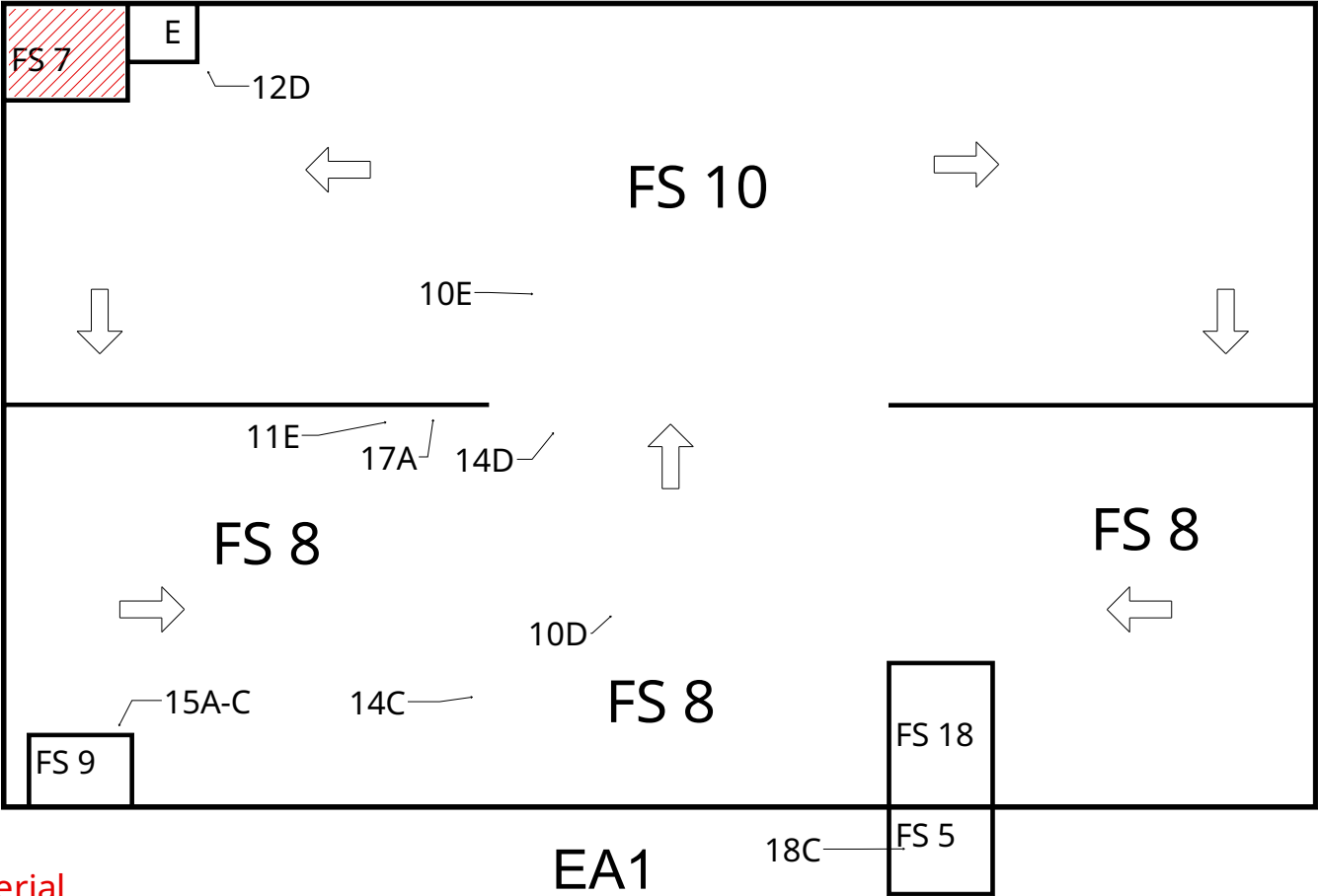
Figure 3 - 2nd Floor
401 Adams Street
Gary, Indiana 46402

Approximate Building Area 30,000 SF

DATE: 03/18/25	DRAWN BY: CB	PROJECT NO. 240100
-------------------	-----------------	-----------------------

EA3

Adams Street



4th Avenue

Assumed Material

Fire Door - Metal: EA1; EA2; EA4; FS4; FS5; FS7; FS8; FS13; FS15

Legend

- Sample location
- ACM Sample location
- Functional space inaccessible
- Staircase
- Ramp direction

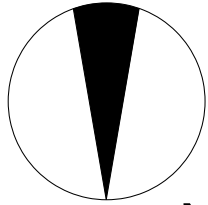
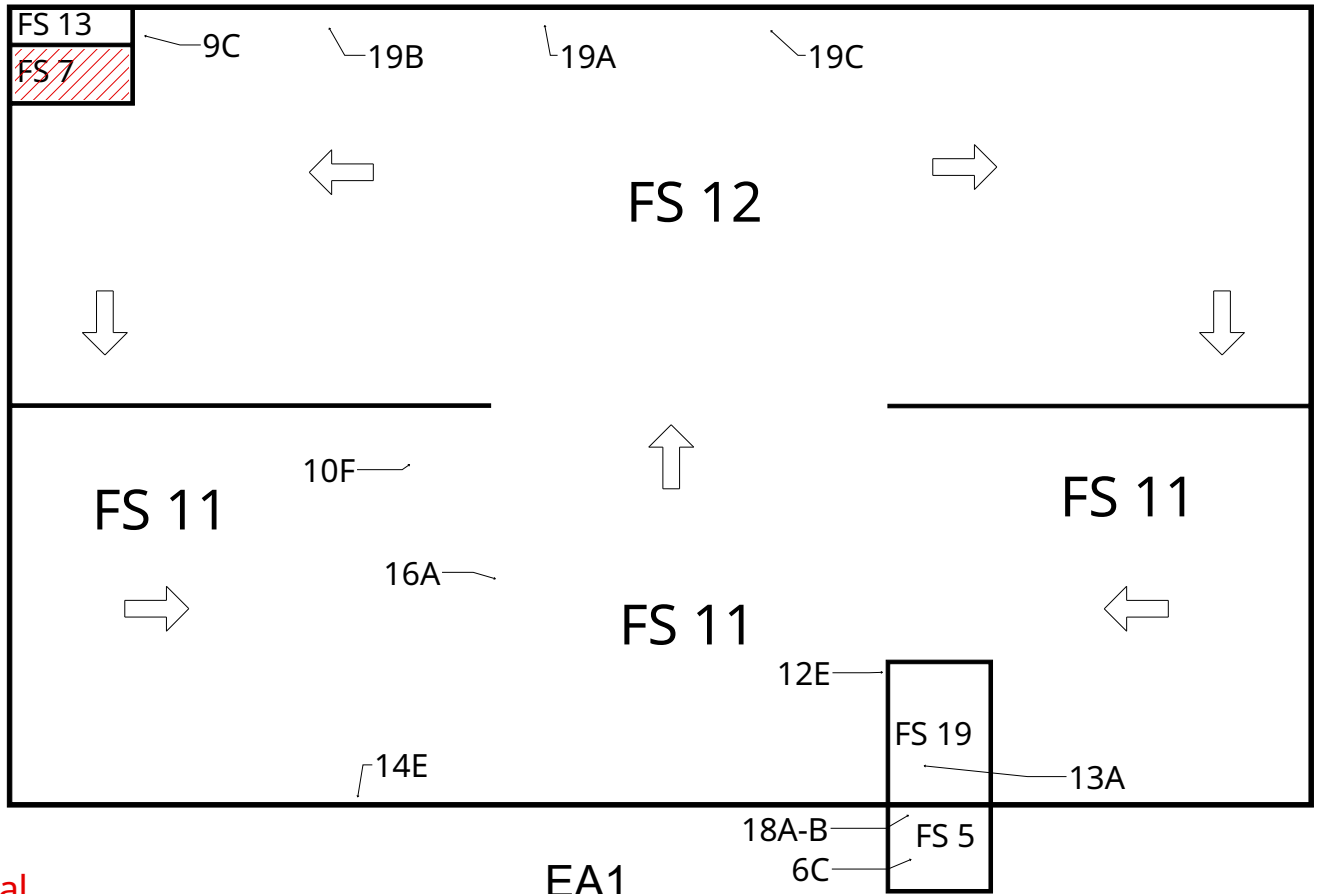


Figure 4 - 3rd Floor
 401 Adams Street
 Gary, Indiana 46402

Approximate Building Area 30,000 SF

DATE: 03/18/25	DRAWN BY: CB	PROJECT NO. 240100
-------------------	-----------------	-----------------------

EA3



Adams Street

EA2

EA4

EA1

4th Avenue

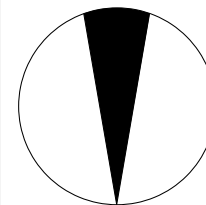
Assumed Material

Fire Door - Metal: EA1; EA2; EA4; FS4; FS5; FS7; FS8; FS13; FS15

Legend

- Sample location
- ACM Sample location
- Functional space inaccessible
- Staircase

Approximate Building Area 30,000 SF

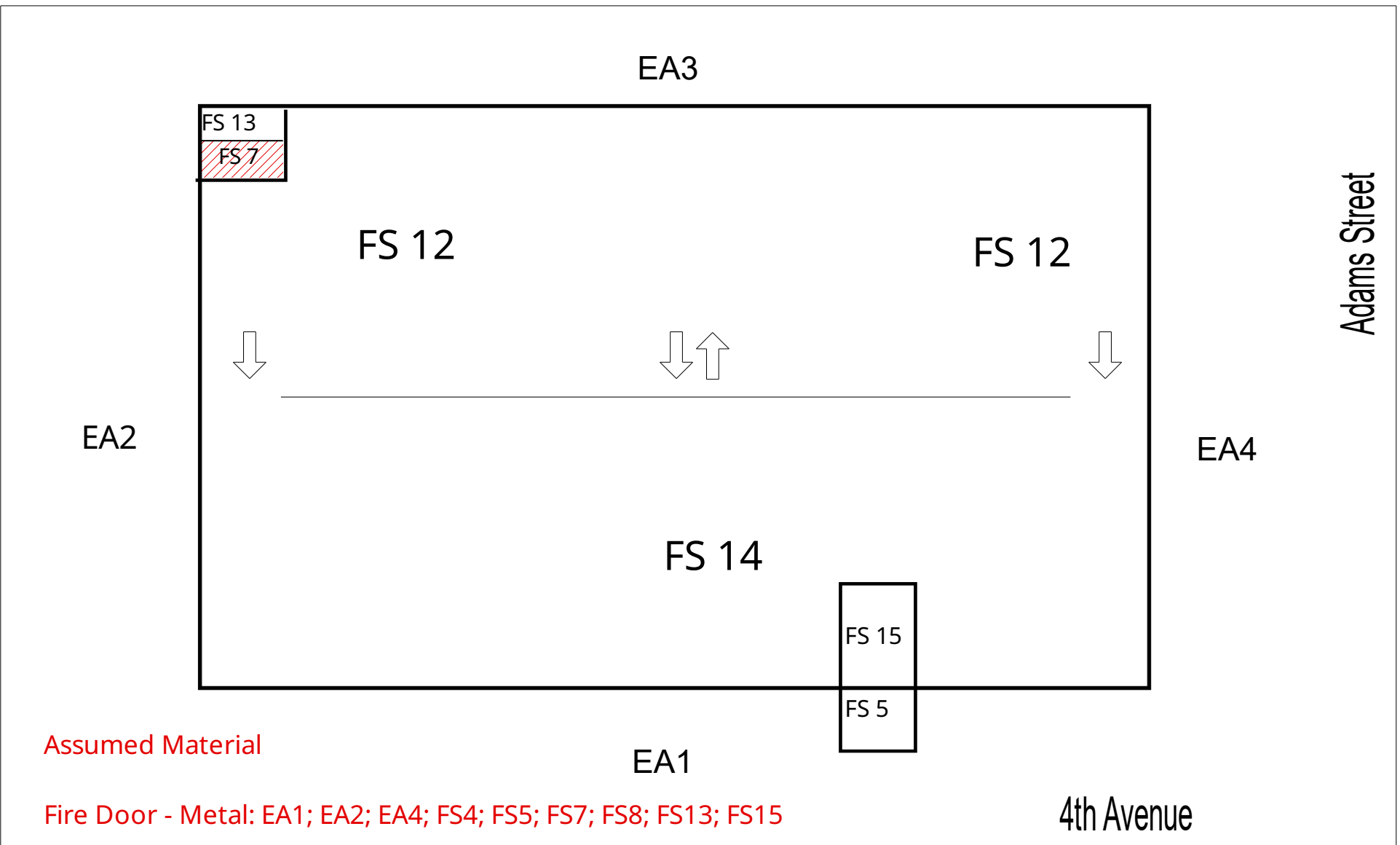


N



Figure 5 - 4th Floor
 401 Adams Street
 Gary, Indiana 46402



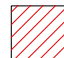
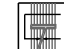
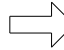
DATE: 03/18/25	DRAWN BY: CB	PROJECT NO. 240100
-------------------	-----------------	-----------------------



Assumed Material

Fire Door - Metal: EA1; EA2; EA4; FS4; FS5; FS7; FS8; FS13; FS15

Legend

-  Sample location
-  ACM Sample location
-  Functional space inaccessible
-  Staircase
-  Ramp Direction

Approximate Building Area 30,000 SF

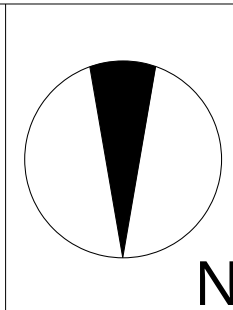
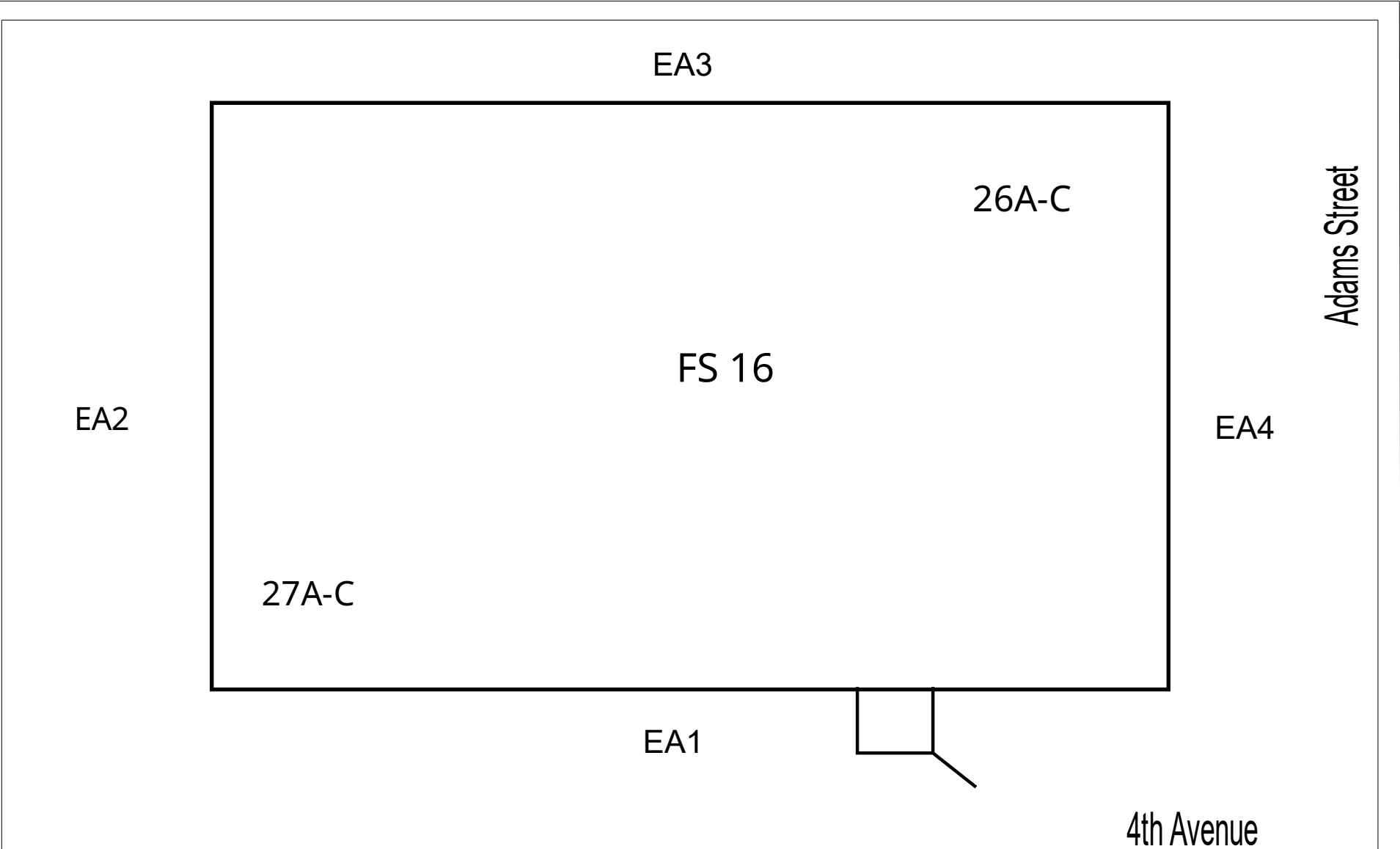

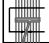


Figure 6 - Roof
401 Adams Street
Gary, Indiana 46402

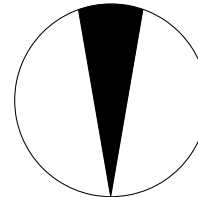
DATE: 03/18/25	DRAWN BY: CB	PROJECT NO. 240100
-------------------	-----------------	-----------------------



Legend

- Sample location
- ACM Sample location
-  Functional space inaccessible
-  Staircase

Approximate Building Area 30,000 SF



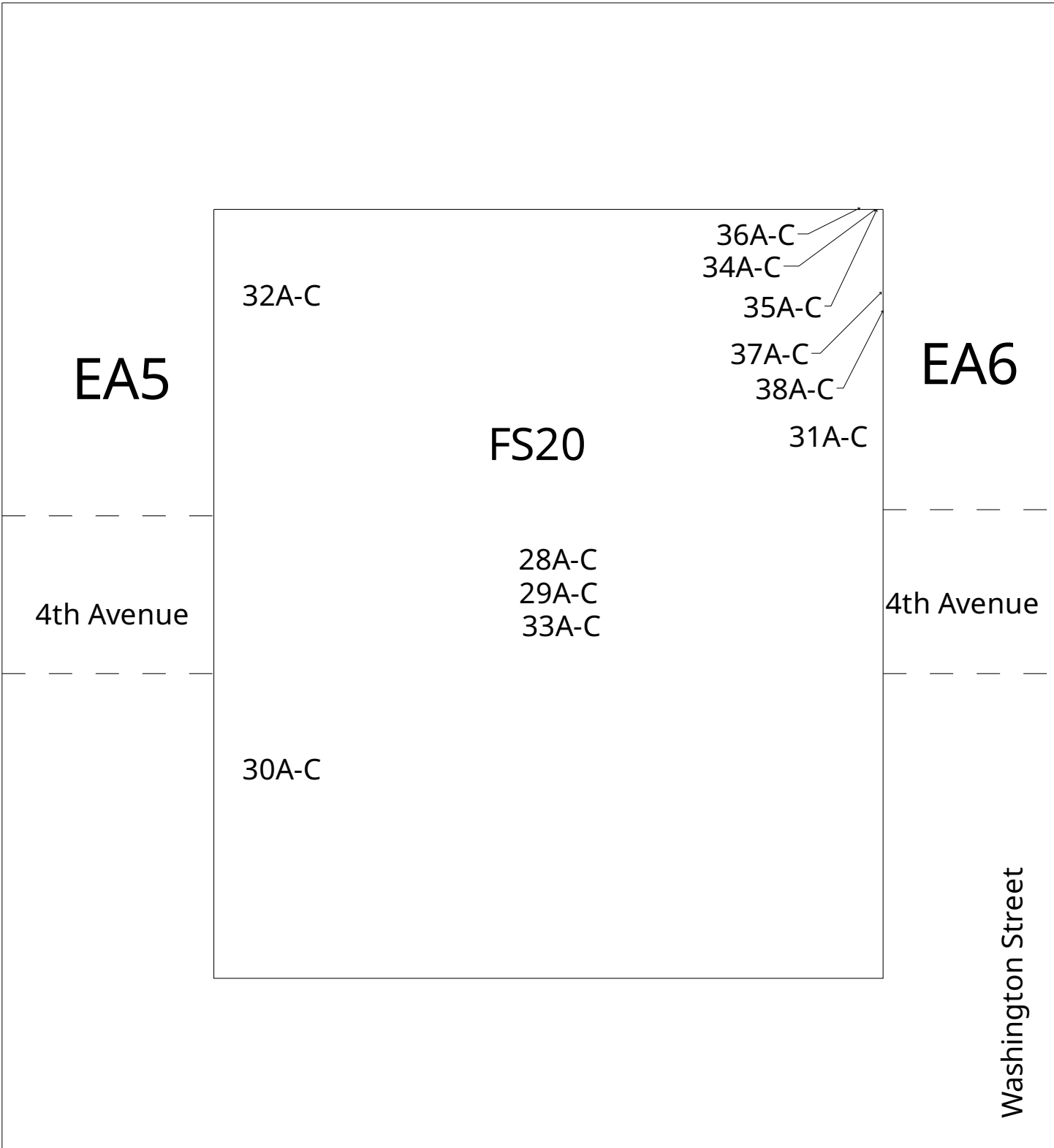
N

4th Avenue

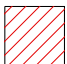
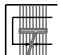



Figure 7 - Crawlspace
401 Adams Street
Gary, Indiana 46402

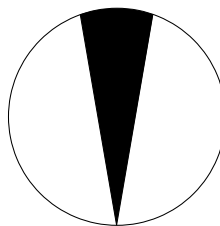
DATE: 03/18/25	DRAWN BY: CB	PROJECT NO. 240100
-------------------	-----------------	-----------------------



Legend

- Sample location
- ACM Sample location
-  Functional space inaccessible
-   Staircase

Approximate Building Area 3,080 SF



N



Figure 8 - Sky Bridge
401 Adams Street
Gary, Indiana 46402

DATE:
03/18/25

DRAWN BY:
CB

PROJECT NO.
240100

ATTACHMENT 3 – PHOTOGRAPHIC LOG

City of Gary Commercial Blight Elimination Program Exterior & Functional Spaces

401 Adams Street (Garage) Gary, IN



EA-1 Front



EA-1 (B) Front



EA-2 Left Side



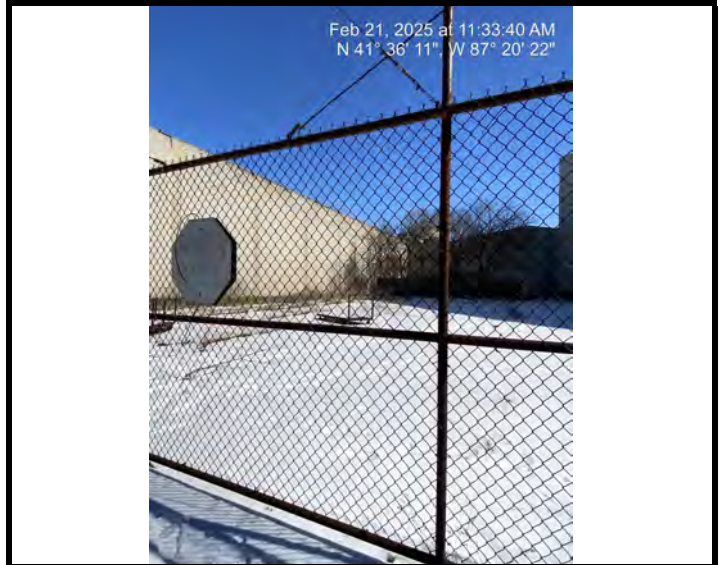
EA-2 (B) Left Side

City of Gary Commercial Blight Elimination Program
Exterior & Functional Spaces

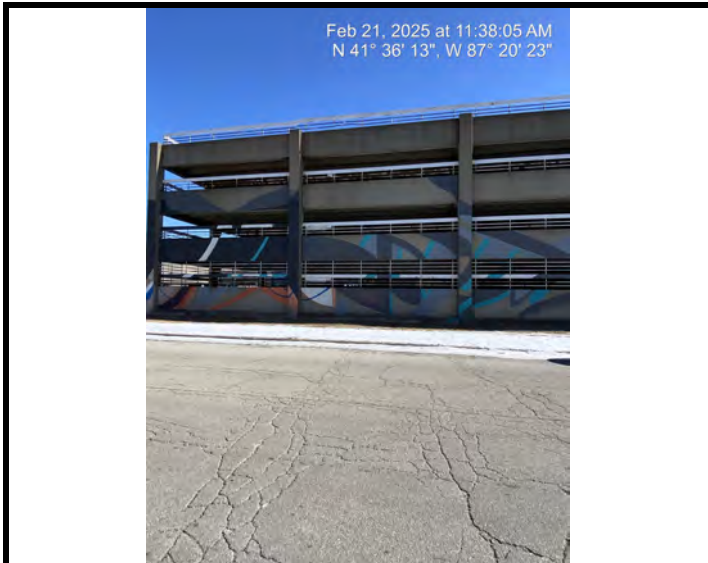
401 Adams Street (Garage) Gary, IN



EA-3 Rear



EA-3 (B) Rear



EA-4 Right Side



EA-4 (B) Right Side

City of Gary Commercial Blight Elimination Program Exterior & Functional Spaces

401 Adams Street (Garage) Gary, IN



FS-1 1st Floor



FS-1 (B) 1st Floor



FS-1 (C) 1st Floor



FS-2 1st Floor

City of Gary Commercial Blight Elimination Program
Exterior & Functional Spaces

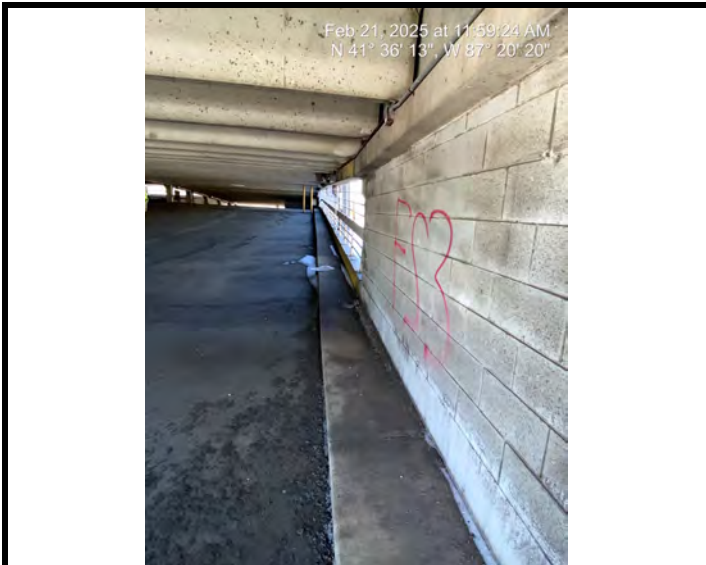
401 Adams Street (Garage) Gary, IN



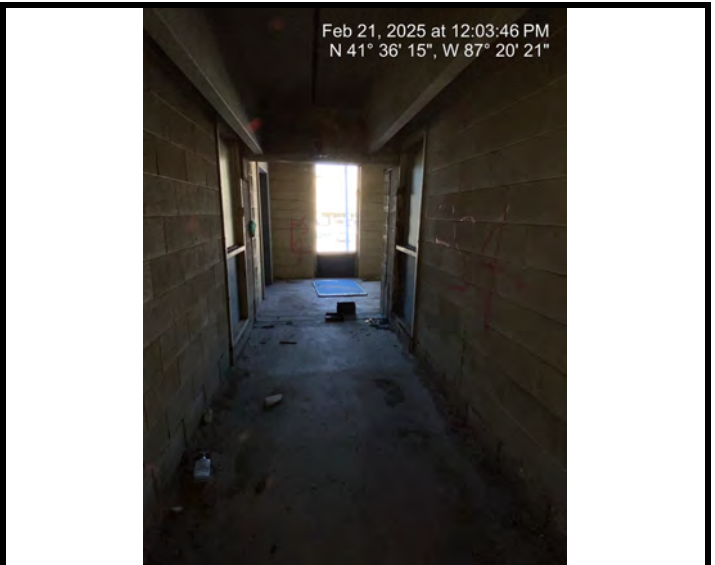
FS-2 (B) 1st Floor



FS-3 1st Floor



FS-3 (B) 1st Floor



FS-4 2nd Floor

**City of Gary Commercial Blight Elimination Program
Exterior & Functional Spaces**

401 Adams Street (Garage) Gary, IN



FS-5 Staricase



FS-5 (B) Staricase



FS-6 2nd Floor



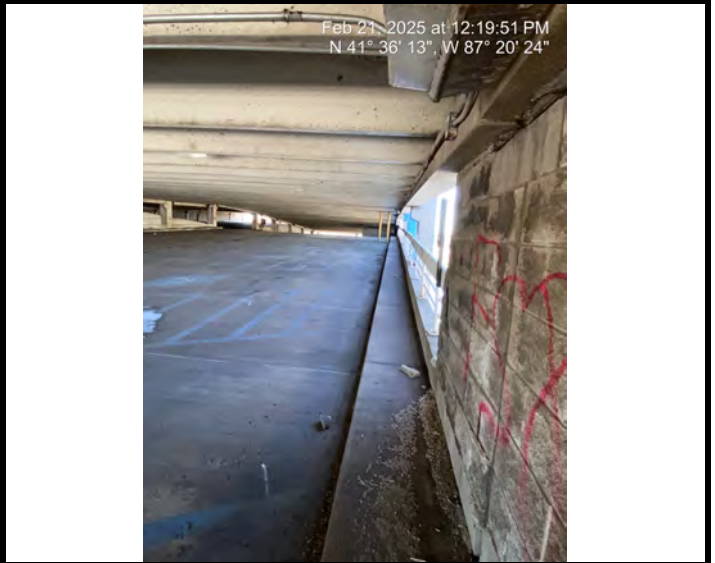
FS-6 (B) 2nd Floor

City of Gary Commercial Blight Elimination Program
Exterior & Functional Spaces

401 Adams Street (Garage) Gary, IN



FS-7 Elevator



FS-8 3rd Floor



FS-8 (B) 3rd Floor



FS-9 3rd Floor

City of Gary Commercial Blight Elimination Program Exterior & Functional Spaces

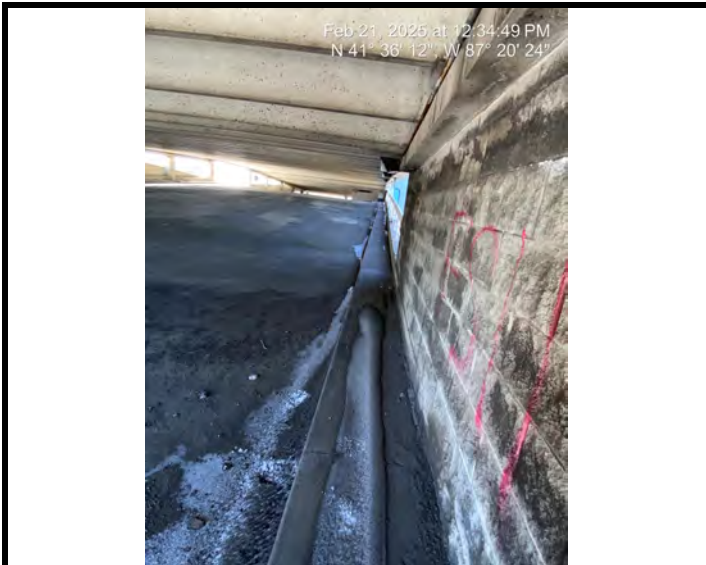
401 Adams Street (Garage) Gary, IN



FS-10 3rd Floor



FS-10 (B) 3rd Floor



FS-11 4th Floor



FS-12 4th Floor

City of Gary Commercial Blight Elimination Program Exterior & Functional Spaces

401 Adams Street (Garage) Gary, IN



FS-12 (B) 4th Floor



FS-13 4th Floor



FS-14 Roof



FS-14 (B) Roof

City of Gary Commercial Blight Elimination Program
Exterior & Functional Spaces

401 Adams Street (Garage) Gary, IN



FS-15 Roof



FS-16 Crawlspace



FS-16 (B) Crawlspace



FS-16 (C) Crawlspace

City of Gary Commercial Blight Elimination Program
Exterior & Functional Spaces

401 Adams Street (Garage) Gary, IN



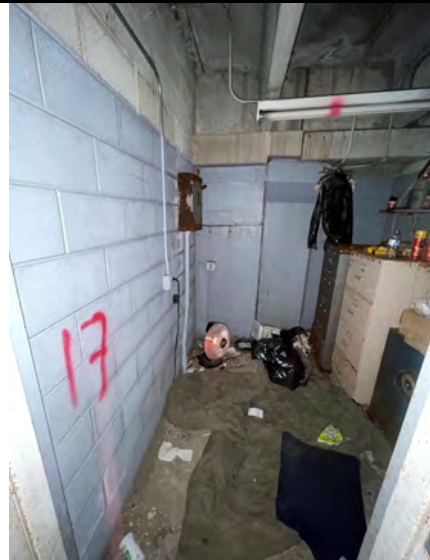
FS-17 1st Floor



FS-17 (B) 1st Floor



FS-17 (C) 1st Floor



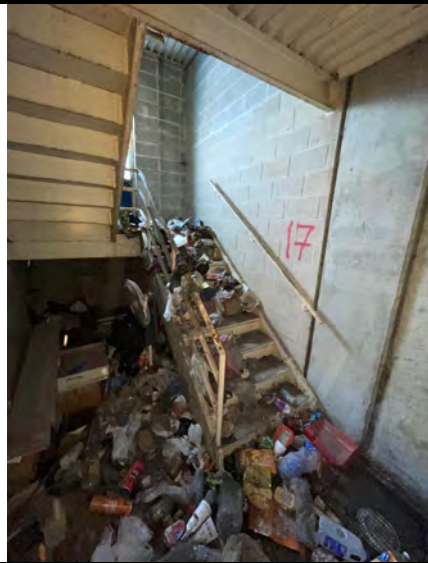
FS-17 (D) 1st Floor

**City of Gary Commercial Blight Elimination Program
Exterior & Functional Spaces**

401 Adams Street (Garage) Gary, IN



FS-17 (E) 1st Floor



FS-17 (F) 1st Floor



FS-18 3rd Floor



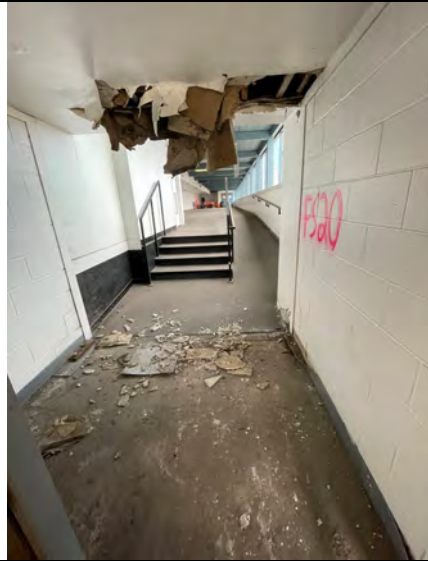
FS-19 4th Floor

**City of Gary Commercial Blight Elimination Program
Exterior & Functional Spaces**

401 Adams Street (Garage) Gary, IN



FS-20 Sky Bridge



FS-20 (B) Sky Bridge

City of Gary Commercial Blight Elimination Program Asbestos Containing Samples

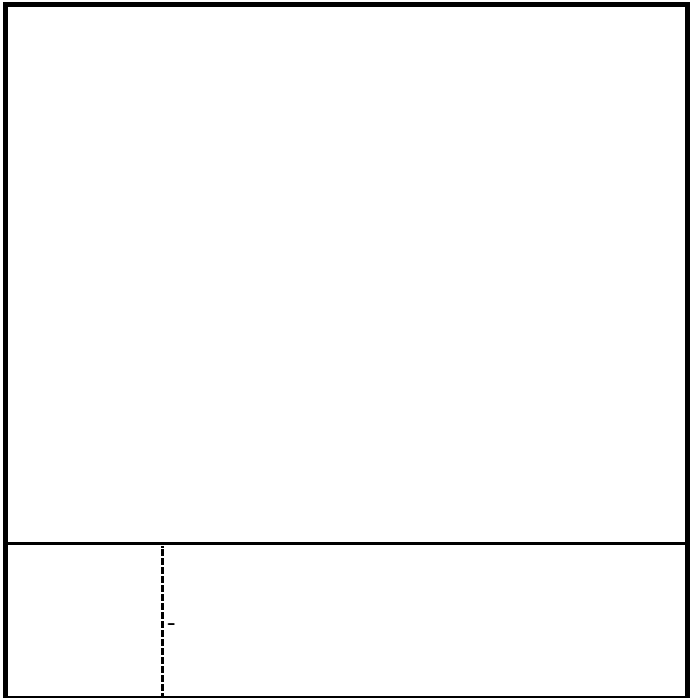
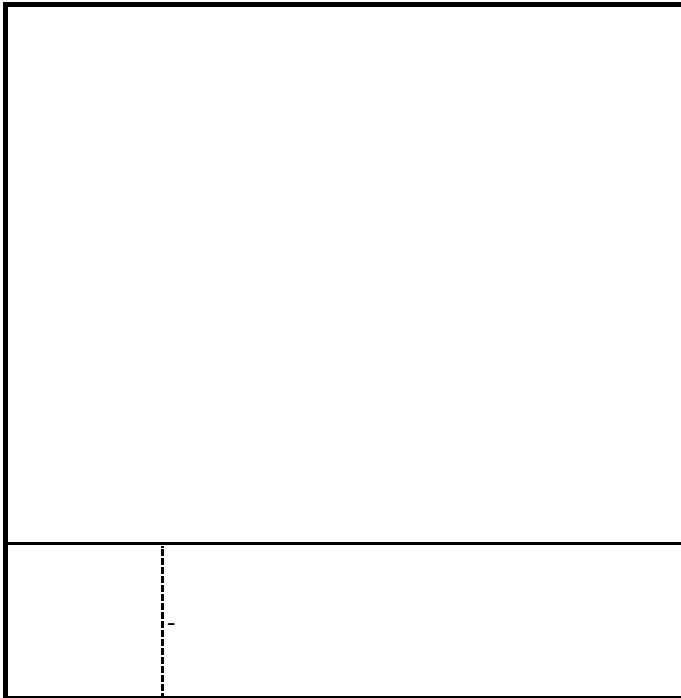
401 Adams Street (Garage) Gary, IN



Sample #24 | Transite - Transite panels with Wall Sheeting

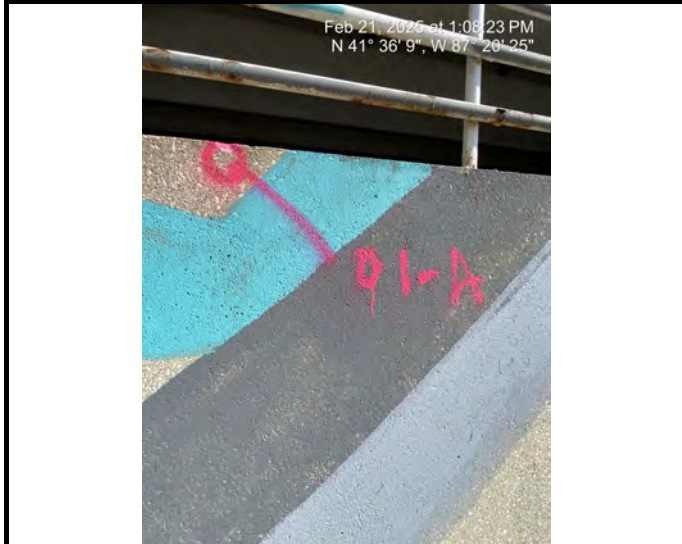


Assumed Material # A-1 | Fire Door - Metal



Gary Commercial Blight Elimination Program Non-Detect Samples

401 Adams Street (Garage) Gary, IN



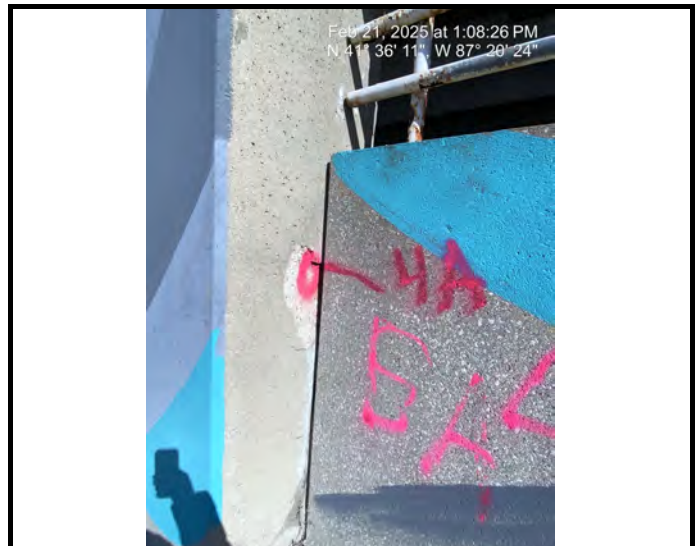
Sample #1 Concrete - Exterior decorative concrete slabs



Sample #2 Concrete - Exterior footing, at base of building



Sample #3 Exterior Caulk - Gray, flexible, at base of decorative concrete and exterior footings



Sample #4 Concrete - Concrete columns, exterior & interior

Gary Commercial Blight Elimination Program Non-Detect Samples

401 Adams Street (Garage) Gary, IN



Sample #5 Exterior Caulk - Gray, brittle, at short metal doors



Sample #6 Exterior Caulk - Gray, flexible. On exterior and interior metal doors and windows



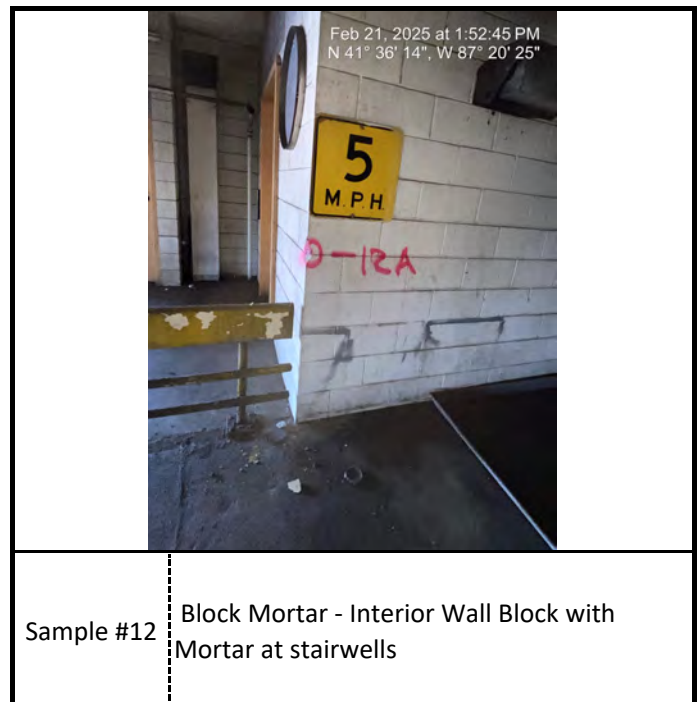
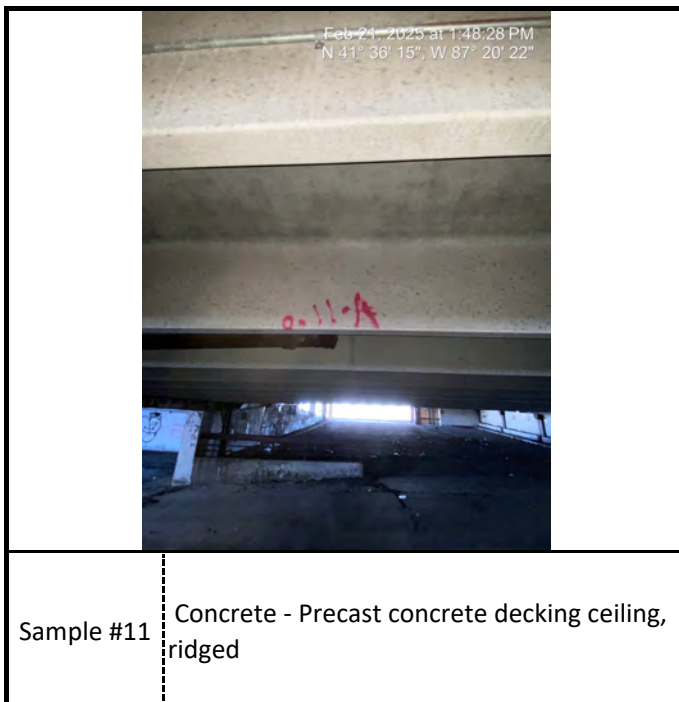
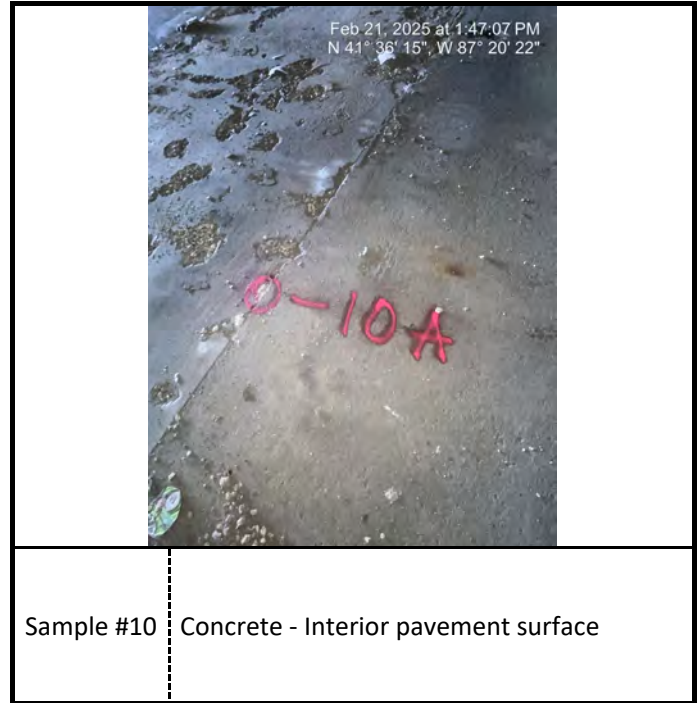
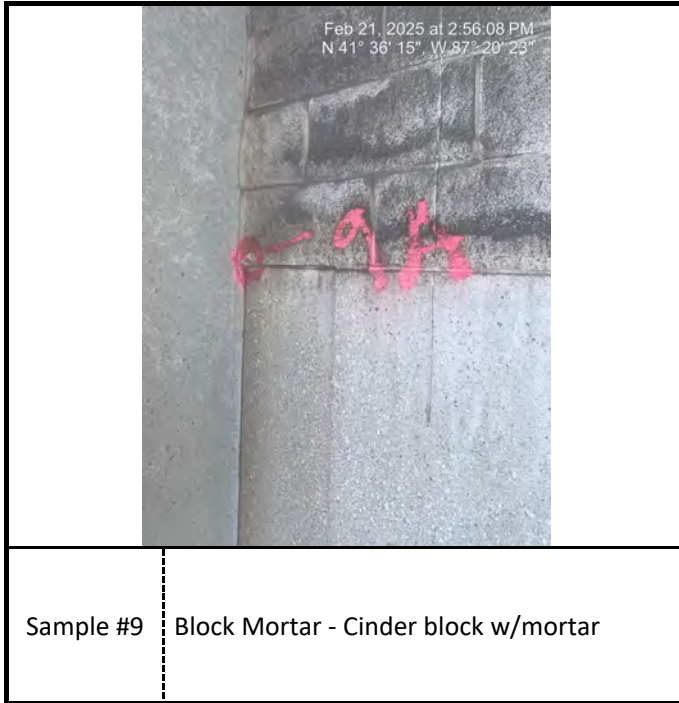
Sample #7 Brick Mortar - Exterior ridged gray brick w/mortar



Sample #8 Concrete - Retaining walls

Gary Commercial Blight Elimination Program Non-Detect Samples

401 Adams Street (Garage) Gary, IN



Gary Commercial Blight Elimination Program Non-Detect Samples

401 Adams Street (Garage) Gary, IN



Sample #13 Ceiling Panel - 2X2, white, pinholes & fissures



Sample #14 Concrete - Parking garage interior curbs



Sample #15 Wallboard - with Mud



Sample #16 Interior Caulk - Gray, used as expansion joint in concrete paving

Gary Commercial Blight Elimination Program Non-Detect Samples

401 Adams Street (Garage) Gary, IN



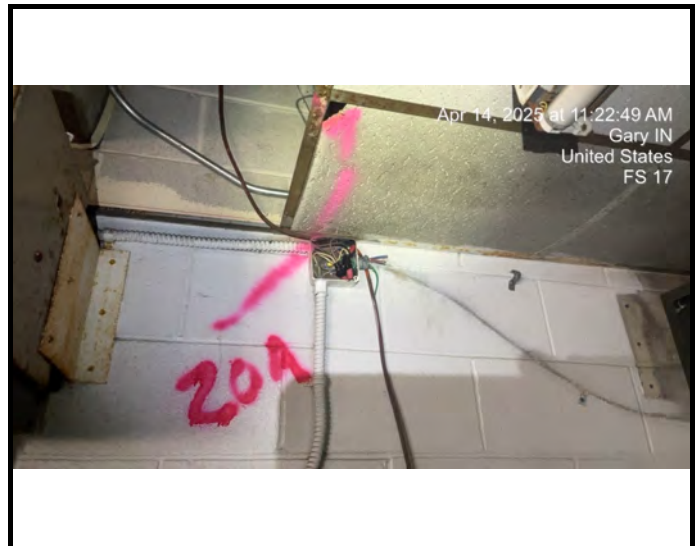
Sample #17 Heat Shield - Light Fixtures, along interior center wall



Sample #18 Fire Hose - Canvas fire hose w/ black rubber interior



Sample #19 Exterior Caulk - On metal at roof parapets



Sample #20 Ceiling Panel - 2X2, White with Grooves

Gary Commercial Blight Elimination Program Non-Detect Samples

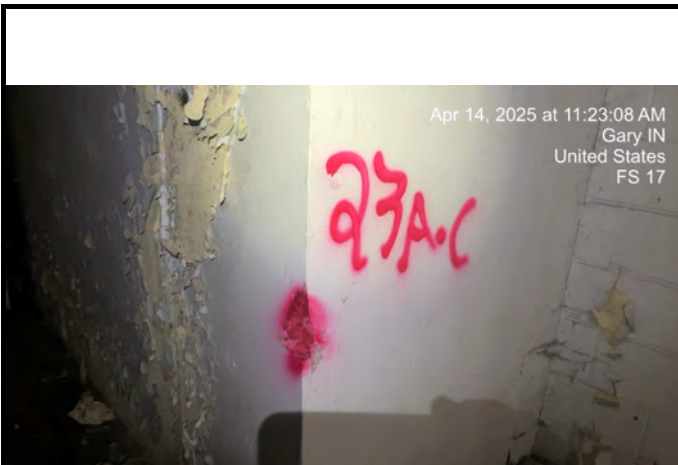
401 Adams Street (Garage) Gary, IN



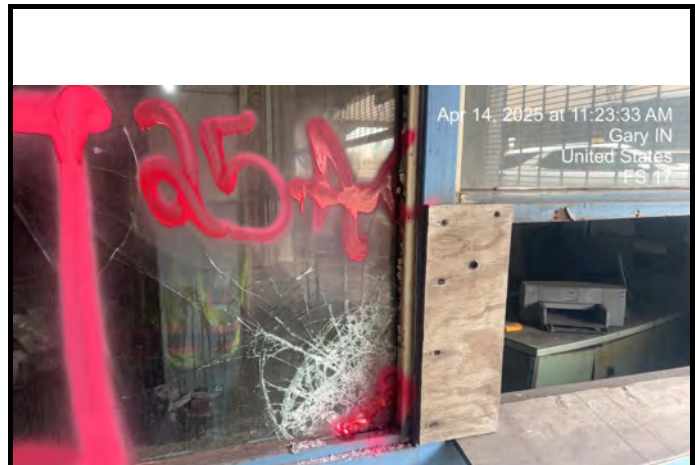
Sample #21 Concrete - Office Flooring



Sample #22 Block Mortar - Interior Wall Block with Mortar



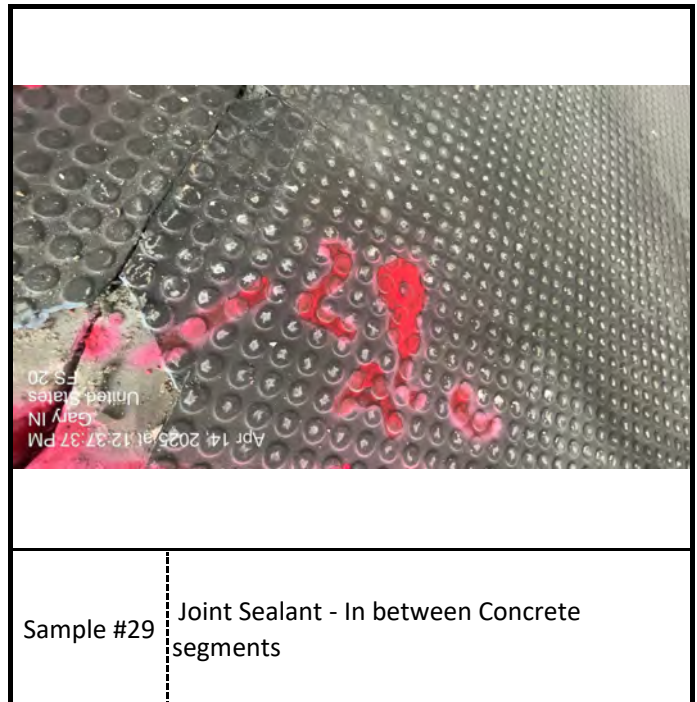
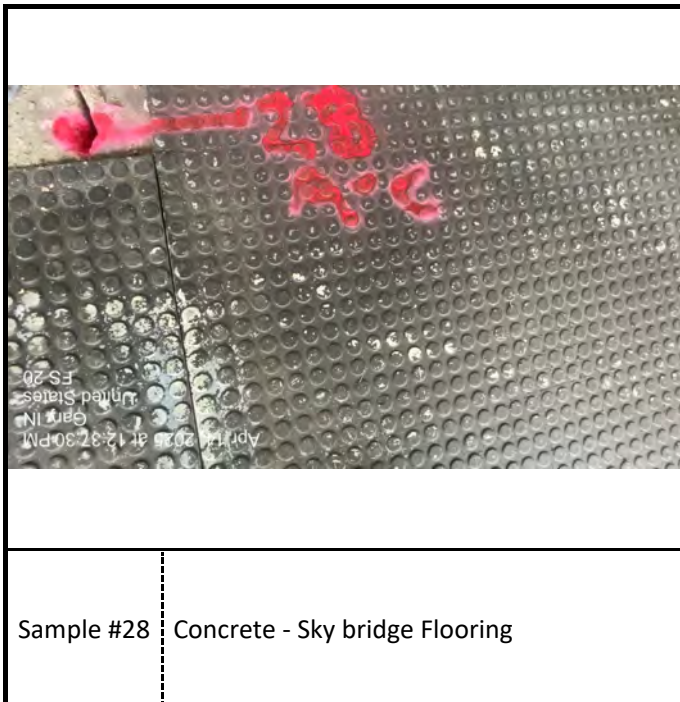
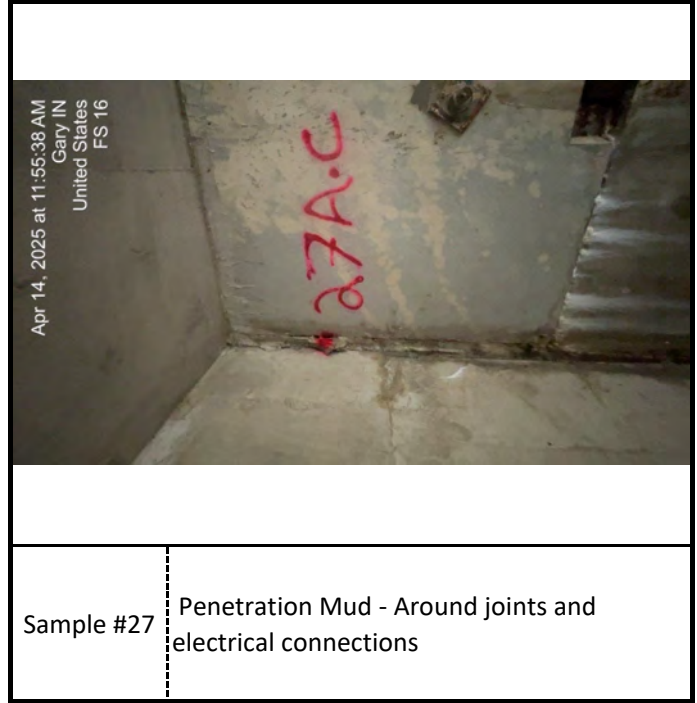
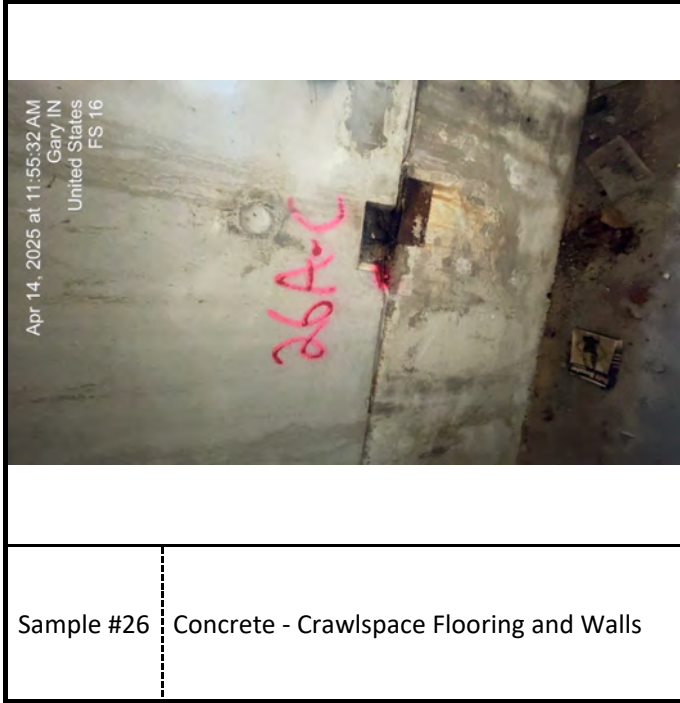
Sample #23 Concrete - Interior walls



Sample #25 Interior Caulk - Around windows

Gary Commercial Blight Elimination Program Non-Detect Samples

401 Adams Street (Garage) Gary, IN

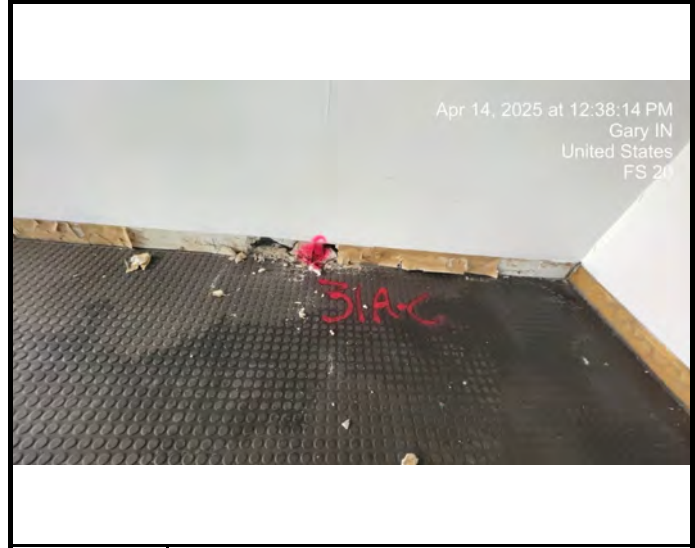


Gary Commercial Blight Elimination Program Non-Detect Samples

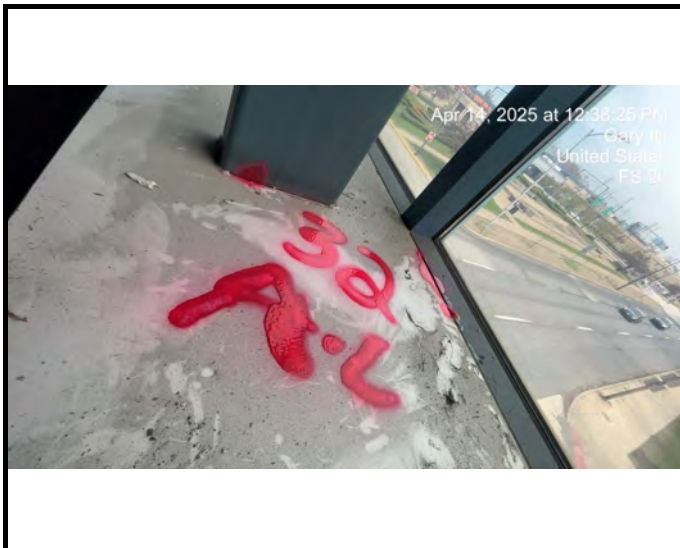
401 Adams Street (Garage) Gary, IN



Sample #30 Cove Base - with Adhesive



Sample #31 Wallboard - with Mud & Tape



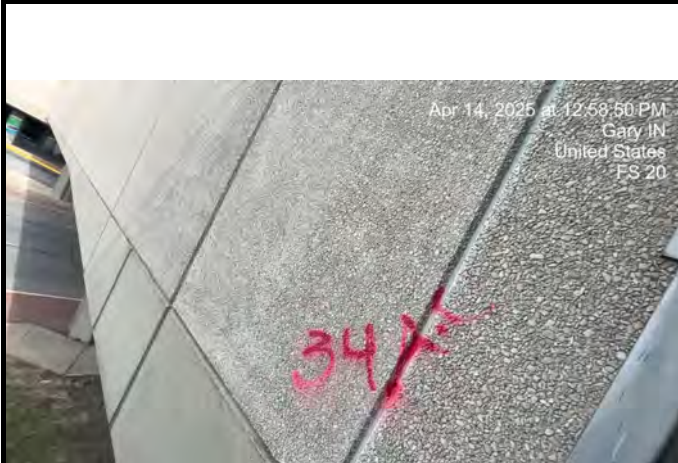
Sample #32 Interior Caulk - Around Windows



Sample #33 Rubber - Matting on SkyBridge flooring

Gary Commercial Blight Elimination Program Non-Detect Samples

401 Adams Street (Garage) Gary, IN



Sample #34 Exterior Caulk - Seam Sealant on concrete segments



Sample #35 Concrete - Foundation Walls- SkyBridge



Sample #36 Concrete - Foundation Walls- SkyBridge bottom portion



Sample #37 Roofing Material - Flat Roof Materials

**Gary Commercial Blight Elimination Program
Non-Detect Samples**

401 Adams Street (Garage) Gary, IN



Sample #38 | Roofing Material - Flashing

