

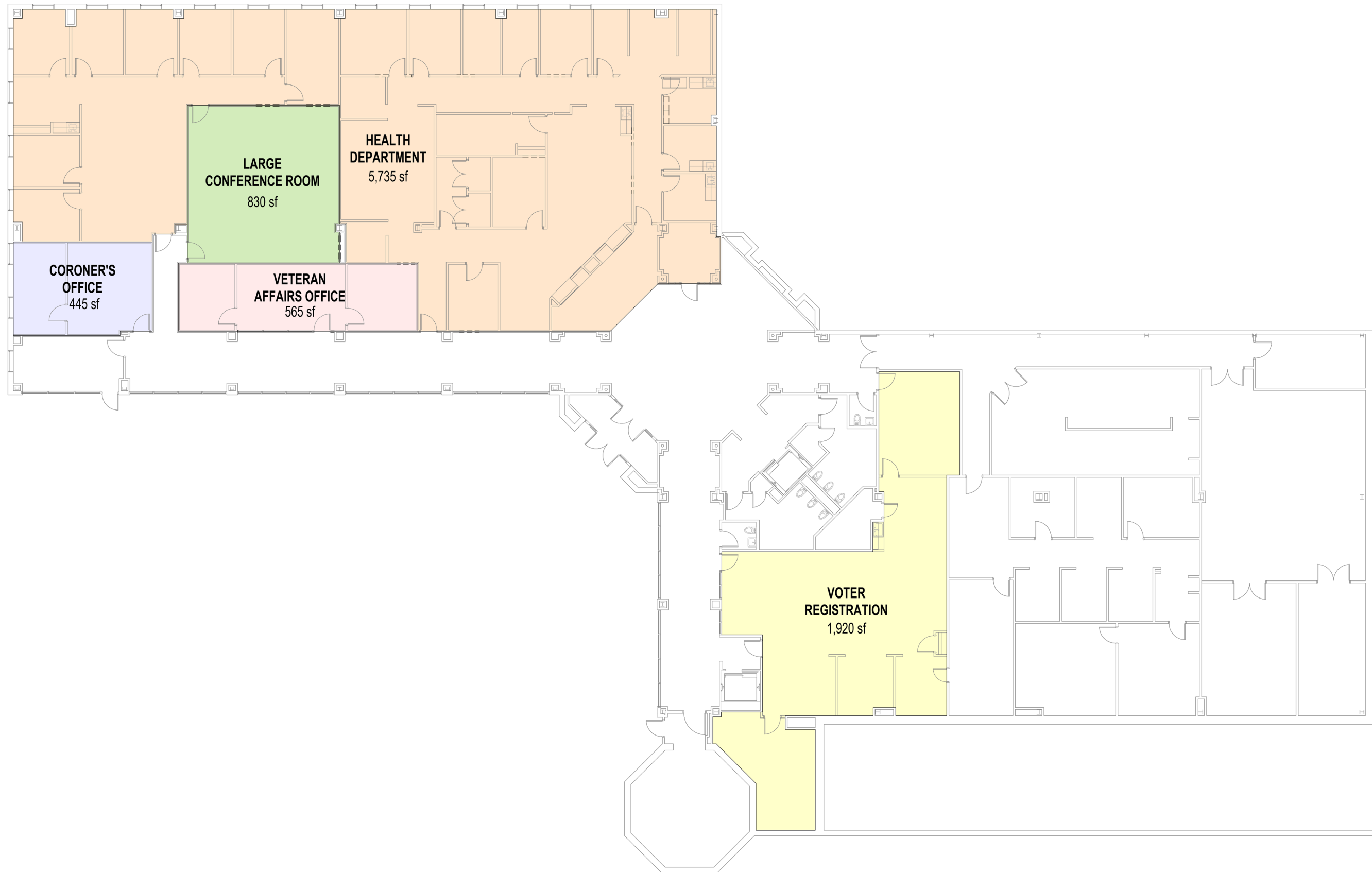

EXISTING LOWER LEVEL SPACE PLAN

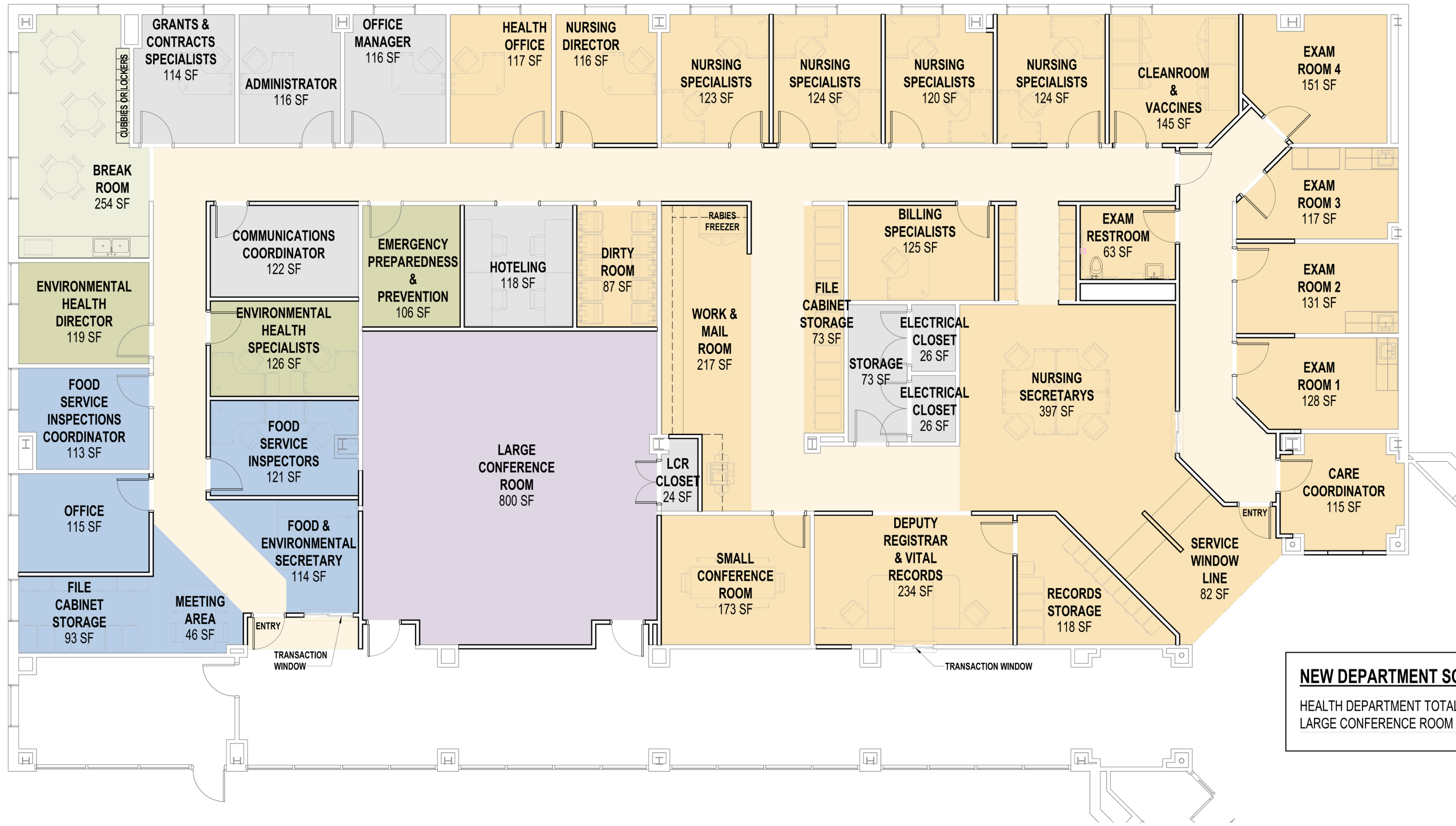

PROPOSED HEALTH DEPARTMENT FLOOR PLAN



NEW DEPARTMENT SQUARE FOOTAGE
 HEALTH DEPARTMENT TOTAL - 6,813 sf
 LARGE CONFERENCE ROOM - 824 SF

PROPOSED VETERAN SERVICES AND CORONER OFFICE FLOOR PLAN

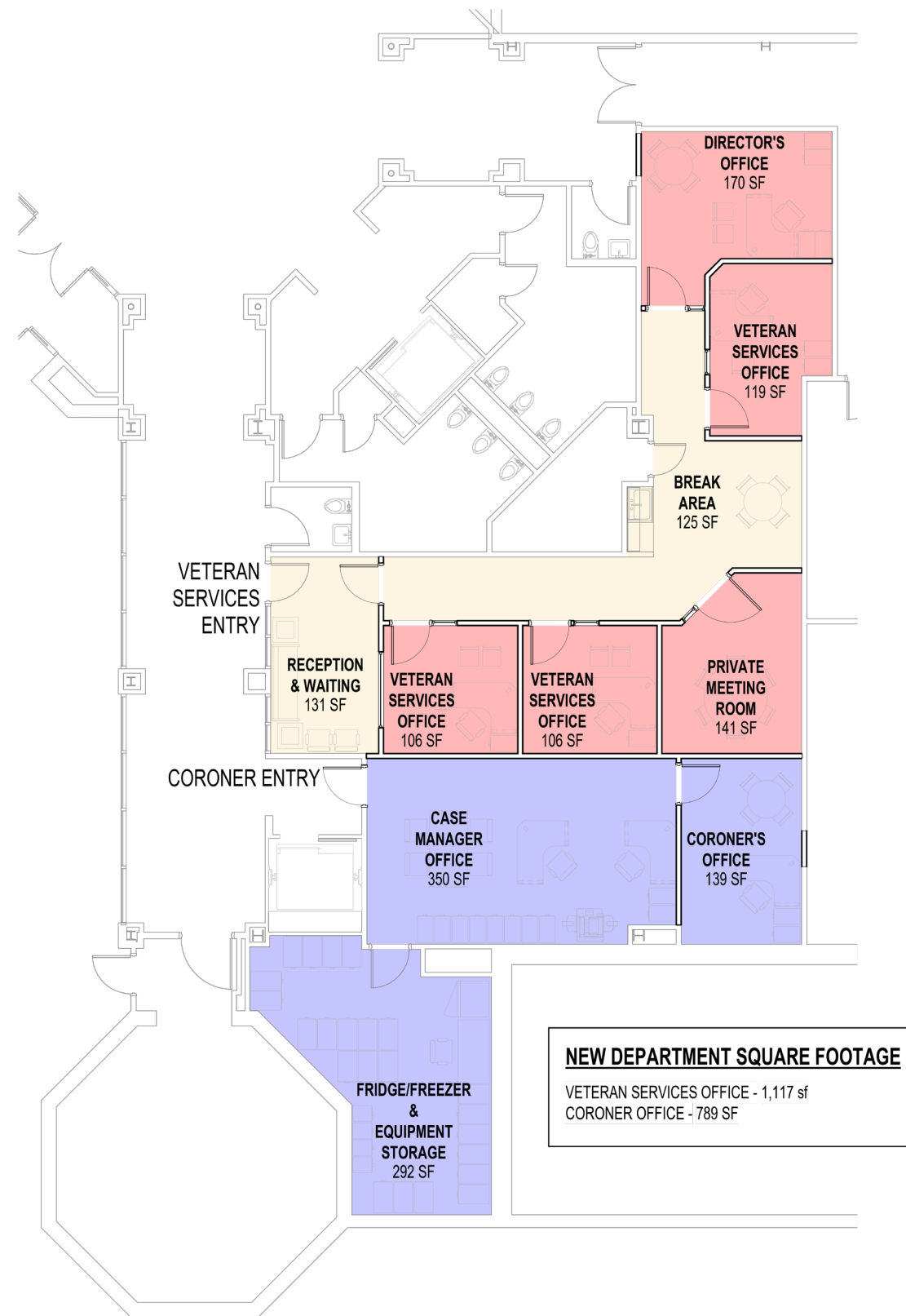

ARCHITECT'S BUDGETARY COST OPINION

EXISTING VOTER REGISTRATION AREA

LIGHT INTERIOR RENOVATIONS:

Renovation – Paint, Flooring, Ceilings, Light Fixtures, Minor Walls/Doors, Minor HVAC

- +/-815 SF @ \$100/SF \$81,500

MEDIUM INTERIOR RENOVATIONS:

Renovation – Paint, Flooring, Ceilings, Light Fixtures, Moderate Walls/Doors, Moderate HVAC

- +/-1,135 SF @ \$125/SF \$141,875

CONTINGENCY:

5% of Construction Subtotal \$11,169

EXISTING HEALTH, VETERANS, & CORONER AREA

LIGHT INTERIOR RENOVATIONS:

Renovation – Paint, Flooring, Ceilings, Light Fixtures, Minor Walls/Doors, Minor HVAC

- +/-2,810 SF @ \$100/SF \$281,000

MEDIUM INTERIOR RENOVATIONS:

Renovation – Paint, Flooring, Ceilings, Light Fixtures, Moderate Walls/Doors, Moderate HVAC

- +/-4,950 SF @ \$125/SF \$618,750

CONTINGENCY:

5% of Construction Subtotal \$44,988

CONSTRUCTION COST SUBTOTAL: **\$1,179,282**

ARCHITECT'S BUDGETARY COST OPINION

SOFT COSTS:

| | | |
|---|--|--------------------|
| A/E Design Fee | | |
| • 6.5% of \$1,179,282 | | \$76,653 |
| • Multiphase/Temp Conditions Planning & Documentation | | \$7,500 |
| Loose Furnishings (furniture, appliances) | | |
| • Budgetary (undefined scope) | | \$75,000 |
| Fixed Technology | | |
| • Displays, Access Control, Security Cameras, WAPS | | \$50,000 |
| o Assumes some re-use/reinstallation of existing | | |
| o Excludes loose electronics (phones, computers, copiers, etc.) | | |
| o Budgetary (assumed scope based on similar projects and existing conditions) | | |
| Permits | | \$5,000 |
| • State construction design release, local building permit | | |
| Builder's Risk Insurance (if required/desired) | | \$5,000 |
| • By Owner, budgetary | | |
| Sales Tax | | \$0 |
| • Exempt | | |
| Utility Fees/Permits | | \$0 |
| • By Owner or None Required | | |
| Bidding Contingency | | \$58,965 |
| • 5% of Construction Cost Subtotal | | |
| SOFT COST SUBTOTAL: | | \$278,118 |
| TOTAL PROJECT COST: | | \$1,457,400 |

PORTER COUNTY FUNDING

| | |
|---------------------------------|--------------------|
| ARPA | \$945,000 |
| Health Dept 2024 (construction) | \$175,307 |
| Health Dept 2025 (construction) | \$337,769 |
| Health Dept 2024 (furniture) | \$47,766 |
| <hr/> | |
| TOTAL: | \$1,505,842 |

PROPOSED PROJECT SCHEDULE

PORTER COUNTY HEALTH DEPARTMENT EXPANSION *FEASIBILITY/SPACE STUDY CONCEPT BUDGET/SCHEDULE* November 14, 2023

| PROJECT | Conceptual Project Budget | Duration (Weeks) | 2023 | | | | 2024 | | | | | | | | | | | | 2025 | | | | | | | | | | | | 2026 | | | | | | | | | | | | | | | | | | | | | | | | |
|--|---------------------------|------------------|--------|----|----|----|------|---|---|---|--------------------------------|---|---|---|---|----|----|----|------|---|---|---|---|---|---|---|---|----|----|----|------|---|---|---|---|---|---|---|---|----|----|----|--|--|--|--|--|--|--|--|--|--|--|--|--|
| | | | 9 | 10 | 11 | 12 | 1 | 2 | 3 | 4 | 5 | 6 | 7 | 8 | 9 | 10 | 11 | 12 | 1 | 2 | 3 | 4 | 5 | 6 | 7 | 8 | 9 | 10 | 11 | 12 | 1 | 2 | 3 | 4 | 5 | 6 | 7 | 8 | 9 | 10 | 11 | 12 | | | | | | | | | | | | | |
| Porter County Health Dept Expansion | \$1.5M | | DESIGN | | | | BID | | | | CONSTRUCTION (Total 12 Months) | | | | | | | | | | | | | | | | | | | | | | | | | | | | | | | | | | | | | | | | | | | | |
| Feasibility/Space Study Design | | 8 | █ | | | | | | | | | | | | | | | | | | | | | | | | | | | | | | | | | | | | | | | | | | | | | | | | | | | | |
| Conceptual Estimate/Schedule | | 1 | | █ | | | | | | | | | | | | | | | | | | | | | | | | | | | | | | | | | | | | | | | | | | | | | | | | | | | |
| Design/Schedule/Estimate Presentation | | 1 | | █ | | | | | | | | | | | | | | | | | | | | | | | | | | | | | | | | | | | | | | | | | | | | | | | | | | | |
| Design Development | | 8 | | █ | | | | | | | | | | | | | | | | | | | | | | | | | | | | | | | | | | | | | | | | | | | | | | | | | | | |
| Construction Documents | | 8 | | | | | █ | | | | | | | | | | | | | | | | | | | | | | | | | | | | | | | | | | | | | | | | | | | | | | | | |
| Bidding, Contracts, Pre-Construction | | 8 | | | | | █ | | | | | | | | | | | | | | | | | | | | | | | | | | | | | | | | | | | | | | | | | | | | | | | | |
| Construction - Phase 1 | | 14 | | | | | | | █ | | | | | | | | | | | | | | | | | | | | | | | | | | | | | | | | | | | | | | | | | | | | | | |
| Coroner & V.S. Move-In, Health Dept Move-Out | | 2 | | | | | | | | | | | █ | | | | | | | | | | | | | | | | | | | | | | | | | | | | | | | | | | | | | | | | | | |
| Construction - Phase 2 | | 14 | | | | | | | | | | | | █ | | | | | | | | | | | | | | | | | | | | | | | | | | | | | | | | | | | | | | | | | |
| Health Dept Flip, Vacate Large Conference | | 2 | | | | | | | | | | | | | | | | | | | | | | | | | | | | | | | | | | | | | | | | | | | | | | | | | | | | | |
| Construction - Phase 3 | | 12 | | | | | | | | | | | | | | | | | | | | | | | | | | | | | | | | | | | | | | | | | | | | | | | | | | | | | |
| Complete Occupancy | | 2 | | | | | | | | | | | | | | | | | | | | | | | | | | | | | | | | | | | | | | | | | | | | | | | | | | | | | |

2024 PRIMARY VOTING

2024 GEN ELEC VOTING

2025 PRIMARY VOTING

PROPOSED PHASING PLAN

