



43. Looking north along US 41



44. Looking north along US 41



45. Looking south along US 41



46. Looking north east at US 41 & SR 58 intersection



47. Looking south within US 41 median



48. Looking north within US 41 median toward US 41 & SR 58 intersection



49. Looking west along SR 58



50. Looking east at US 41 & SR 58 intersection



51. Looking south east at US 41 & SR 58 interchange



52. Looking south along US 41



53. Looking north along US 41



54. Looking south along US 41



55. Looking south within US 41 median



56. Looking north within US 41 median



57. Looking south along US 41



58. Looking north downstream UNT-2 to Busseron



59. Looking south upstream UNT-2 to Busseron



60. Looking south along US 41



61. Looking north along US 41



62. Looking south towards US 41 & SR 58 interchange



63. Looking north along US 41



64. Looking east along SR 58



65. Looking north within US 41 median



66. Looking south within US 41 median towards US 41 & SR 58 intersection

PROJECT	DESIGNATION
1800226	1800226
CONTRACT	
R-41474	

INDIANA DEPARTMENT OF TRANSPORTATION

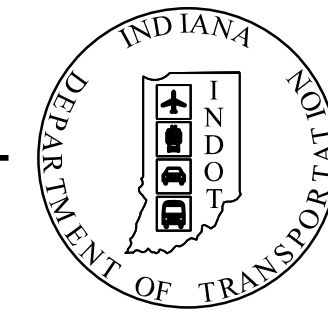

ROAD PLANS U.S. 41 AT S.R. 58 INTERSECTION IMPROVEMENT

ROUTE: U.S. 41 FROM: RP 76+22 TO: RP 76+55

PROJECT NO.

P.E. 1800226

CONST. 1800226

PROJECT DESCRIPTION

INTERSECTION IMPROVEMENTS AND ROADWAY MODIFICATIONS ON U.S. 41/U.S. 150 AT S.R. 58 LOCATED APPROXIMATELY 19.9 MILES NORTH OF THE U.S. 41/U.S.50/U.S. 150 INTERCHANGE IN SECTIONS 3 & 12, T-6-N, R-9-W, HADDON TOWNSHIP, SULLIVAN COUNTY, INDIANA.

TRAFFIC DATA U.S. 41

A.A.D.T. (2023)	8,318 V.P.D.
A.A.D.T. (2043)	8,318 V.P.D.
D.H.V. (2043)	8.02%
DIRECTIONAL DISTRIBUTION	49.52%
TRUCKS	25.21% OF AADT 18.74% OF DHV

DESIGN DATA U.S. 41

DESIGN SPEED	60 MPH
PROJECT DESIGN CRITERIA	3R NON-FREEWAY
FUNCTIONAL CLASSIFICATION	PRINCIPAL ARTERIAL
RURAL/URBAN	RURAL
TERRAIN	LEVEL
ACCESS CONTROL	PARTIAL

TRAFFIC DATA S.R. 58

A.A.D.T. (2023)	1,550 V.P.D.
A.A.D.T. (2043)	1,550 V.P.D.
D.H.V. (2043)	11.00%
DIRECTIONAL DISTRIBUTION	57.00%
TRUCKS	13.30% OF AADT 18.90% OF DHV

DESIGN DATA S.R. 58

DESIGN SPEED	50/30 MPH
PROJECT DESIGN CRITERIA	3R NON-FREEWAY
FUNCTIONAL CLASSIFICATION	MAJOR COLLECTOR
RURAL/URBAN	RURAL
TERRAIN	LEVEL
ACCESS CONTROL	NONE

**STAGE 1 PLANS
MAY 15, 2020**

**BEGIN PROJECT
PROJECT NO. 1800226
P.O.T. STA. 238+88.00
LINE "PR-A"**

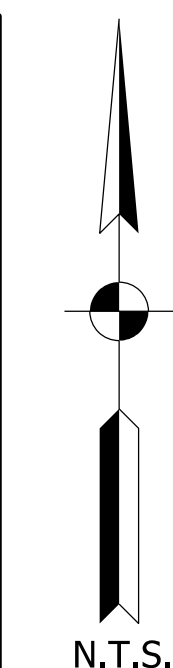
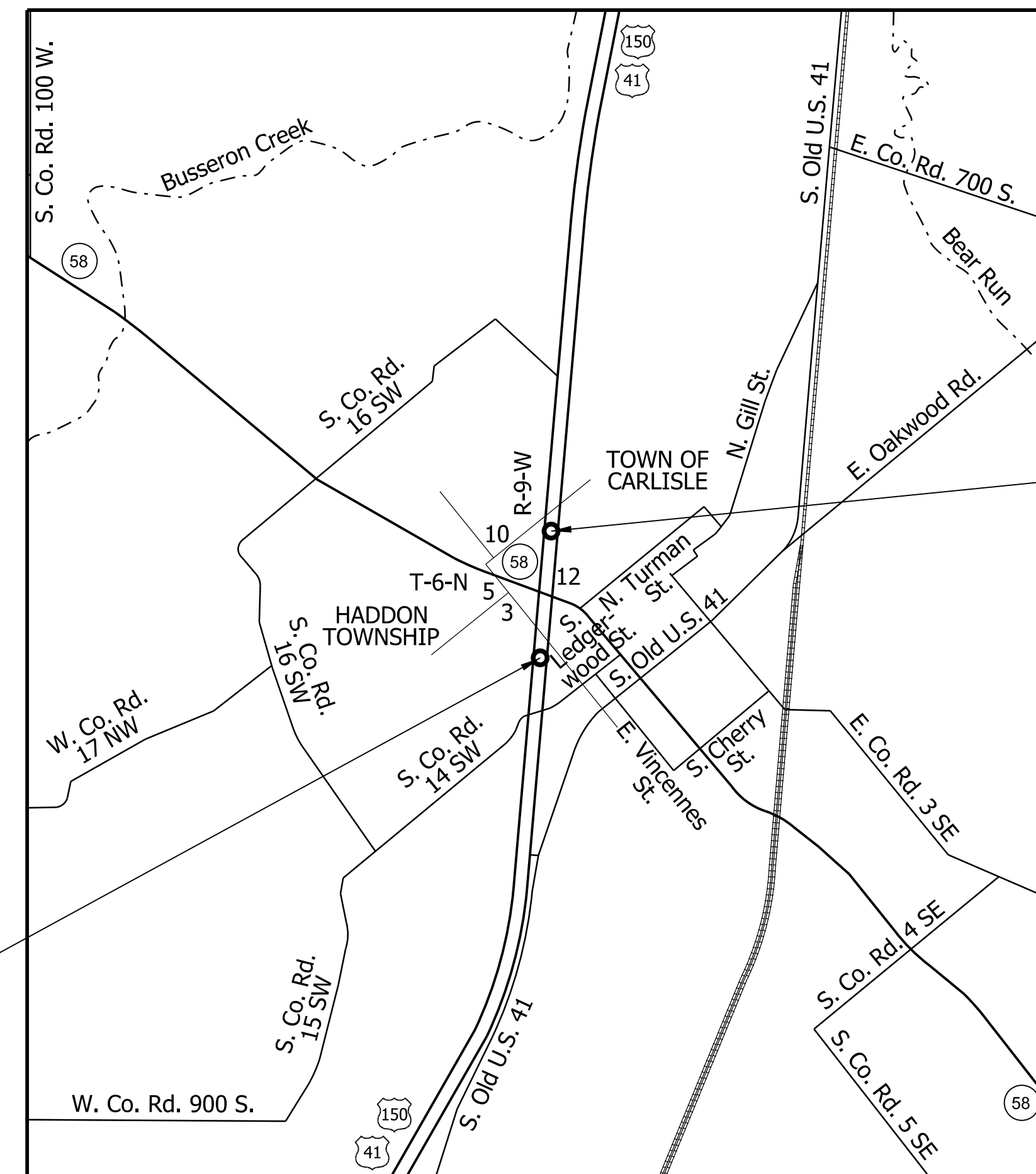

**END PROJECT
PROJECT NO. 1800226
P.O.T. STA. 258+60.00
LINE "PR-A"**



LATITUDE: 38°57'53"N LONGITUDE: 87°24'24"W

GROSS LENGTH: 0.37 MI.
NET LENGTH: 0.37 MI.
MAX. GRADE: 2.28%

HYDROLOGIC UNIT CODE: 05120111160130

INDIANA DEPARTMENT OF TRANSPORTATION
STANDARD SPECIFICATIONS DATED 2020
TO BE USED WITH THESE PLANS

HNTB
THE HNTB COMPANIES
INFRASTRUCTURE SOLUTIONS
111 MONUMENT CIRCLE
SUITE 1200
INDIANAPOLIS, IN 46204-5178

**DRAFT
NOT FOR CONSTRUCTION**

PLANS PREPARED BY: HNTB INDIANA, INC. (317) 636-4682 PHONE NUMBER
CERTIFIED BY: _____ DATE
APPROVED FOR LETTING: _____ DATE
INDIANA DEPARTMENT OF TRANSPORTATION

DESIGNATION	1800226
SURVEY BOOK	
ELECTRONIC	1 of 47
CONTRACT	PROJECT
R-41474	1800226

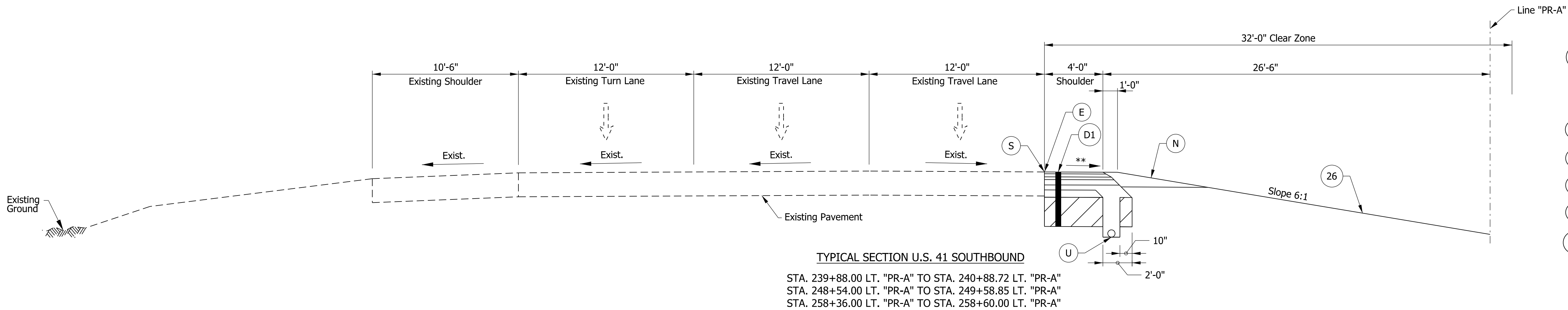
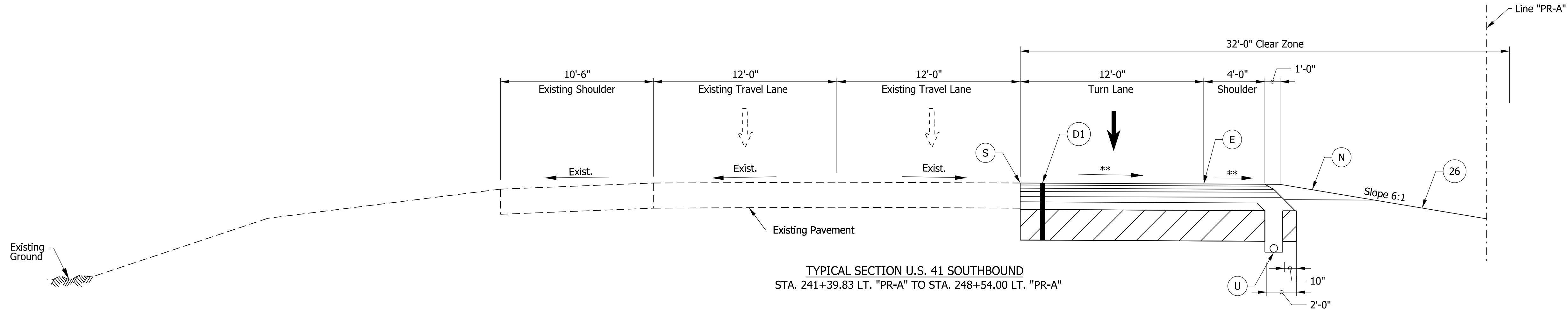

- Legend**
- (D1) 165#/Syd. OC/OA-HMA, 4, 70, Surface, 9.5 mm on 275#/Syd. OC/OA-HMA, 4, 70, Intermediate, 19.0 mm on 880#/Syd. OC/OA-HMA, 4, 64, Base, 25.0 mm on 300#/Syd. OC/OA-HMA, 4, 76, Intermediate OG, 19.0 mm on 6 in. of Compacted Aggregate No. 53 on Subgrade Treatment Type IC
 - (E) Milled HMA Corrugations, Conventional (See Note 2)
 - (N) Compacted Aggregate, No. 53
 - (S) Saw Cut (No Direct Pay)
 - (U) 6 In. Underdrain (See Std. Dwg. No. 718-UNDR-01)
 - (26) Seed Mixture, R
- ** Proposed Cross Slope to Match Existing Slope of Adjacent Lane.

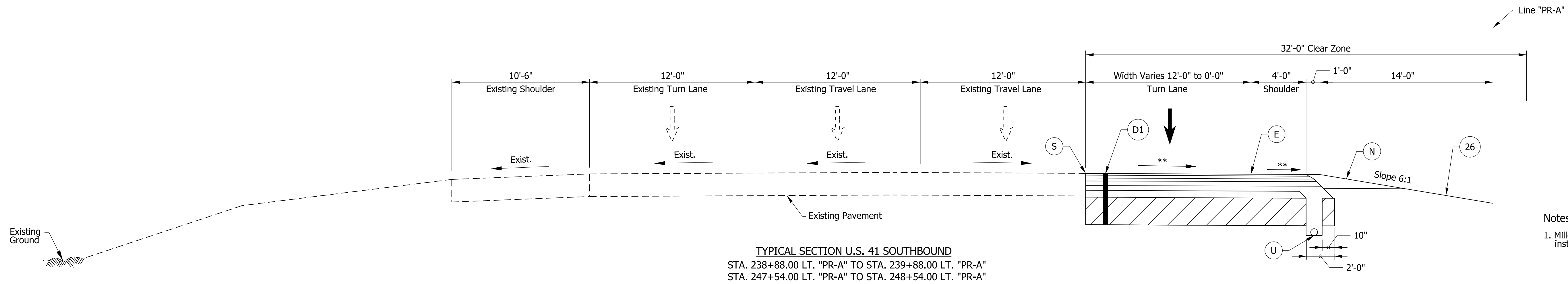

- Notes**
- Milled HMA Corrugations, Conventional shall be installed per Std. Dwg. E 606-SHCG-02.

Note to Reviewer: Safety edge detail to be provided in a future submittal.

Note to Reviewer: Pavement assumed to be asphalt. Final pavement design to be determined in a future submittal.

DRAFT
NOT FOR CONSTRUCTION

RECOMMENDED FOR APPROVAL	DESIGN ENGINEER	DATE
DESIGNED: MKM	DRAWN: JKH	
CHECKED: JLC	CHECKED: MKM	

INDIANA
DEPARTMENT OF TRANSPORTATION

ROADWAY TYPICAL CROSS SECTIONS

HORIZONTAL SCALE	BRIDGE FILE
1/4"=1'-0"	N/A
VERTICAL SCALE	DESIGNATION
N/A	1800226
SURVEY BOOK	SHEETS TS-01
ELECTRONIC	3 of 47
CONTRACT	PROJECT
R-41474	1800226

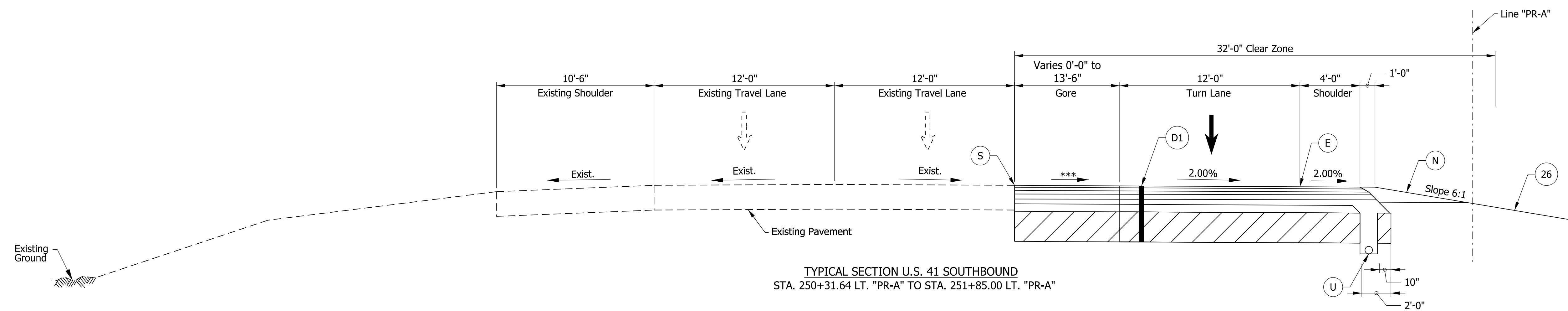
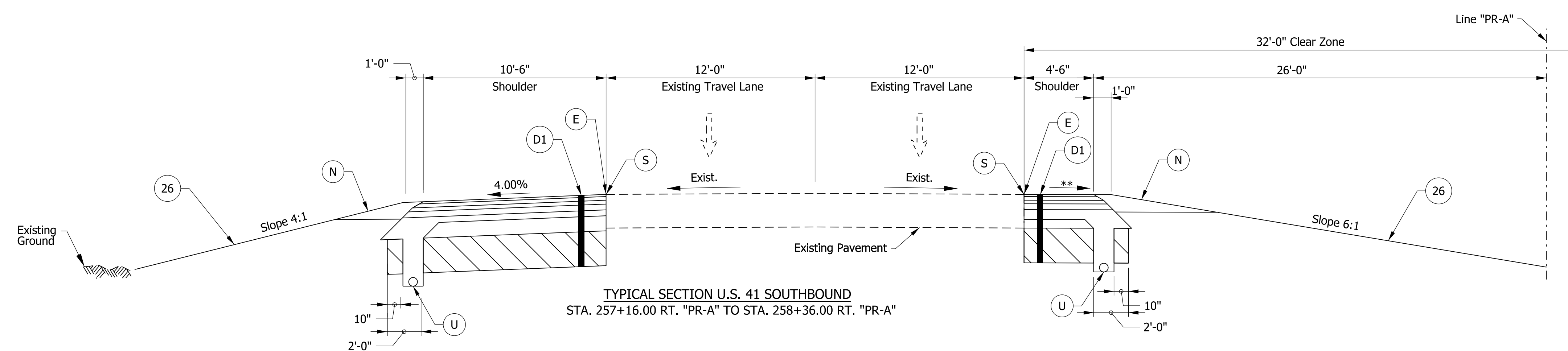
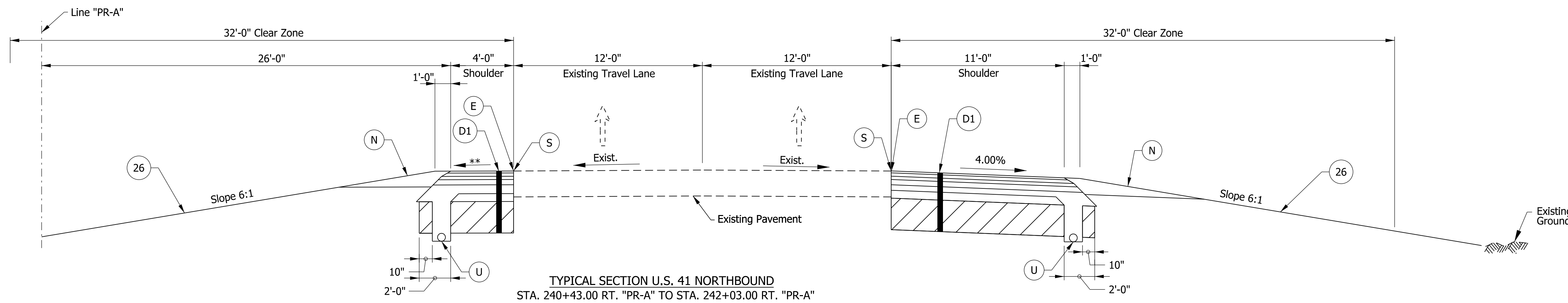

- Legend**
- D1 165#/Svd. OC/QA-HMA, 4, 70, Surface, 9.5 mm on 275#/Svd. OC/QA-HMA, 4, 70, Intermediate, 19.0 mm on 880#/Svd. OC/QA-HMA, 4, 64, Base, 25.0 mm on 300#/Svd. OC/QA-HMA, 4, 76, Intermediate OG, 19.0 mm on 6 in. of Compacted Aggregate No. 53 on Subgrade Treatment Type IC
 - E Milled HMA Corrugations, Conventional (See Note 1)
 - N Compacted Aggregate, No. 53
 - S Saw Cut (No Direct Pay)
 - U 6 In. Underdrain (See Std. Dwg. No. 718-UNDR-01)
 - 26 Seed Mixture, R
 - ** Proposed Cross Slope to Match Existing Slope of Adjacent Lane.
 - *** Cross Slope Varies. See Spot Elevation Details for Additional Information.

Notes

- Milled HMA Corrugations, Conventional shall be installed per Std. Dwg. E 606-SHCG-02.

Note to Reviewer: Spot elevation details to be provided in a future submittal.

Note to Reviewer: Safety edge detail to be provided in a future submittal.

Note to Reviewer: Pavement assumed to be asphalt. Final pavement design to be determined in a future submittal.

challingsworth
5/15/2020 5:23:26 pm
model:Sheet42
file:n:\74927-us 41 intersections\cadd\h2\cde\74927-rd-s-is01.dgn

DRAFT
NOT FOR CONSTRUCTION

RECOMMENDED FOR APPROVAL _____	DESIGN ENGINEER _____	DATE _____
DESIGNED: _____ MKM _____	DRAWN: _____ JKH _____	
CHECKED: _____ JLC _____	CHECKED: _____ MKM _____	

INDIANA
DEPARTMENT OF TRANSPORTATION

ROADWAY TYPICAL CROSS SECTIONS

HORIZONTAL SCALE	BRIDGE FILE
1/4"=1'-0"	N/A
VERTICAL SCALE	DESIGNATION
N/A	1800226
SURVEY BOOK	SHEETS TS-02
ELECTRONIC	4 of 47
CONTRACT	PROJECT
R-41474	1800226