

HARTFORD
UNINCORPORATED TOWN
OHIO COUNTY
INDIANA
LOCATED IN SEC.
23
T4N-R2W

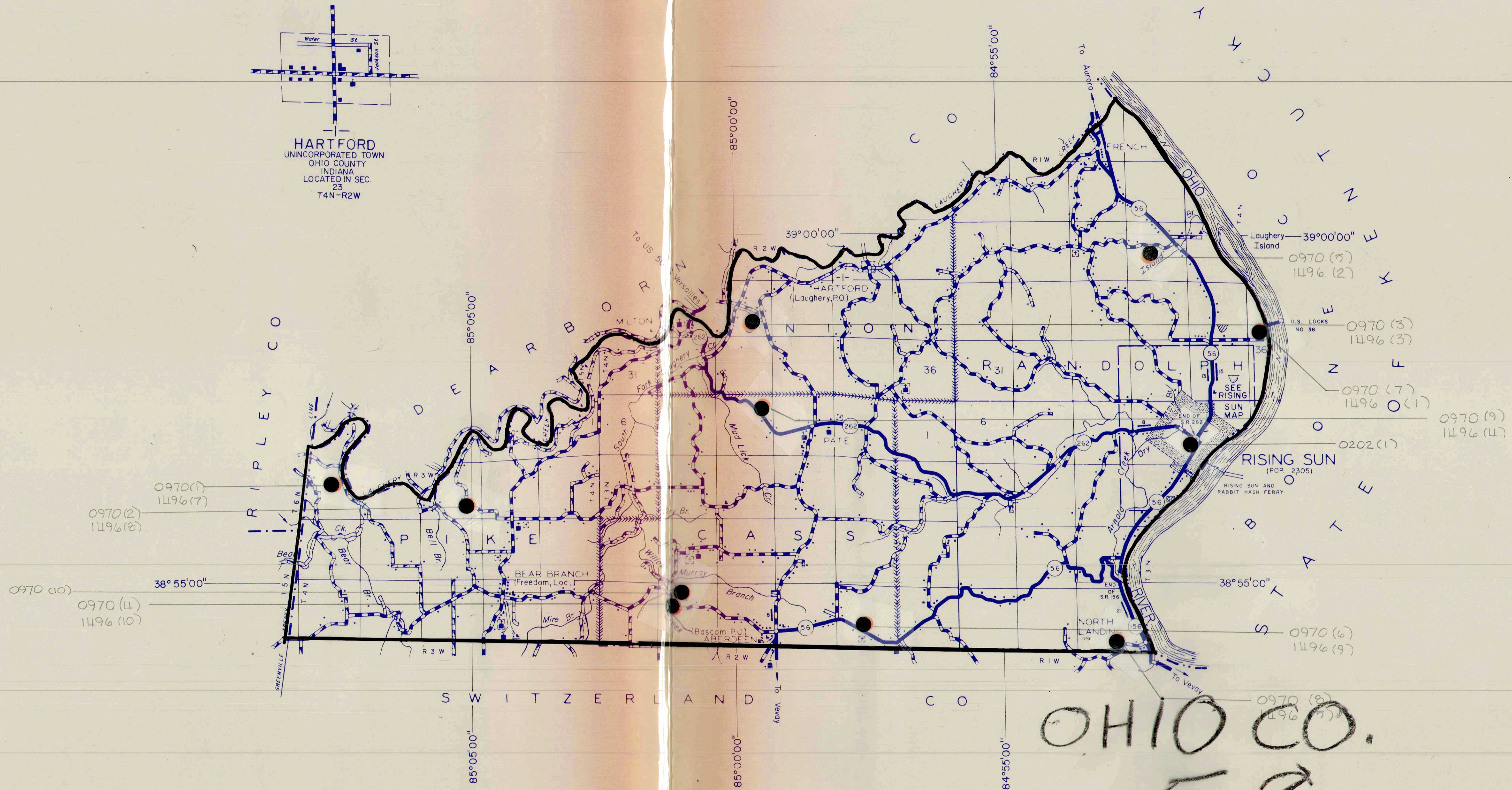

LEGEND

- PAVED ROAD
- BITUMINOUS SURFACED ROAD
- METAL SURFACED ROAD
- GRADED AND DRAINED EARTH ROAD
- UNIMPROVED EARTH ROAD
- PRIMITIVE ROAD
- UNITED STATES HIGHWAY
- STATE HIGHWAY SYSTEM
- COUNTY SEAT
- OTHER CITIES AND VILLAGES
- ATHLETIC FIELD OR AMUSEMENT PARK
- SMALL PARK (SP, STATE, OR COUNTY, P)
- FAIR GROUNDS
- RACE COURSE
- CEMETERY
- DWELLING OR FARM UNIT
- SEASONAL DWELLING
- STORE OR SMALL BUSINESS ESTABLISHMENT
- TOWN HALL
- CHURCH
- SCHOOL
- CORRECTIONAL INSTITUTION
- HOSPITAL
- FACTORY
- SAWMILL
- MINE
- OIL TANK
- POWER PLANT
- RADIO STATION
- FIRE TOWER
- DEPARTMENT OF COMMERCE INTER-MEDIATE LANDING FIELD
- COMMERCIAL, MUNICIPAL OR PRIVATE AIRPORT
- MARKED AUXILIARY AIRPORT
- ARMY OR NATIONAL GUARD LANDING FIELD
- STATE BOUNDARY
- COUNTY LINE
- CIVIL TOWNSHIP LINE
- CORPORATE LINE
- SECTION LINE
- MICHIGAN ROAD LAND SECTION
- STATE PARK BOUNDARY (NAME SHOWN)
- STATE FOREST OR STATE GAME PRESERVE BOUNDARY
- NATIONAL FARM BOUNDARY (NAME SHOWN)
- NATIONAL PURCHASE UNIT BOUNDARY
- RAILROAD (ANY NUMBER OF TRACKS USED BY SINGLE OPERATING COMPANY)
- ELECTRIC INTERURBAN OR SUBURBAN RAILROAD
- RAILROAD STATION
- REVENUE STOP (NO STATION)
- RAILROAD ABOVE
- RAILROAD BELOW
- NARROW STREAM
- WIDE STREAM
- NAVIGABLE STREAM
- DOCK, PIER OR LANDING
- CANAL
- OPERATED SHIP AND BARGE LINES ON CANAL
- DRAINAGE DITCH (MAIN)
- HIGHWAY BRIDGE (OVER 20 SPAN)
- BRIDGES FOR LONG RIVER CROSSINGS
- DAM WITH ROAD
- DAM WITHOUT ROAD
- DAM WITH LOCK
- LEVEE
- FORD-ROAD ESTABLISHED
- FORD-PRIMITIVE ROAD
- TOLL FERRY

GENERAL HIGHWAY AND TRANSPORTATION MAP
OHIO COUNTY
INDIANA

PREPARED BY THE
INDIANA STATE HIGHWAY COMMISSION
DIVISION OF PLANNING
IN COOPERATION WITH THE
U.S. DEPARTMENT OF TRANSPORTATION
FEDERAL HIGHWAY ADMINISTRATION

DEC. 31, 1978

MAP CHECKED WITH AERIAL PHOTOGRAPHS DATED 1976

Note: This map not copyrighted. For information regarding availability, write:
Indiana State Highway Commission
Division of Planning
1205 State Office Building
Indianapolis, Ind. 46204

| DATE | REVISIONS | BY |
|------|-----------|----|
| | | |
| | | |
| | | |
| | | |
| | | |
| | | |
| | | |
| | | |
| | | |

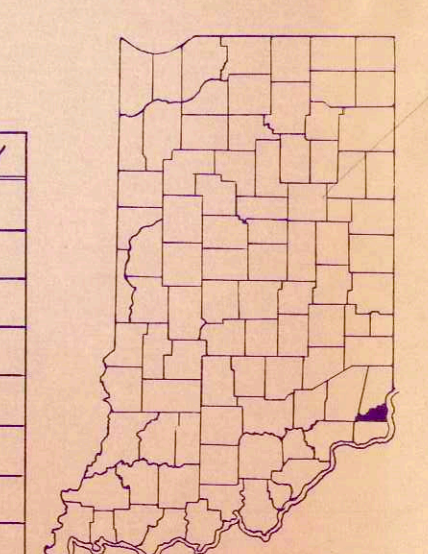

SHEET 1 OF 1 MAP SHEET AND NO SUPPLEMENTAL SHEETS