

-6- MIAMI
UNINCORPORATED TOWN
MIAMI COUNTY
INDIANA
LOCATED IN SEC 17 & 18
T25N-R4E

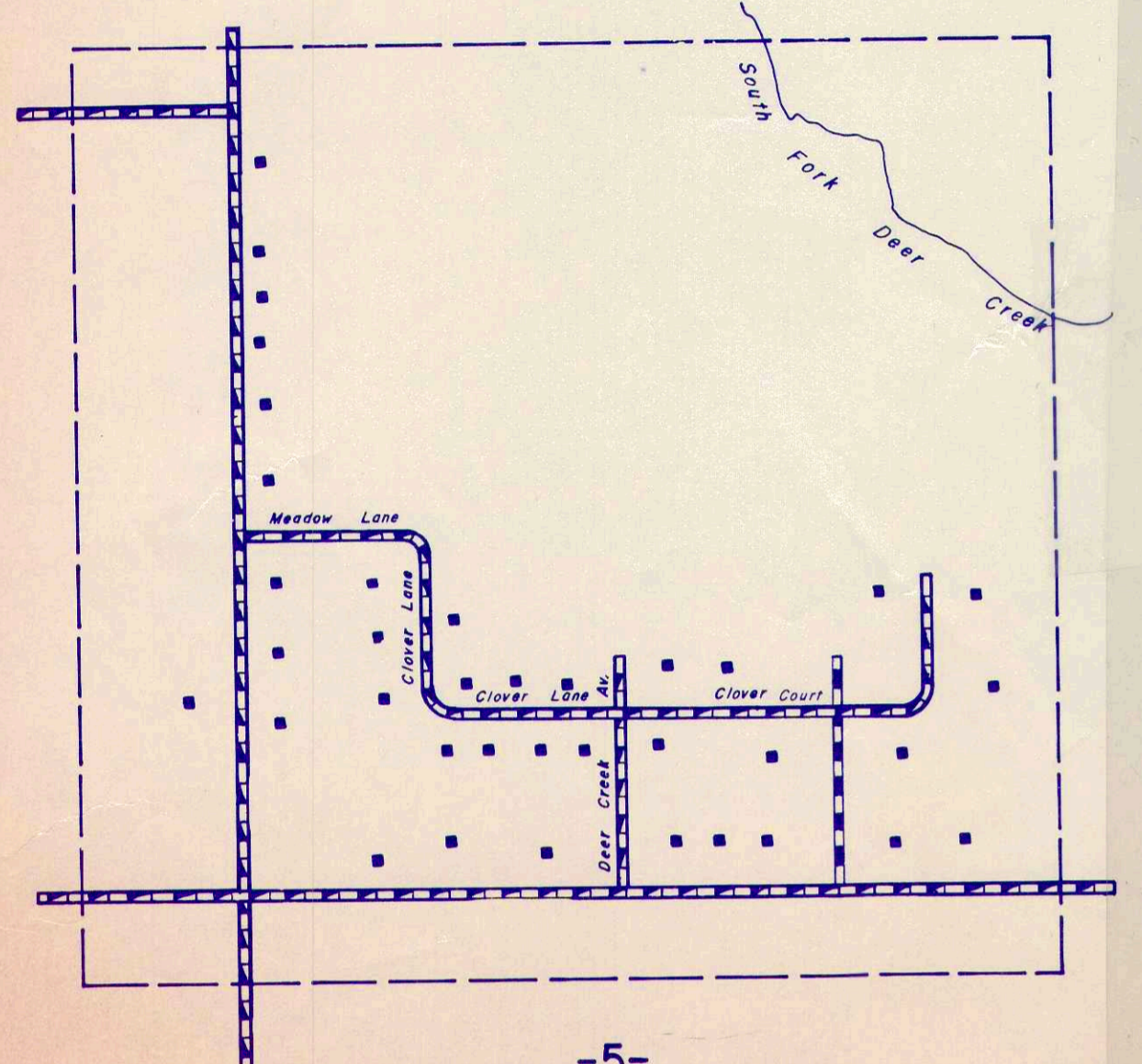

-5- DEER CREEK ESTATES
UNINCORPORATED AREA
MIAMI COUNTY
INDIANA
LOCATED IN SEC 36
T25N-R3E

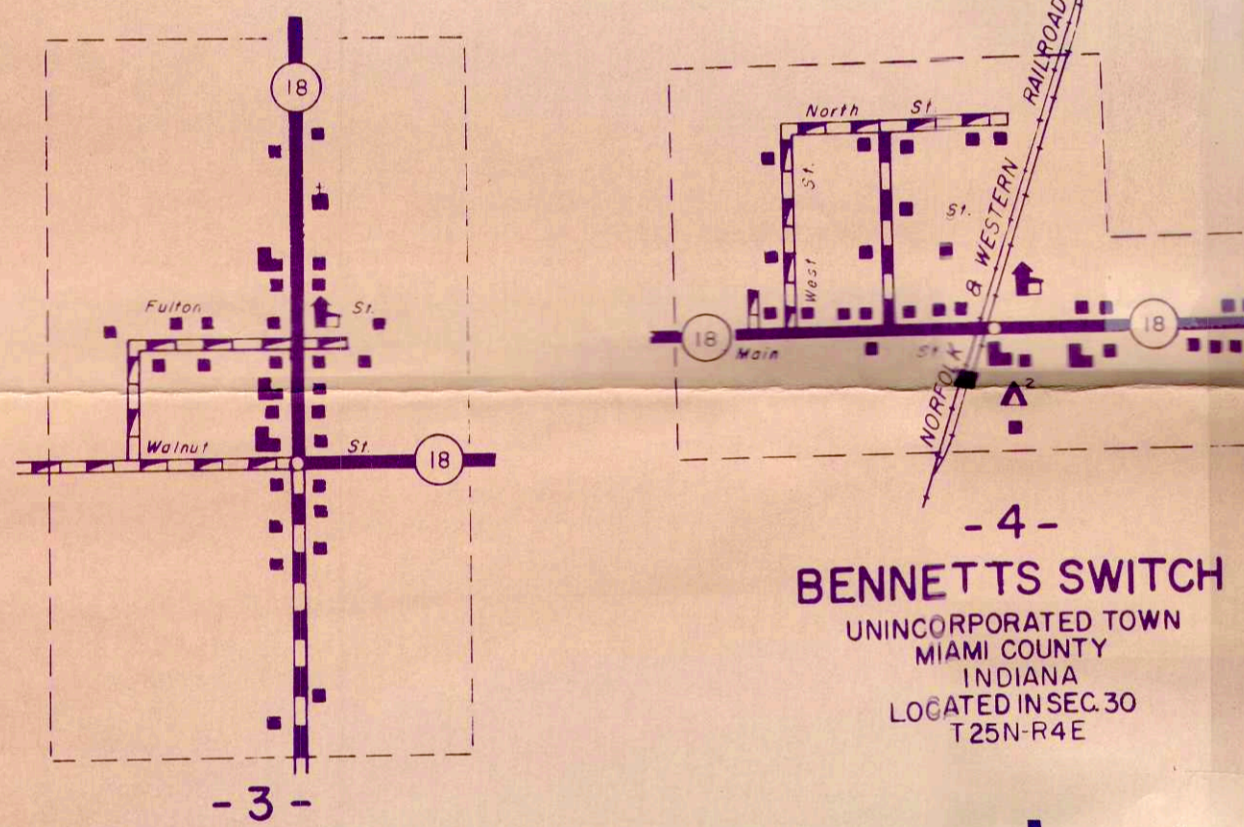

-4- BENNETTS SWITCH
UNINCORPORATED TOWN
MIAMI COUNTY
INDIANA
LOCATED IN SEC 30
T25N-R4E

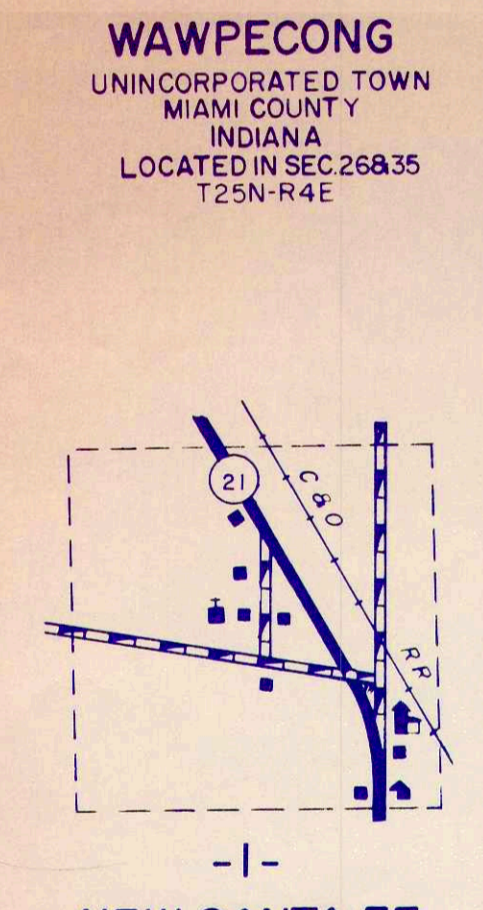

-3- WAWPECONG
UNINCORPORATED TOWN
MIAMI COUNTY
INDIANA
LOCATED IN SEC 26 & 35
T25N-R4E

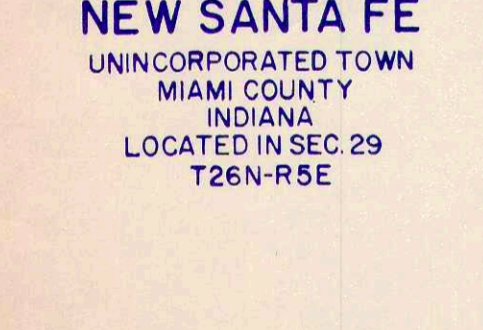

-1- NEW SANTA FE
UNINCORPORATED TOWN
MIAMI COUNTY
INDIANA
LOCATED IN SEC 29
T26N-R5E



-2- SANTA FE
UNINCORPORATED TOWN
MIAMI COUNTY
INDIANA
LOCATED IN SEC 32
T25N-R5E

LEGEND

- INTERSTATE HIGHWAY SYSTEM
- UNITED STATES HIGHWAY
- STATE HIGHWAY SYSTEM
- DIVIDED HIGHWAY
- PAVED ROAD
- BITUMINOUS SURFACED ROAD
- METAL SURFACED ROAD
- GRADED AND DRAINED EARTH ROAD
- UNIMPROVED EARTH ROAD
- PRIMITIVE ROAD
- INTERCHANGE (LOCATED IN INCORPORATED CITY)
- INTERCHANGE
- HIGHWAY GRADE SEPARATION
- HIGHWAY BRIDGES (OVER 20' SPAN)
- CONCRETE FORD OR DIP
- FORD - ROAD ESTABLISHED
- FORD - PRIMITIVE ROAD
- RAILROAD (ANY NUMBER OF TRACKS) USED BY SINGLE OPERATING COMPANY
- RAILROAD STATION
- RAILROAD ABOVE
- RAILROAD BELOW
- NARROW STREAM
- WIDE STREAM (ARROWS POINT IN DIRECTION OF FLOW)
- NAVIGABLE STREAM (ARROWS POINT IN DIRECTION OF FLOW)
- DAM WITH ROAD
- DAM WITH LOCK
- DAM WITHOUT ROAD
- LEVEE
- LEVEE WITH ROAD
- TOLL FERRY
- STATE BOUNDARY
- COUNTY LINE
- CIVIL TOWNSHIP LINE
- CORPORATE LINE
- INSET LIMITS
- CONGRESSIONAL TOWNSHIP LINE
- SECTION LINE
- STATE PARK BOUNDARY (NAME SHOWN)
- STATE FOREST OR STATE GAME PRESERVE BOUNDARY
- NATIONAL PARK BOUNDARY (NAME SHOWN)
- NATIONAL PURCHASE UNIT BOUNDARY
- AIRPORT BOUNDARY
- C COMMERCIAL, M MUNICIPAL, OR P PRIVATE AIRPORT
- ARMY OR NATIONAL GUARD LANDING FIELD
- STATE CAPITOL
- COUNTY SEAT
- OTHER CITIES AND VILLAGES
- DWELLING OR FARM UNIT
- ROW OR GROUP OF DWELLINGS CLOSELY SPACED
- SEASONAL DWELLING
- ROW OR GROUP OF SEASONAL DWELLINGS
- APARTMENT
- HOTEL
- MOTEL OR TOURIST COURT
- TRAILER COURT
- STORE OR SMALL BUSINESS ESTABLISHMENT
- TOWN HALL, GRANGE OR COMMUNITY HALL
- COMBINED DWELLING AND STORE
- POST OFFICE
- BARRACKS OR DORMITORIES FOR STUDENTS, WORKERS, MIGRANTS, ETC.
- SCHOOLHOUSE, OTHER EDUCATIONAL INSTITUTION
- CHURCH, OTHER RELIGIOUS INSTITUTION
- CEMETERY
- CHURCH WITH CEMETERY ADJACENT
- FRESH AIR FARM OR REST HOME
- HOSPITAL
- POLICE STATION
- FIRE ENGINE HOUSE
- ARMORY
- FAIR GROUND, RACE COURSE OR SPEEDWAY
- WAREHOUSE - GENERAL
- FACTORY OR INDUSTRIAL PLANT
- GAUGING OR PUMPING STATION (GENERAL)
- PUMPING STATION (GAS OR OIL)
- POWER PLANT
- BOOSTER STATION
- RADIO STATION (WITH CALL LETTERS)
- RADIO RANGE STATION
- TELEVISION RELAY STATION
- AGRICULTURAL EXPERIMENT STATION
- COUNTY FARM
- STOCK YARD
- GRAIN ELEVATOR
- NURSERY
- FRUIT OR NUT ORCHARD
- GREENHOUSE
- CORRECTIONAL INSTITUTION
- CAMP OR LODGE
- OBSERVATION OR LOOKOUT TOWER
- SAWMILL (STATIONARY)
- DRIVE-IN THEATRE
- RIFLE CLUB
- GOLF COURSE OR COUNTRY CLUB
- SMALL PARK
- WAYSIDE PARK
- BATHING BEACH OR SWIMMING POOL
- PICNIC GROUND
- PLAYGROUND, BALL FIELD, ETC.
- SCENIC SITE
- MINE, QUARRY OR OPEN CUT
- OIL OR GAS WELLS
- GROUP OF STORAGE TANKS (OIL OR GAS)
- QUARRY
- GRAVEL PIT
- GARBAGE OR RUBBISH DUMP

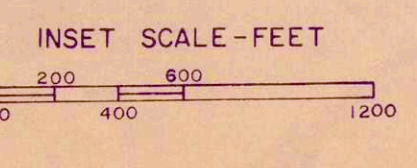

GENERAL HIGHWAY AND TRANSPORTATION MAP
MIAMI COUNTY
INDIANA

PREPARED BY THE
DIVISION OF PLANNING
INDIANA STATE HIGHWAY COMMISSION
IN COOPERATION WITH THE
U. S. DEPARTMENT OF TRANSPORTATION
FEDERAL HIGHWAY ADMINISTRATION

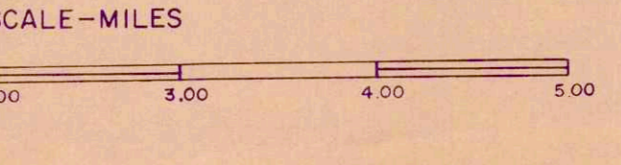

1979
POLYCONIC PROJECTION

MAP CHECKED WITH AERIAL PHOTOGRAPHS DATED 1976

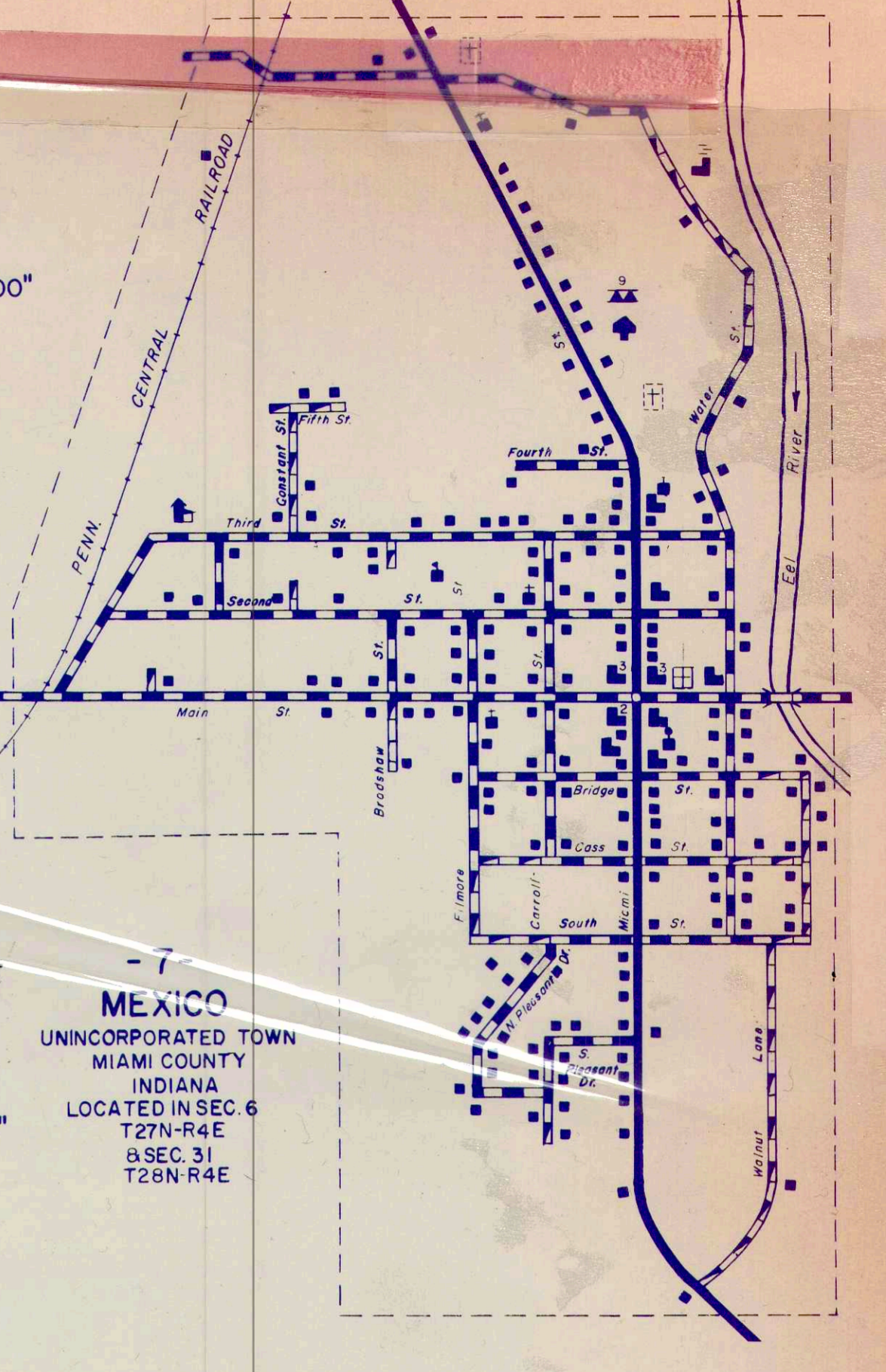

-7- MEXICO
UNINCORPORATED TOWN
MIAMI COUNTY
INDIANA
LOCATED IN SEC 6
T27N-R4E
S. SEC. 31
T26N-R4E

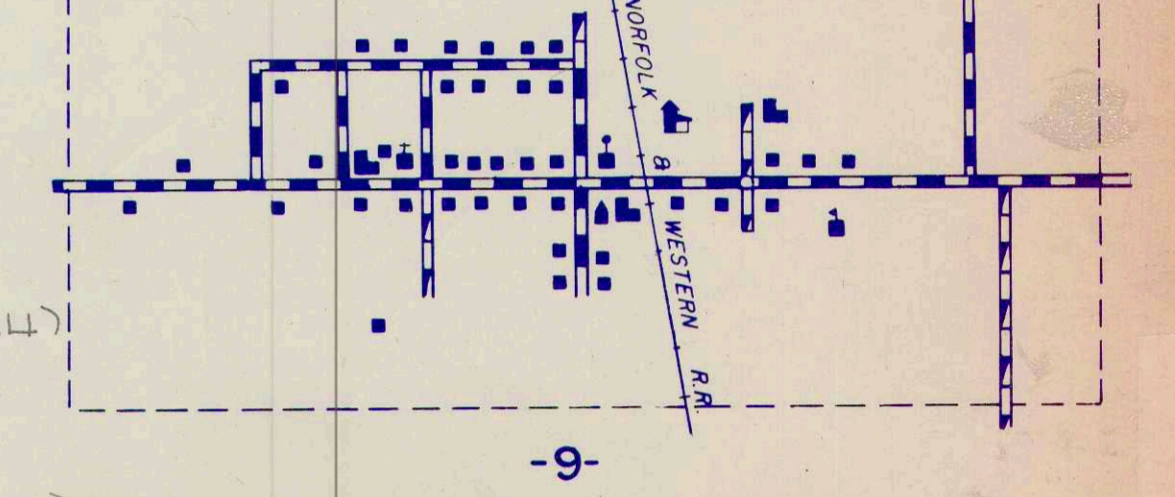

-9- DEEDSVILLE
UNINCORPORATED TOWN
MIAMI COUNTY
INDIANA
LOCATED IN SEC 32
T29N-R4E

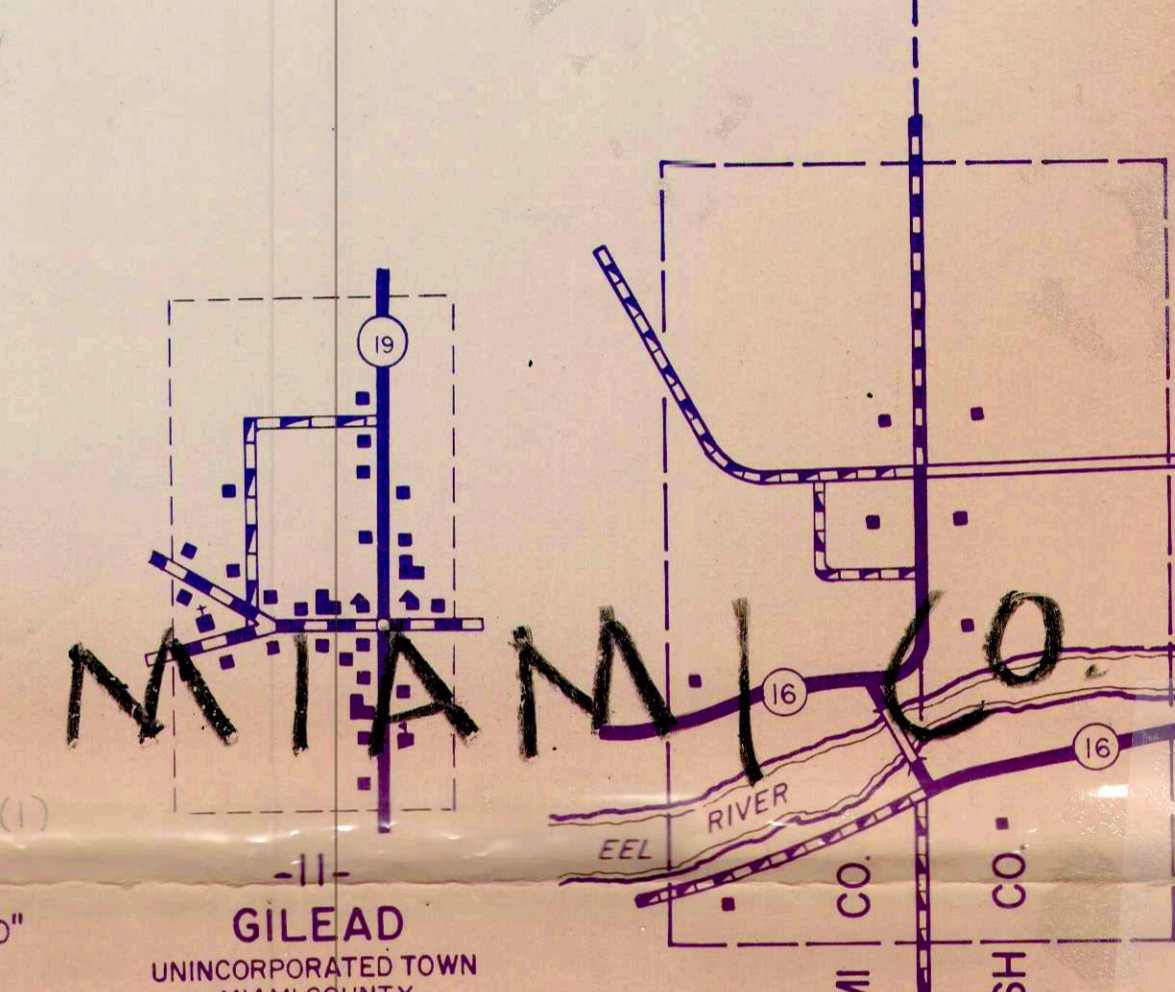

-12- STOCKDALE
UNINCORPORATED TOWN
MIAMI COUNTY
INDIANA
LOCATED IN SECS. 2, 3, 34, 35
T28N & T29N-R5E

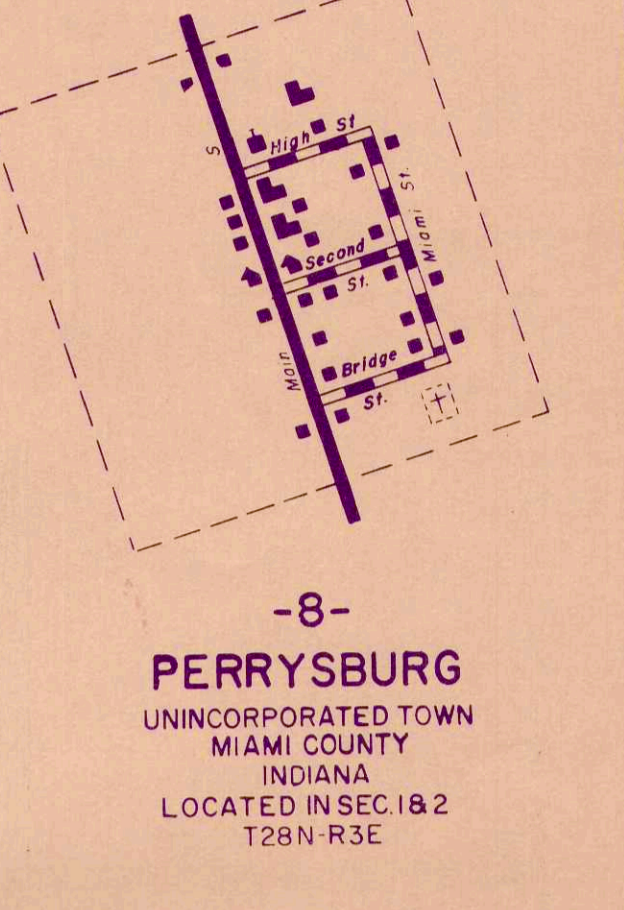

-8- PERRYSBURG
UNINCORPORATED TOWN
MIAMI COUNTY
INDIANA
LOCATED IN SEC 18 & 2
T28N-R3E

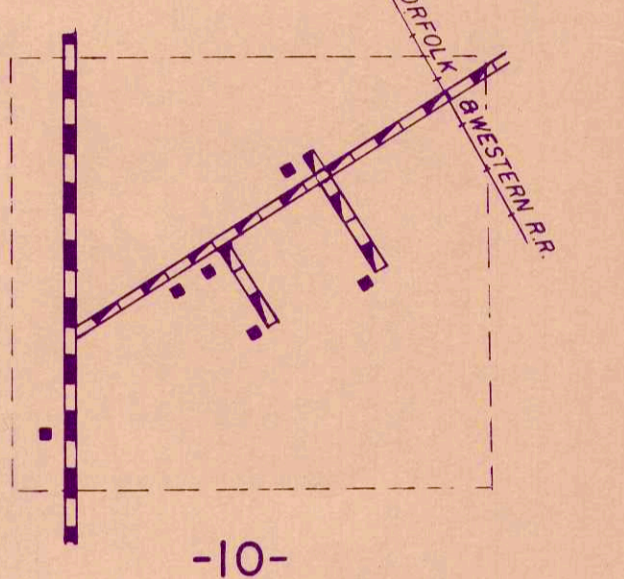

-10- BIRMINGHAM
UNINCORPORATED TOWN
MIAMI COUNTY
INDIANA
LOCATED IN SEC 29
T29N-R4E

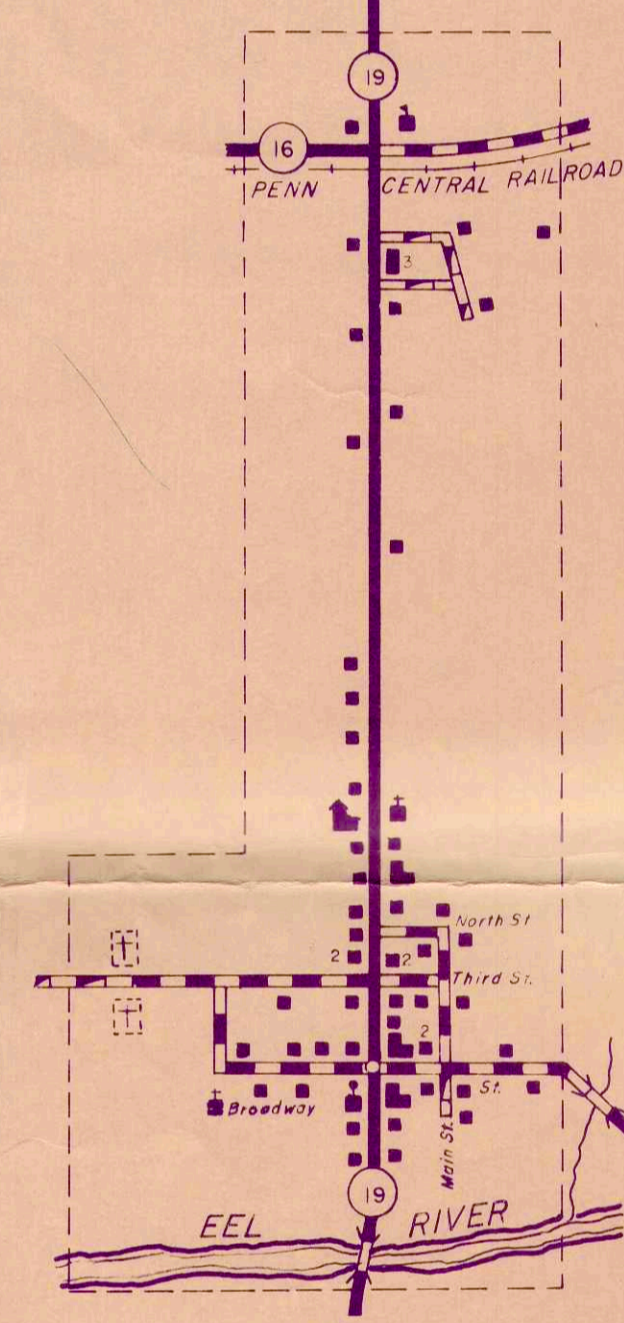

-13- CHIL
UNINCORPORATED TOWN
MIAMI COUNTY
INDIANA
LOCATED IN SEC 24
T28N-R4E

MIAMI CO
52
MIAMI CO
WABASH CO.

APPROVAL DATE _____

DATE	REVISIONS	BY

