

-4- DEMING
UNINCORPORATED TOWN
HAMILTON COUNTY
INDIANA
LOCATED IN SECS 5, 8, 8,
T19N, R4E

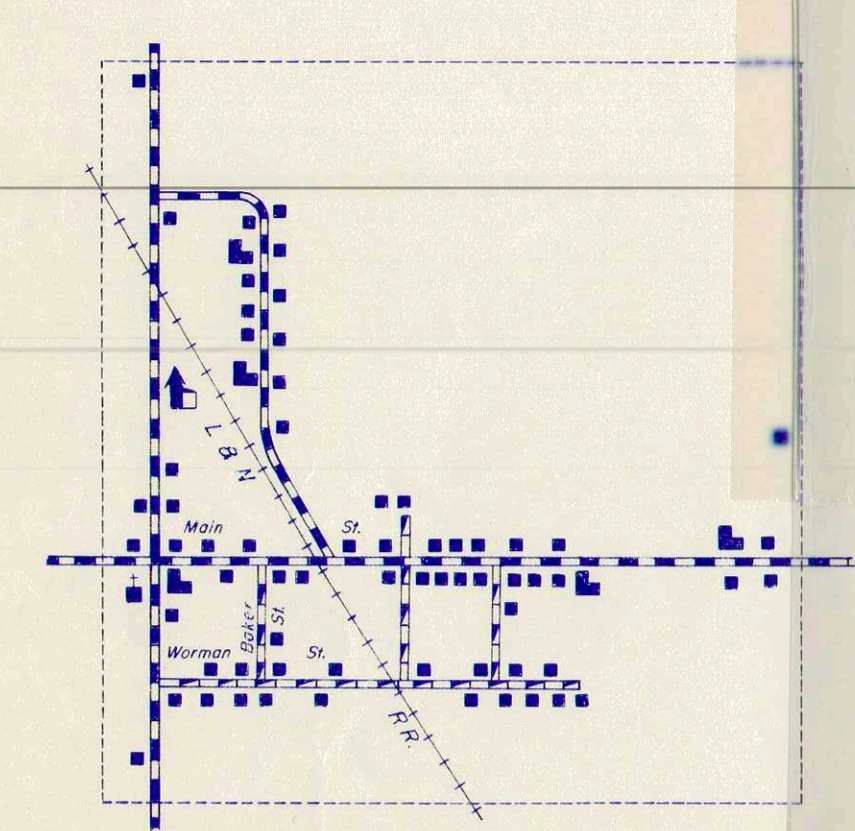

-3- HORTONVILLE
UNINCORPORATED TOWN
HAMILTON COUNTY
INDIANA
LOCATED IN SECS 14 & 23,
T19N, R3E

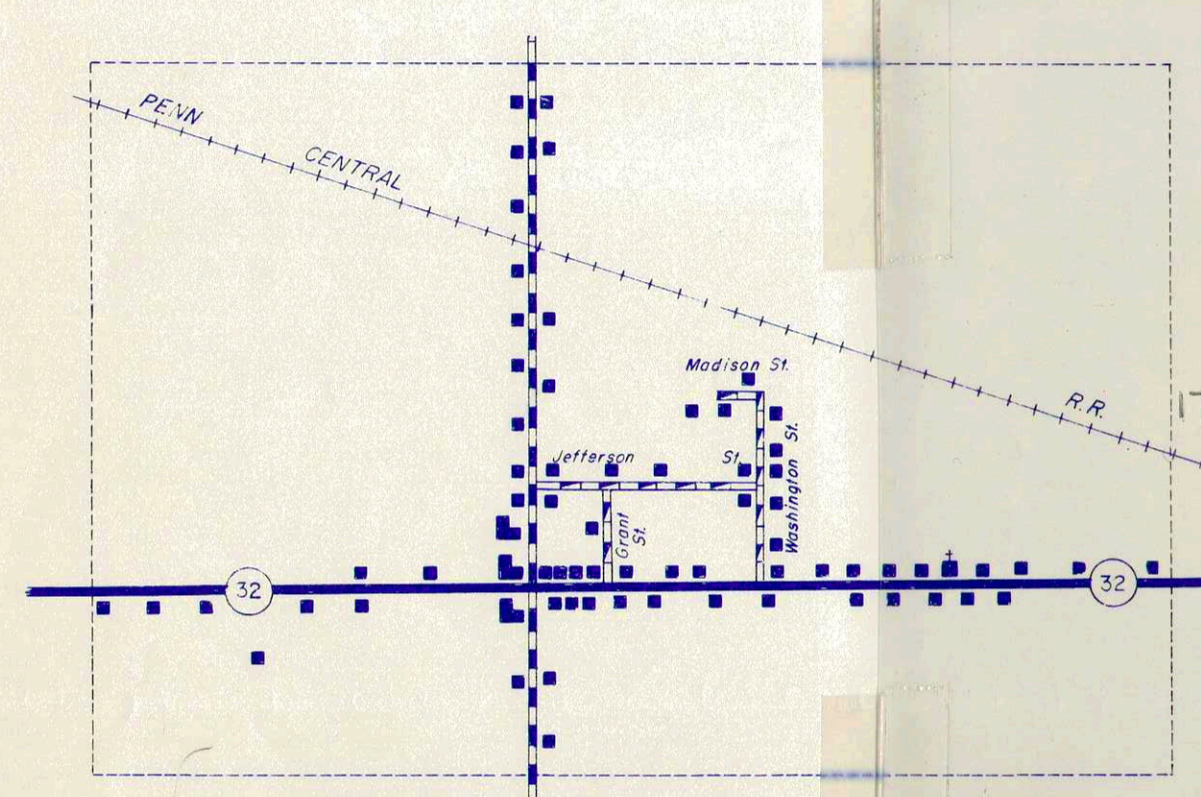

-2- JOLIETVILLE
UNINCORPORATED TOWN
HAMILTON COUNTY
INDIANA
LOCATED IN SEC 6, T19N, R3E,
& SEC 31, T19N, R3E

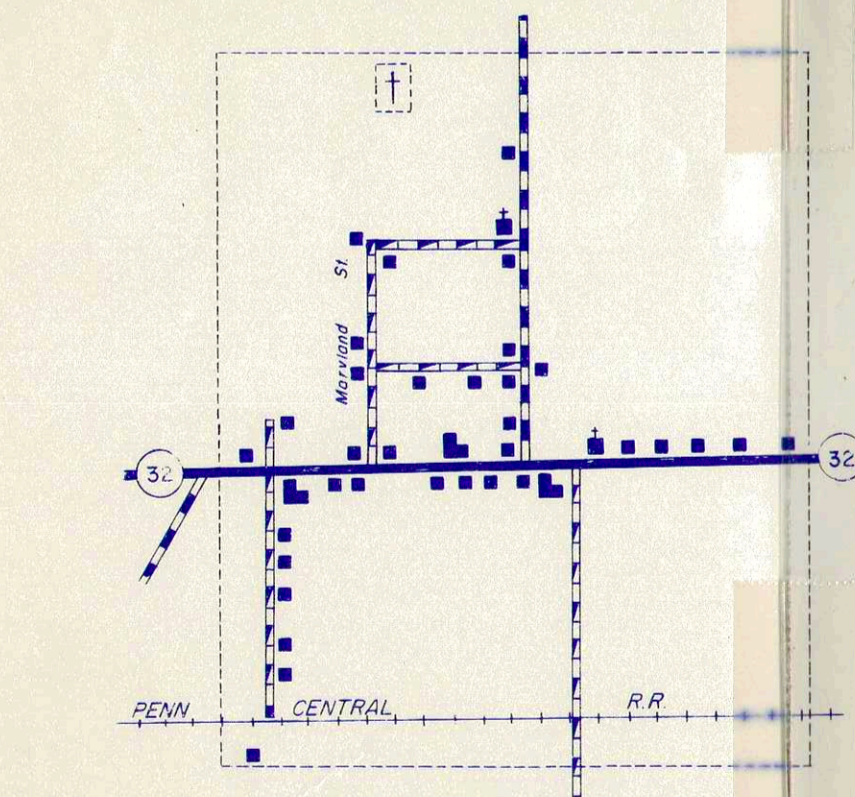

-1- EAGLETOWN
UNINCORPORATED TOWN
HAMILTON COUNTY
INDIANA
LOCATED IN SEC 4, T18N, R3E,
& SEC 33, T19N, R3E

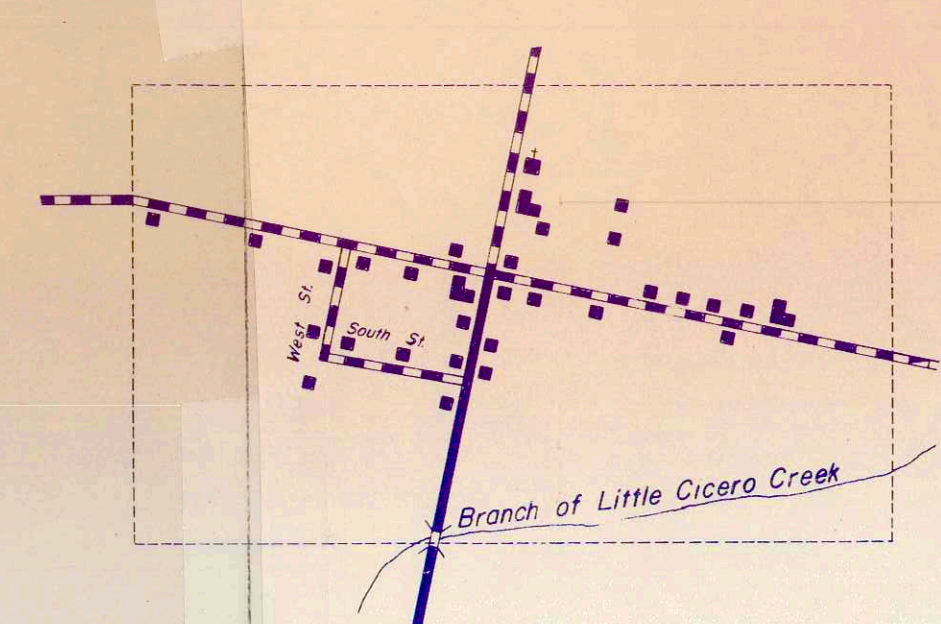
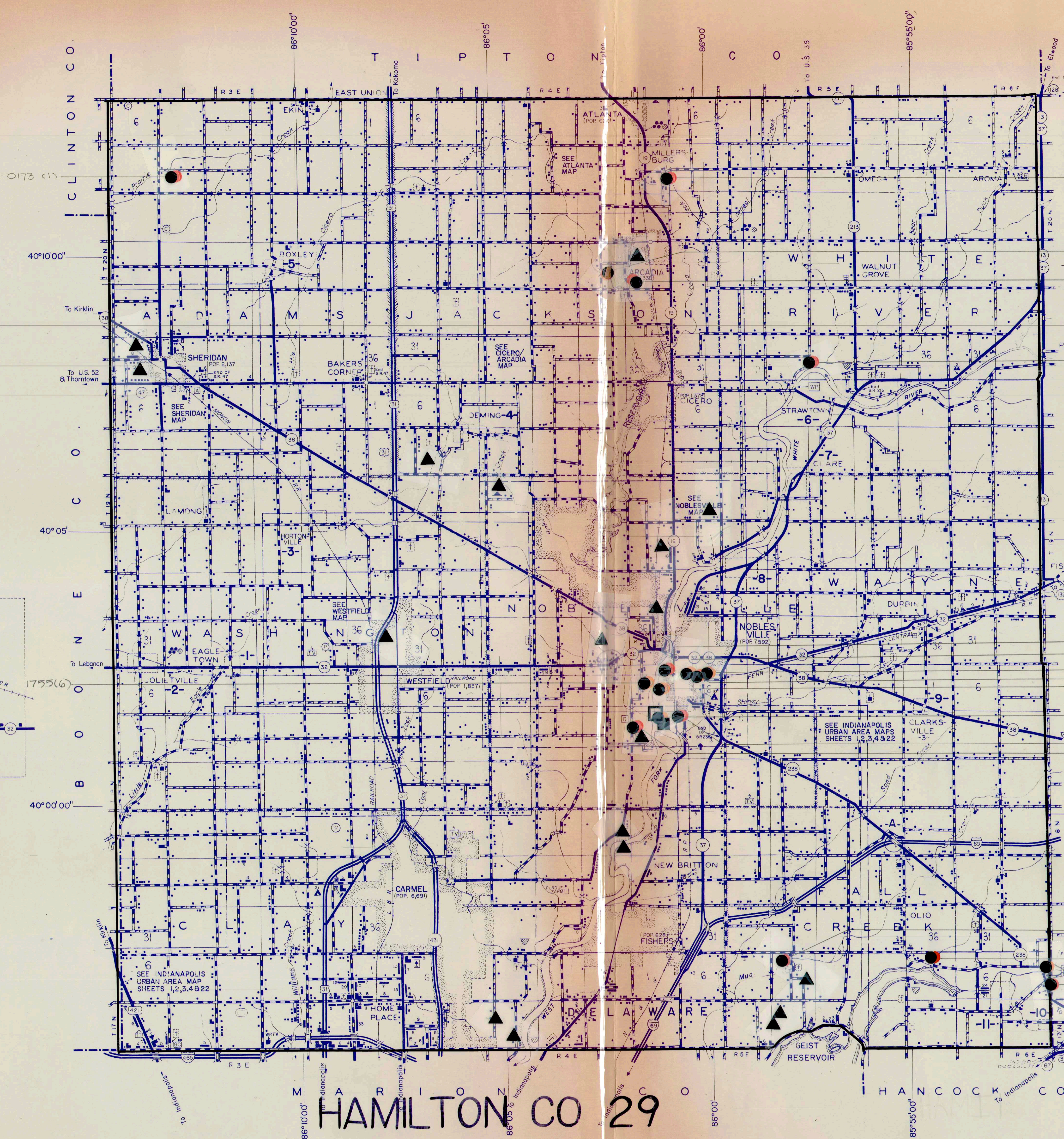

-5- BOXLEY
UNINCORPORATED TOWN
HAMILTON COUNTY
INDIANA
LOCATED IN SEC. 22,
T20N, R3E

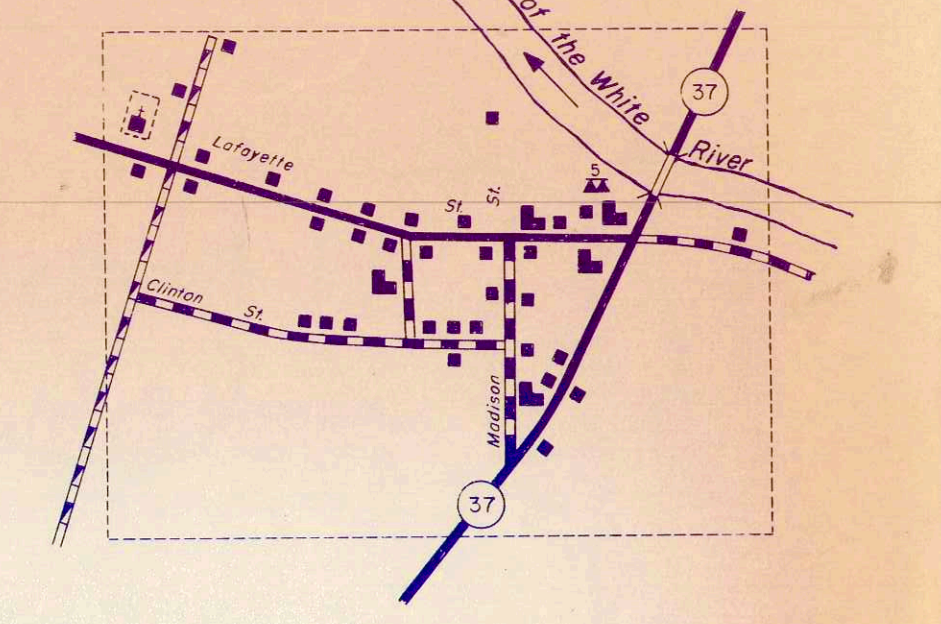

-6- STRAWTOWN
UNINCORPORATED TOWN
HAMILTON COUNTY
INDIANA
LOCATED IN SEC. 3,
T19N, R5E

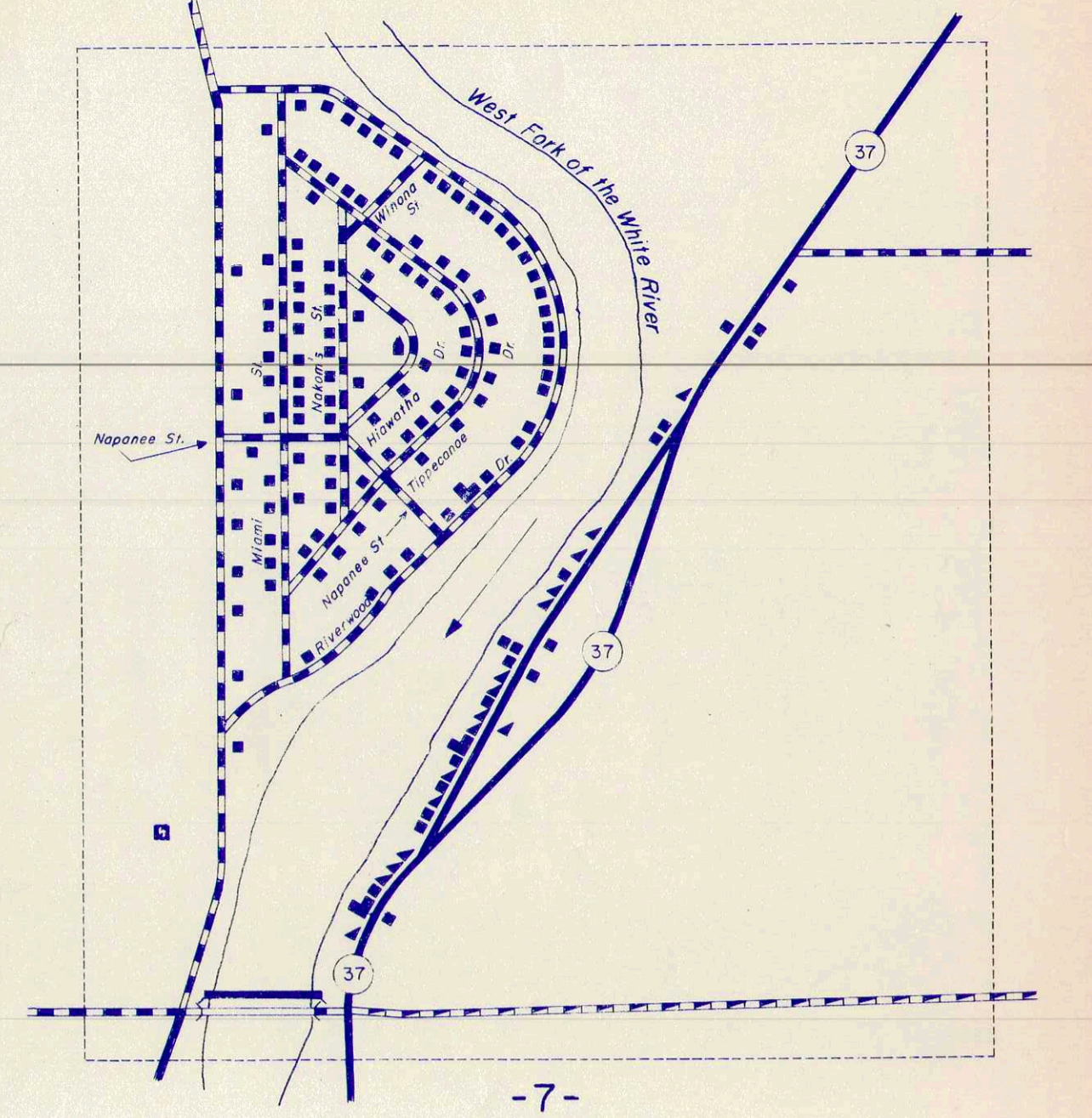

-7- CLARE
UNINCORPORATED TOWN
HAMILTON COUNTY
INDIANA
LOCATED IN SECS. 9 & 16,
T19N, R5E

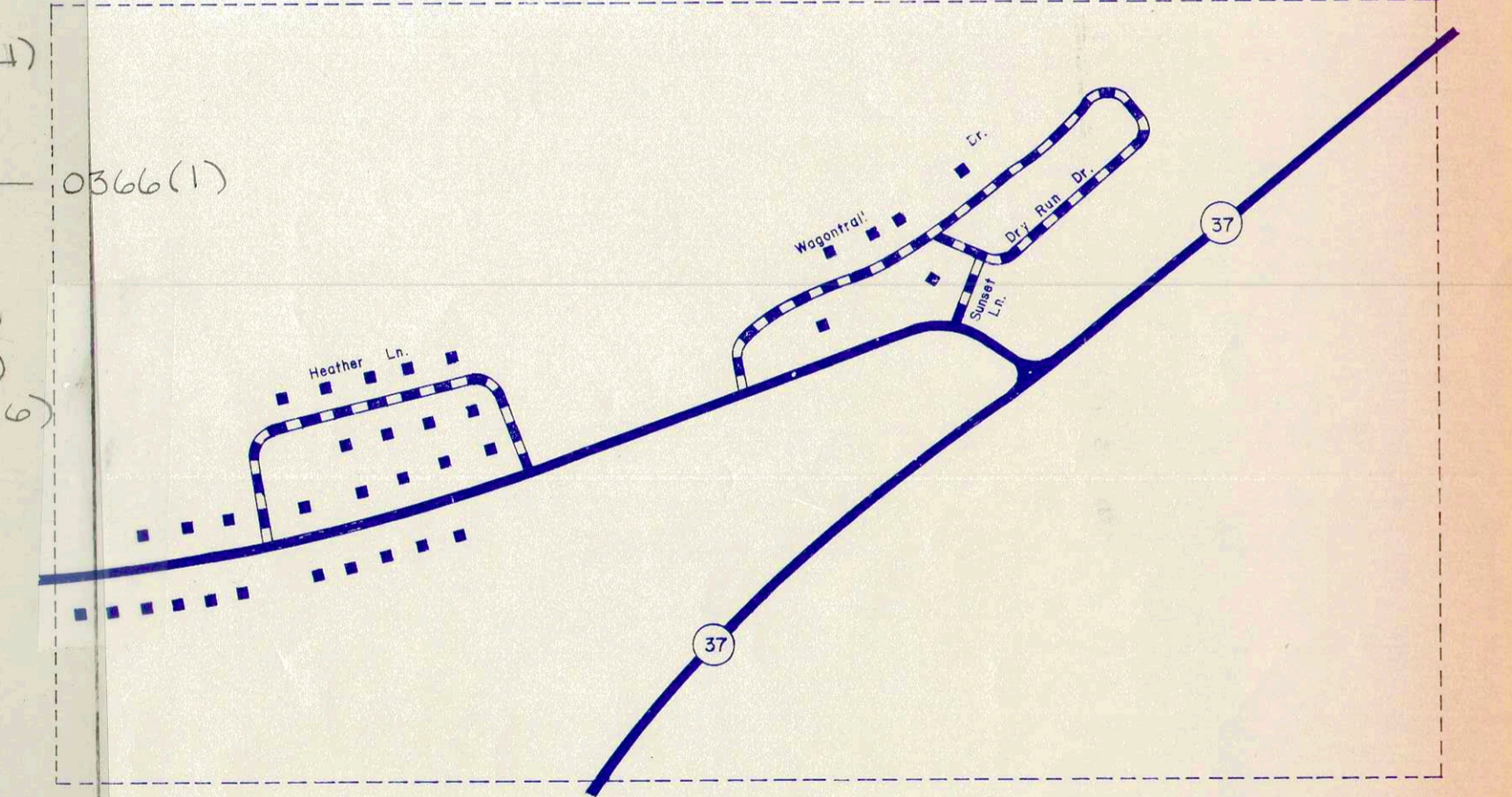

-9- CLARKSVILLE
UNINCORPORATED TOWN
HAMILTON COUNTY
INDIANA
LOCATED IN SECS. 1 & 12,
T18N, R5E

LEGEND

- INTERSTATE HIGHWAY SYSTEM
- UNITED STATES HIGHWAY
- STATE HIGHWAY SYSTEM
- DIVIDED HIGHWAY
- PAVED ROAD
- BITUMINOUS SURFACED ROAD
- METAL SURFACED ROAD
- GRADED AND DRAINED EARTH ROAD
- UNIMPROVED EARTH ROAD
- PRIMITIVE ROAD
- INTERCHANGE (LOCATED IN INCORPORATED CITY)
- INTERCHANGE
- HIGHWAY GRADE SEPARATION
- HIGHWAY BRIDGES (OVER 20' SPAN)
- CONCRETE FORD OR DIP
- FORD - ROAD ESTABLISHED
- FORD - PRIMITIVE ROAD
- RAILROAD (ANY NUMBER OF TRACKS) USED BY SINGLE OPERATING COMPANY
- RAILROAD STATION
- RAILROAD ABOVE
- RAILROAD BELOW
- NARROW STREAM
- WIDE STREAM (ARROWS POINT IN DIRECTION OF FLOW)
- NAVIGABLE STREAM (ARROWS POINT IN DIRECTION OF FLOW)
- DAM WITH ROAD
- DAM WITH LOCK
- DAM WITHOUT ROAD
- LEVEE
- LEVEE WITH ROAD
- TOLL FERRY
- STATE BOUNDARY
- COUNTY LINE
- CIVIL TOWNSHIP LINE
- CONGRESSIONAL TOWNSHIP LINE
- SECTION LINE
- STATE PARK BOUNDARY (NAME SHOWN)
- STATE FOREST OR STATE GAME PRESERVE BOUNDARY
- NATIONAL PARK BOUNDARY (NAME SHOWN)
- NATIONAL PURCHASE UNIT BOUNDARY
- AIRPORT BOUNDARY
- C COMMERCIAL, M MUNICIPAL, OR P PRIVATE AIRPORT
- A ARMY OR G NATIONAL GUARD LANDING FIELD
- STATE CAPITOL
- COUNTY SEAT
- OTHER CITIES AND VILLAGES
- DWELLING OR FARM UNIT
- ROW OR GROUP OF DWELLINGS CLOSELY SPACED
- SEASONAL DWELLING
- ROW OR GROUP OF SEASONAL DWELLINGS
- APARTMENT
- HOTEL
- MOTEL OR TOURIST COURT
- TRAILER COURT
- STORE OR SMALL BUSINESS ESTABLISHMENT
- TOWN HALL, GRANGE OR COMMUNITY HALL
- COMBINED DWELLING AND STORE
- POST OFFICE
- BARRACKS OR DORMITORIES FOR STUDENTS, WORKERS, OR OTHER EDUCATIONAL INSTITUTION
- SCHOOLHOUSE, MIGRANTS, ETC.
- CHURCH, OTHER RELIGIOUS INSTITUTION
- CEMETERY
- CHURCH WITH CEMETERY ADJACENT
- FRESH AIR FARM OR REST HOME
- HOSPITAL
- POLICE STATION
- FIRE ENGINE HOUSE
- ARMORY
- FAIR GROUND, RACE COURSE OR SPEEDWAY
- WAREHOUSE - GENERAL
- FACTORY OR INDUSTRIAL PLANT
- SAUGING OR PUMPING STATION (GENERAL)
- PUMPING STATION (GAS OR OIL)
- HIGHWAY GARAGE
- POWER PLANT
- BOOSTER STATION
- RADIO STATION (WITH CALL LETTERS)
- RADIO RANGE STATION
- TELEVISION RELAY STATION
- AGRICULTURAL EXPERIMENT STATION
- COUNTY FARM
- STOCK YARD
- GRAIN ELEVATOR
- NURSERY
- FRUIT OR NUT ORCHARD
- GREENHOUSE
- CORRECTIONAL INSTITUTION
- CAMP OR LODGE
- OBSERVATION OR LOOKOUT TOWER
- SAWMILL (STATIONARY)
- DRIVE-IN THEATRE
- RIFLE CLUB
- GOLF COURSE OR COUNTRY CLUB
- SMALL PARK
- WAYSIDE PARK
- BATHING BEACH OR SWIMMING POOL
- PICNIC GROUND
- PLAYGROUND, BALL FIELD, ETC.
- SCENIC SITE
- MINE, QUARRY OR OPEN CUT
- OIL OR GAS WELLS
- GROUP OF STORAGE TANKS (OIL OR GAS)
- QUARRY
- GRAVEL PIT
- GARBAGE OR RUBBISH DUMP

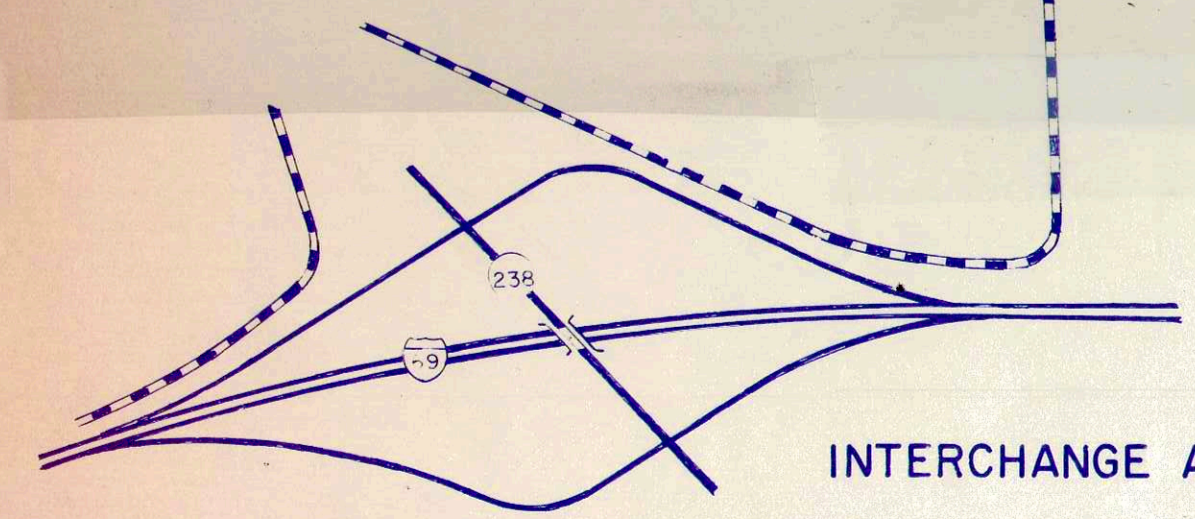

INTERCHANGE A

**GENERAL HIGHWAY AND TRANSPORTATION MAP
HAMILTON COUNTY
INDIANA**

PREPARED BY THE
DIVISION OF PLANNING
INDIANA STATE HIGHWAY COMMISSION
IN COOPERATION WITH THE
U. S. DEPARTMENT OF TRANSPORTATION
FEDERAL HIGHWAY ADMINISTRATION

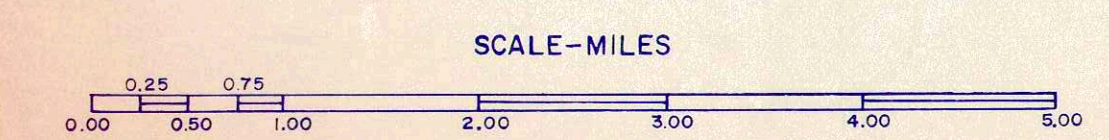

1976

POLYCONIC PROJECTION

Note: This map not copyrighted for information regarding availability, write:
Indiana State Highway Commission
Division of Planning
1200 State Office Building
Indianapolis, Ind. 46204

APPROVAL DATE

DATE	REVISIONS	BY

SHEET 1 OF 1 MAP SHEET AND NO SUPPLEMENTAL SHEETS

