

INSET NO. 7  
UNINCORPORATED AREA  
GRANT COUNTY  
INDIANA  
LOCATED IN SEC. 9, 10, 15, 16  
T.25N, R.7E.

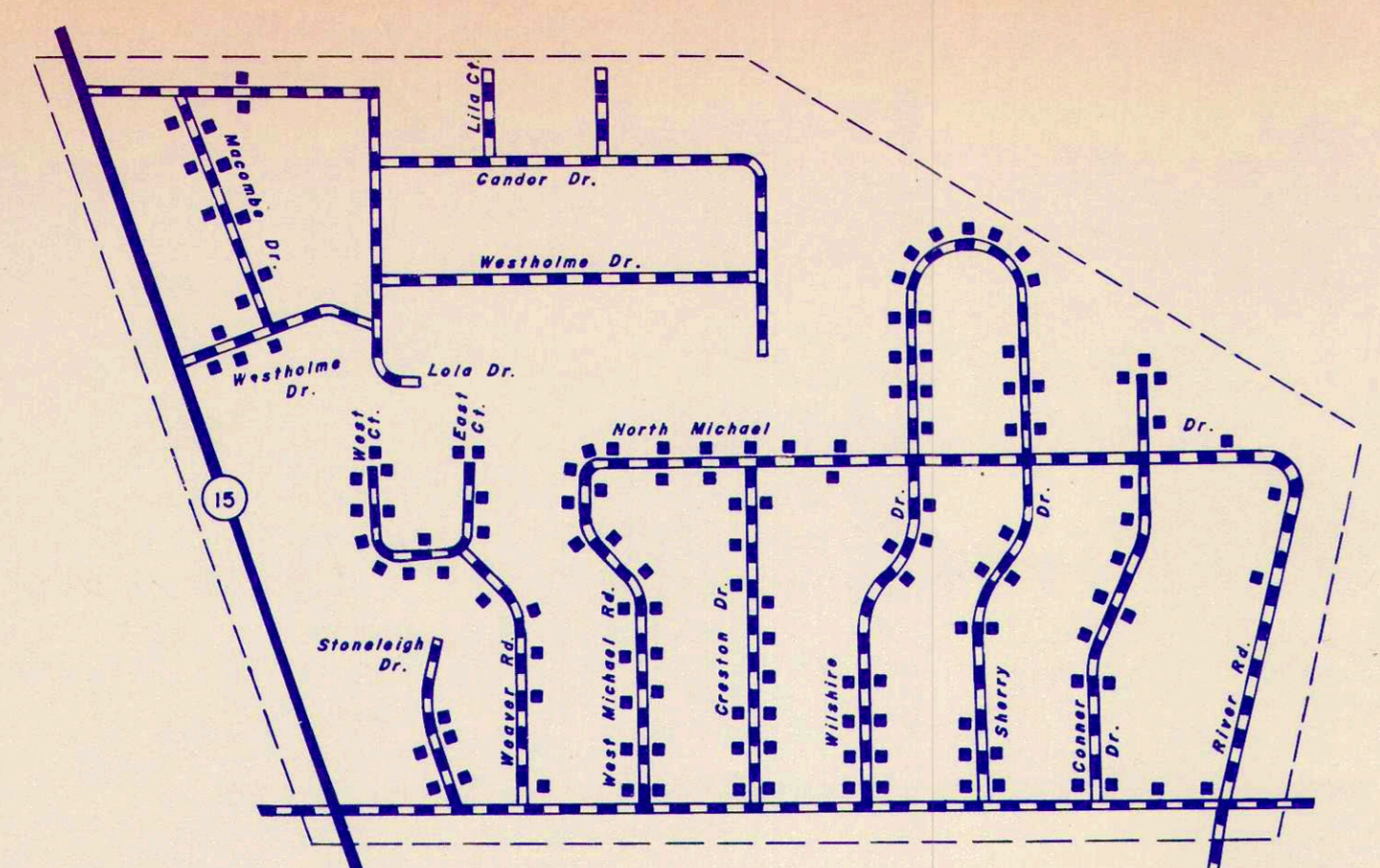

INSET NO. 8  
UNINCORPORATED AREA  
GRANT COUNTY  
INDIANA  
LOCATED IN SEC. 24  
T.25N, R.8E.

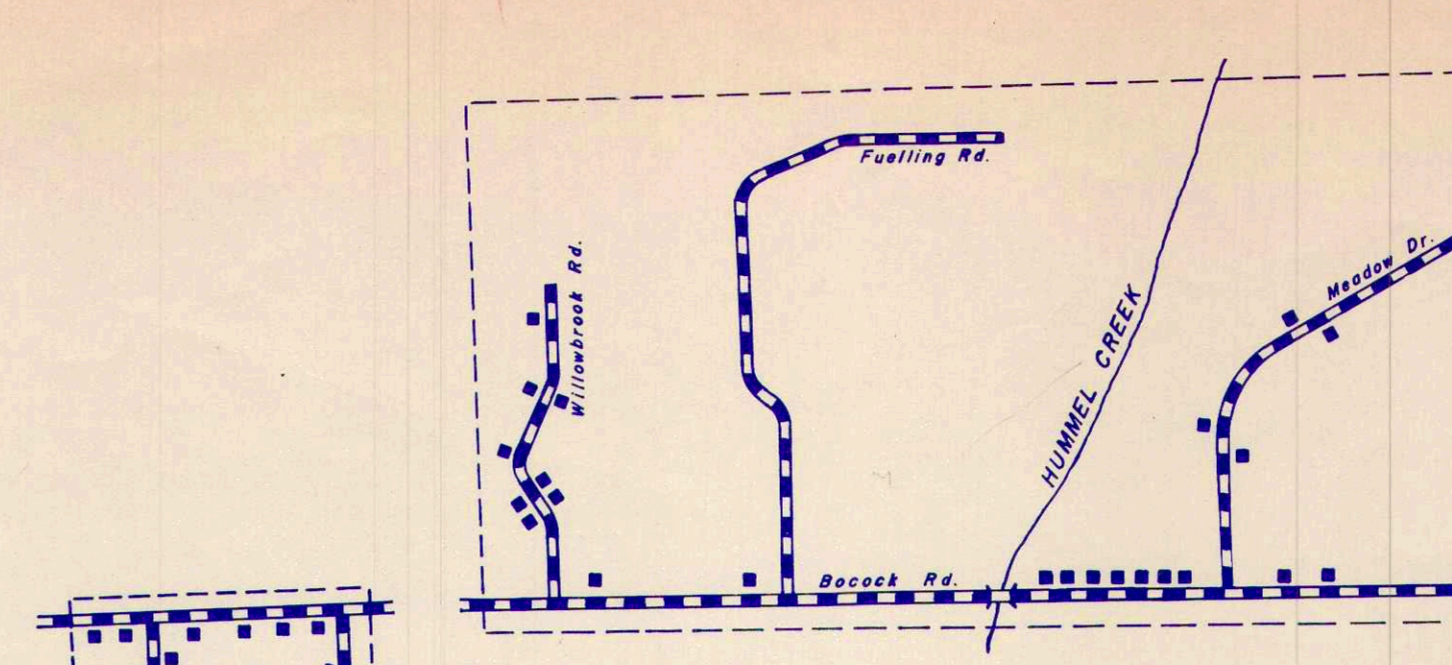

INSET NO. 10  
UNINCORPORATED AREA  
GRANT COUNTY  
INDIANA  
LOCATED IN SEC. 21  
T.25N, R.7E.

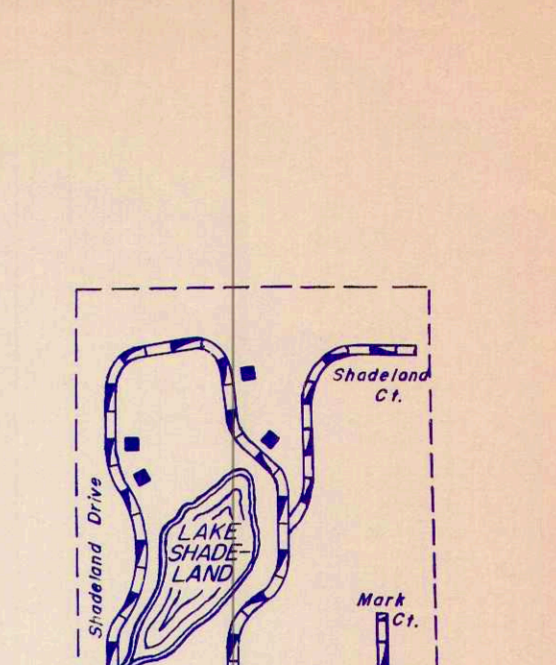

INSET NO. 11  
UNINCORPORATED AREA  
GRANT COUNTY  
INDIANA  
LOCATED IN SEC. 22  
T.25N, R.8E.

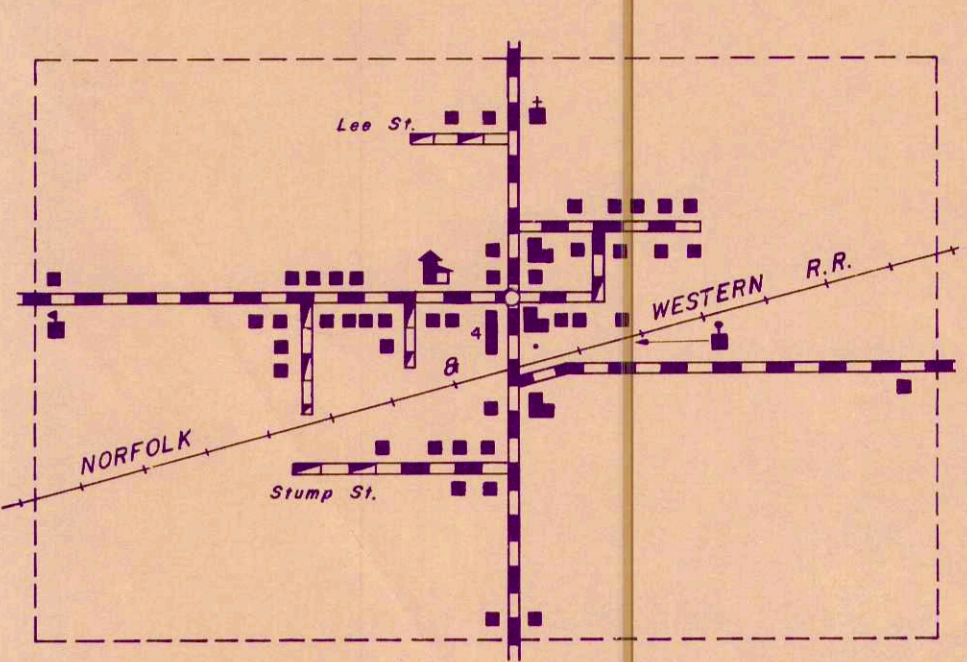

-12-  
LANDESS  
UNINCORPORATED TOWN  
GRANT COUNTY  
INDIANA  
LOCATED AT SEC. CORNERS 13, 18,  
19, 24, T.24N, R.87E.

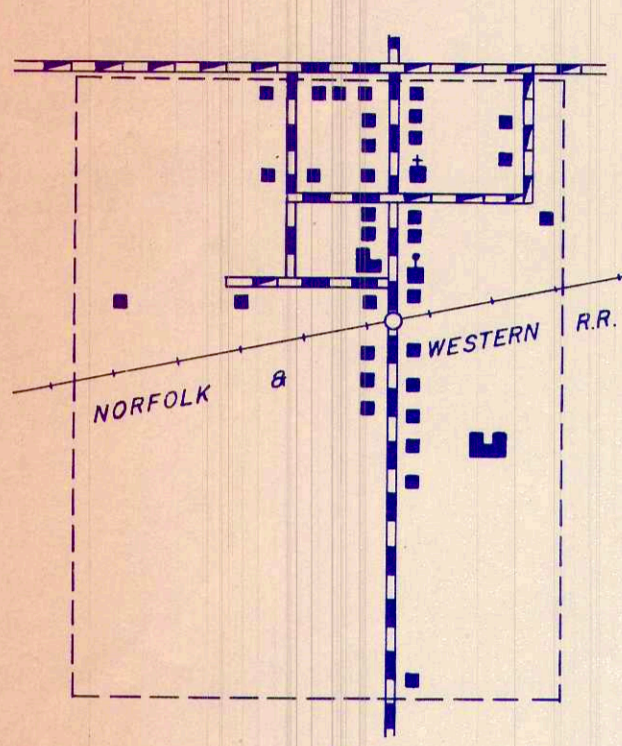

-5-  
HERBST  
UNINCORPORATED TOWN  
GRANT COUNTY  
INDIANA  
LOCATED IN S.E. 1/4 SEC. 24  
T.24N, R.7E. & SW 1/4 SEC. 19  
T.24N, R.7E.

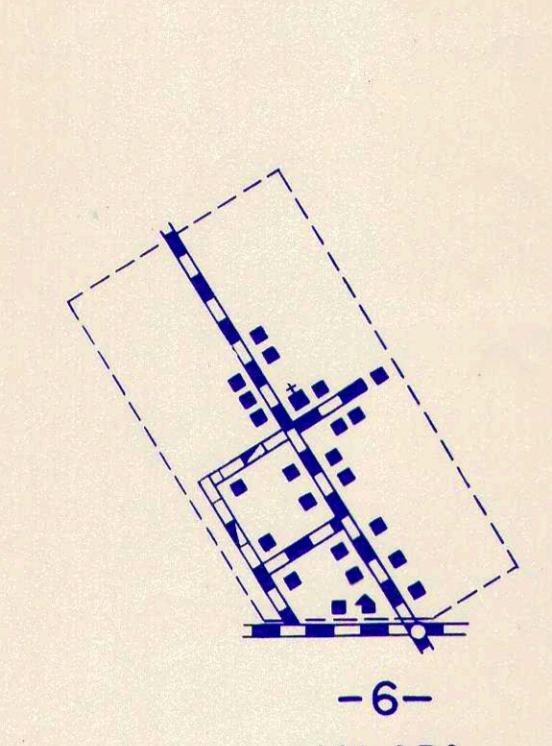

-6-  
JALAPA  
UNINCORPORATED TOWN  
GRANT COUNTY  
INDIANA  
LOCATED IN SW 1/4 SECTION 9  
T.25N, R.7E.

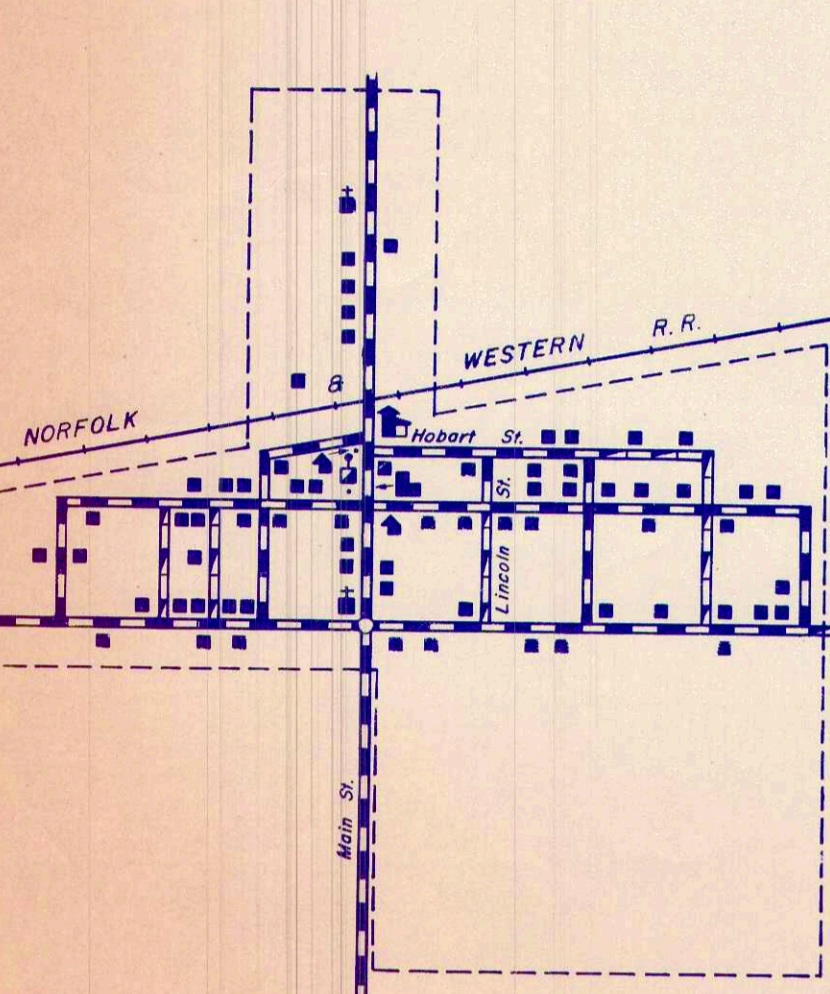

-4-  
SIMS  
UNINCORPORATED TOWN  
GRANT COUNTY  
INDIANA  
LOCATED IN W. 1/2 SEC. 28  
T.24N, R.8E.

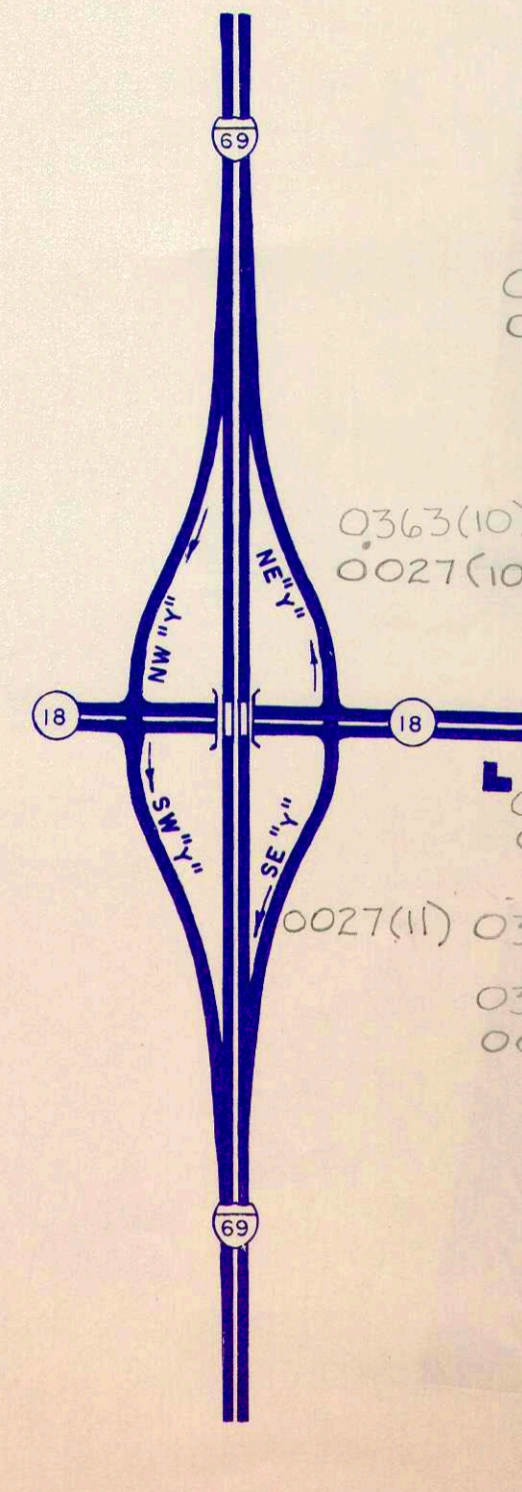

INTERCHANGE C

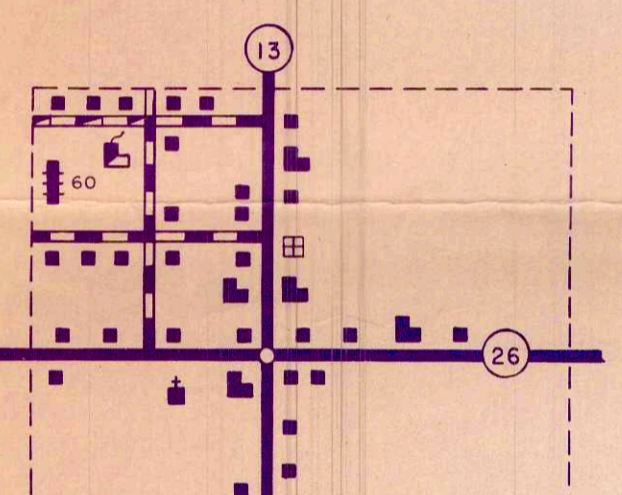

-2-  
POINT ISABEL  
UNINCORPORATED TOWN  
GRANT COUNTY  
INDIANA  
LOCATED AT SEC. CORNERS  
22, 23, 26, 27, T.23N, R.8E.

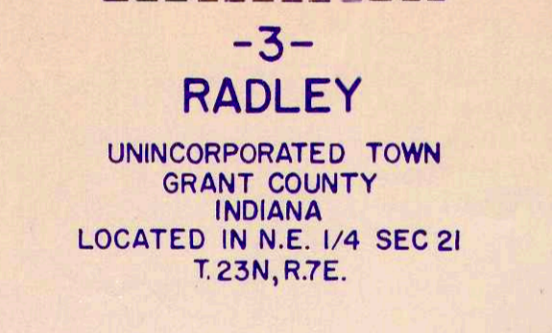

-3-  
RADLEY  
UNINCORPORATED TOWN  
GRANT COUNTY  
INDIANA  
LOCATED IN N.E. 1/4 SEC. 21  
T.23N, R.7E.

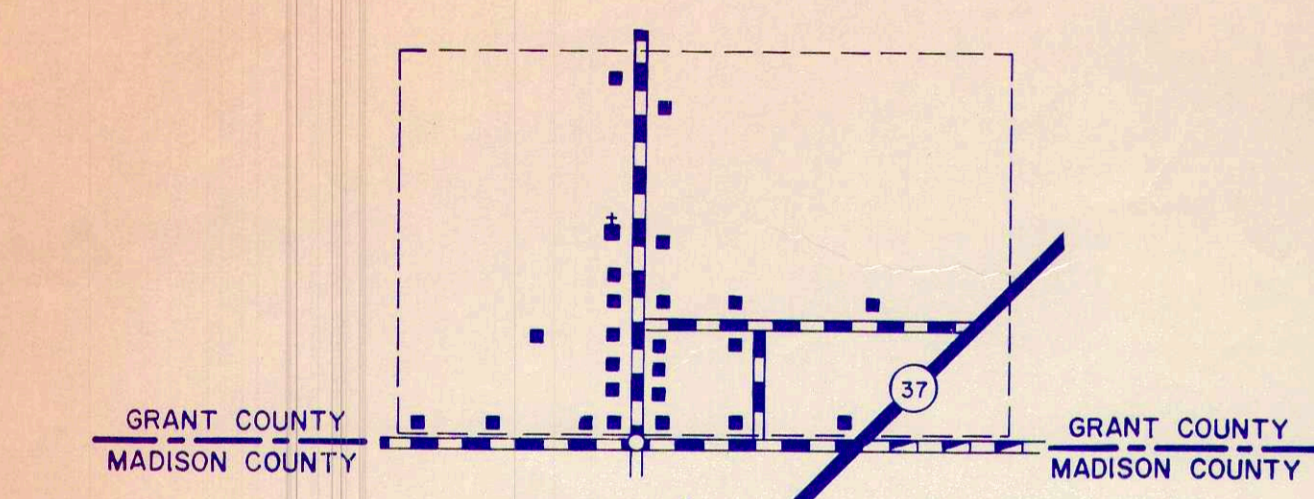

-1-  
RIGDON  
UNINCORPORATED TOWN  
GRANT COUNTY  
INDIANA  
LOCATED AT SEC. CORNERS  
18, 12, 12, 22N, R.6E, 60, 122N, R.6E.

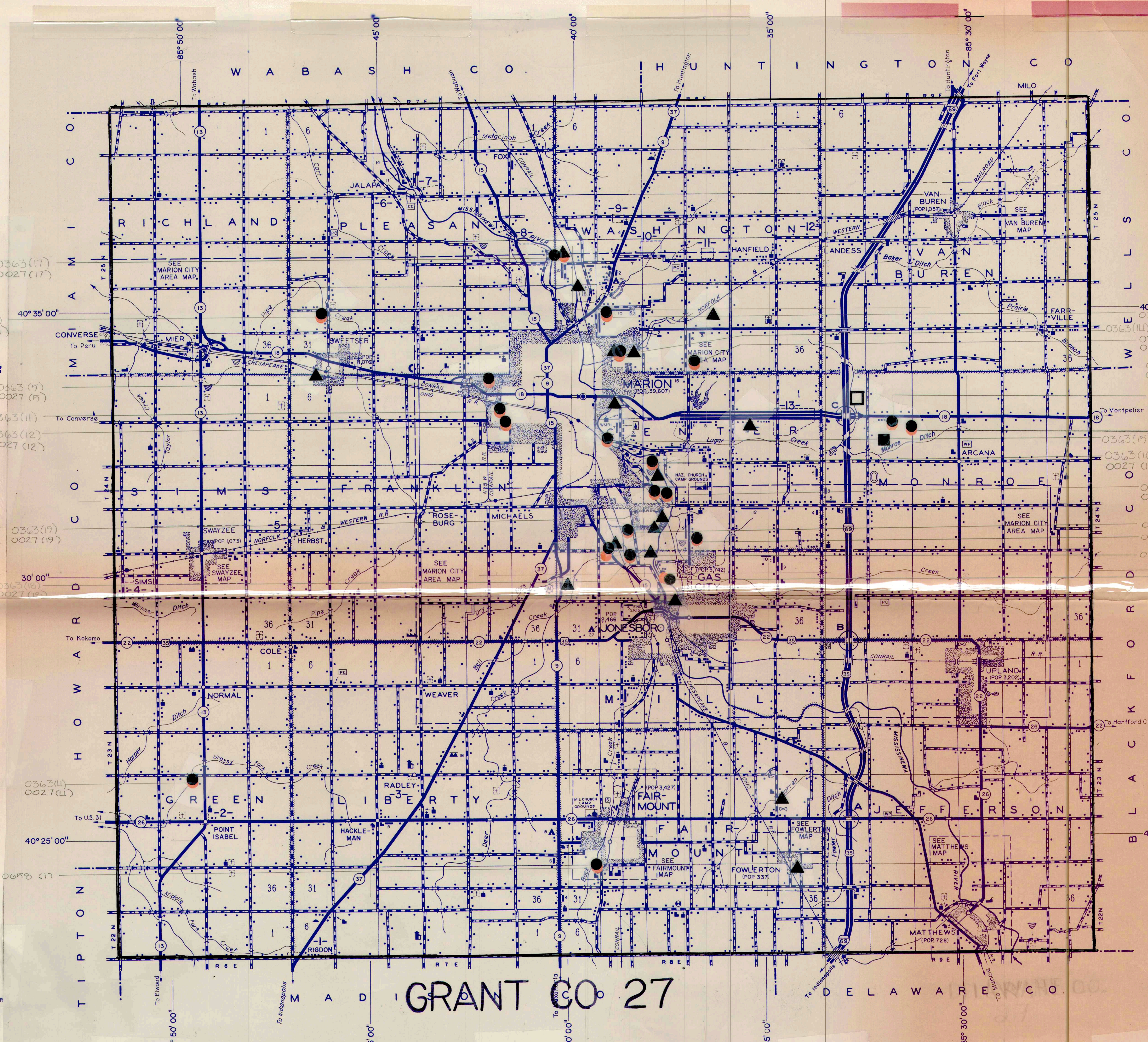

LEGEND

- INTERSTATE HIGHWAY SYSTEM
- UNITED STATES HIGHWAY
- STATE HIGHWAY SYSTEM
- DIVIDED HIGHWAY
- PAVED ROAD
- BITUMINOUS SURFACED ROAD
- METAL SURFACED ROAD
- GRADED AND DRAINED EARTH ROAD
- UNIMPROVED EARTH ROAD
- PRIMITIVE ROAD
- INTERCHANGE (LOCATED IN INCORPORATED CITY)
- INTERCHANGE
- HIGHWAY GRADE SEPARATION
- HIGHWAY BRIDGES (OVER 20' SPAN)
- CONCRETE FORD OR DIP
- FORD - ROAD ESTABLISHED
- FORD - PRIMITIVE ROAD
- RAILROAD (ANY NUMBER OF TRACKS) USED BY SINGLE OPERATING COMPANY
- RAILROAD STATION
- RAILROAD ABOVE
- RAILROAD BELOW
- NARROW STREAM
- WIDE STREAM
- NAVIGABLE STREAM (ARROWS POINT IN DIRECTION OF FLOW)
- DAM WITH ROAD
- DAM WITH LOCK
- DAM WITHOUT ROAD
- LEVEE WITH ROAD
- TOLL FERRY
- STATE BOUNDARY
- COUNTY LINE
- CIVIL TOWNSHIP LINE
- CORPORATE LINE
- INSET LIMITS
- CONGRESSIONAL TOWNSHIP LINE
- SECTION LINE
- STATE PARK BOUNDARY (NAME SHOWN)
- STATE FOREST OR STATE GAME PRESERVE BOUNDARY
- NATIONAL PARK BOUNDARY (NAME SHOWN)
- NATIONAL PURCHASE UNIT BOUNDARY
- AIRPORT BOUNDARY
- C COMMERCIAL, M MUNICIPAL, OR P PRIVATE AIRPORT
- A ARMY OR NATIONAL GUARD LANDING FIELD
- STATE CAPITOL
- COUNTY SEAT
- OTHER CITIES AND VILLAGES
- DWELLING OR FARM UNIT
- ROW OR GROUP OF DWELLINGS CLOSELY SPACED
- SEASONAL DWELLING
- ROW OR GROUP OF SEASONAL DWELLINGS
- APARTMENT
- HOTEL
- MOTEL OR TOURIST COURT
- TRAILER COURT
- STORE OR SMALL BUSINESS ESTABLISHMENT
- TOWN HALL, GRANGE OR COMMUNITY HALL
- COMBINED DWELLING AND STORE
- POST OFFICE
- BARRACKS OR DORMITORIES FOR STUDENTS WORKERS, MIGRANTS, ETC.
- SCHOOLHOUSE, OTHER EDUCATIONAL INSTITUTION
- CHURCH, OTHER RELIGIOUS INSTITUTION
- CEMETERY
- CHURCH WITH CEMETERY ADJACENT
- FRESH AIR FARM OR REST HOME
- HOSPITAL
- POLICE STATION
- FIRE ENGINE HOUSE
- ARMORY
- FAIR GROUND, RACE COURSE OR SPEEDWAY
- WAREHOUSE - GENERAL
- FACTORY OR INDUSTRIAL PLANT
- GASOLIN OR PUMPING STATION (GENERAL)
- PUMPING STATION (GAS OR OIL)
- HIGHWAY GARAGE
- POWER PLANT
- BOOSTER STATION
- RADIO STATION (WITH CALL LETTERS) OR TELEVISION RELAY STATION
- AGRICULTURAL EXPERIMENT STATION
- COUNTY FARM
- STOCK YARD
- GRAIN ELEVATOR
- NURSERY
- FRUIT OR NUT ORCHARD
- GREENHOUSE
- CORRECTIONAL INSTITUTION
- CAMP OR LODGE
- OBSERVATION OR LOOKOUT TOWER
- SAWMILL (STATIONARY)
- DRIVE-IN THEATRE
- RIFLE CLUB
- GOLF COURSE OR COUNTRY CLUB
- SMALL PARK
- WAYSIDE PARK
- BATHING BEACH OR SWIMMING POOL
- PICNIC GROUND
- PLAYGROUND, BALL FIELD, ETC.
- SCENIC SITE
- MINE, QUARRY OR OPEN CUT
- OIL OR GAS WELLS
- GROUP OF STORAGE TANKS (OIL OR GAS) STOPS
- GRAVEL PIT
- CAPRAE OR RUBBISH DUMP

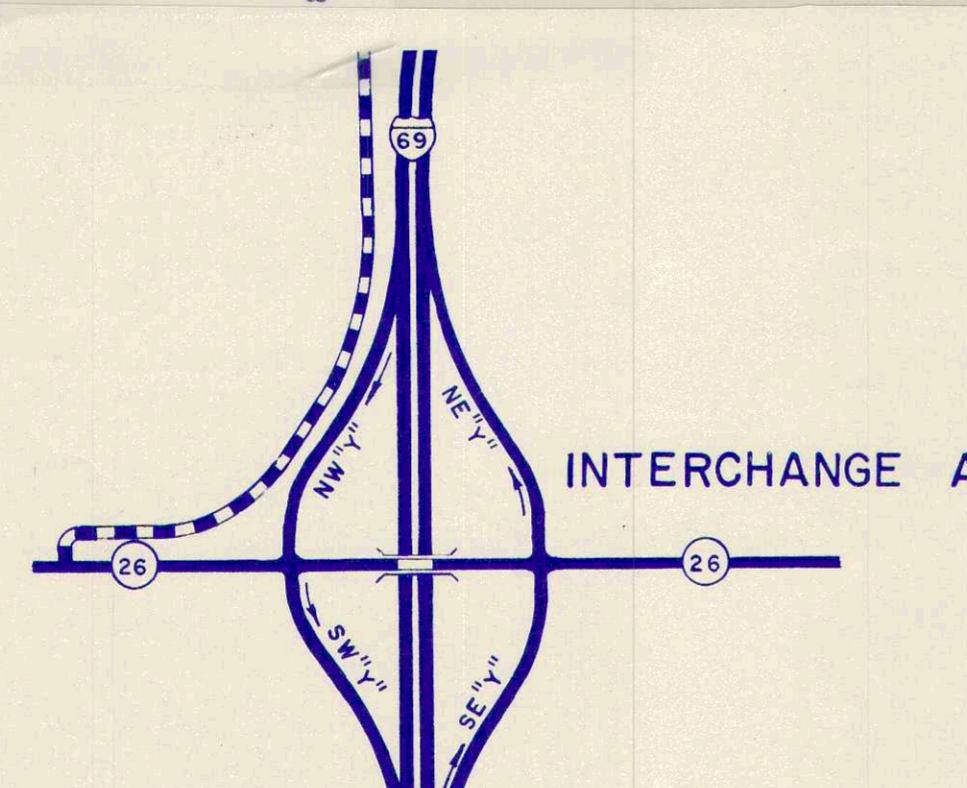

INTERCHANGE A

GENERAL HIGHWAY AND TRANSPORTATION MAP  
GRANT COUNTY  
INDIANA

\*The Area Plan Commission in Marion, Inc. sent back a map and instrument with information (case # on 27 0363), since then, the following agencies returned their copies of this instrument. All are not listed by respondent number alongside the instrument.  
01 27 0027  
10 27 1161  
03 27 0171

PREPARED BY THE  
DIVISION OF PLANNING  
INDIANA STATE HIGHWAY COMMISSION  
IN COOPERATION WITH THE  
U. S. DEPARTMENT OF TRANSPORTATION  
FEDERAL HIGHWAY ADMINISTRATION

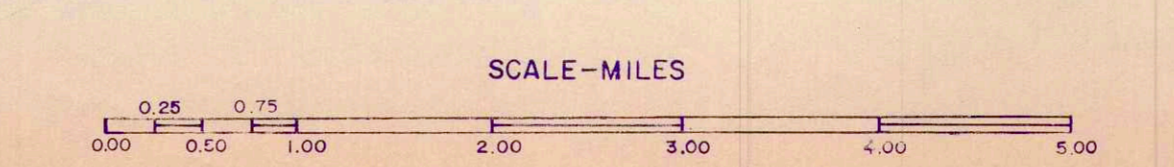

1979

POLYCONIC PROJECTION  
MAP CHECKED WITH AERIAL PHOTOGRAPHS DATED 1976

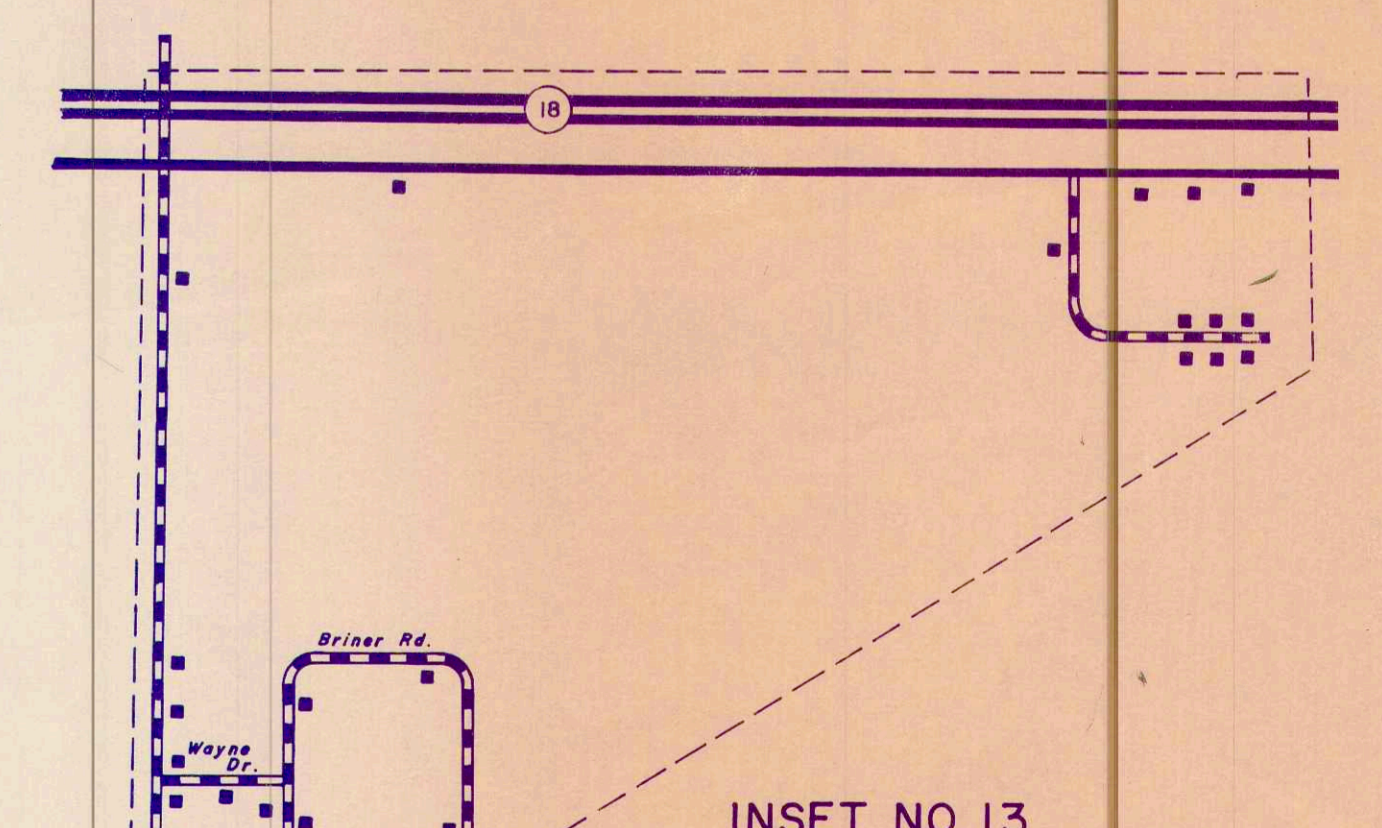

INSET NO. 13  
UNINCORPORATED AREA  
GRANT COUNTY  
INDIANA  
LOCATED IN SEC. 12  
T.24N, R.8E.

APPROVAL DATE \_\_\_\_\_

DATE	REVISIONS	BY

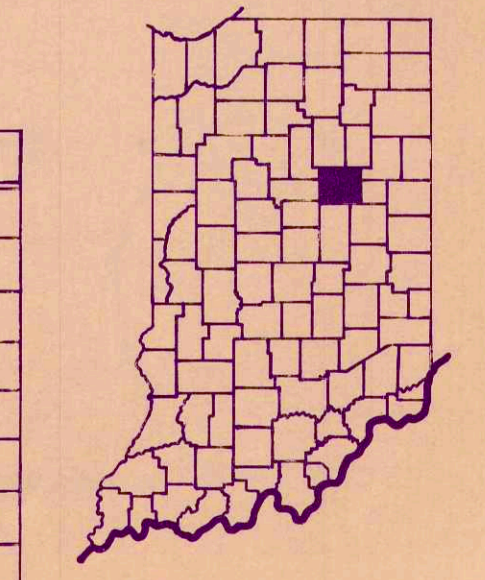

Note: This map not copyrighted for information regarding availability, write Indiana State Highway Commission, Division of Planning, 1201 State Office Building, Indianapolis, Ind. 46204