

INSET NO. 4
UNINCORPORATED TOWN
FOUNTAIN COUNTY
INDIANA
LOCATED IN SEC. 34
T18N-R9W

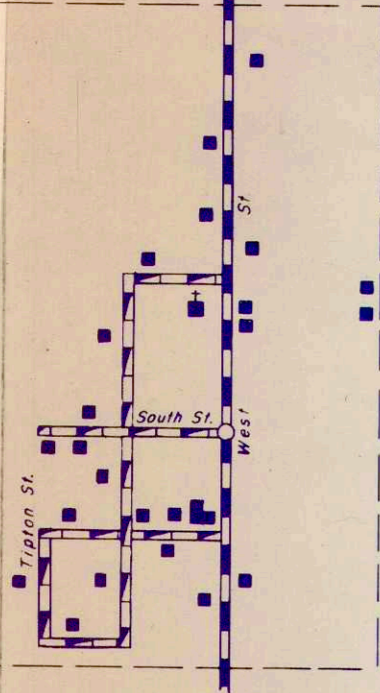

INSET NO. 5
UNINCORPORATED TOWN
FOUNTAIN COUNTY
INDIANA
LOCATED IN SEC. 1
T18N-R9W

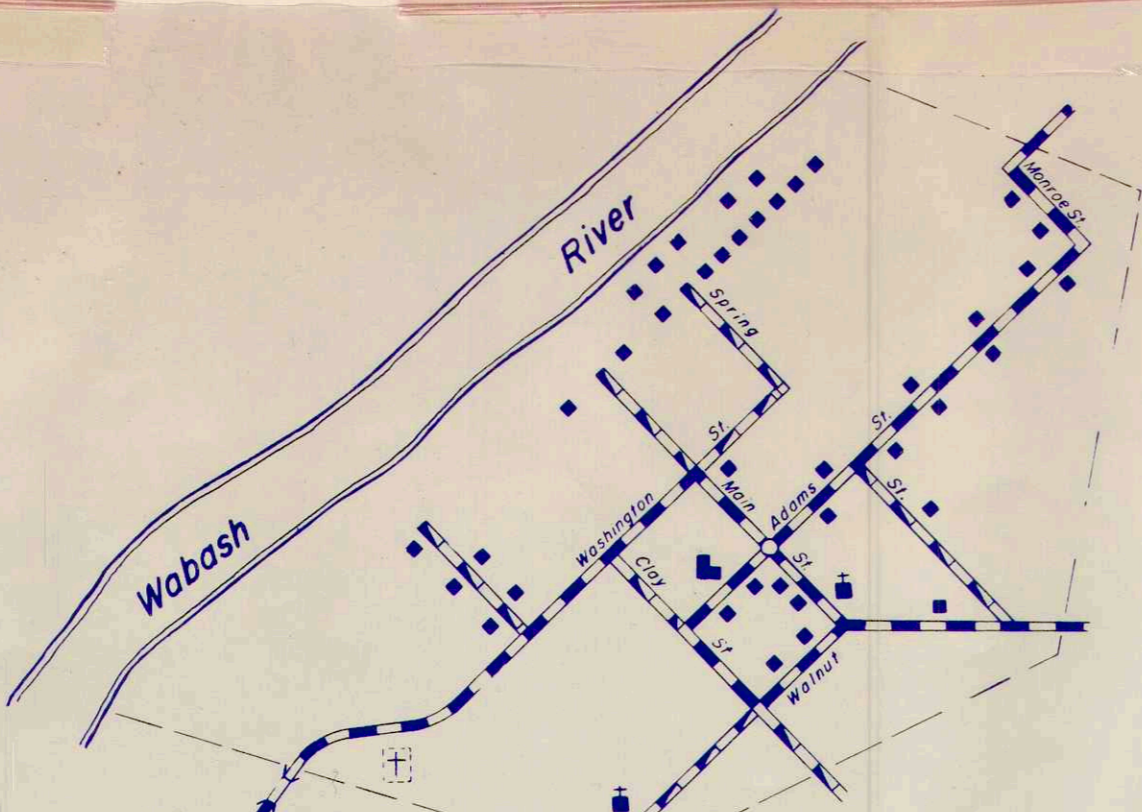

INSET NO. 6
UNINCORPORATED TOWN
FOUNTAIN COUNTY
INDIANA
LOCATED IN SEC. 32
T21N-R8W

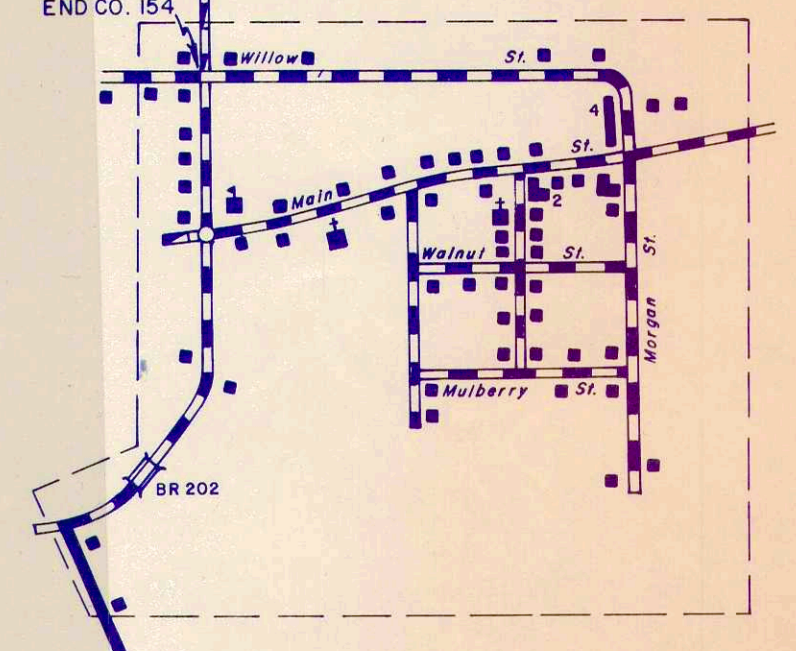

INSET NO. 7
UNINCORPORATED TOWN
FOUNTAIN COUNTY
INDIANA
LOCATED IN SEC. 19
T20N-R7W

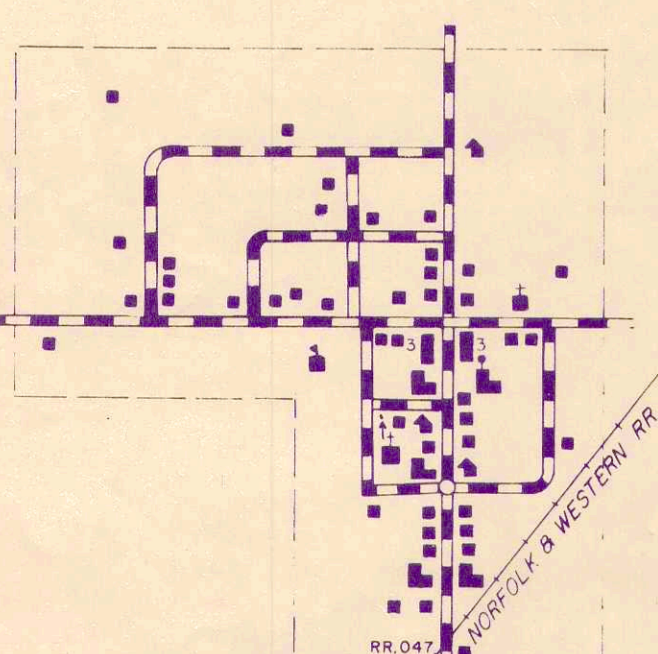

INSET NO. 2
UNINCORPORATED TOWN
FOUNTAIN COUNTY
INDIANA
LOCATED IN SEC. 16
T20N-R7W

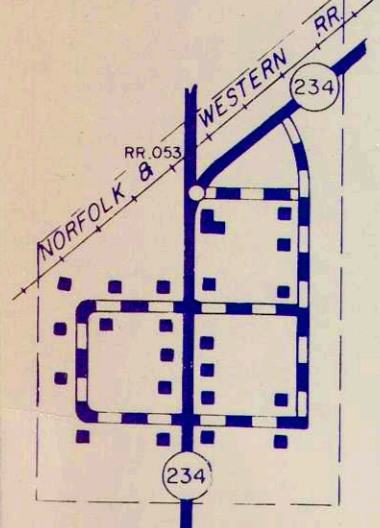

INSET NO. 3
UNINCORPORATED TOWN
FOUNTAIN COUNTY
INDIANA
LOCATED IN SEC. 35
T18N-R9W

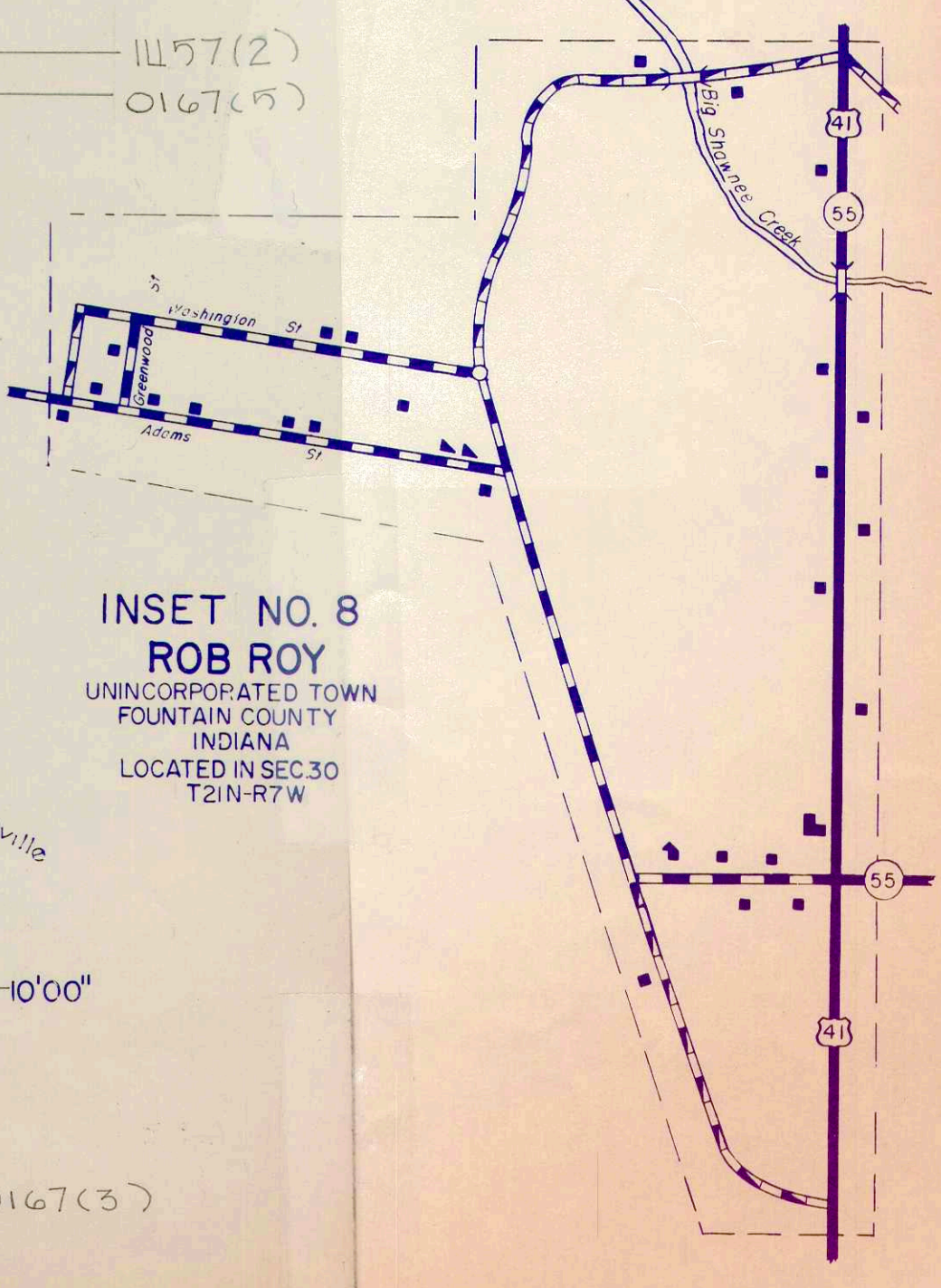

INSET NO. 8
UNINCORPORATED TOWN
FOUNTAIN COUNTY
INDIANA
LOCATED IN SEC. 30
T21N-R7W

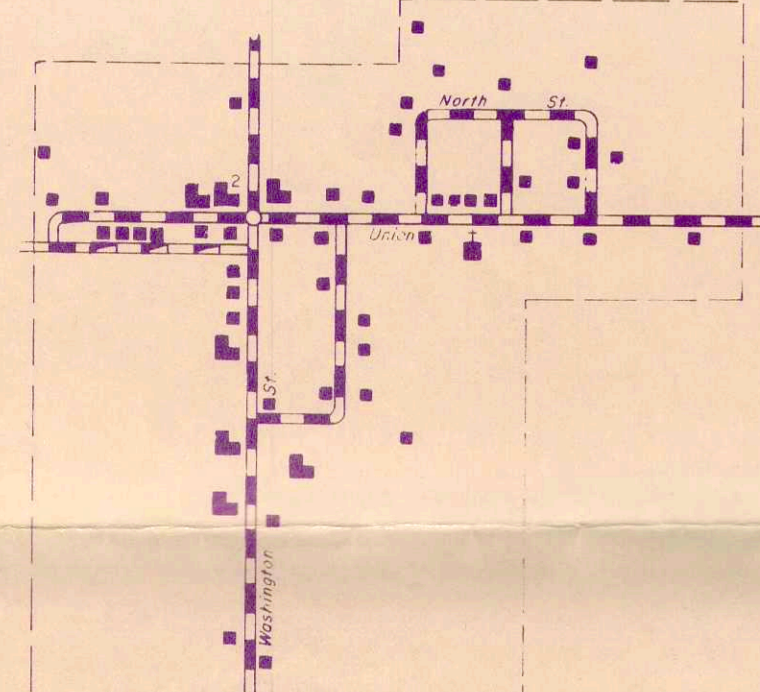

INSET NO. 1
UNINCORPORATED TOWN
FOUNTAIN COUNTY
INDIANA
LOCATED IN SEC. 7
T18N-R9W

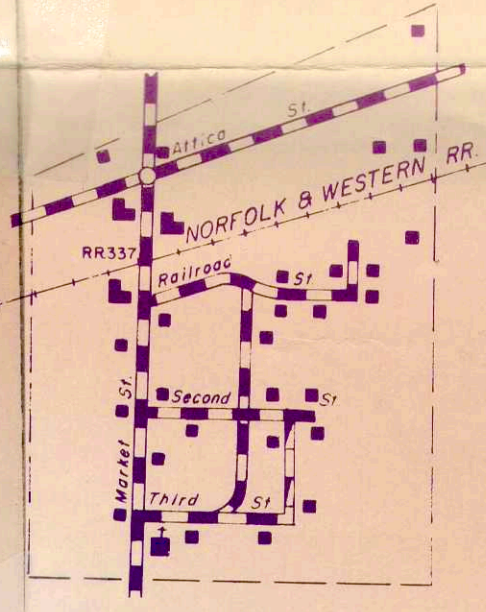

INSET NO. 9
UNINCORPORATED TOWN
FOUNTAIN COUNTY
INDIANA
LOCATED IN SEC. 25
T22N-R7W

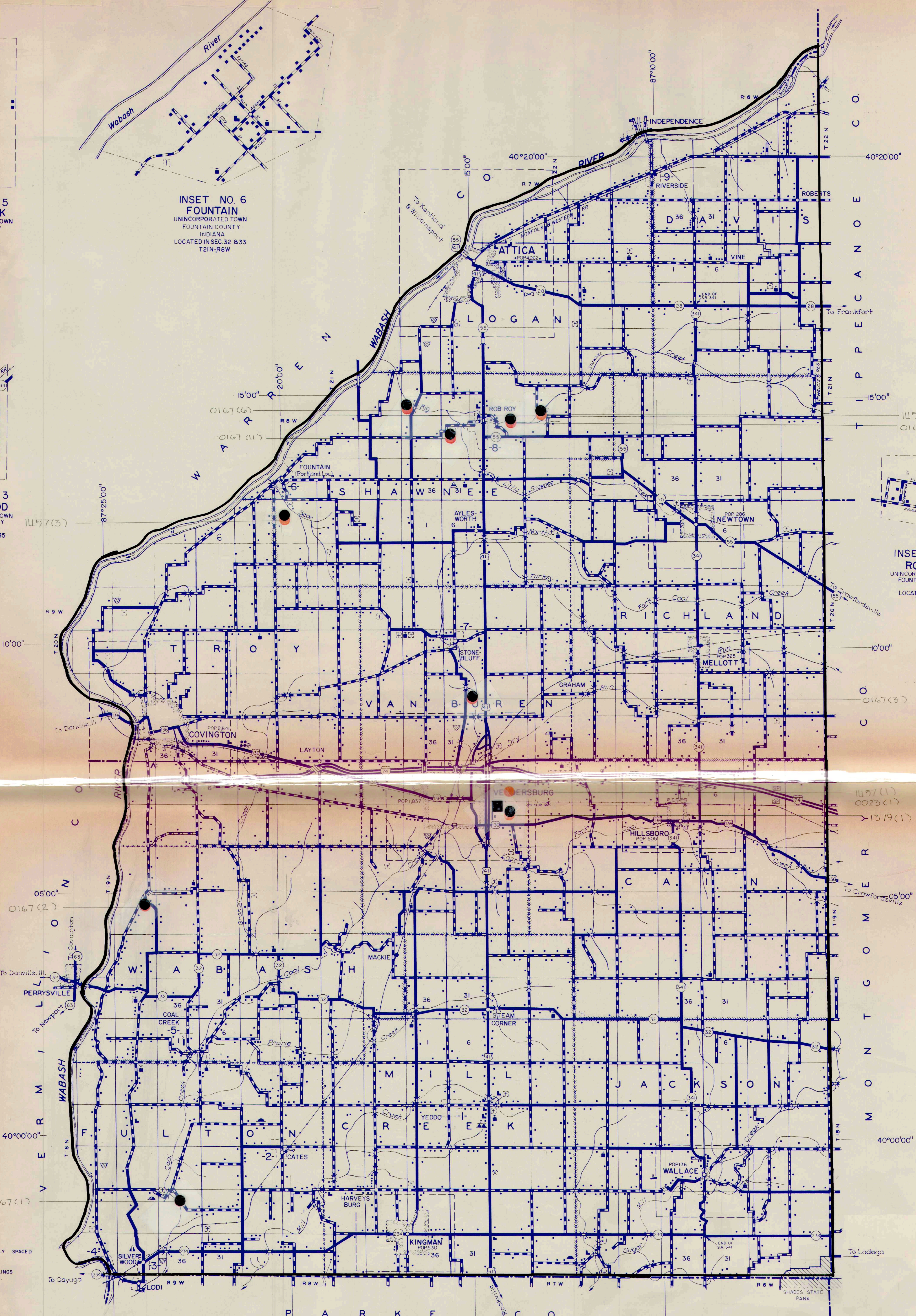

LEGEND

- INTERSTATE HIGHWAY SYSTEM
- UNITED STATES HIGHWAY
- STATE HIGHWAY SYSTEM
- DIVIDED HIGHWAY
- PAVED ROAD
- BITUMINOUS SURFACED ROAD
- METAL SURFACED ROAD
- GRADED AND DRAINED EARTH ROAD
- UNIMPROVED EARTH ROAD
- PRIMITIVE ROAD
- INTERCHANGE (LOCATED IN INCORPORATED CITY)
- INTERCHANGE
- HIGHWAY GRADE SEPARATION
- HIGHWAY BRIDGES (OVER 20' SPAN)
- CONCRETE FORD OR DIP
- FORD - ROAD ESTABLISHED
- FORD - PRIMITIVE ROAD
- RAILROAD (ANY NUMBER OF TRACKS USED BY SINGLE OPERATING COMPANY)
- RAILROAD STATION
- RAILROAD ABOVE
- RAILROAD BELOW
- WIDE STREAM (ARROWS POINT IN DIRECTION OF FLOW)
- NAVIGABLE STREAM (ARROWS POINT IN DIRECTION OF FLOW)
- DAM WITH ROAD
- DAM WITH LOCK
- DAM WITHOUT ROAD
- LEVEE
- LEVEE WITH ROAD
- TOLL FERRY
- STATE BOUNDARY
- COUNTY LINE
- CIVIL TOWNSHIP LINE
- CORPORATE LINE
- INSET LIMITS
- CONGRESSIONAL TOWNSHIP LINE
- SECTION LINE
- STATE PARK BOUNDARY (NAME SHOWN)
- STATE FOREST OR STATE GAME PRESERVE BOUNDARY (NAME SHOWN)
- NATIONAL PARK BOUNDARY (NAME SHOWN)
- NATIONAL PURCHASE UNIT BOUNDARY
- AIRPORT BOUNDARY
- C COMMERCIAL, M MUNICIPAL, OR P PRIVATE AIRPORT
- A ARMY OR G NATIONAL GUARD LANDING FIELD
- STATE CAPITOL
- COUNTY SEAT
- OTHER CITIES AND VILLAGES
- DWELLING OR FARM UNIT
- ROW OR GROUP OF DWELLINGS CLOSELY SPACED
- SEASONAL DWELLING
- ROW OR GROUP OF SEASONAL DWELLINGS
- APARTMENT
- HOTEL
- MOTEL OR TOURIST COURT
- TRAILER COURT
- STORE OR SMALL BUSINESS ESTABLISHMENT
- TOWN HALL, GRANGE OR COMMUNITY HALL
- COMBINED DWELLING AND STORE
- POST OFFICE
- BARRACKS OR DORMITORIES FOR STUDENTS WORKERS, MIGRANTS, ETC.
- SCHOOLHOUSE, OTHER EDUCATIONAL INSTITUTION
- CHURCH, OTHER RELIGIOUS INSTITUTION
- CEMETERY
- CHURCH WITH CEMETERY ADJACENT
- FRESH AIR FARM OR REST HOME
- HOSPITAL
- POLICE STATION
- FIRE ENGINE HOUSE
- ARMORY
- FAIR GROUND, RACE COURSE OR SPEEDWAY
- WAREHOUSE - GENERAL
- FACTORY OR INDUSTRIAL PLANT
- GAUGING OR PUMPING STATION (GENERAL)
- PUMPING STATION (GAS OR OIL)
- HIGHWAY GARAGE
- POWER PLANT
- BOOSTER STATION
- RADIO STATION (WITH CALL LETTERS)
- RADIO RANGE STATION
- TELEVISION RELAY STATION
- AGRICULTURAL EXPERIMENT STATION
- COUNTY FARM
- NURSERY
- FRUIT OR NUT ORCHARD
- GREENHOUSE
- CORRECTIONAL INSTITUTION
- CAMP OR LODGE
- OBSERVATION OR LOOKOUT TOWER
- SAWMILL (STATIONARY)
- DRIVE-IN THEATRE
- RIFLE CLUB
- GOLF COURSE OR COUNTRY CLUB
- SMALL PARK
- WAYSIDE PARK
- BATHING BEACH OR SWIMMING POOL
- PICNIC GROUND
- PLAYGROUND, BALL FIELD, ETC.
- SCENIC SITE
- MINE, QUARRY OR OPEN CUT
- OIL OR GAS WELLS
- GROUP OF STORAGE TANKS (OIL OR GAS)
- QUARRY
- GRAVEL PIT
- GARBAGE OR RUBBISH DUMP

FOUNTAIN CO 23

**GENERAL HIGHWAY AND TRANSPORTATION MAP
FOUNTAIN COUNTY
INDIANA**

PREPARED BY THE
DIVISION OF PLANNING
INDIANA STATE HIGHWAY COMMISSION
IN COOPERATION WITH THE
U.S. DEPARTMENT OF TRANSPORTATION
FEDERAL HIGHWAY ADMINISTRATION
BUREAU OF PUBLIC ROADS

SCALE - MILES
0 0.25 0.50 1.00 2.00 3.00 4.00 5.00

DECEMBER 31, 1978
POLYCONIC PROJECTION

APPROVAL DATE _____

DATE	REVISIONS	BY

Note: This map was copyrighted for information regarding availability, write:
Indiana State Highway Commission
Division of Planning
1205 State Office Building
Indianapolis, Ind. 46204

