

INSET NO. 10
UNINCORPORATED TOWN
CLINTON COUNTY
INDIANA
LOCATED IN SECTIONS
2, 3, 4, 5, 6, 7, 8, 9, 10
T21N R1E

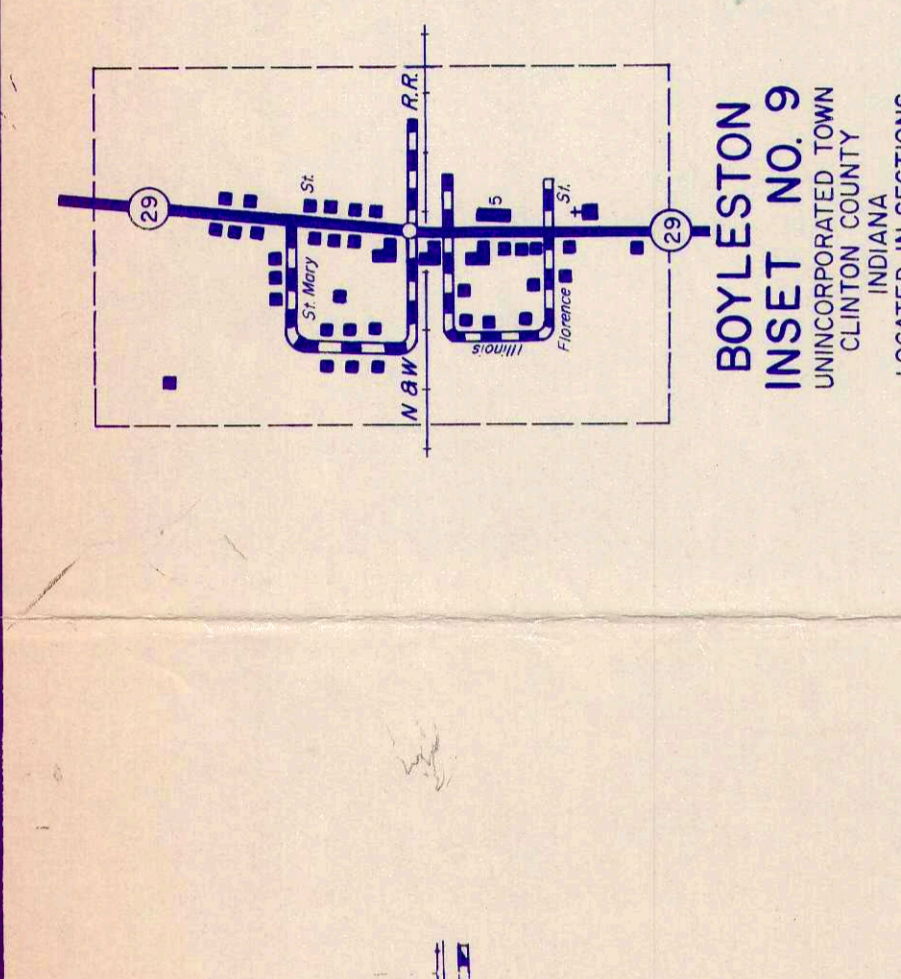

BOYLESTON
INSET NO. 9
UNINCORPORATED TOWN
CLINTON COUNTY
INDIANA
LOCATED IN SECTIONS
2, 3, 4, 5, 6, 7, 8, 9
T21N R1E

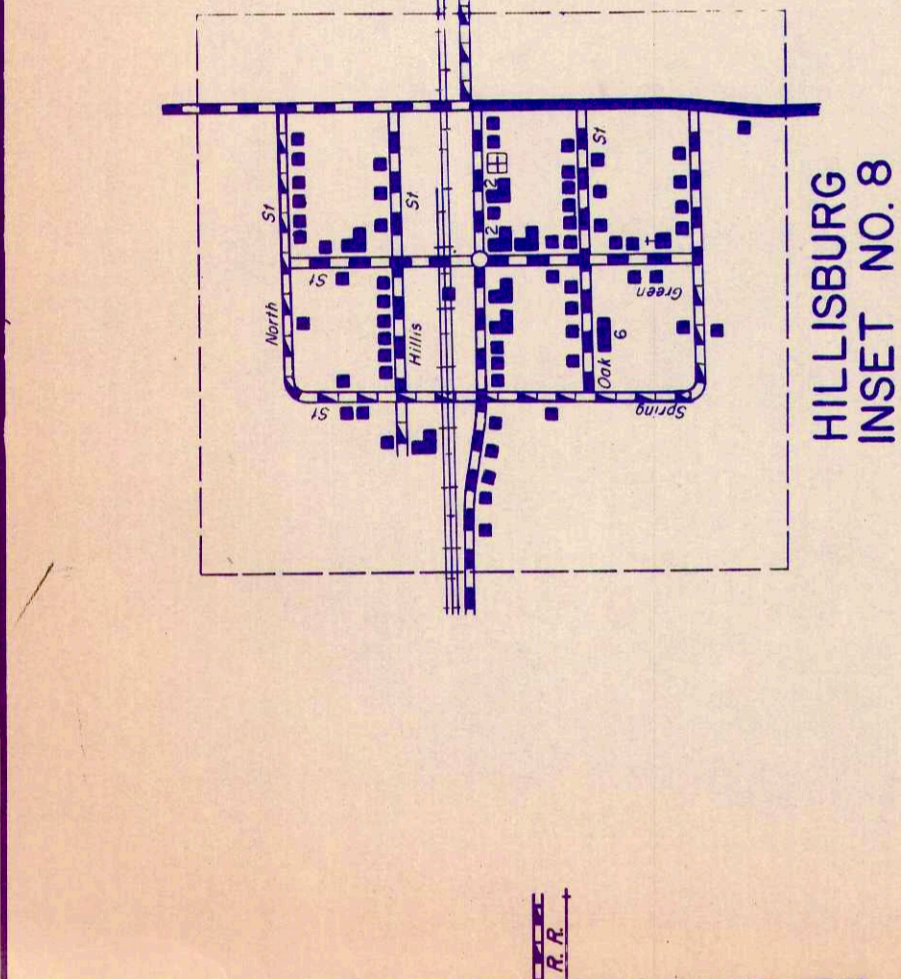

HILLSBURG
INSET NO. 8
UNINCORPORATED TOWN
CLINTON COUNTY
INDIANA
LOCATED IN SECTIONS
1, 2, 3, 4, 5, 6, 7, 8
T21N R2E

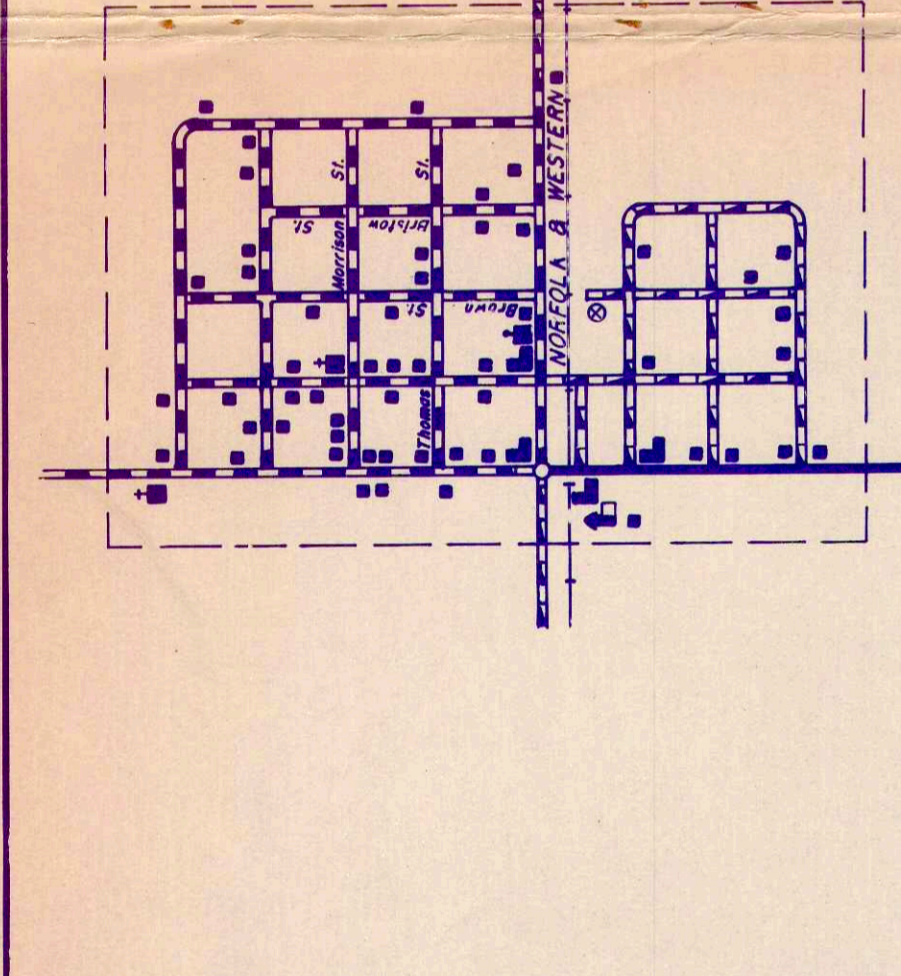

SCIRCLEVILLE
INSET NO. 7
UNINCORPORATED TOWN
CLINTON COUNTY
INDIANA
LOCATED IN SECTIONS
3, 4, 5, 6, 7, 8, 9, 10
T21N R2E

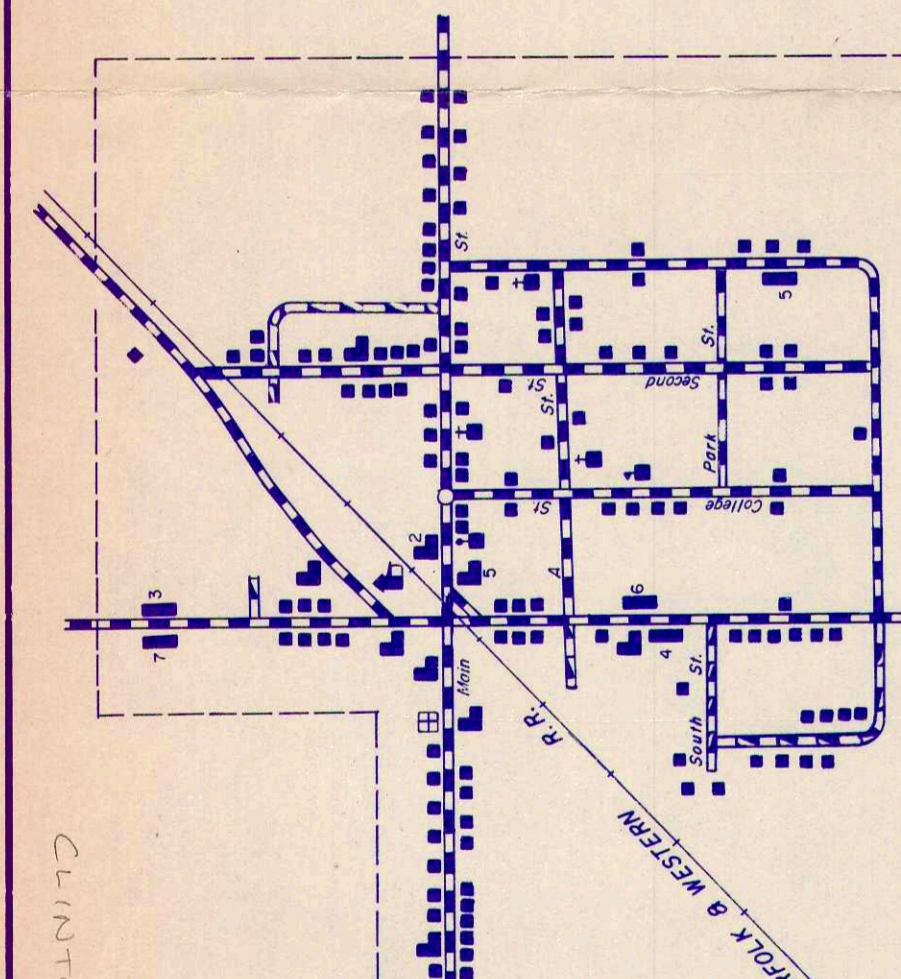

FOREST
INSET NO. 6
UNINCORPORATED TOWN
CLINTON COUNTY
INDIANA
LOCATED IN SECTIONS
1, 2, 3, 4, 5, 6, 7, 8, 9
T22S R2E

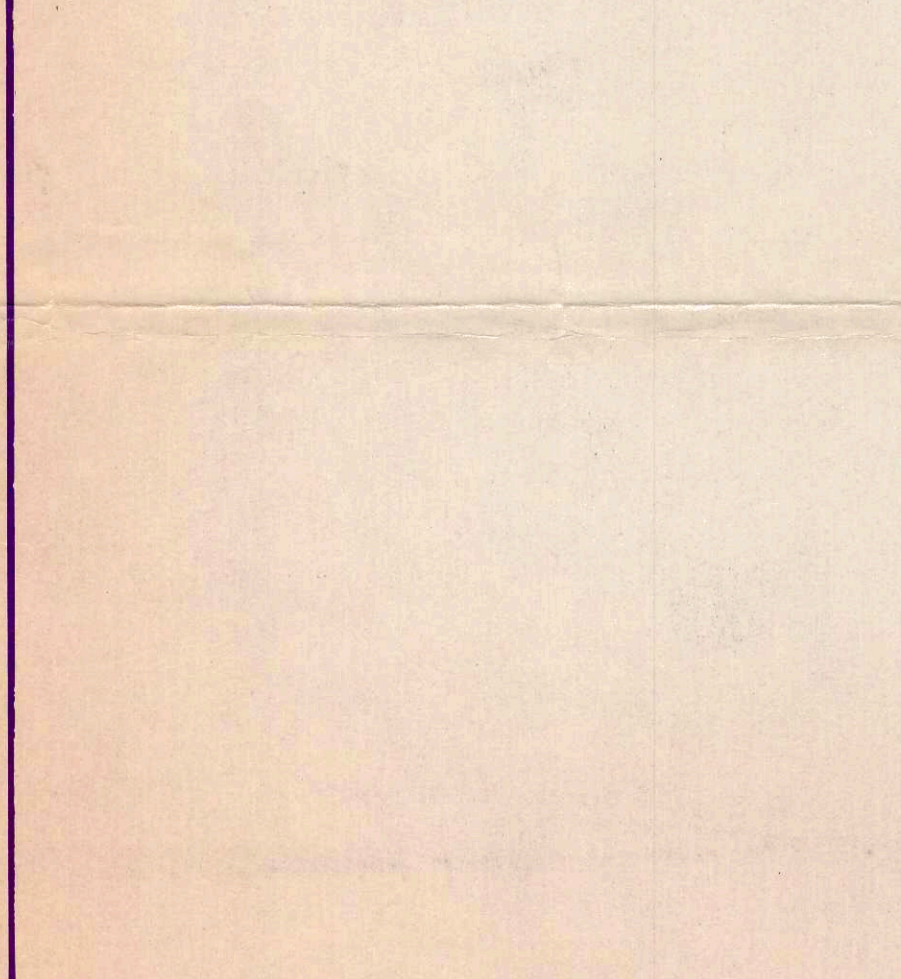

SEDALIA
INSET NO. 5
UNINCORPORATED TOWN
CLINTON COUNTY
INDIANA
LOCATED IN SECTIONS
1, 2, 3, 4, 5, 6, 7, 8, 9
T23N R1W

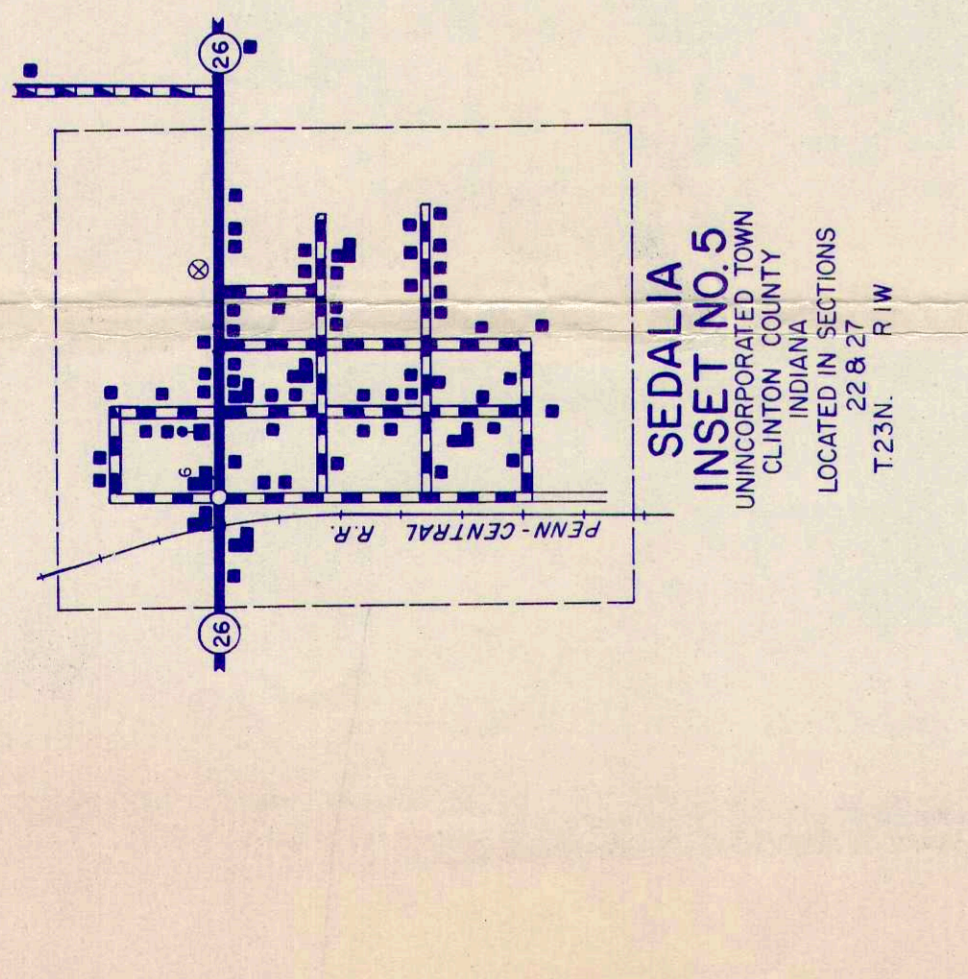

MORAN
INSET NO. 4
UNINCORPORATED TOWN
CLINTON COUNTY
INDIANA
LOCATED IN SECTIONS
1, 2, 3, 4, 5, 6, 7, 8, 9
T23N R1W

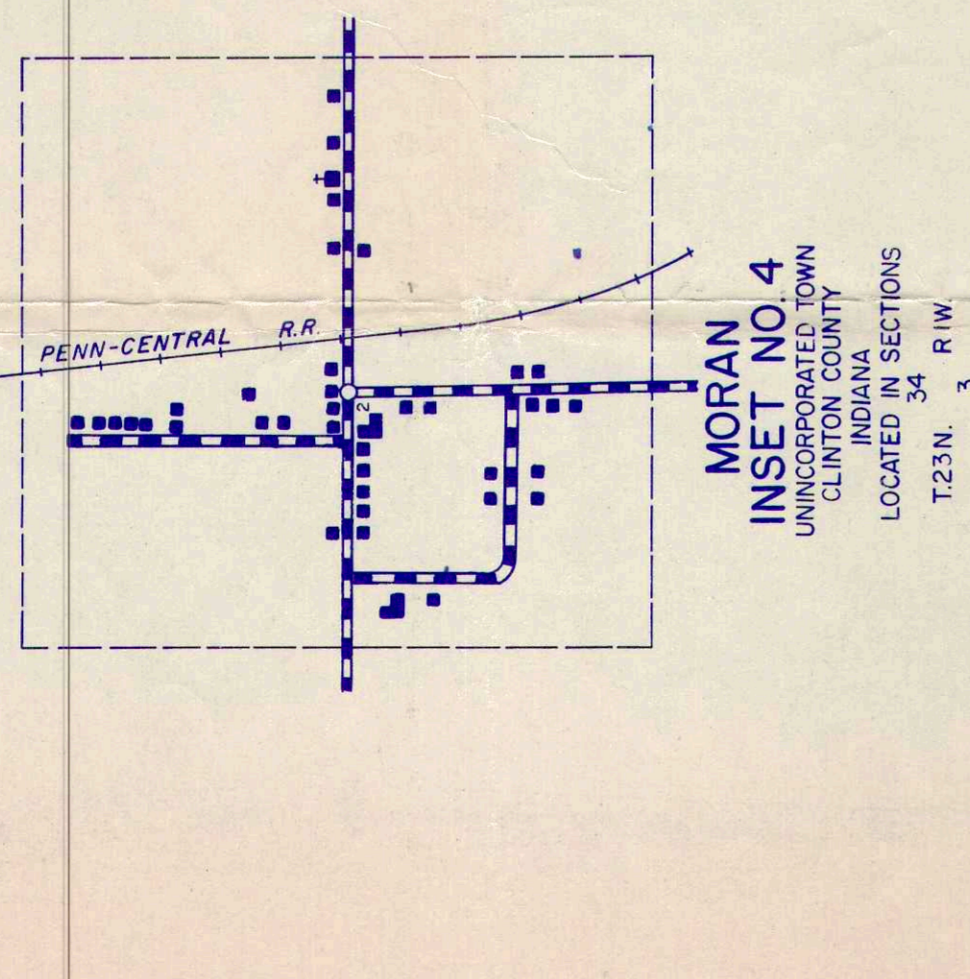

CAMBRIA
INSET NO. 3
UNINCORPORATED TOWN
CLINTON COUNTY
INDIANA
LOCATED IN SECTIONS
1, 2, 3, 4, 5, 6, 7, 8, 9
T22N R1W

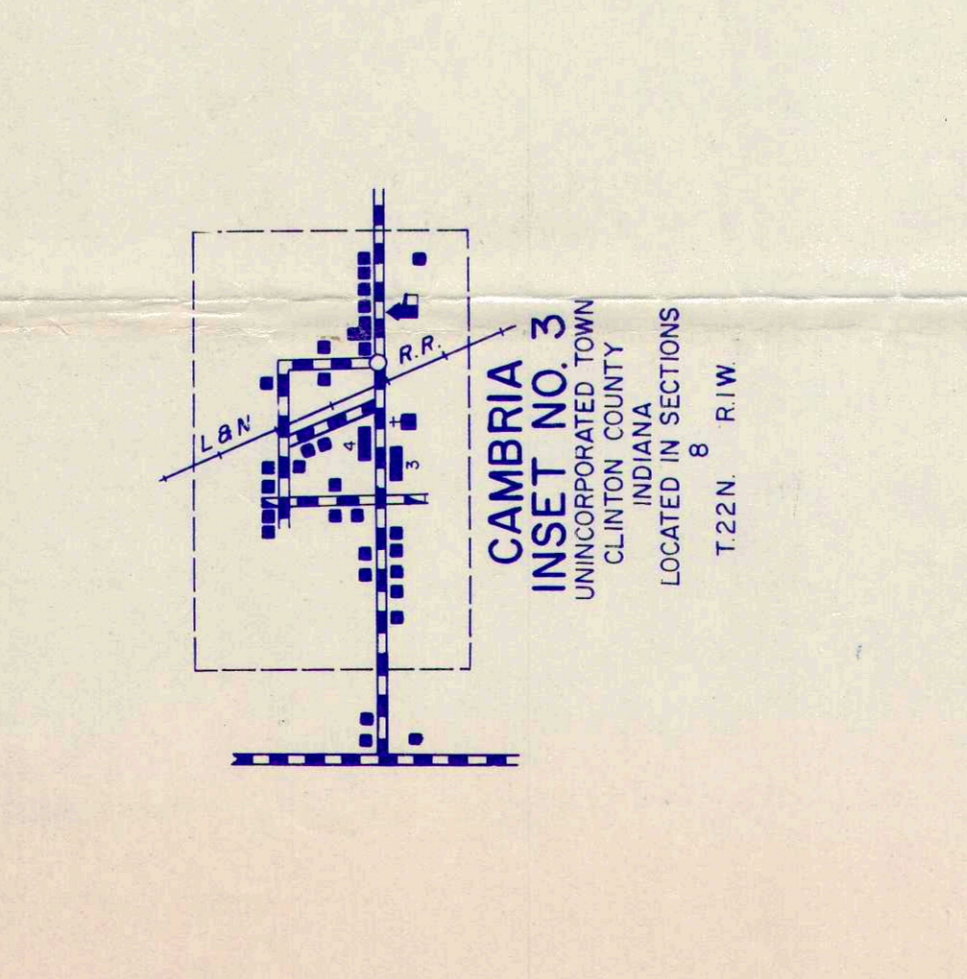

MANSON
INSET NO. 2
UNINCORPORATED TOWN
CLINTON COUNTY
INDIANA
LOCATED IN SECTIONS
1, 2, 3, 4, 5, 6, 7, 8, 9
T21N R2W

LEGEND

- INTERSTATE HIGHWAY SYSTEM
- UNITED STATES HIGHWAY
- STATE HIGHWAY SYSTEM
- DIVIDED HIGHWAY
- PAVED ROAD
- METAL SURFACED ROAD
- GRADED AND DRAINED EARTH ROAD
- UNIMPROVED EARTH ROAD
- PRIMITIVE ROAD
- INTERCHANGE
- HIGHWAY GRADE SEPARATION
- HIGHWAY BRIDGE OVER 20' SPAN
- CONCRETE ROAD OR DIP
- ROAD - PRIMITIVE ROAD
- ROAD - PRIVATE ROAD
- ROAD - SINGLE OPERATING COMPANY
- RAILROAD STATION
- RAILROAD ABOVE
- RAILROAD BELOW
- NARROW STREAM
- NAVIGABLE STREAM (DIRECTION OF FLOW)
- DAM WITH LOCK
- DAM WITHOUT ROAD
- DAM WITH ROAD
- POST OFFICE
- SCHOOLHOUSE
- CHURCH
- FRESH AIR FARM
- HOSPITAL
- POLICE STATION
- FIRE ENGINE HOUSE
- ARMY ORDNANCE DEPOT
- FACTORY OR INDUSTRIAL PLANT
- GAUGING OR PUMPING STATION
- HIGHWAY GARAGE
- POWER PLANT
- RADIO STATION
- RADIO STATION WITH CALL LETTERS
- AGRICULTURAL EXPERIMENT STATION
- STOCK FARM
- GRAIN ELEVATOR
- NURSERY
- FRUIT OR NUT ORCHARD
- GREENHOUSE
- CORRECTIONAL INSTITUTION
- CAMP OR LODGE
- LOCKOUT TOWER
- SMALL STATIONARY
- DRIVE-IN THEATRE
- GOLF COURSE OR COUNTRY CLUB
- SMALL PARK
- SWIMMING BEACH OR SWIMMING POOL
- PICNIC GROUND
- SCENIC SITE
- MINE, QUARRY OR OPEN CUT
- OIL OR GAS WELLS
- GRAVEL PIT
- GARBAGE OR RUBBISH DUMP
- STUDENT HOME
- MIGRANT HOME
- OTHER RELIGIOUS INSTITUTION
- CHURCH WITH CEMETERY ADJACENT
- FRESH AIR FARM OR REST HOME
- POLICE STATION
- FIRE ENGINE HOUSE
- ARMY ORDNANCE DEPOT
- FACTORY OR INDUSTRIAL PLANT
- GAUGING OR PUMPING STATION
- HIGHWAY GARAGE
- POWER PLANT
- RADIO STATION
- RADIO STATION WITH CALL LETTERS
- AGRICULTURAL EXPERIMENT STATION
- STOCK FARM
- GRAIN ELEVATOR
- NURSERY
- FRUIT OR NUT ORCHARD
- GREENHOUSE
- CORRECTIONAL INSTITUTION
- CAMP OR LODGE
- LOCKOUT TOWER
- SMALL STATIONARY

**GENERAL HIGHWAY AND TRANSPORTATION MAP
CLINTON COUNTY
INDIANA**

PREPARED BY THE
DIVISION OF PLANNING
INDIANA STATE HIGHWAY COMMISSION
IN COOPERATION WITH THE
U.S. DEPARTMENT OF TRANSPORTATION
FEDERAL HIGHWAY ADMINISTRATION
BUREAU OF PUBLIC ROADS

B.P.R. APPROVAL DATE _____

DATE	REVISIONS	BY

SCALE - FEET
0 100 200 300 400 500 600 700 800 900 1000

SCALE - MILES
0 10 20 30 40 50 60 70 80 90 100