

**INSET NO. 6**  
**PLEASANTVIEW VILLAGE**

UNINCORPORATED AREA  
BARTHOLOMEW COUNTY  
INDIANA  
LOCATED IN SECS. 9 & 4  
T9N, R4E

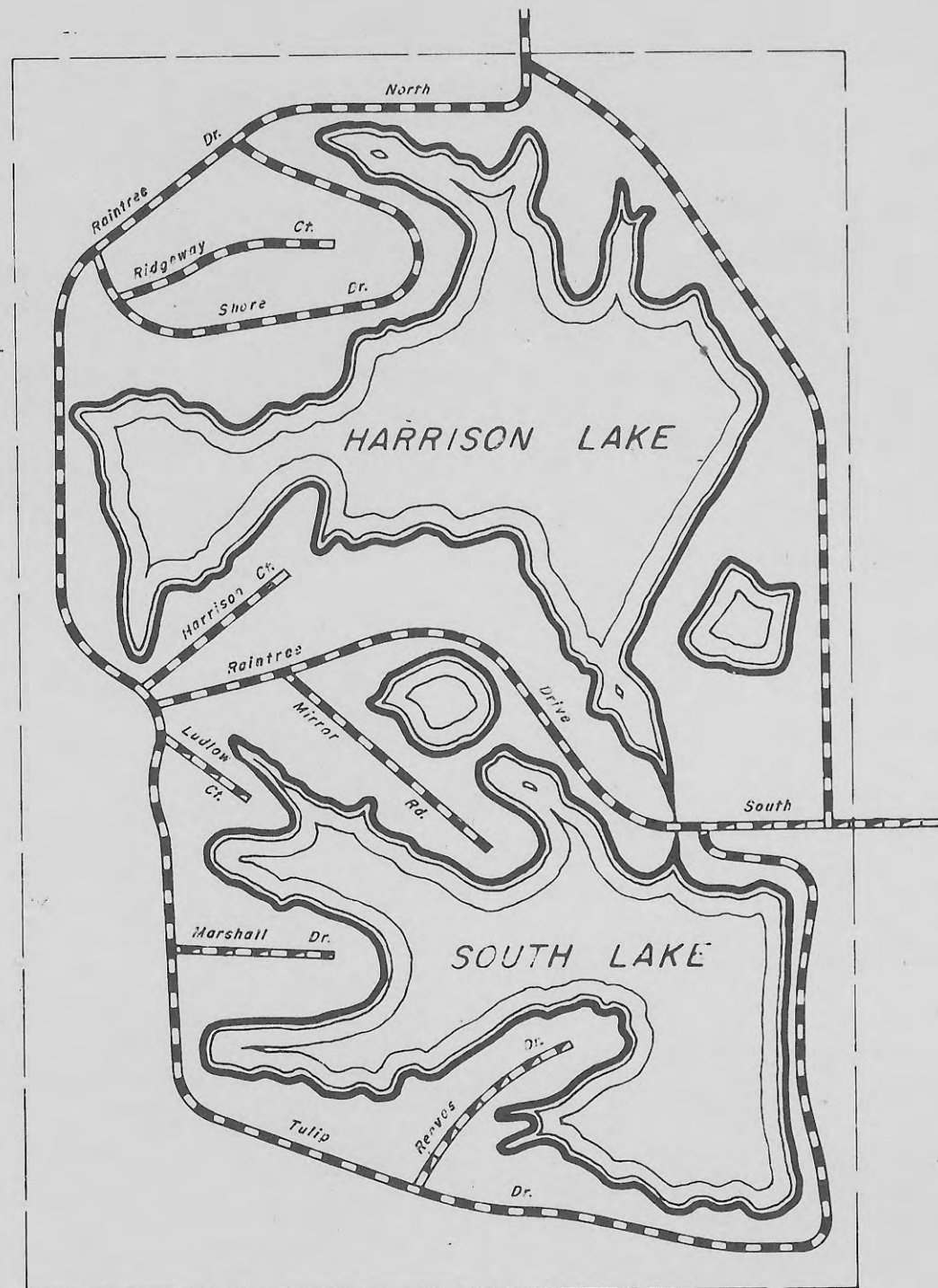

**INSET NO. 5**  
**HARRISON LAKES**

UNINCORPORATED AREA  
BARTHOLOMEW COUNTY  
INDIANA  
LOCATED IN SECS. 30 & 31  
T9N, R5E  
SECS. 25 & 36  
T9N, R4E

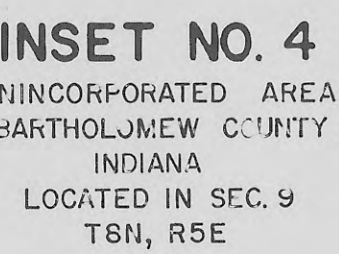

**INSET NO. 4**  
**HILLVIEW EST.**

UNINCORPORATED AREA  
BARTHOLOMEW COUNTY  
INDIANA  
LOCATED IN SEC. 9  
T8N, R5E

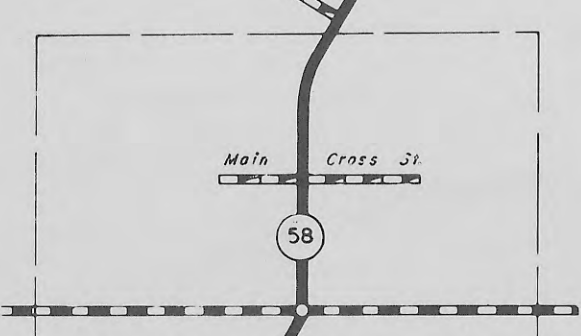

**INSET NO. 1**  
**WAYMANSVILLE**

UNINCORPORATED TOWN  
BARTHOLOMEW COUNTY  
INDIANA  
LOCATED IN SECS. 11 & 12  
T8N, R4E

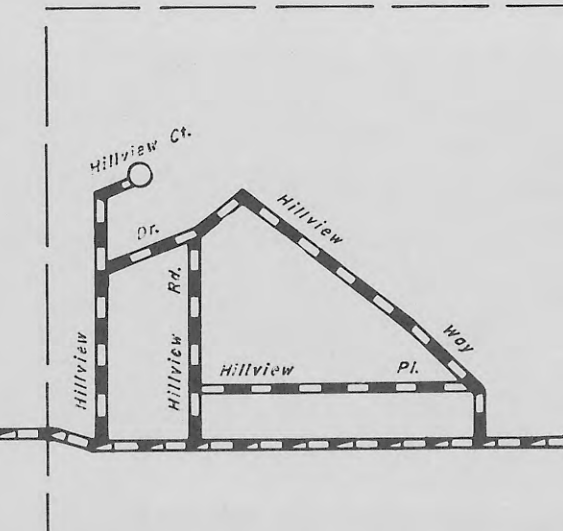

**INSET NO. 2**  
**HILLVIEW EST.**

UNINCORPORATED AREA  
BARTHOLOMEW COUNTY  
INDIANA  
LOCATED IN SEC. 36  
T8N, R4E

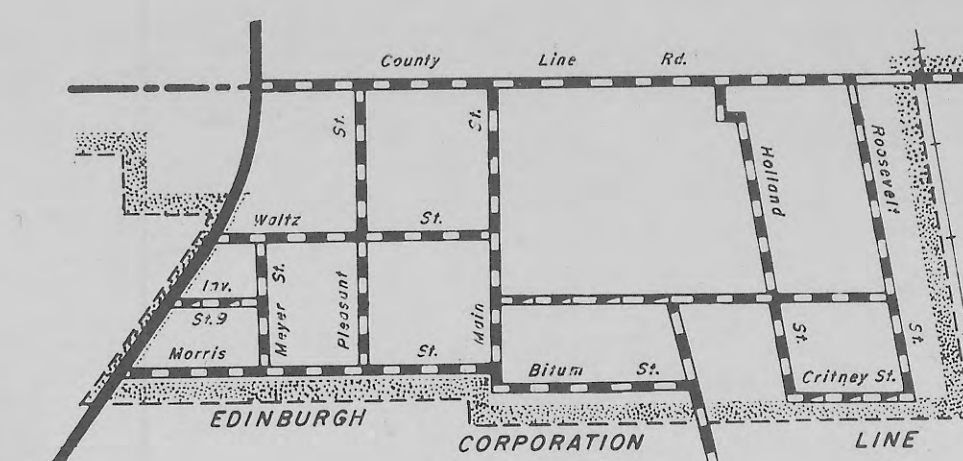

**INSET NO. 7**  
**EDINBURGH**

UNINCORPORATED TOWN  
BARTHOLOMEW COUNTY  
INDIANA  
LOCATED IN SEC. 3  
T10N, R5E

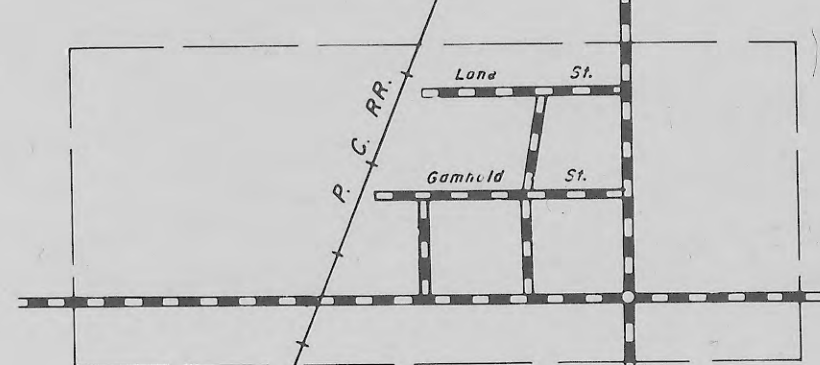

**INSET NO. 8**  
**ST. LOUIS CROSSING**

UNINCORPORATED TOWN  
BARTHOLOMEW COUNTY  
INDIANA  
LOCATED IN SEC. 10  
T10N, R5E

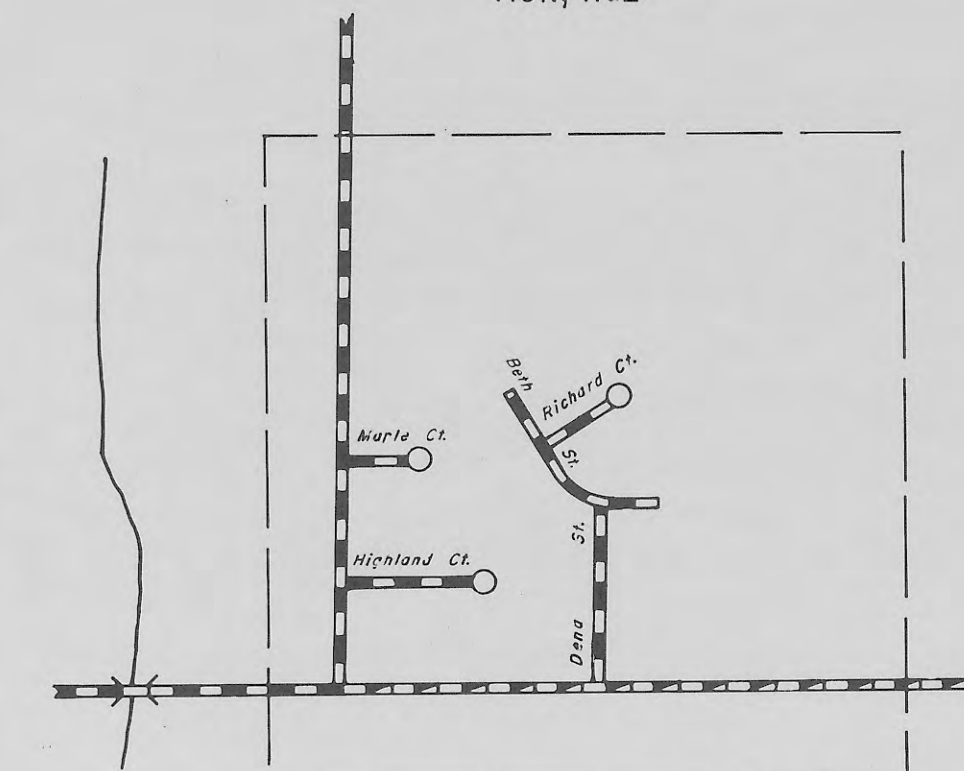

**INSET NO. 9**  
**EAST CLIFFORD**

UNINCORPORATED AREA  
BARTHOLOMEW COUNTY  
INDIANA  
LOCATED IN SEC. 27  
T10N, R5E

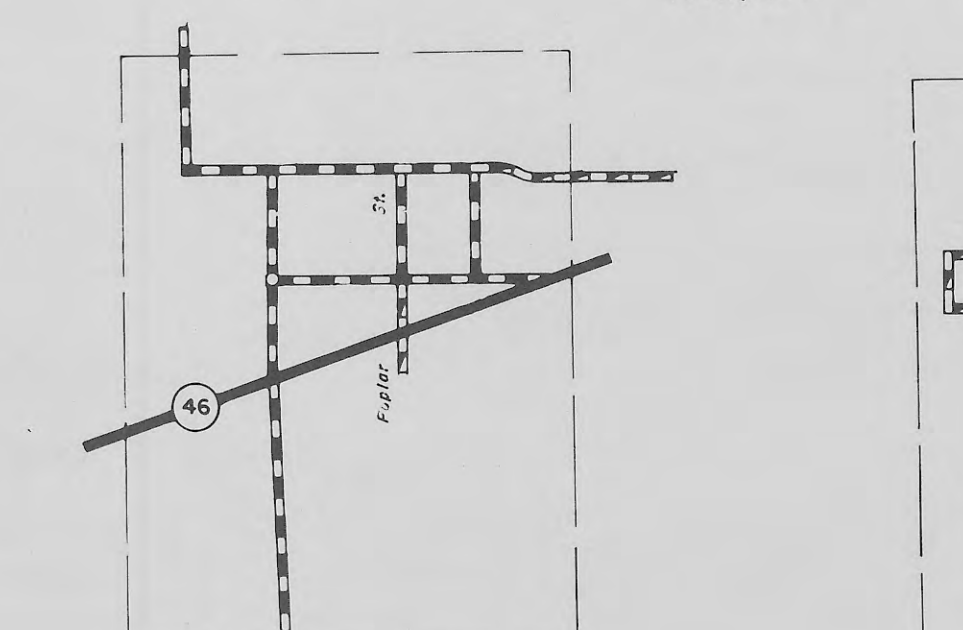

**INSET NO. 11**  
**NEWBERN**

UNINCORPORATED TOWN  
BARTHOLOMEW COUNTY  
INDIANA  
LOCATED IN SEC. 9  
T9N, R6E

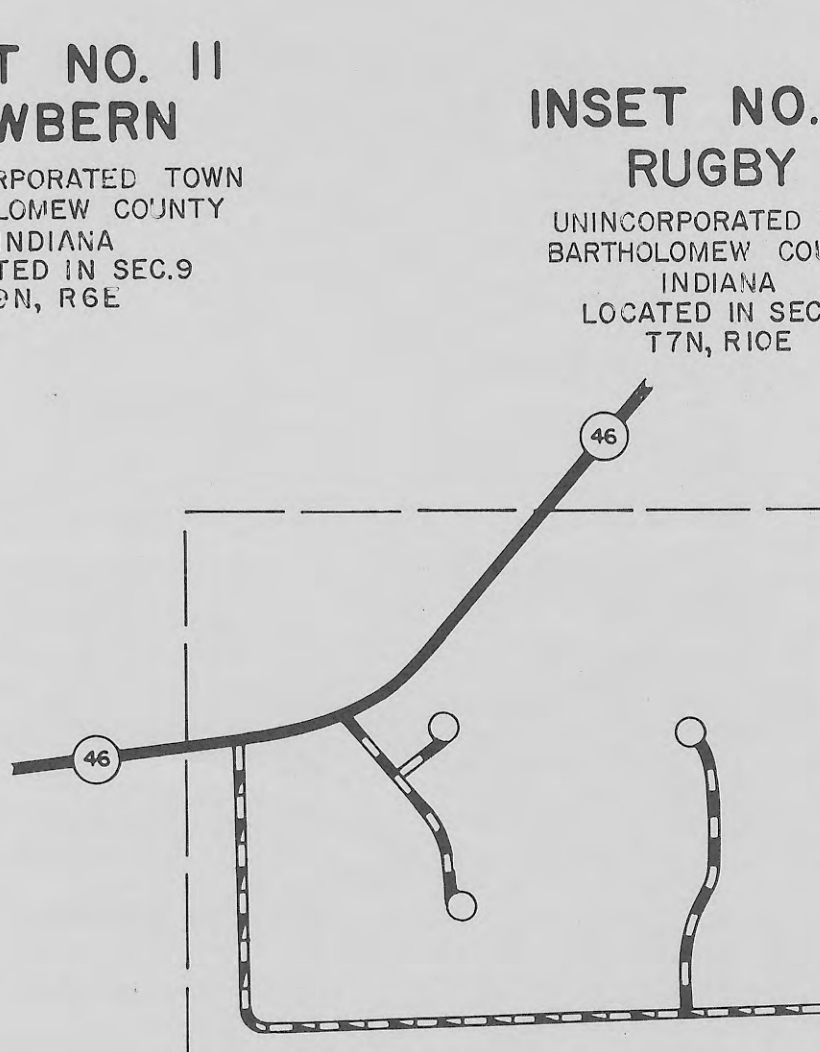

**INSET NO. 10**  
**RUGBY**

UNINCORPORATED TOWN  
BARTHOLOMEW COUNTY  
INDIANA  
LOCATED IN SEC. 14  
T7N, R1E

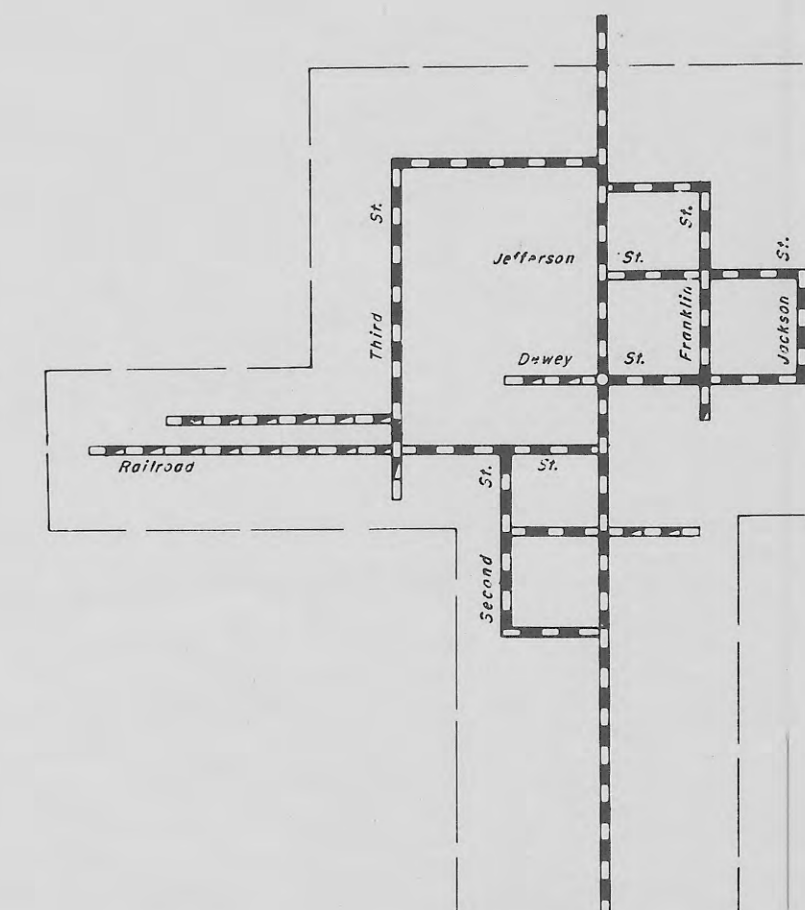

**INSET NO. 14**  
**GRAMMER**

UNINCORPORATED TOWN  
BARTHOLOMEW COUNTY  
INDIANA  
LOCATED IN SECS. 10 & 11  
T8N, R7E

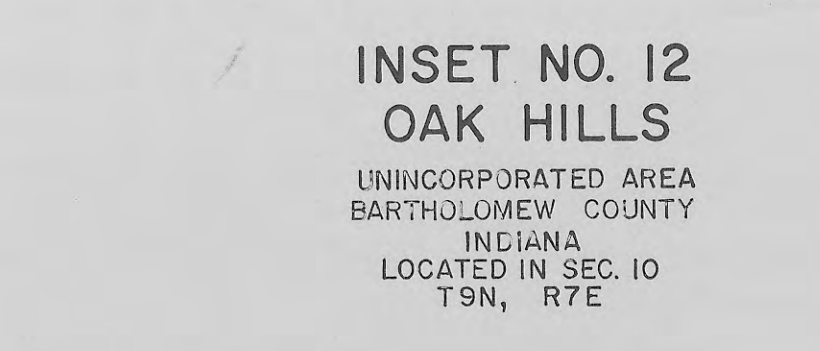

**INSET NO. 12**  
**OAK HILLS**

UNINCORPORATED AREA  
BARTHOLOMEW COUNTY  
INDIANA  
LOCATED IN SEC. 10  
T9N, R7E

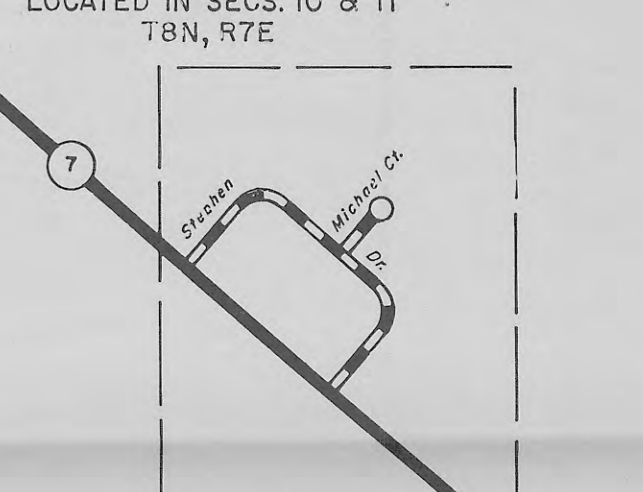

**INSET NO. 15**  
**GLANDON PARK**

UNINCORPORATED AREA  
BARTHOLOMEW COUNTY  
INDIANA  
LOCATED IN SEC. 17  
T8N, R7E

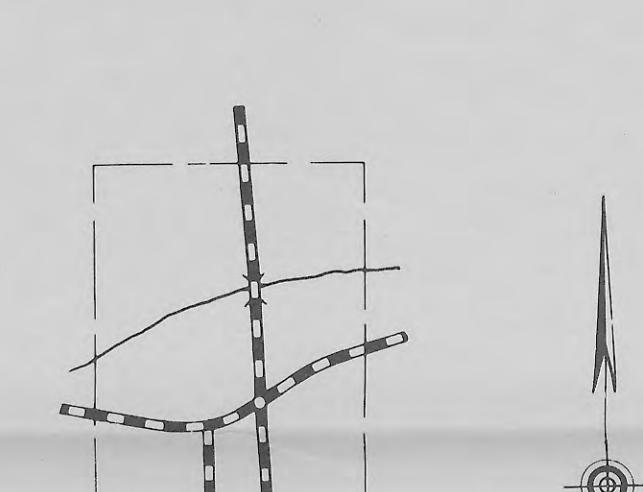

**INSET NO. 13**  
**BURNVILLE**

UNINCORPORATED TOWN  
BARTHOLOMEW COUNTY  
INDIANA  
LOCATED IN SECS. 3, 7B, R7E  
& SEC. 34, T9N, R7E

**LEGEND**

- INTERSTATE HIGHWAY SYSTEM
- UNITED STATES HIGHWAY
- STATE HIGHWAY SYSTEM
- DIVIDED HIGHWAY
- PAVED ROAD
- BITUMINOUS SURFACED ROAD
- METAL SURFACED ROAD
- GRADED AND DRAINED EARTH ROAD
- UNIMPROVED EARTH ROAD
- PRIMITIVE ROAD
- INTERCHANGE (LOCATED IN INCORPORATED CITY)
- INTERCHANGE
- HIGHWAY GRADE SEPARATION
- HIGHWAY BRIDGES (OVER 20' SPAN)
- CONCRETE FORD OR DIP
- FORD - ROAD ESTABLISHED
- FORD - PRIMITIVE ROAD
- FORD - PRIMITIVE ROAD
- RAILROAD (ANY NUMBER OF TRACKS) USED BY SINGLE OPERATING COMPANY
- RAILROAD STATION
- RAILROAD ABOVE
- RAILROAD BELOW
- NARROW STREAM
- WIDE STREAM
- ARROWS POINT IN DIRECTION OF FLOW
- NAVIGABLE STREAM
- ARROWS POINT IN DIRECTION OF FLOW
- DAM WITH ROAD
- DAM WITH LOCK
- DAM WITHOUT ROAD
- LEVEE
- LEVEE WITH ROAD
- TOLL FERRY
- STATE BOUNDARY
- COUNTY LINE
- CIVIL TOWNSHIP LINE
- CORPORATE LINE
- INSET LIMITS
- CONGRESSIONAL TOWNSHIP LINE
- SECTION LINE
- STATE PARK BOUNDARY (NAME SHOWN)
- STATE FOREST OR STATE GAME PRESERVE BOUNDARY
- NATIONAL PARK BOUNDARY (NAME SHOWN)
- NATIONAL PURCHASE UNIT BOUNDARY
- AIRPORT BOUNDARY
- C. COMMERCIAL, M. MUNICIPAL, OR P. PRIVATE AIRPORT
- LANDING FIELD
- COUNTY SEAT
- OTHER CITIES AND VILLAGES
- DWELLING OR FARM UNIT
- ROW OR GROUP OF DWELLINGS CLOSELY SPACED
- SEASONAL DWELLING
- ROW OR GROUP OF SEASONAL DWELLINGS
- APARTMENT
- HOTEL
- MOTEL OR TOURIST COURT
- TRAILER COURT
- STORE OR SMALL BUSINESS ESTABLISHMENT
- TOWN HALL, GRANGE OR COMMUNITY HALL
- COMBINED DWELLING AND STORE
- POST OFFICE
- BARRACKS OR DORMITORIES FOR STUDENTS, WORKERS, MIGRANTS, ETC.
- SCHOOLHOUSE, OTHER EDUCATIONAL INSTITUTION
- CHURCH, OTHER RELIGIOUS INSTITUTION
- CEMETERY
- CHURCH WITH CEMETERY ADJACENT
- FRESH AIR FARM OR REST HOME
- HOSPITAL
- POLICE STATION
- FIRE ENGINE HOUSE
- ARMORY
- FAIR GROUND, RACE COURSE OR SPOREWAY
- WAREHOUSE - GENERAL
- FACTORY OR INDUSTRIAL PLANT
- GAUGING OR PUMPING STATION (GENERAL)
- PUMPING STATION (GAS OR OIL)
- HIGHWAY GARAGE
- POWER PLANT
- BOOSTER STATION
- RADIO STATION (WITH CALL LETTERS)
- STATE CAPITOL
- DRIVE-IN THEATRE
- RIFLE CLUB
- GOLF COURSE OR COUNTRY CLUB
- SMALL PARK
- WAYSIDE PARK
- BATHING BEACH OR SWIMMING POOL
- PICNIC GROUND
- PLAYGROUND, BALL FIELD, ETC.
- SCENIC SITE
- MINE, QUARRY OR OPEN CUT
- OIL OR GAS WELLS
- GROUP OF STORAGE TANKS (OIL OR GAS)
- QUARRY
- GRAVEL PIT
- GARBAGE OR RUBBISH DUMP

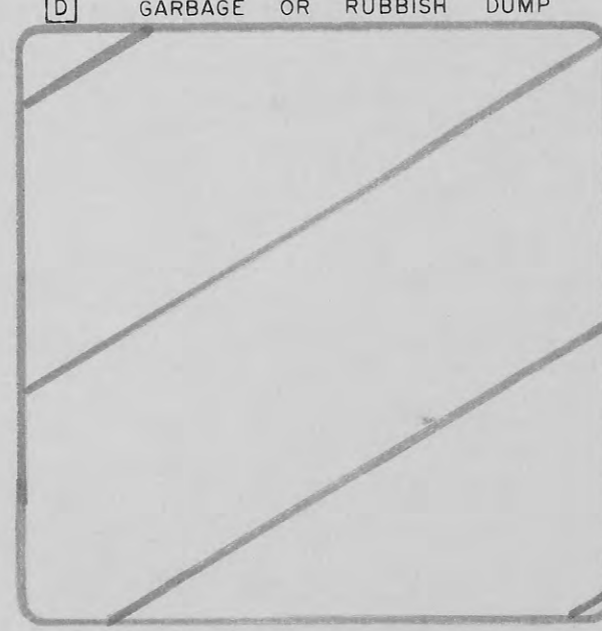

**GENERAL HIGHWAY AND TRANSPORTATION MAP**  
**BARTHOLOMEW COUNTY**  
**INDIANA**

COVERAGE OF  
**AERIAL SEARCH**

PREPARED BY THE  
**DIVISION OF PLANNING**  
IN COOPERATION WITH THE  
**U. S. DEPARTMENT OF TRANSPORTATION**  
**FEDERAL HIGHWAY ADMINISTRATION**  
**BUREAU OF PUBLIC ROADS**

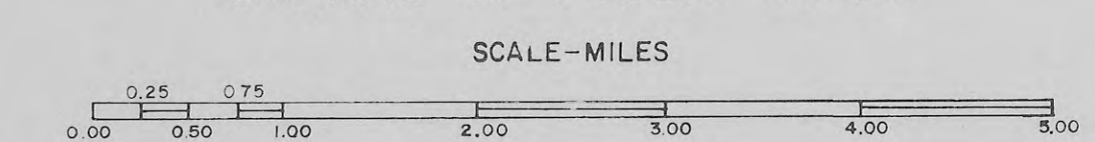

1976

POLYCONIC PROJECTION

**ENVIRONMENTAL SYSTEMS**  
**APPLICATION CENTER**

B.P.R. APPROVAL DATE \_\_\_\_\_

DATE	REVISIONS	BY

SHEET 1 OF 1 MAP SHEET AND  
1 SUPPLEMENTAL SHEET

