

# INDIANA GOVERNMENT CENTER SOUTH, FIRST FLOOR

**Legend**

- Elevator
- Freight Elevator
- Escalator
- Restroom
- Stairwell
- Telephone
- Door
- Snacks

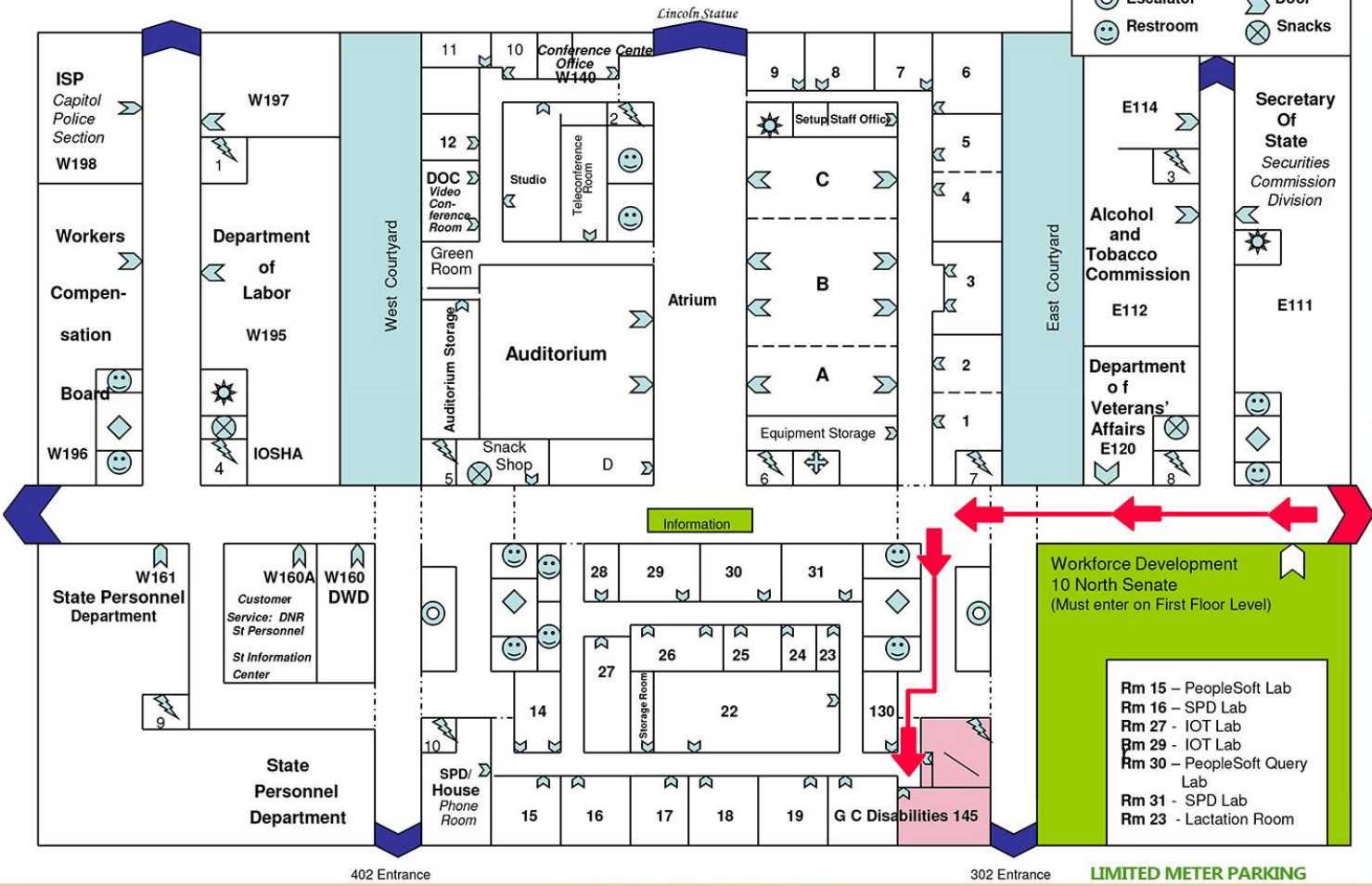

WEST ST.

SENATE AVE

**PUBLIC ENTRANCE**

LIMITED ACCESSIBLE PARKING

**WASHINGTON ST.**

**STATE PARKING GARAGE**

BAY #1

ACCESSIBLE PARKING AVAILABLE

MISSOURI ST.

- GCPD COUNCIL VISITORS:**
- USE PARKING BAY #1
  - TAKE TICKET & BRING WITH YOU
  - COUNCIL STAFF WILL VALIDATE YOUR PARKING

LIMITED METER PARKING

- Workforce Development**  
10 North Senate  
(Must enter on First Floor Level)
- Rm 15 - PeopleSoft Lab
  - Rm 16 - SPD Lab
  - Rm 27 - IOT Lab
  - Rm 29 - IOT Lab
  - Rm 30 - PeopleSoft Query Lab
  - Rm 31 - SPD Lab
  - Rm 23 - Lactation Room