

E 503-R-516d

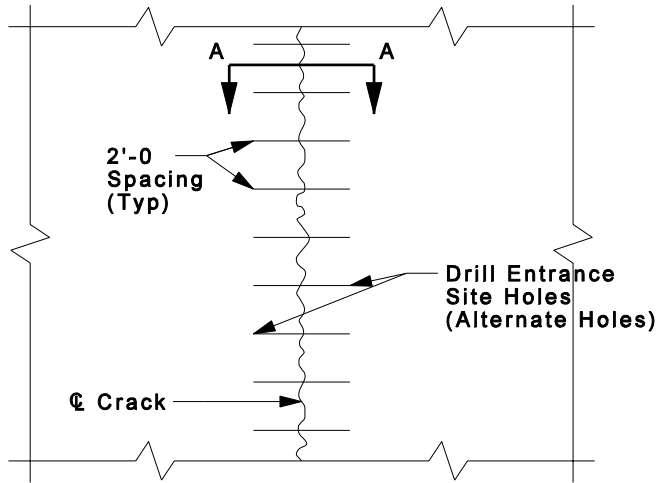

Longitudinal or Transverse Crack

Epoxy Coated Reinforcing Steel				
D	X	Bar Length	Bar Size	
			Transverse	Longitudinal
9"	6 1/2"	9"	#8	#6
9 1/2"	6 3/4"	9"	#8	#6
10"	7"	10"	#10	#6
10 1/2"	7 1/2"	11"	#10	#6
11"	7 3/4"	12"	#10	#6
11 1/2"	8 1/4"	13"	#10	#6
12"	8 1/2"	13"	#10	#6
12 1/2"	9"	14"	#11	#6
13"	9 1/4"	15"	#11	#6
13 1/2"	9 1/2"	16"	#11	#6
14"	10"	17"	#11	#6
14 1/2"	10 1/4"	18"	#11	#6
15"	10 3/4"	19"	#11	#6
15 1/2"	11"	20"	#11	#6
16"	11 1/2"	20"	#11	#6

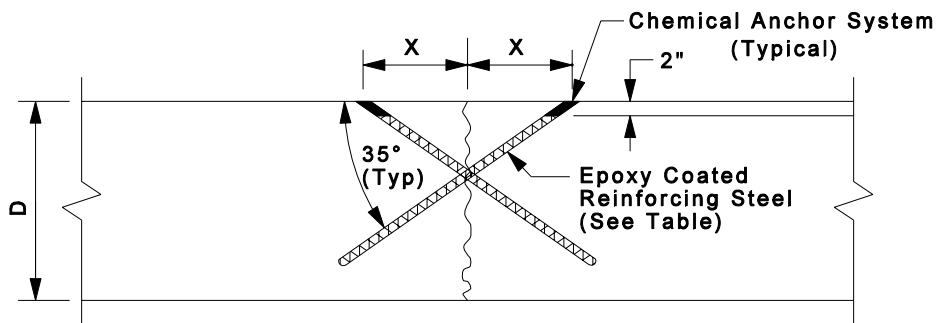

Section A-A

INDIANA DEPARTMENT OF TRANSPORTATION
PCCP STITCHING

3-24-06