

404-2.02(02) Fillet Dimensions for Steel Beams or Girders [Rev. Aug. 2017]

Figure [404-2B](#) illustrates fillet dimensions for steel beams or girders. The following will apply to the use of this Figure. Let dimension Y equal the total depth of the deck and fillet measured to the top of the web.

404-2.02(03) Fillet Dimensions for Concrete Beams [Rev. Aug. 2017]

Figure [404-2C](#) illustrates fillet dimensions for concrete beams.

404-2.03(02) Permanent Metal Forms [Rev. May 2013, Rev. Aug. 2017]

Metal stay-in-place forms may be used to support the deck between beams. Designers should assume the use of metal forms and account for dead load as described in Section 403-2.03.

Plan details should include only the minimum fillet dimensions. The design of permanent metal forms is the responsibility of the contractor. Recurring Special Provision (RSP) 702-B-304, Permanent Deck Form Angles, should be included in contracts with applicable bridge work until such time as the RSP is incorporated into the *Standard Specifications*.

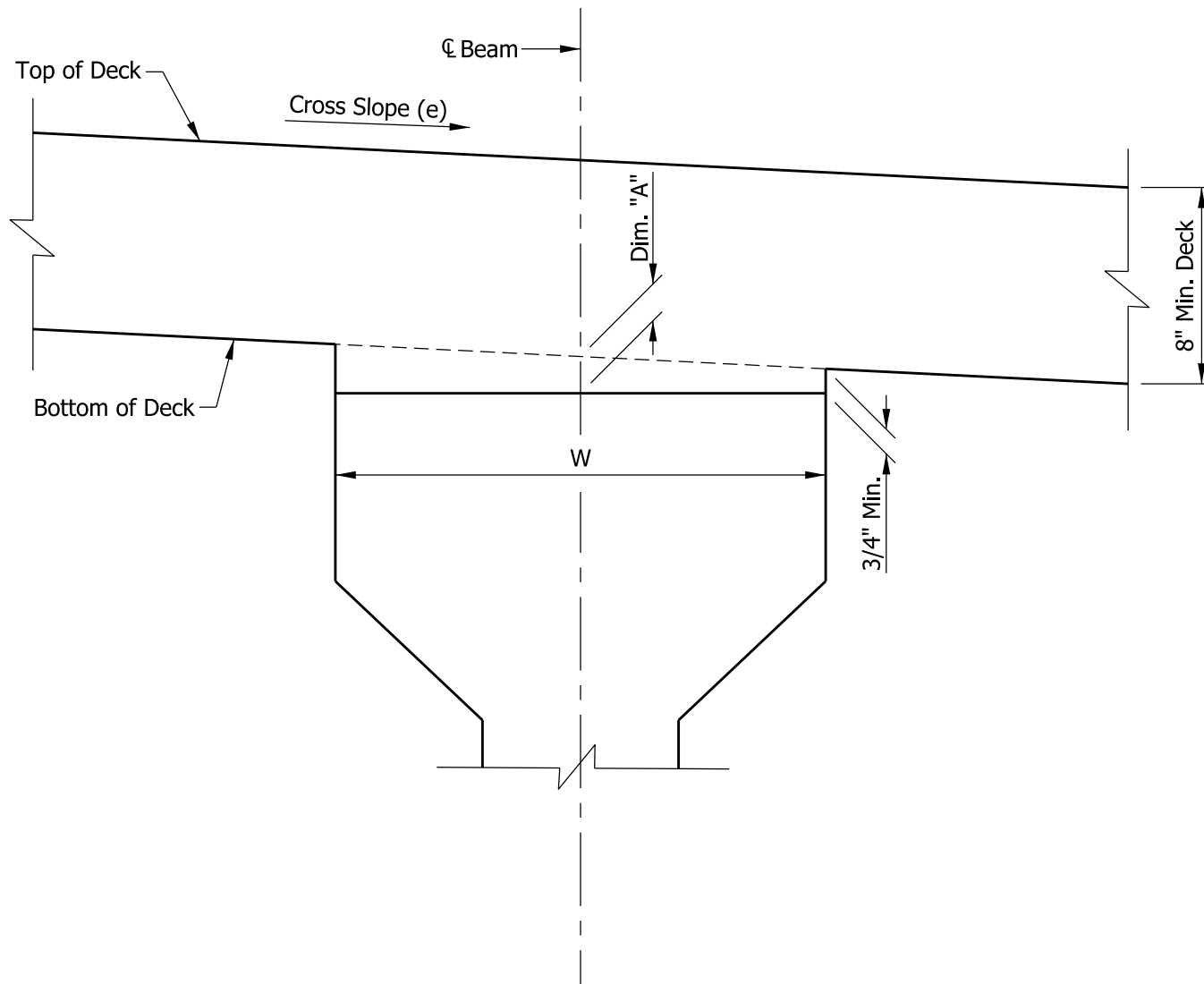

FILLET DIMENSION FOR PRE-STRESSED BEAMS

Figure 404-2C

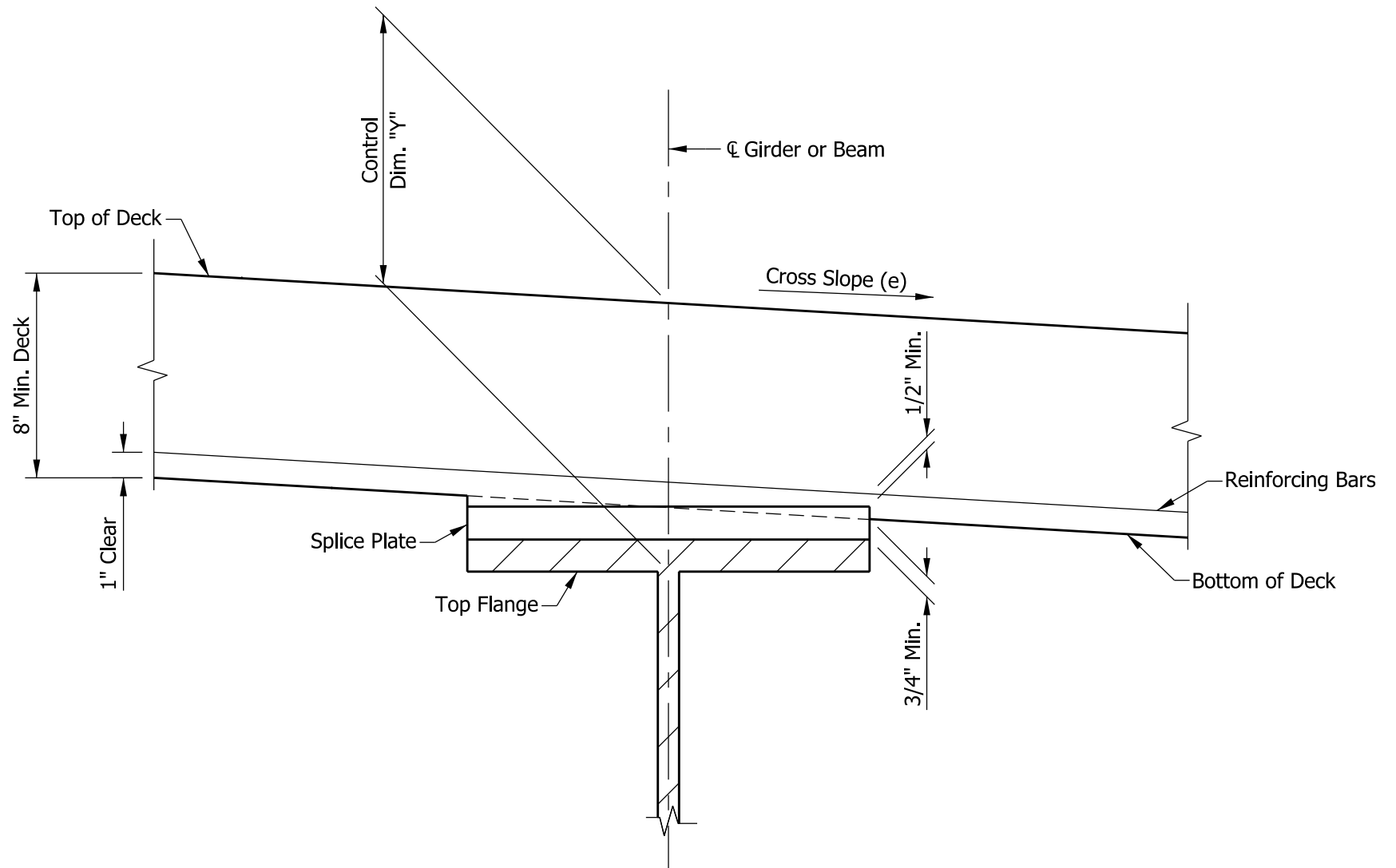

FILLET DIMENSIONS FOR STEEL BEAM

Figure 404-2B