

NOTES:

1. See Standard Drawing 616-SWRR-01 for Section F-F.
2. If riprap is specified, 300 hand-laid riprap or precast concrete riprap type A may be used.
- ③ Precast concrete riprap:
Type A: H = 195 (200 nom.)
Type B: H = 95 (100 nom.)

SECTION THROUGH PRECAST RIPRAP

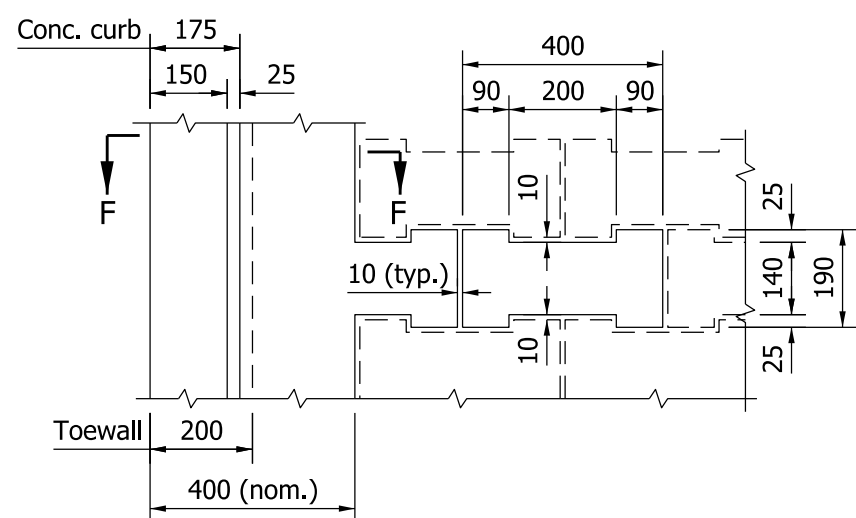

PLAN - PRECAST CONCRETE RIPRAP
(Type A shown)

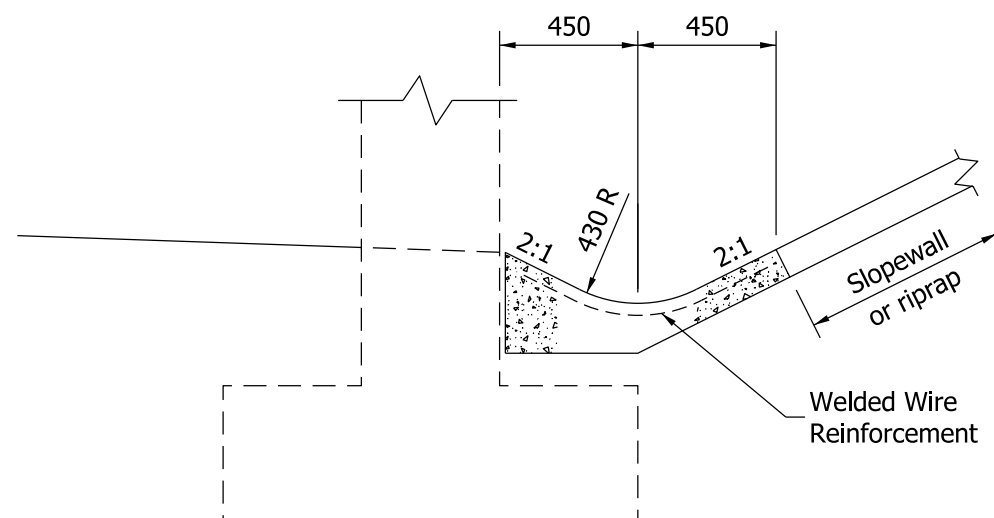

SECTION THROUGH PAVED DITCH AT TOE OF SLOPE
(See layout on plans for location of paved ditch)

All Dimensions are in mm unless otherwise specified.

INDIANA DEPARTMENT OF TRANSPORTATION	
RIPRAP SLOPEWALL DETAILS	
SEPTEMBER 2011	
STANDARD DRAWING NO.	616-SWRR-02
	<i>/s/ Richard L. VanCleave</i> 09/01/11
	DESIGN STANDARDS ENGINEER DATE
	<i>/s/ Mark A. Miller</i> 09/01/11
	CHIEF HIGHWAY ENGINEER DATE
DESIGN STANDARDS ENGINEER	