

ELEVATION
Scale: None

4 - 19 ϕ x 320 long round head bolts in 22 ϕ holes. (top rail)
Holes are to be slotted as required for expansion.

4 - 4.8 ϕ x 300 long round head bolts in 6 ϕ holes (bottom rail).
Holes are to be slotted as required for expansion.

* Field measure distance to holes on concrete transition.

NOTES :

1. All chamfered edges shall be 25.
2. Intermediate railing splices shall be placed every 6 m with center of connection at span quarter points.
3. See Standard Drawing 706-BRPP-05 for railing tube details and inner sleeve details.
4. See Standard Drawing 706-BRPP-06 for base plate detail and reinforcing steel bar bends.
5. See Standard Drawing 706-TTBP-05 and -06 for concrete bridge railing transition, TPS-1.
6. See Standard Drawing 703-BRST-01 for standard 180° bar bending details.
7. All reinforcing bars designated "E" shall be epoxy coated.
8. Reinforcing steel in sidewalk match that shown on the bridge plans.

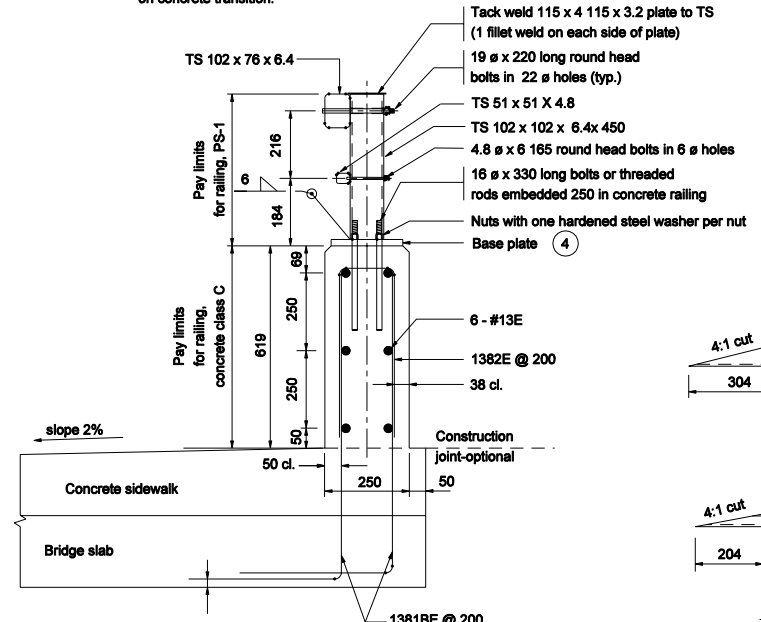

TYPICAL SECTION
Scale: None

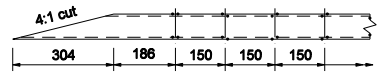

DETAIL A
(Plan view of top rail)
Scale: None

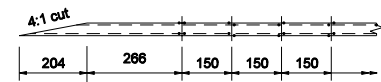

DETAIL A
(Plan view of bottom rail)
Scale: None

All Dimension are in mm unless otherwise specified

INDIANA DEPARTMENT OF TRANSPORTATION	
RAILING, PS-1	
SEPTEMBER 2005	
STANDARD DRAWING NO. 706-BRPP-03	
	<i>/s/ Richard L. VanCleave</i> 9-01-05 DESIGN STANDARDS ENGINEER DATE
	<i>/s/ Richard K. Smutzer</i> 9-01-05 CHIEF HIGHWAY ENGINEER DATE
DESIGN STANDARDS ENGINEER	