

Reduced Speed Advance
Warning Sign Assembly

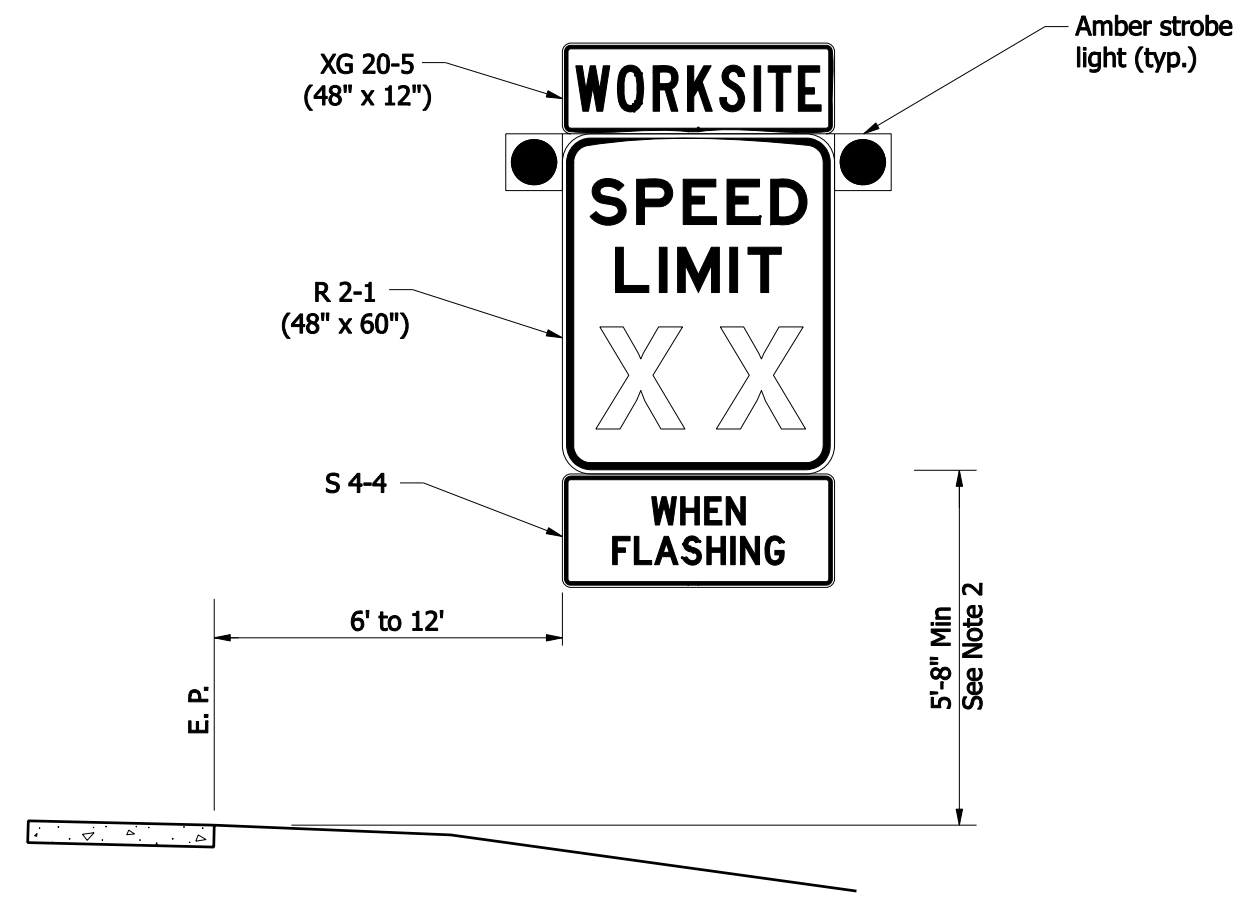

Worksite Speed Limit
Sign Assembly

General Notes:

1. If not trailer mounted, signs and supports shall meet NCHRP 350 crash evaluation criteria.
2. Mounting height shall be 7' for interstate applications.
3. Advance Warning Sign speed shall match Worksite Sign.
4. The Work Site Speed Limit shall be 45 MPH, or 10 MPH below the posted speed limit for the roadway under construction, whichever is less.

INDIANA DEPARTMENT OF TRANSPORTATION											
WORKSITE SPEED LIMIT SIGN ASSEMBLY											
SEPTEMBER 2007											
STANDARD DRAWING NO. E 801-TCDV-10											
	<table style="width: 100%; border: none;"> <tr> <td style="border: none;">/s/ <i>Richard L. VanCleave</i></td> <td style="border: none; text-align: right;">09/04/07</td> </tr> <tr> <td style="border: none;">DESIGN STANDARDS ENGINEER</td> <td style="border: none; text-align: right;">DATE</td> </tr> <tr> <td colspan="2" style="border: none;"> </td> </tr> <tr> <td style="border: none;">/s/ <i>Mark A. Miller</i></td> <td style="border: none; text-align: right;">09/04/07</td> </tr> <tr> <td style="border: none;">CHIEF HIGHWAY ENGINEER</td> <td style="border: none; text-align: right;">DATE</td> </tr> </table>	/s/ <i>Richard L. VanCleave</i>	09/04/07	DESIGN STANDARDS ENGINEER	DATE			/s/ <i>Mark A. Miller</i>	09/04/07	CHIEF HIGHWAY ENGINEER	DATE
/s/ <i>Richard L. VanCleave</i>	09/04/07										
DESIGN STANDARDS ENGINEER	DATE										
/s/ <i>Mark A. Miller</i>	09/04/07										
CHIEF HIGHWAY ENGINEER	DATE										
DESIGN STANDARDS ENGINEER											