

**NOTES:**

1. Where used with HMA mainline pavement, concrete railing and moment slab lengths shall coincide and be spaced at 18 ft.

**PLAN - REINFORCED CONCRETE MOMENT SLAB JOINTS**

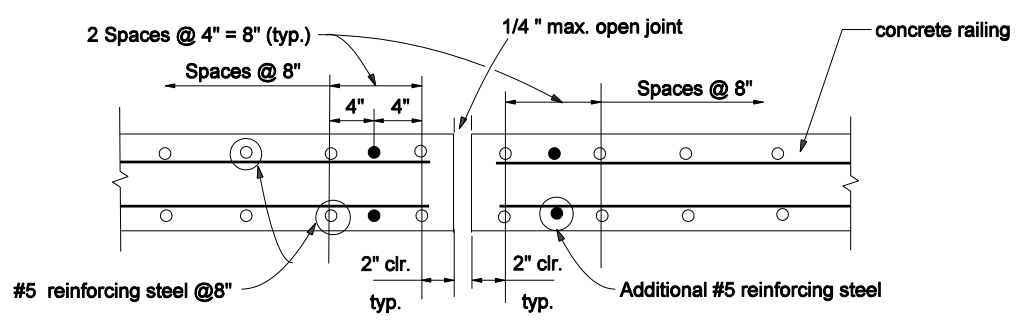

**PLAN - CONCRETE RAILING  
ADDITIONAL VERTICAL STEEL**

INDIANA DEPARTMENT OF TRANSPORTATION	
<b>MOMENT SLAB JOINTS</b>	
SEPTEMBER 2006	
STANDARD DRAWING NO. E 706-BRRW-05	
	/s/ Richard L. VanCleave 9-01-06 DESIGN STANDARDS ENGINEER DATE
	/s/ Richard Smutzer 9-01-06 CHIEF HIGHWAY ENGINEER DATE
DESIGN STANDARDS ENGINEER	