

GENERAL NOTES

1. For detour route marker assemblies (A), (B), (C) and (D) see Standard Drawing E 801-TCDT-03.
2. See Standard Drawing E 801-TCLG-01 for standard notes and legend.

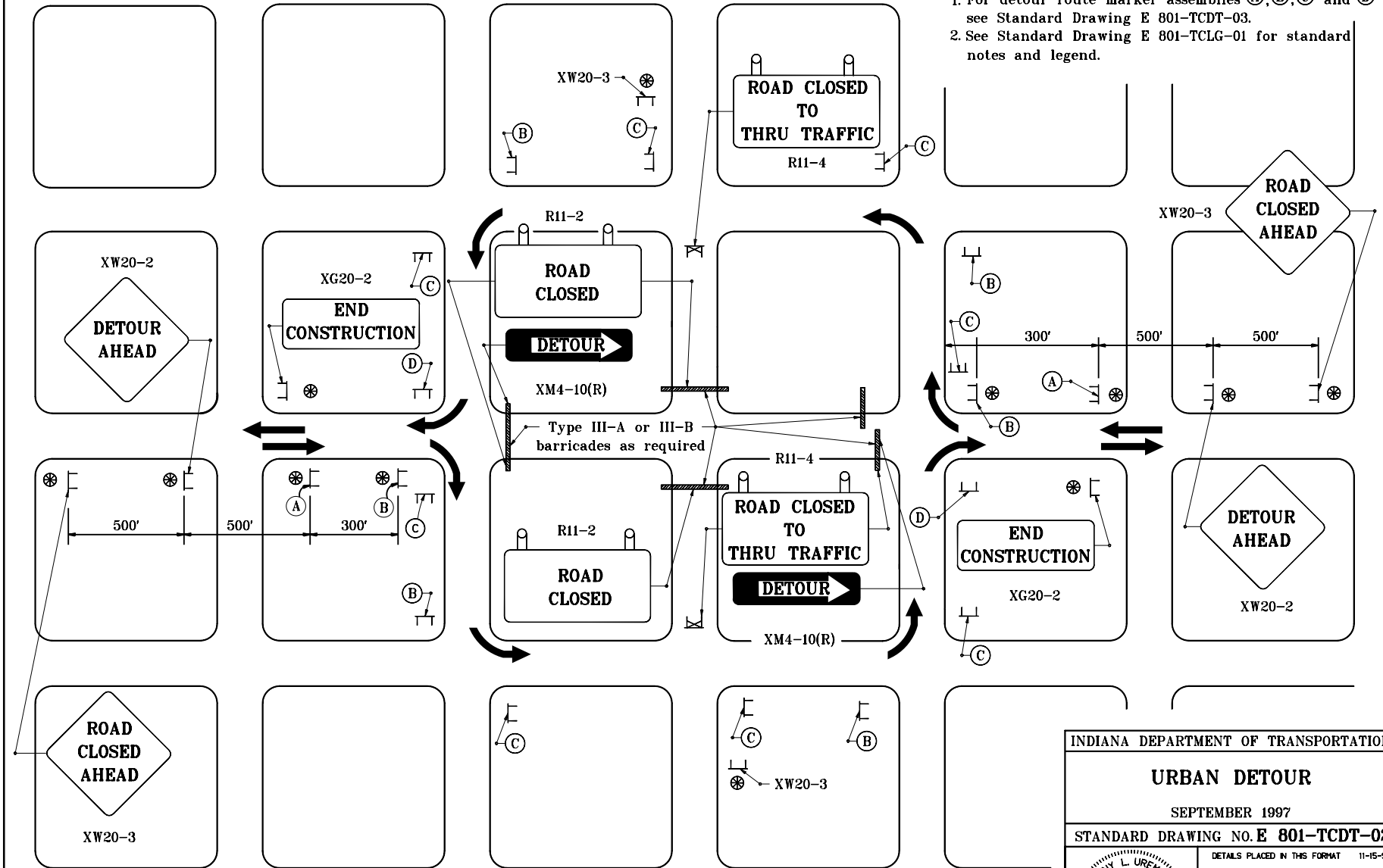

TYPICAL APPLICATIONS OF TRAFFIC DEVICES FOR AN URBAN DETOUR

INDIANA DEPARTMENT OF TRANSPORTATION	
URBAN DETOUR	
SEPTEMBER 1997	
STANDARD DRAWING NO. E 801-TCDT-02	
DETAILS PLACED IN THIS FORMAT 11-15-99	
	/s/ Anthony L. Uremovich 11-15-99 DESIGN STANDARDS ENGINEER DATE
	/s/ Firooz Zandi 11-15-99 CHIEF HIGHWAY ENGINEER DATE
DESIGN STANDARDS ENGINEER	ORIGINALLY APPROVED 9-02-97