

**GENERAL NOTES**

- ① S = Normal width of paved shoulder as shown on plans.
- ② See plans for W
- 3. Mailbox approach pavement section shall be the same as the shoulder material.
- 4. High speed is defined as 50 MPH or greater.

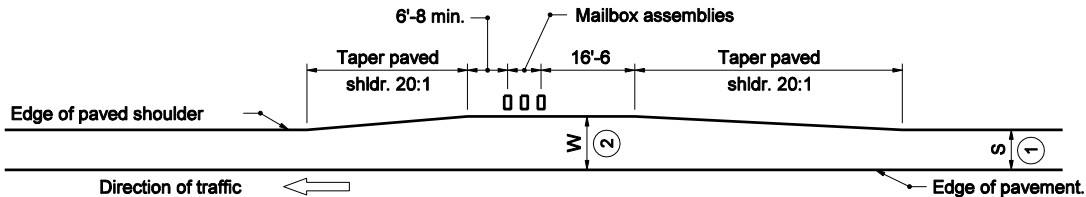

**TYPICAL MAILBOX APPROACH**

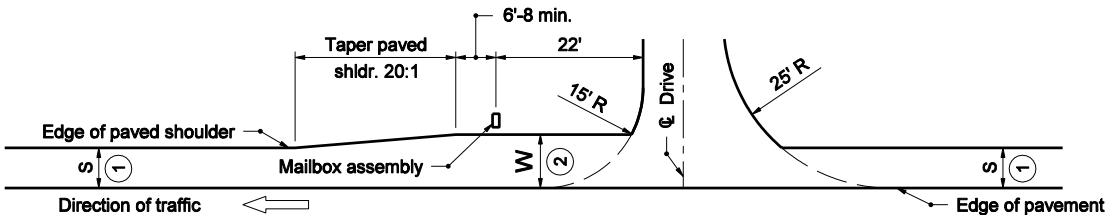

**COMBINATION MAILBOX APPROACH & DRIVE  
(Mailbox located beyond drive)**

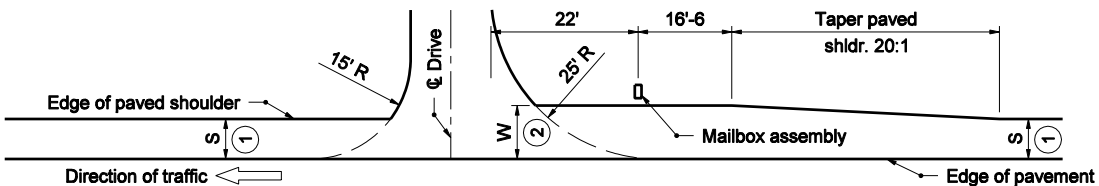

**COMBINATION MAILBOX APPROACH & DRIVE  
(Mailbox located beyond drive)**

INDIANA DEPARTMENT OF TRANSPORTATION

**MAILBOX APPROACHES  
HIGH SPEED TRAFFIC**

MARCH 2005

STANDARD DRAWING NO. E 610-MBAP-01

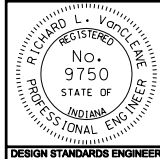

*/s/ Richard L. VanCleave* 3-01-05  
DESIGN STANDARDS ENGINEER DATE

*/s/ Richard K. Smutzer* 3-01-05  
CHIEF HIGHWAY ENGINEER DATE

DESIGN STANDARDS ENGINEER