

* Field measure distance to holes on concrete transition.

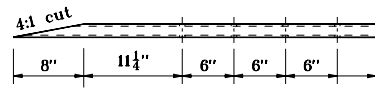
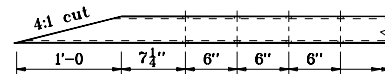
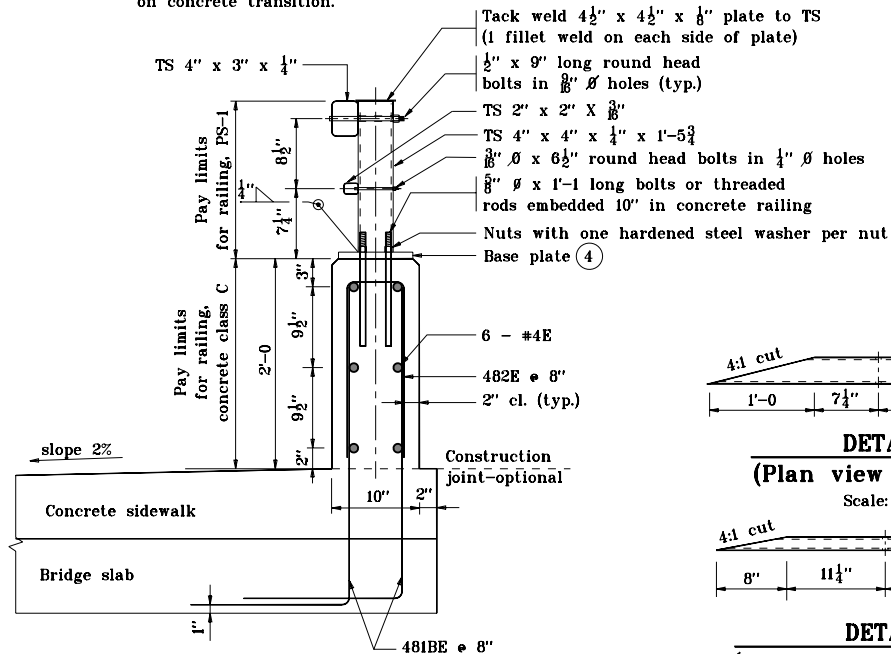

NOTES :

1. All chamfered edges shall be 1".
2. Intermediate railing splices shall be placed every 20' with center of connection at span quarter points.
3. See Standard Drawing E 706-BRPP-05 for railing tube details and inner sleeve details.
- ④ See Standard Drawing E 706-BRPP-06 for base plate detail and reinforcing steel bar bends.
5. See Standard Drawing E 706-TTBP-05 and -06 for concrete bridge railing transition, TPS-1.
6. See Standard Drawing E 703-BRST-01 for standard 180° bar bending details.
7. All reinforcing bars designated "E" shall be epoxy coated.
8. Reinforcing steel in sidewalk match that shown on the bridge plans.

INDIANA DEPARTMENT OF TRANSPORTATION	
RAILING, PS-1	
SEPTEMBER 2001	
STANDARD DRAWING NO. E 706-BRPP-03	
	/s/ Anthony L. Uremovich 9-04-01 DESIGN STANDARDS ENGINEER DATE
	/s/ Firooz Zandi 9-04-01 CHIEF HIGHWAY ENGINEER DATE
DESIGN STANDARDS ENGINEER	