

# **GENERAL NOTES**

1. For notes that apply to this sheet, see Standard Drawing 801-TCLG-01 for general notes and legend.
2. See Standard Drawing 801-TCCO-02 for Entrance Detail.
3. See Standard Drawing 801-TCCO-03 for Exit Detail.
4. See Standard Drawing 801-TCDV-03 for the required length of taper section for channelizing devices for construction zone speed limits less than 55 MPH.
5. Appropriate channelizing devices:
  - a. For freeways - temporary concrete barrier- (see Standard Drawings 602-TCCB-01 thru-04)
  - b. For non-freeways - cones or tubular markers (see Standard Drawing 801-TCDV-01)
6. Area of Type A crossovers are shown on Standard Drawing 801-TCLG-01 and area of Type B crossover is shown on Standard Drawing 801-TCCO-05.

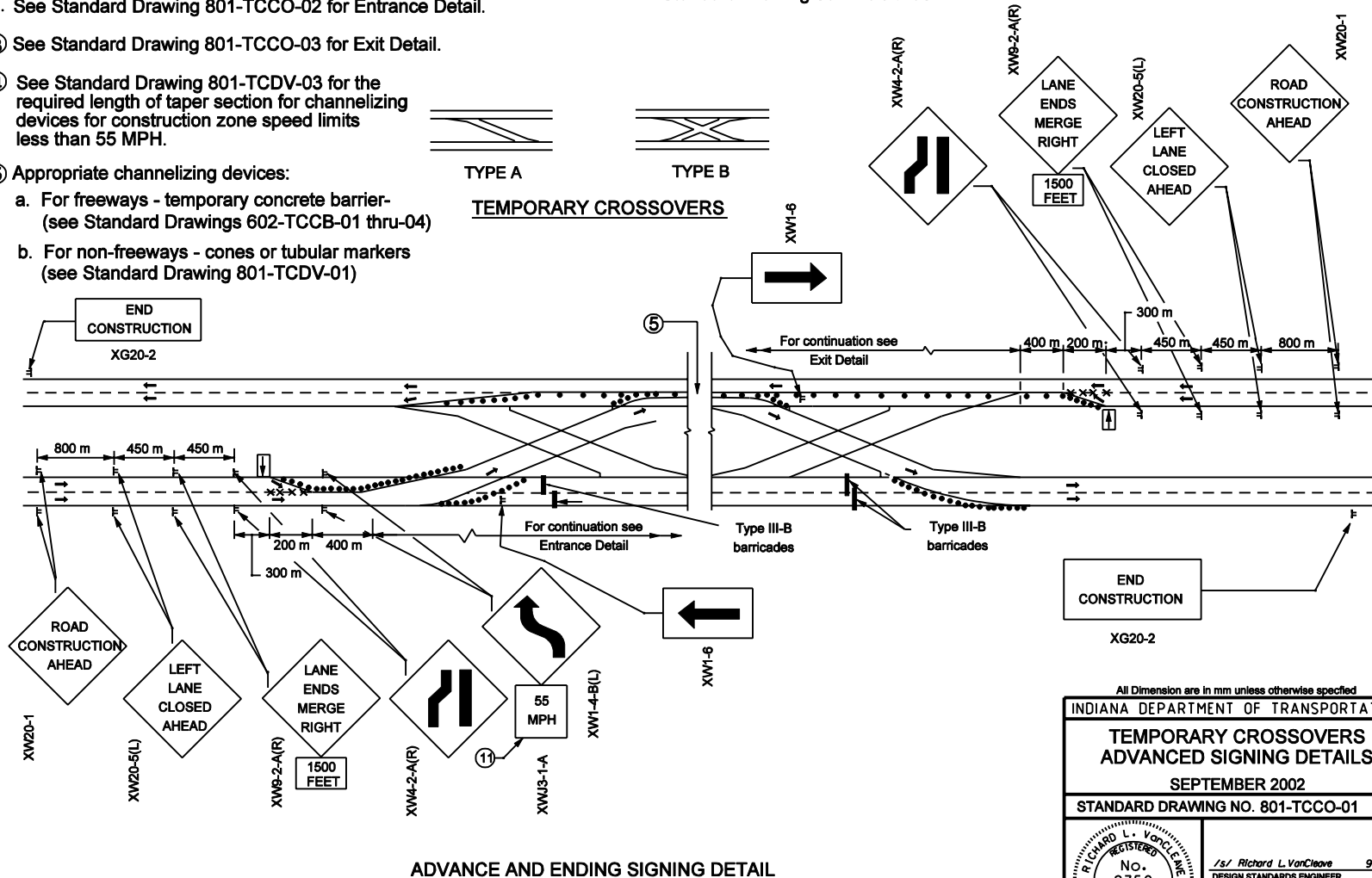
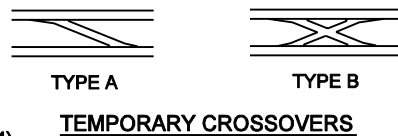

**ADVANCE AND ENDING SIGNING DETAIL**

All Dimension are in mm unless otherwise specified	
INDIANA DEPARTMENT OF TRANSPORTATION	
TEMPORARY CROSSOVERS ADVANCED SIGNING DETAILS	
SEPTEMBER 2002	
STANDARD DRAWING NO. 801-TCCO-01	
	/s/ Richard L. VanCleave DESIGN STANDARDS ENGINEER
	9-03-02 DATE
	/s/ Richard K. Smulzer CHIEF HIGHWAY ENGINEER
	9-03-02 DATE