

PLAN

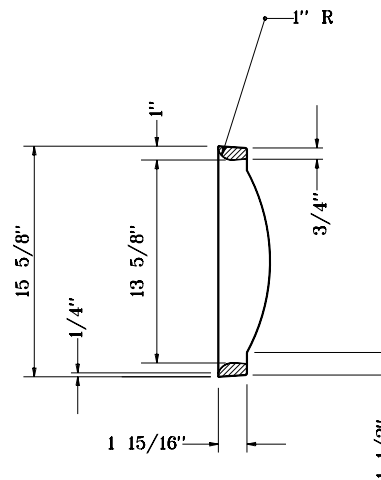

SECTION B-B

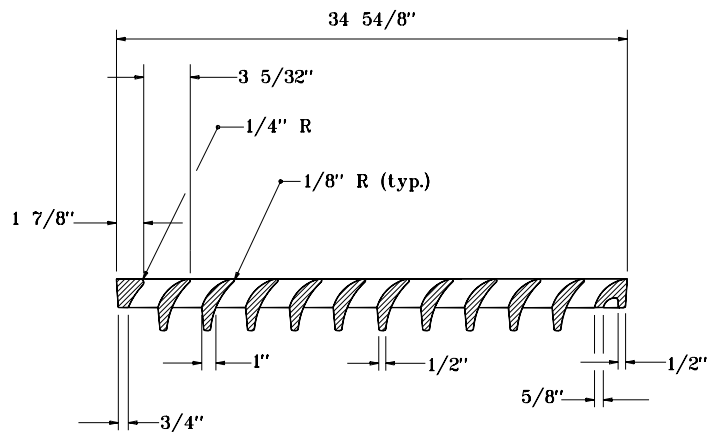

SECTION A-A

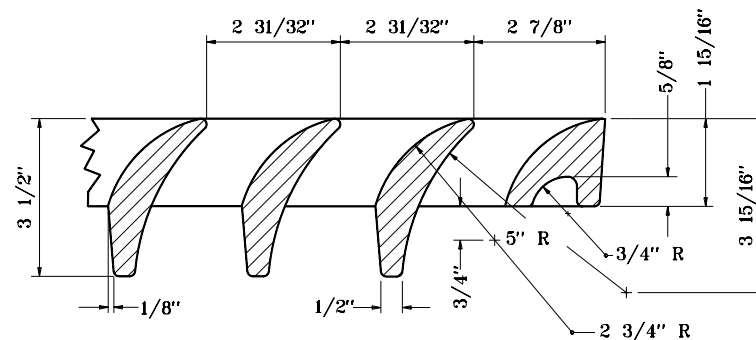

DETAIL OF SECTION A-A

**GRATE
CASTING TYPE 10**

INDIANA DEPARTMENT OF TRANSPORTATION	
CASTINGS TYPE 10	
GRATE	
SEPTEMBER 1998	
STANDARD DRAWING NO. E 720-ICCA-09	
DETAILS PLACED IN THIS FORMAT 11-15-99	
	/s/ Anthony L. Uremovich 11-15-99 DESIGN STANDARDS ENGINEER DATE
	/s/ Firooz Zandi 11-15-99 CHIEF HIGHWAY ENGINEER DATE
	ORIGINALLY APPROVED 9-01-98