

Refer to Maintenance
of Traffic Plan for
pavement section

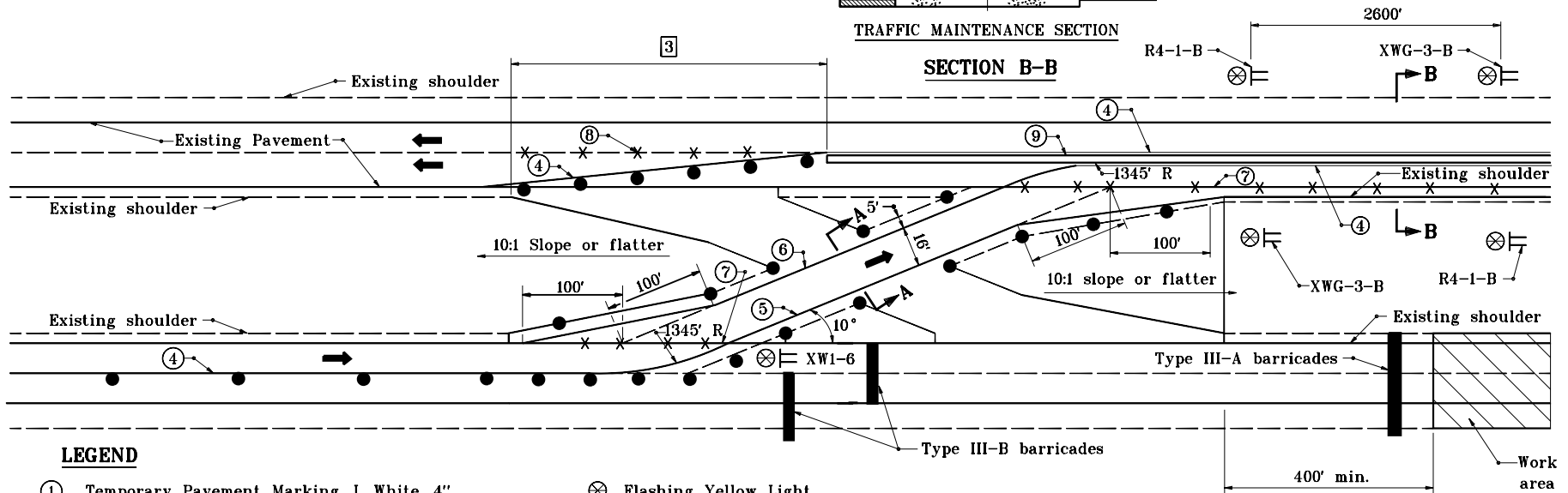
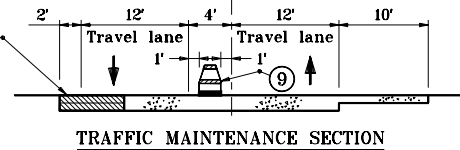

LEGEND

- ① Temporary Pavement Marking, I, White, 4"
- ② Temporary Pavement Marking, I, Yellow, 4"
- ③ Temporary Pavement Marking, II, White, 4"
- ④ Temporary Pavement Marking, II, Yellow, 4"
- ⑤ Temporary Pavement Marking, II, White, 8"
- ⑥ Temporary Pavement Marking, II, Yellow, 8"
- ⑦ Line, Solid Yellow, 4", Remove
- ⑧ Line, Broken White, 4", Remove
- ⑨ Temporary Concrete Barrier or Channelizing Devices
- ⑩ Energy Absorbing Terminal

⊗ Flashing Yellow Light

⬆ Flashing Arrow Sign

■ Type III Barricade

● Drum

≡ Construction Sign A

≡ Construction Sign A & B

NOTES:

1. Signs XW6-3-B and R4-1-B shall be used only with temporary channelizing devices.
2. See Standard Drawing E 611-TCC0-03 for signs legend.
- ③ See Standard Drawing E 801-TCDV-02 for required length.

INDIANA DEPARTMENT OF TRANSPORTATION	
TEMPORARY CROSSOVERS	
ENTRANCE DETAIL	
SEPTEMBER 2000	
STANDARD DRAWING NO. E 611-TCC0-02	
	/s/ Anthony L. Uremovich 9-01-00 DESIGN STANDARDS ENGINEER DATE
	/s/ Firooz Zandi 9-01-00 CHIEF HIGHWAY ENGINEER DATE