

MONUMENT TYPE: *STANDARD BENCH MARK DISK IN CONCRETE MONUMENT*

STAMPING ON DISK: *USC&GS BENCH MARK "K 71 RESET" 1956*

PHYSICAL CONDITION: *EXCELLENT CONDITION - PROTRUDING 0.5 ft*

COMMENTS ON SUITABILITY FOR GPS OBSERVATIONS: *SOME EXTENSIVE OBSTRUCTIONS
BUT HAS POTENTIAL*

"GPS PLAN" CALCULATED OBSERVATIONS TIMES FOR: 7-12-96 15" EPOCHS WITH 5 SV's MIN.

**7:54 TO 8:52 A.M. IND. TIME
9:12 TO 9:30 A.M.**

TO REACH: 2.5 mi SOUTH FROM BELLMORE ALONG SR 59 FROM THE JUNCTION OF US 36, IN THE NORTHWEST QUATER OF THE JUNCTION WITH A BLACKTOP ROAD LEADING WEST, 50 ft WEST OF THE CENTERLINE OF THE HIGHWAY, 92 ft NORTH OF THE CENTERLINE OF THE ROAD LEADING WEST, 2 ft SOUTH OF A CONCRETE INDIANA RW MARKER, AND ABOUT 5 ft HIGHER THAN THE HIGHWAY.

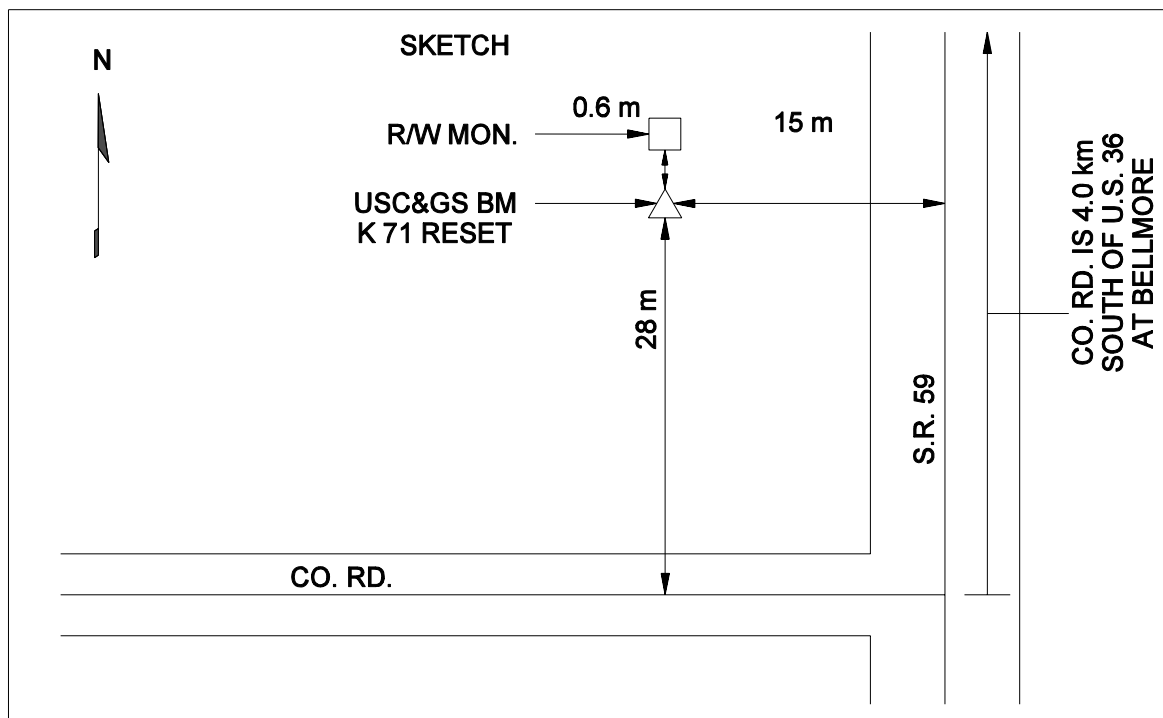

REFERENCE DRAWING

Figure 25-2B