

BRIDGE CONTRACT No. 1537

INDEX	NO.	TYPE	STRUCTURE		STATION	DRAWING NUMBER	SUBJECT	BRIDGE CONTRACT NO.
			SPAN	OVER				
1							Index and Title Sheet	1537
2							Road Plan and Profile	
3	D-3049	R.C. Girder	1 x 32'-0"	Jones & Armstrong Ditch	18+80	C1	Layout	
4							General Plan & Typical Approach Section	
5							Substruct. Details, Bill of Materials & Bend Diagrams	
6							Superstruct. Details, Bill of Materials & Bend Diagrams	
7	D-3050	R.C. Girder	1 x 32'-0"	Lost Creek	28+35	C1	Layout	
8							General Plan	
9							Substruct. Details, Bill of Materials & Bend Diagrams	
10							Superstruct. Details, Bill of Materials & Bend Diagrams	
11							Concrete Reinforcing Details (Rev. April 12, 1937)	
12							Concrete Reinforcing Details (Rev. April 12, 1937)	
13							Cross Sections	
14							Check for Concrete for Extensions (May 1934)	
15							Double Steel Plate Girder Rail (May 1935)	
16							Miscellaneous Specs. Sheet No. 1 (Rev. 1935)	
17							Sheet No. 1 (Rev. May 1937)	
18							Supplement to Reinforcing Curves (Sept. 1937)	
19							Detour, Bypasses, etc. (Rev. Jan. 8, 1936)	

STATE OF INDIANA  
STATE HIGHWAY COMMISSION

# BRIDGE PLANS

## FOR SPANS OVER 20 FEET

### ON

## STATE ROAD NO. 234 SECTION D

LOCATION OF STRUCT. 234-D-3049: ON STATE ROAD 234 IN MONTGOMERY COUNTY, ON BOUNDARY LINE BETWEEN SECTS. 12 & 13, T. 17N, R. 5W, OVER JONES & ARMSTRONG DITCH APPROX. 2.5 MILES EAST OF STATE ROAD 47.  
LOCATION OF STRUCT. 234-D-3050: ON STATE ROAD 234 IN MONTGOMERY COUNTY, ON BOUNDARY LINE BETWEEN SECTS. 12 & 13, T. 17N, R. 5W, OVER LOST CREEK APPROX. 2.8 MILES EAST OF STATE ROAD 47.

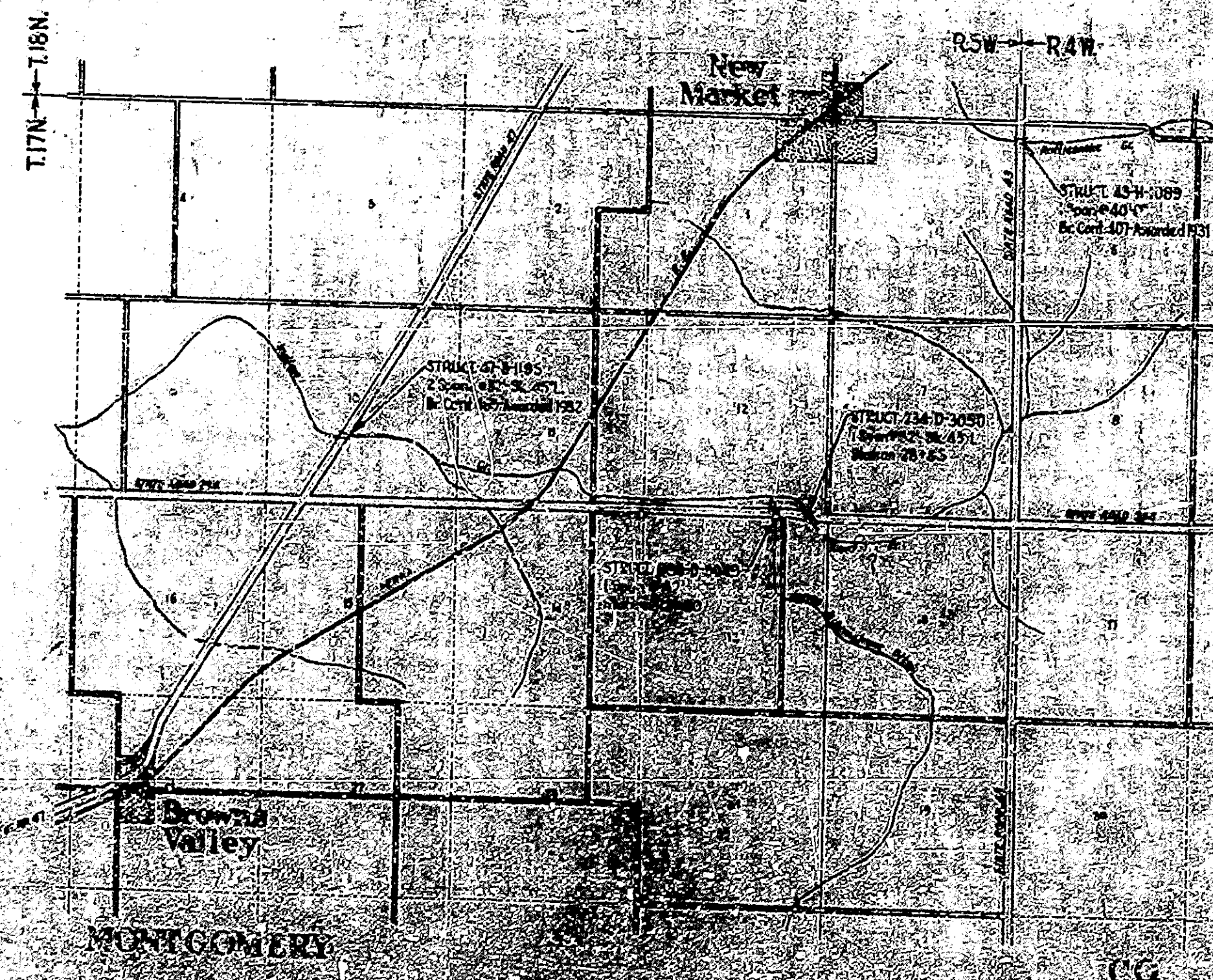

STATE HIGHWAY COMMISSION STANDARD  
BRIDGE SPECIFICATIONS DATED SEPTEMBER 1936  
TO BE USED WITH THESE PLANS.

Rev. 5-20-37 Sheet No. 12

APPROVED AND ADOPTED APRIL 30, 1937  
BY STATE HIGHWAY COMMISSION OF INDIANA  
*Carl ...*  
APPROVED APRIL 1937  
*...*



BRIDGES OVER 20' SPAN				
FED. ROAD DIST. NO.	STATE	CONTRACT NO.	SECTION	TOTAL SHEETS
7	IND.	234	1936	2
				29

SECTION D

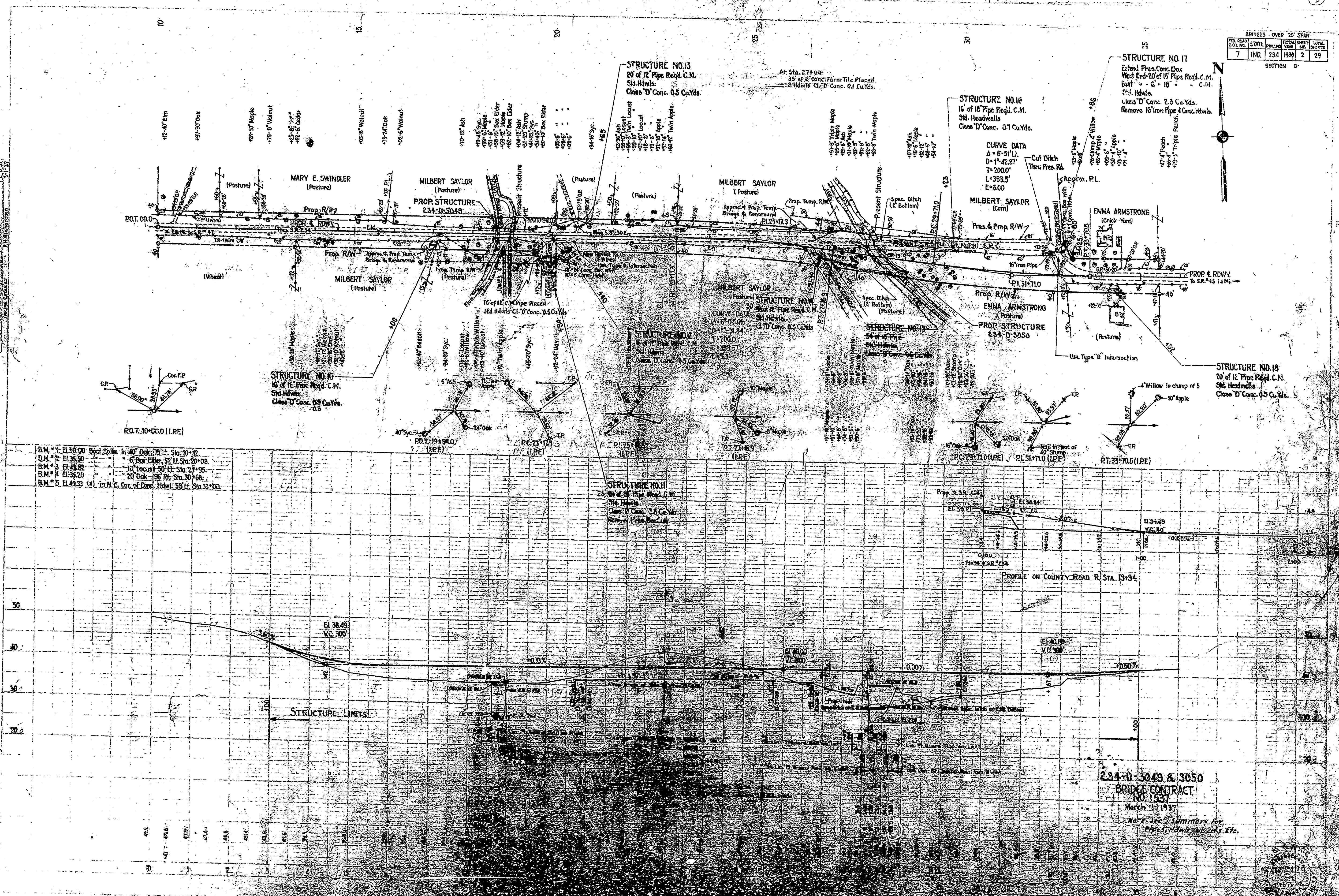

B.M. # 1	EL. 50.00	Box Spike in 40' Oak Sta. 10+32
B.M. # 2	EL. 38.50	6" Box Elder 32' N. Sta. 20+08
B.M. # 3	EL. 48.82	10' Locust 50' N. Sta. 21+95
B.M. # 4	EL. 38.20	20' Oak - 36' R. Sta. 30+66
B.M. # 5	EL. 49.33	(1) in N.E. Cor. of Conc. Hdwall 55' N. Sta. 33+00

234-D-3049 & 3050  
 BRIDGE CONTRACT  
 NO. 1537  
 March 1, 1937  
 No. E-125 Summary by  
 H. S. Davis & Roberts, Etc.



BRIDGES OVER 20' SPAN				
FED. ROAD DIST. NO.	STATE	PROJ. NO.	SHEET NO.	TOTAL SHEETS
7	IND.	234	3	29

SECTION - D

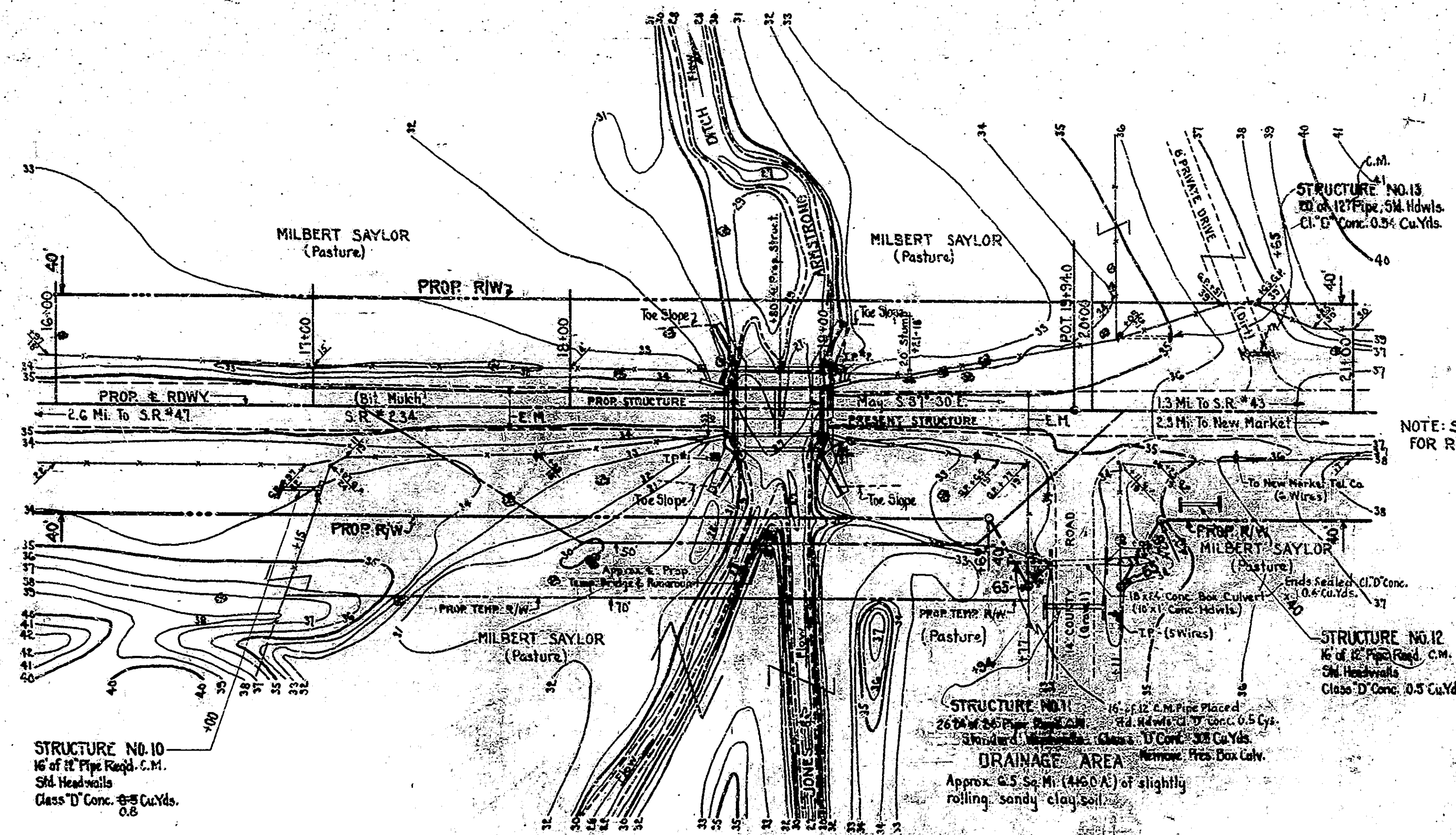

NOTE: SEE ROAD PLAN FOR REFERENCES.

**R.C. SLAB TOP BRIDGE**  
Note: Structure is in poor condition. Pier is badly undermined.

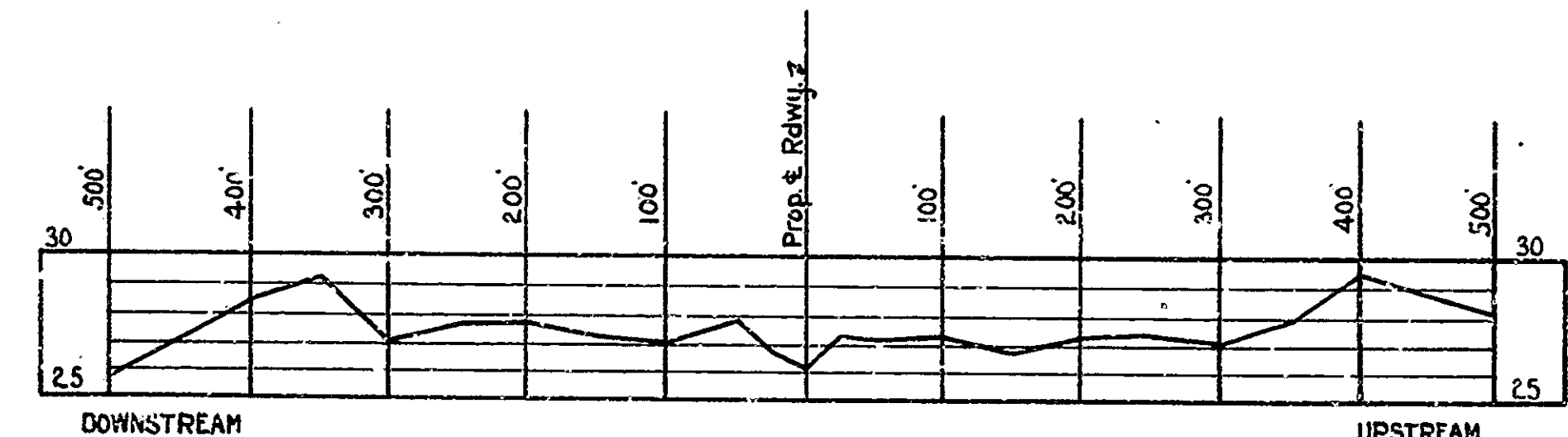
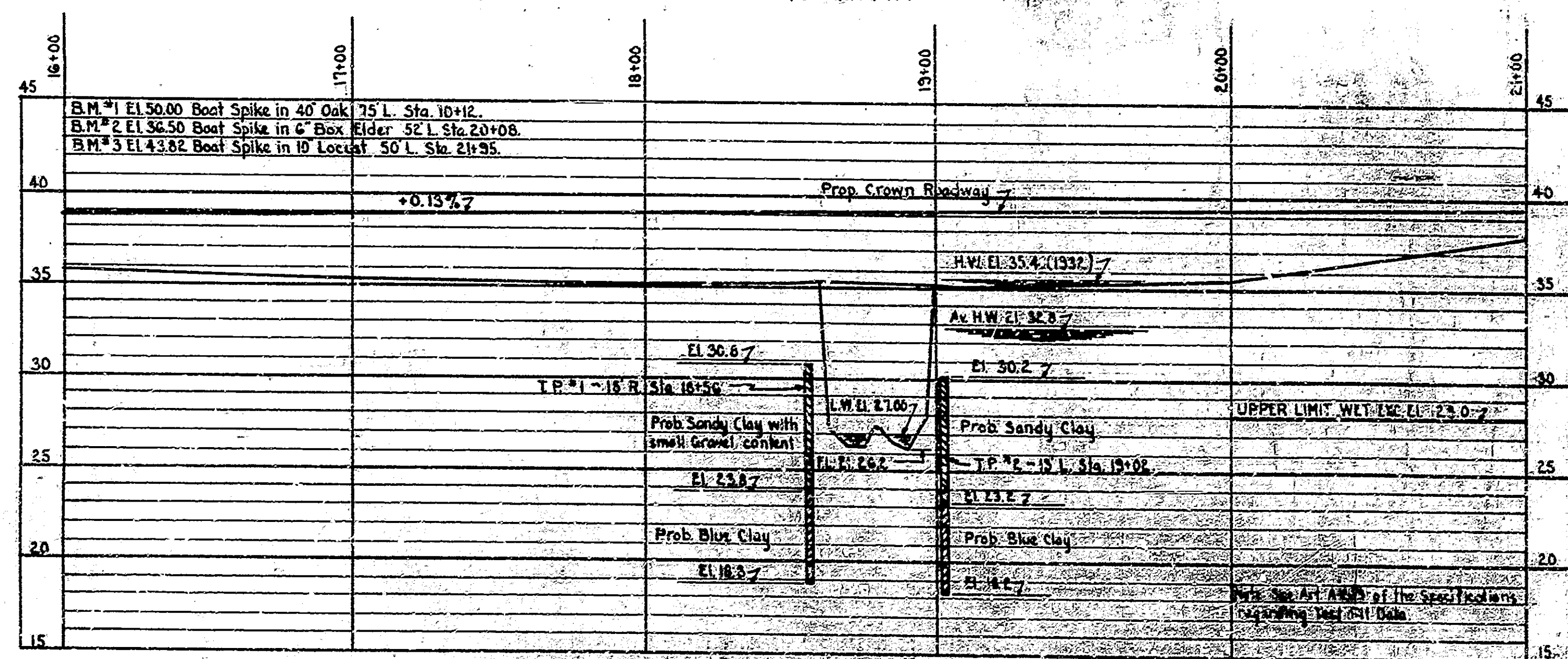
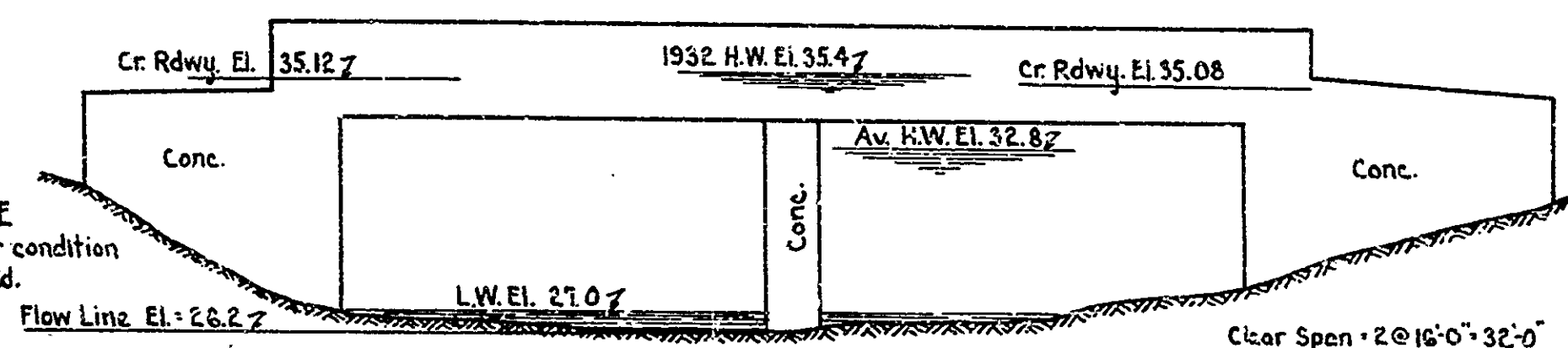

NOTE: See Summary for pipes & hdwls.

LAYOUT  
**REINFORCED CONCRETE BRIDGE**  
1 SPAN @ 32'-0"  
OVER JONES & ARMSTRONG DITCH  
ON STATE ROAD: 234-D  
28'-0" ROADWAY  
MONTGOMERY COUNTY

SCALE: AS NOTED  
RECOMMENDED FOR APPROVAL: MARCH 1, 1937

PROJECT: 234  
SECTION: D  
DRAWING: C1 OF 3

STATION: 18+80  
STRUCTURE NO. 3049  
BRIDGE CONTRACT NO. 1537



DESIGNED: W.M.W. 12-11-36  
DRAWN: E.M.R. 2-13-37  
CHECKED: D.L.S. 2-16-37

FIELD NOTES: Book BR 304 - Pgs. 1-27

Rev. For Change Orders - #125-37



BRIDGES OVER 20' SPAN				
FED. ROAD DIST. NO.	STATE	SPAN NO.	TOTAL SPAN	TOTAL LENGTH
7	IND.	234	1936	4 29

SECTION - D

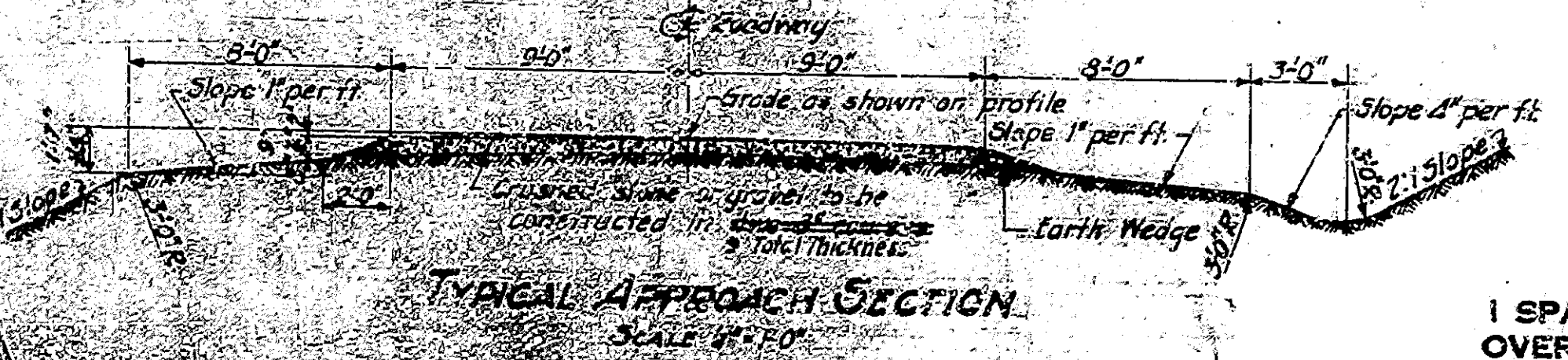
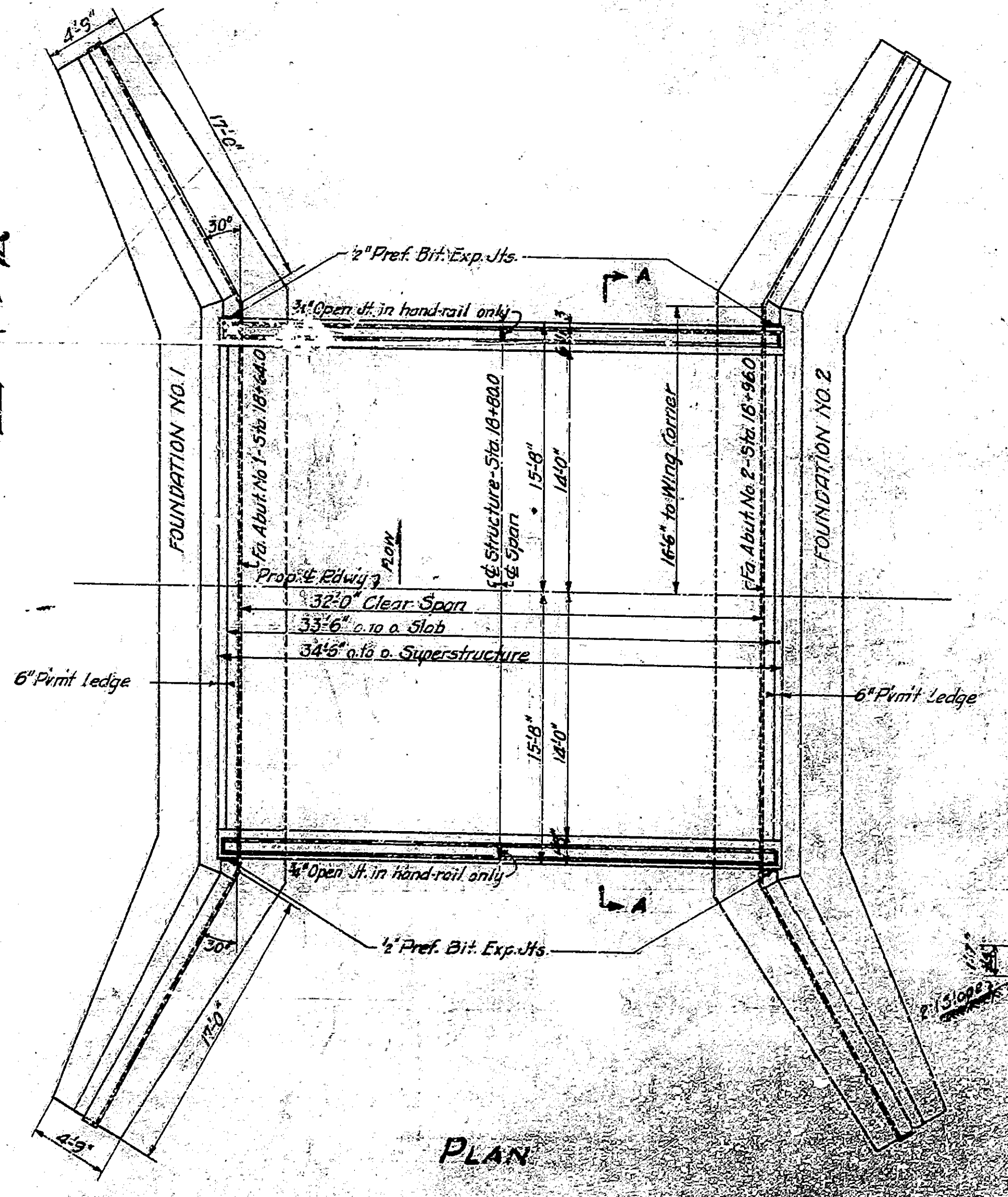
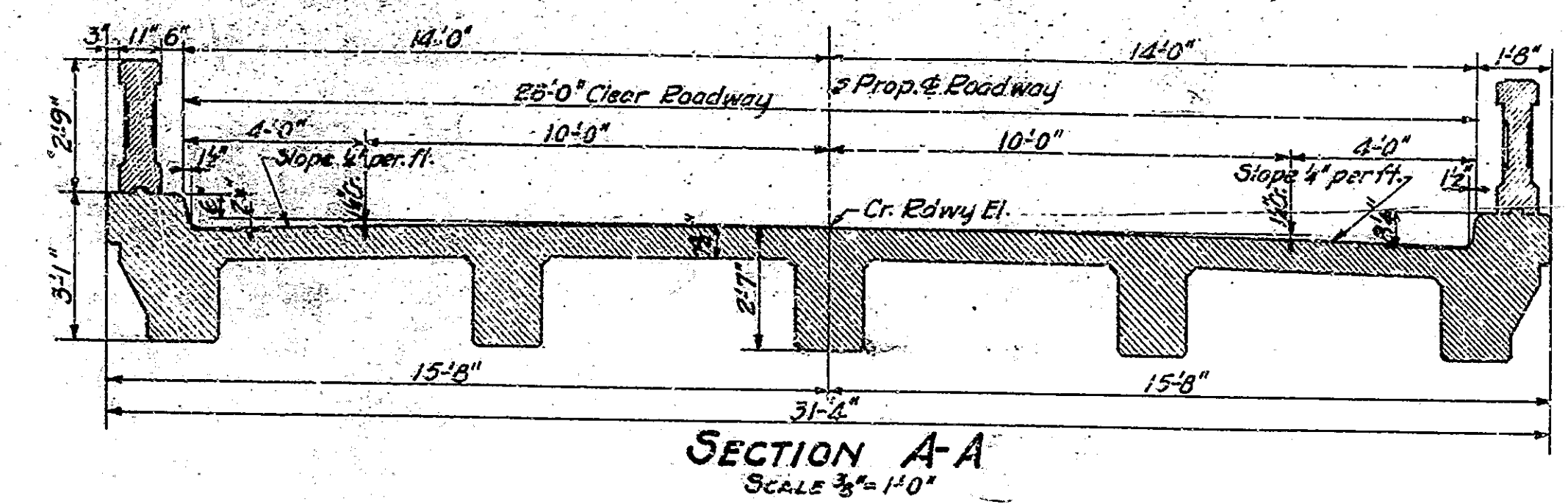
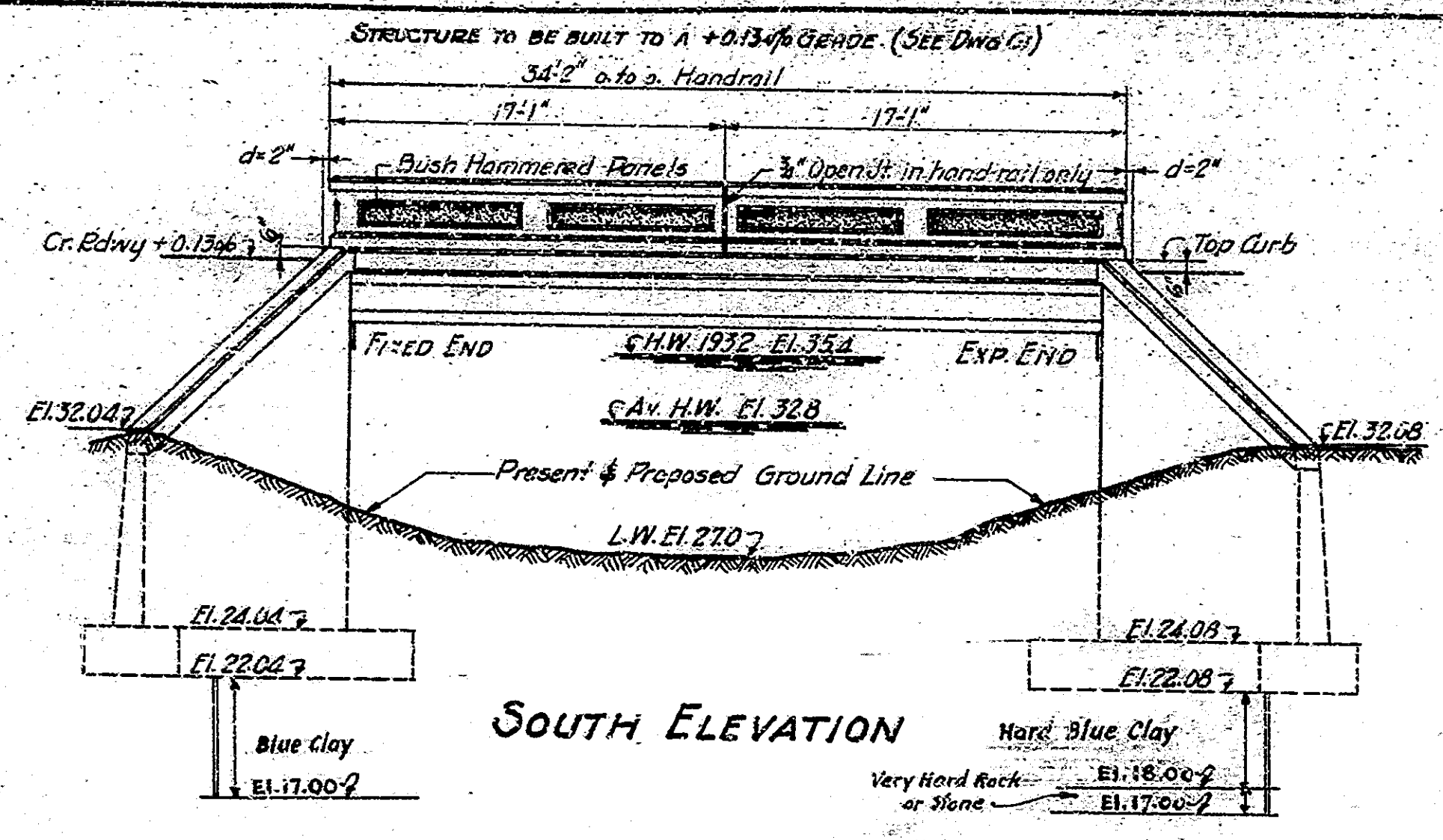

**GENERAL NOTES:**

- Depth of footings to be extended if found necessary. See Art. 5B-202 of the Specifications.
- Reinforcing steel covering shall be 1" in floor slabs, 3" in footings, and 2" in all other parts unless noted.
- Concrete in footings, wing-walls and abutments to be Class "E".
- Concrete in superstructure including hand-rail to be Class "D".
- Concrete in headwalls to be Class "D".
- Waterproof abutments and wingwalls in accordance with Specifications.
- Devel forms under copings and chamfer exposed edges unless noted.
- Wings to be rip-rapped.
- Outlet ends of drains through structure to project 3". Cut or burn off inlet ends flush with concrete.
- See Special Provisions for items included in this contract.
- Approaches Completed by Bridge Contractor.

**STANDARD DRAWINGS.**  
 Superstructure - Use Standard Superstructure Details.  
 32'-0" Span R.C. Girder, Square.  
 28'-0" Roadway, Drawing Std. No. 1026-A dated Mar. 1 1937.

GENERAL PLAN  
**REINFORCED CONCRETE BRIDGE**  
 1 SPAN @ 32'-0" OVER JONES & ARMSTRONG DITCH  
 28'-0" ROADWAY ON STATE ROAD-234D  
**STATE HIGHWAY COMMISSION OF INDIANA**  
 MONTGOMERY COUNTY

SCALE: 1/4" = 1'-0" UNLESS NOTED  
 RECOMMENDED FOR APPROVAL: *[Signature]*  
 PROJECT: 234 STATION: 18+80  
 SECTION: D STRUCTURE NO. 3649  
 DRAWING: C3 OF 3  
 MARCH 1, 1937  
 BRIDGE CONTRACT NO. 1537

DESIGNED BY: C. F. STUBBS  
 DRAWN BY: J. H. HARRIS  
 CHECKED BY: J. H. HARRIS  
 TRACED BY: J. H. HARRIS



BRIDGES OVER 20' SPAN					
YER. ROAD DIST. NO.	STATE	PROJ. NO.	SPAN LENGTH (FEET)	TOTAL SHEETS	SHEET NO.
7	IND.	234	1938	5	29

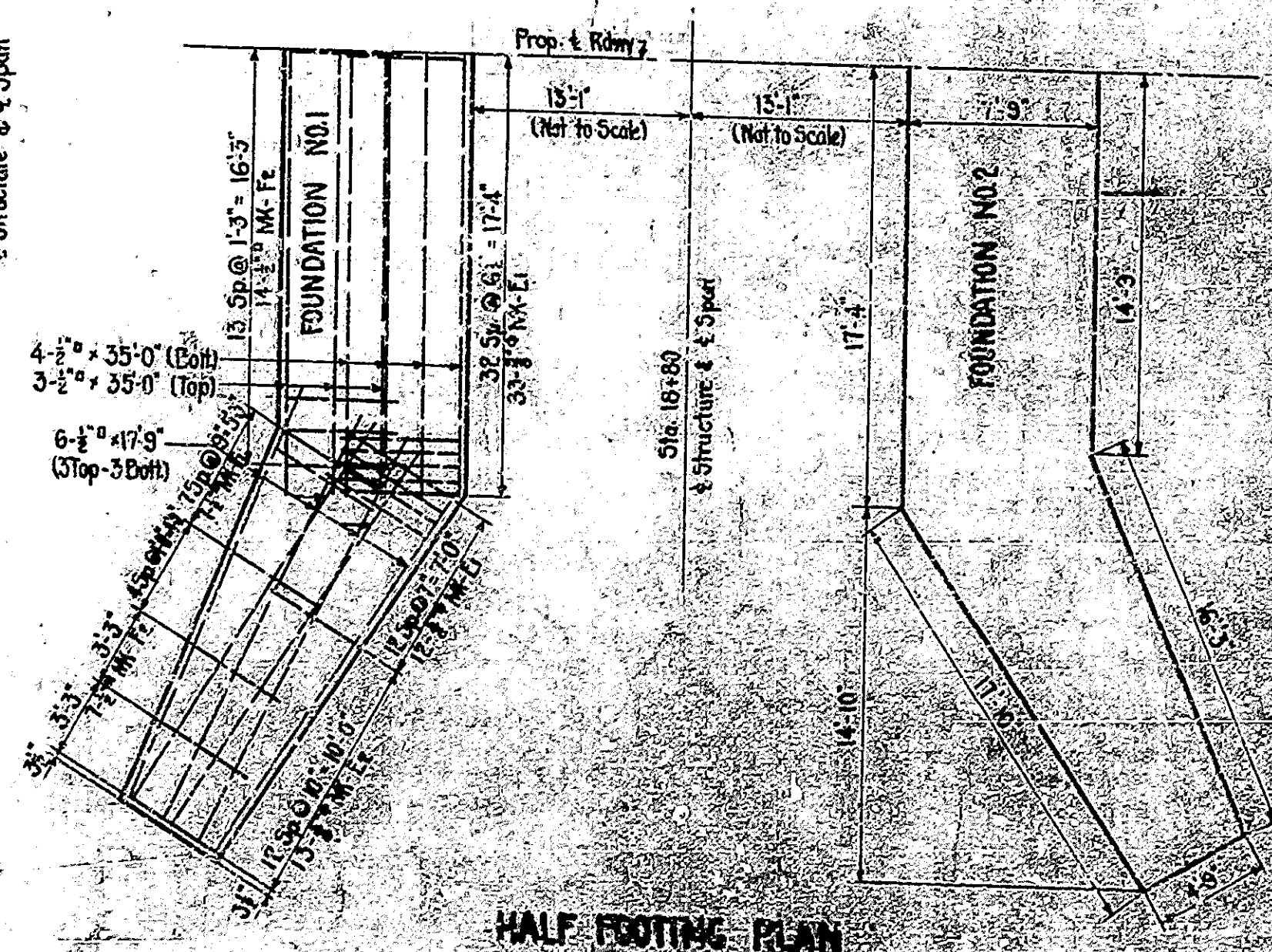
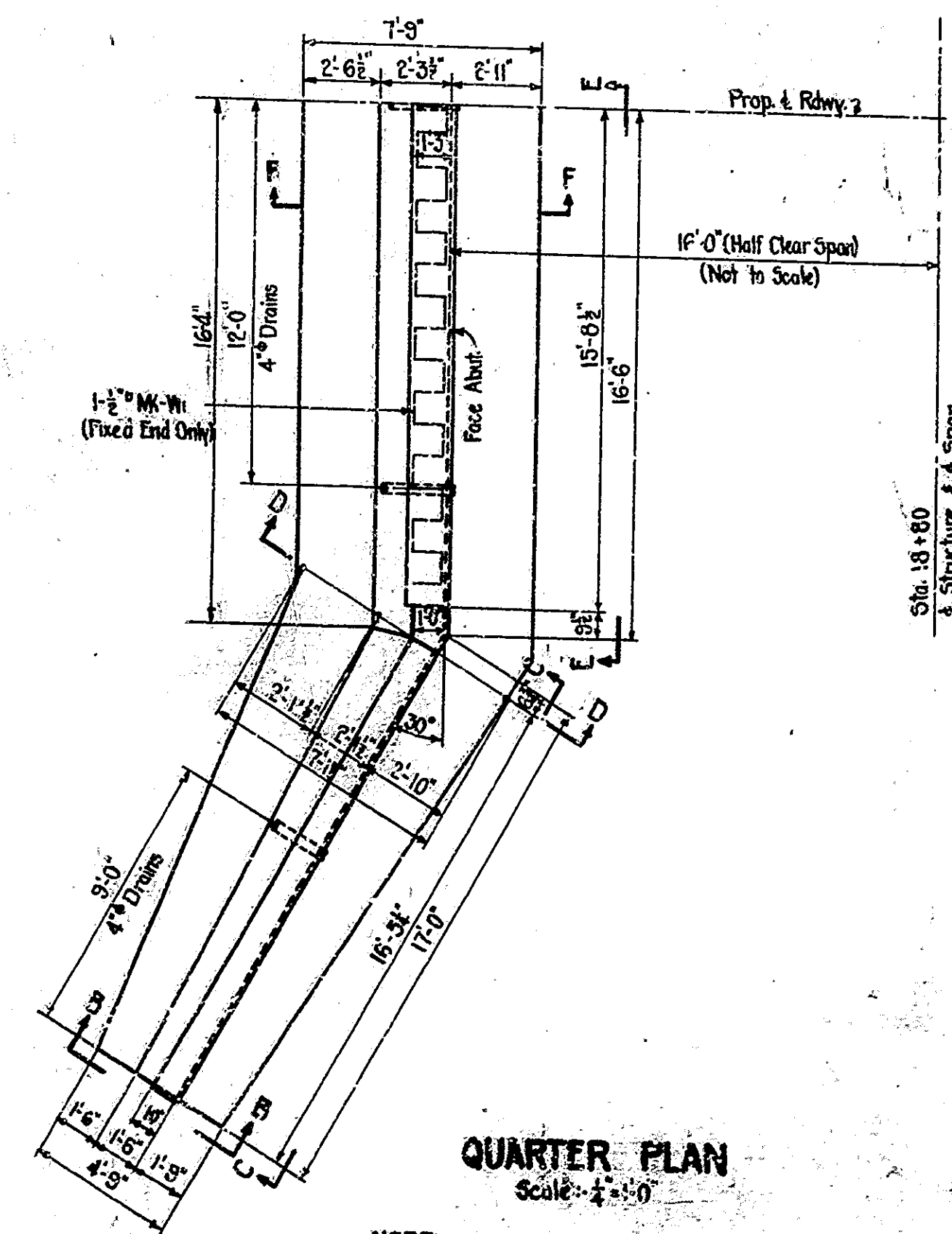
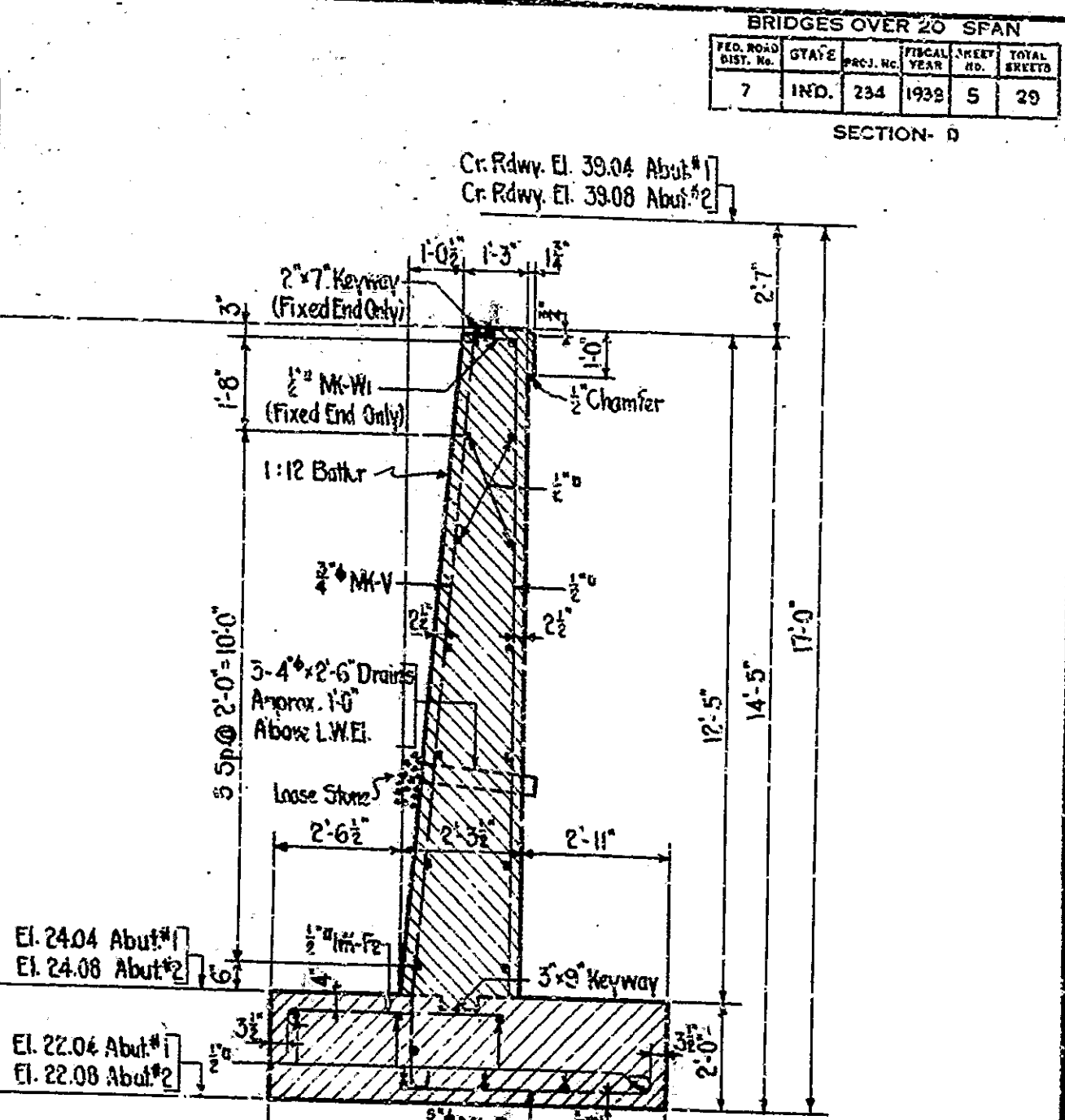
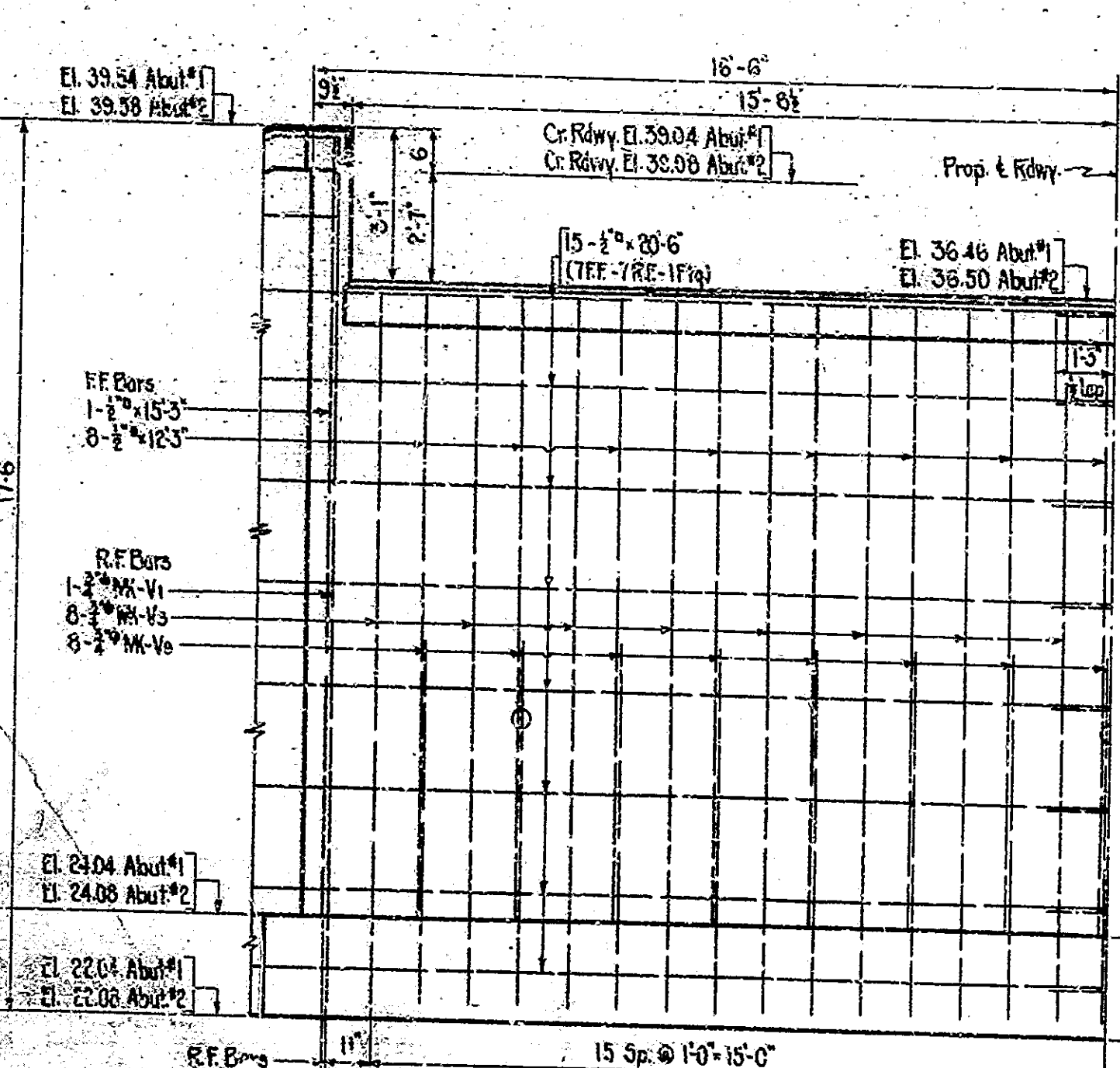
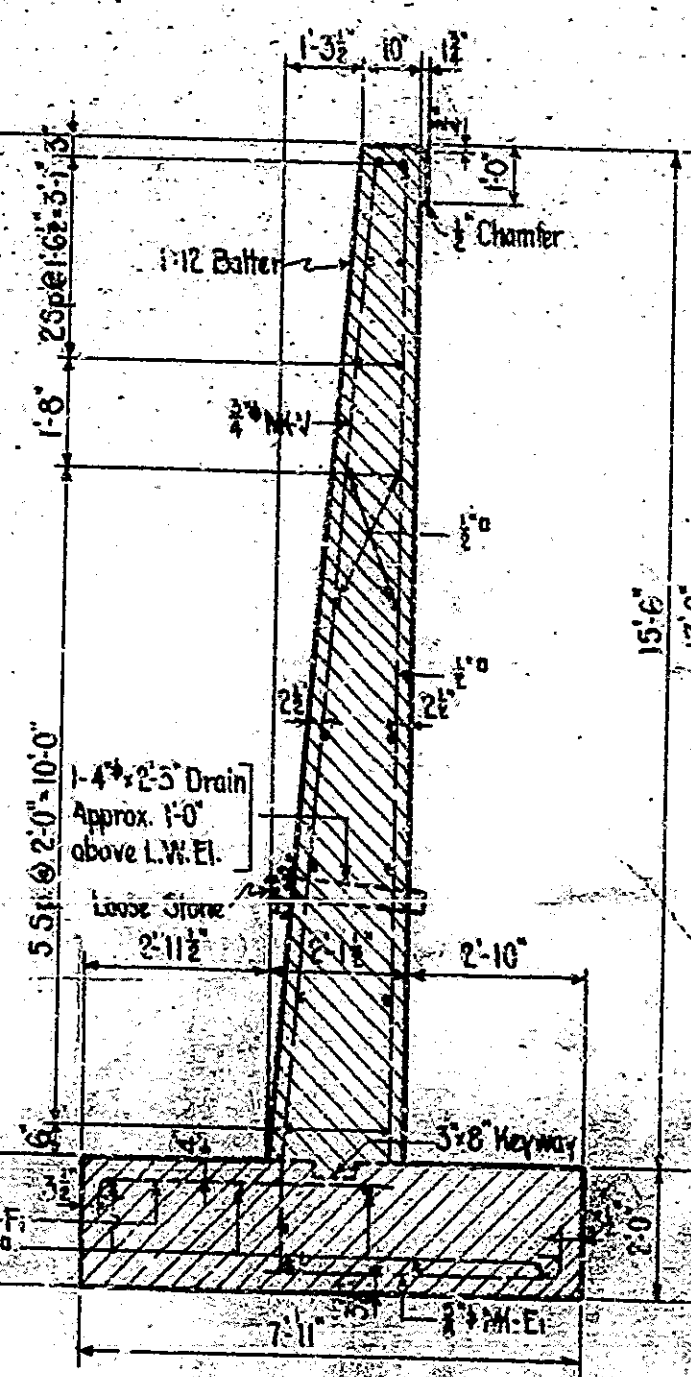
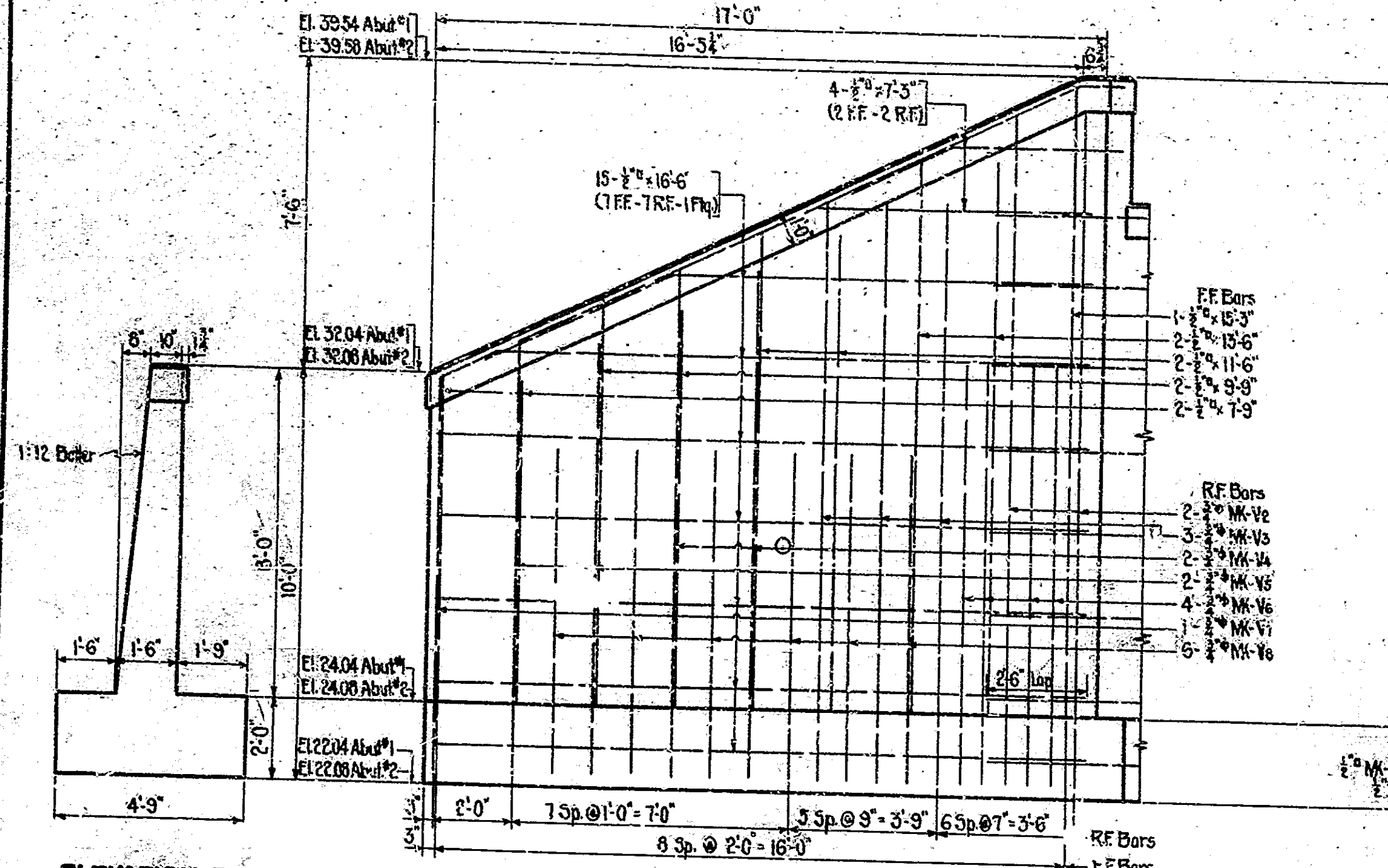

**BILL OF MATERIALS**

REINFORCING STEEL		MARK	NO.	SIZE	LENGTH	LOCATION	TOTAL LENGTH	WEIGHT
STRAIGHT	V1	16	11	4	17'-5"	Top R.F. Abut. (2 C. Abut.)	350'-0"	2542*
	V2	16	2	4	16'-3"	Wings (2 C. Wings)	326'-0"	
	V3	16	1	4	14'-6"	1 Abut. (1 C. Abut.)	292'-0"	
	V4	16	2	4	13'-0"	2 C. Wings	260'-0"	
	V5	16	2	4	12'-3"	(1 C. Wing)	246'-0"	
	V6	16	2	4	11'-5"	(1 C. Wing)	230'-0"	
	V7	16	2	4	10'-5"	(1 C. Wing)	210'-0"	
	V8	16	2	4	9'-5"	(1 C. Wing)	190'-0"	
	V9	16	2	4	8'-5"	(1 C. Wing)	170'-0"	
	V10	16	2	4	7'-5"	(1 C. Wing)	150'-0"	
	V11	16	2	4	6'-5"	(1 C. Wing)	130'-0"	
	V12	16	2	4	5'-5"	(1 C. Wing)	110'-0"	
	V13	16	2	4	4'-5"	(1 C. Wing)	90'-0"	
	V14	16	2	4	3'-5"	(1 C. Wing)	70'-0"	
	V15	16	2	4	2'-5"	(1 C. Wing)	50'-0"	
	V16	16	2	4	1'-5"	(1 C. Wing)	30'-0"	
	V17	16	2	4	1'-0"	(1 C. Wing)	20'-0"	
	V18	16	2	4	1'-0"	(1 C. Wing)	20'-0"	
	V19	16	2	4	1'-0"	(1 C. Wing)	20'-0"	
	V20	16	2	4	1'-0"	(1 C. Wing)	20'-0"	
	V21	16	2	4	1'-0"	(1 C. Wing)	20'-0"	
	V22	16	2	4	1'-0"	(1 C. Wing)	20'-0"	
	V23	16	2	4	1'-0"	(1 C. Wing)	20'-0"	
	V24	16	2	4	1'-0"	(1 C. Wing)	20'-0"	
Total R.F. Bars							3572'	2542*
Total C. Wings							4615'	1866*
TOTAL REINFORCING STEEL								4438'
CONCRETE							63.0 Cu Yds	
SPECIAL ANCHORS							92.3	

Mark	Size	Q	a	Length
V1	16	11	4	17'-5"
V2	16	2	4	16'-3"
V3	16	1	4	14'-6"
V4	16	2	4	13'-0"
V5	16	2	4	12'-3"
V6	16	2	4	11'-5"
V7	16	2	4	10'-5"
V8	16	2	4	9'-5"
V9	16	2	4	8'-5"
V10	16	2	4	7'-5"
V11	16	2	4	6'-5"
V12	16	2	4	5'-5"
V13	16	2	4	4'-5"
V14	16	2	4	3'-5"
V15	16	2	4	2'-5"
V16	16	2	4	1'-5"
V17	16	2	4	1'-0"
V18	16	2	4	1'-0"
V19	16	2	4	1'-0"
V20	16	2	4	1'-0"
V21	16	2	4	1'-0"
V22	16	2	4	1'-0"
V23	16	2	4	1'-0"
V24	16	2	4	1'-0"

SUBSTRUCTURE DETAILS, BILL OF MATERIALS & BENDING DIAGRAMS  
 STATE HIGHWAY COMMISSION OF INDIANA

SCALE: 1/8" = 1'-0" UNLESS NOTED  
 RECOMMENDED FOR APPROVAL: \_\_\_\_\_ MARCH 1, 1937

PROJECT: 234  
 SECTION: D  
 DRAWING: C3 OF 3  
 STATION: 18+80  
 STRUCTURE NO. 3049  
 BRIDGE CONTRACT NO. 1537

DESIGNED BY: B.S. No. \_\_\_\_\_  
 DRAWN BY: D.L.S. 2-29-37  
 CHECKED BY: L.M. 2-24-37  
 APPROVED BY: \_\_\_\_\_

NOTE: WINGS DESIGNED FOR SECTION WITH 18' PAVEMENT, 8' SHOULDERS, 2:1 SLOPES, TO SPILL TO ELEV. 5' ABOVE BOTTOM OF FOOTINGS AT FACES OF ABUTMENTS

NOTE: See Summary Sheet for Bill of Spike Bars



BRIDGES OVER 20' SPAN					
FED. ROAD DIST. NO.	STATE	PROJ. NO.	LOCAL YEAR	SHEET NO.	TOTAL SHEETS
7	IND.	234	1938	7	25

SECTION - D

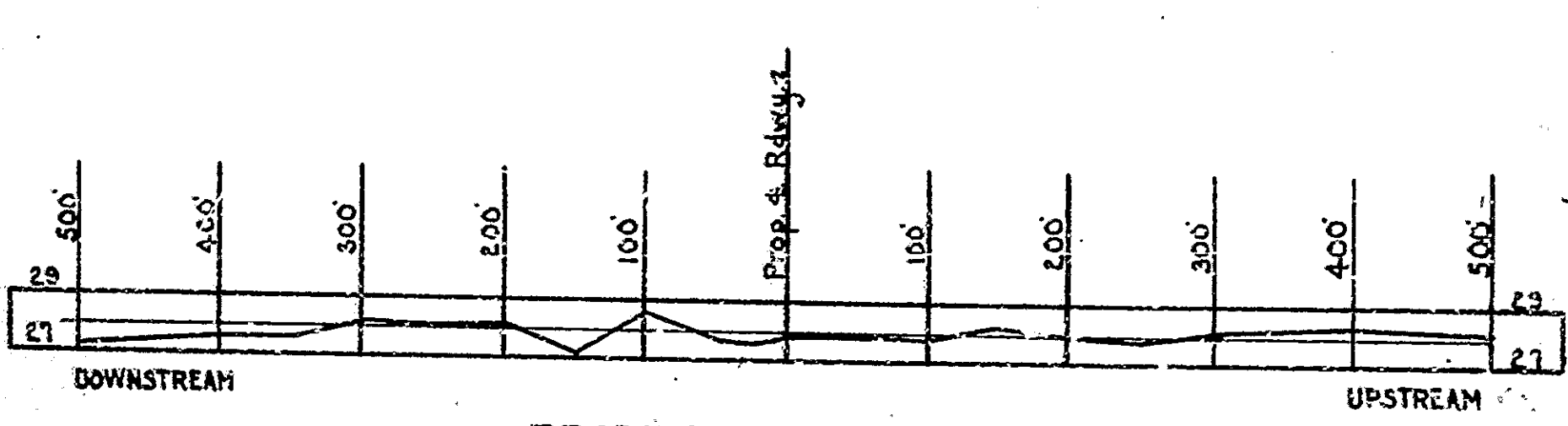
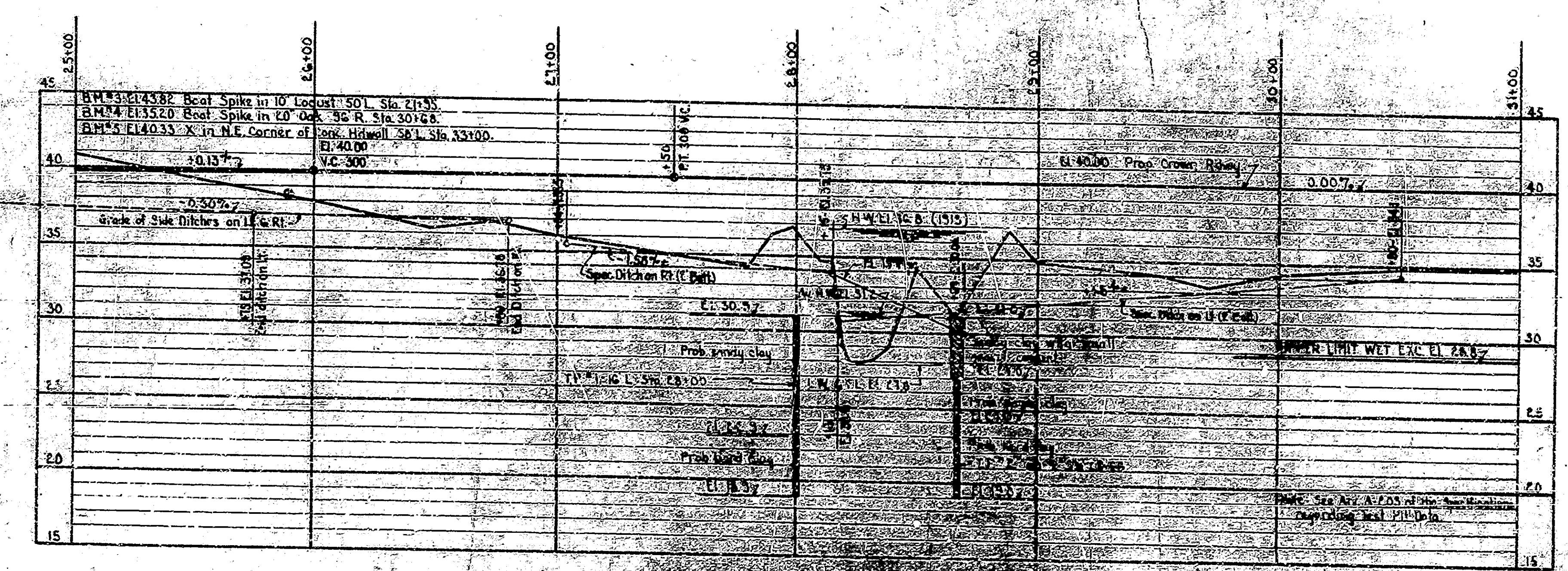
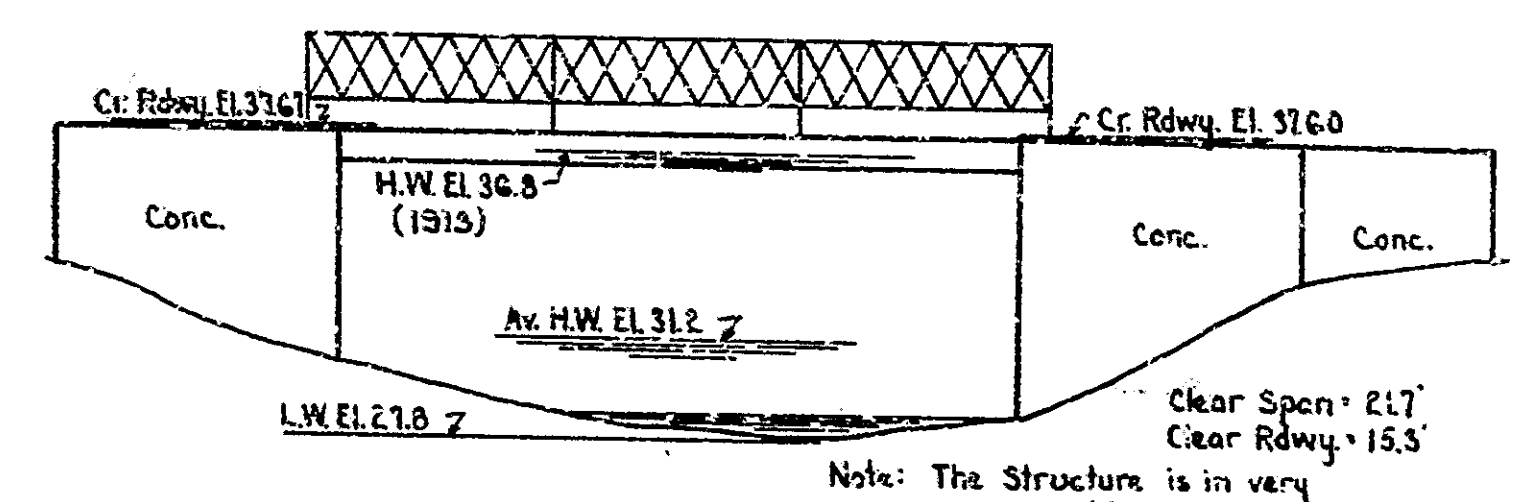
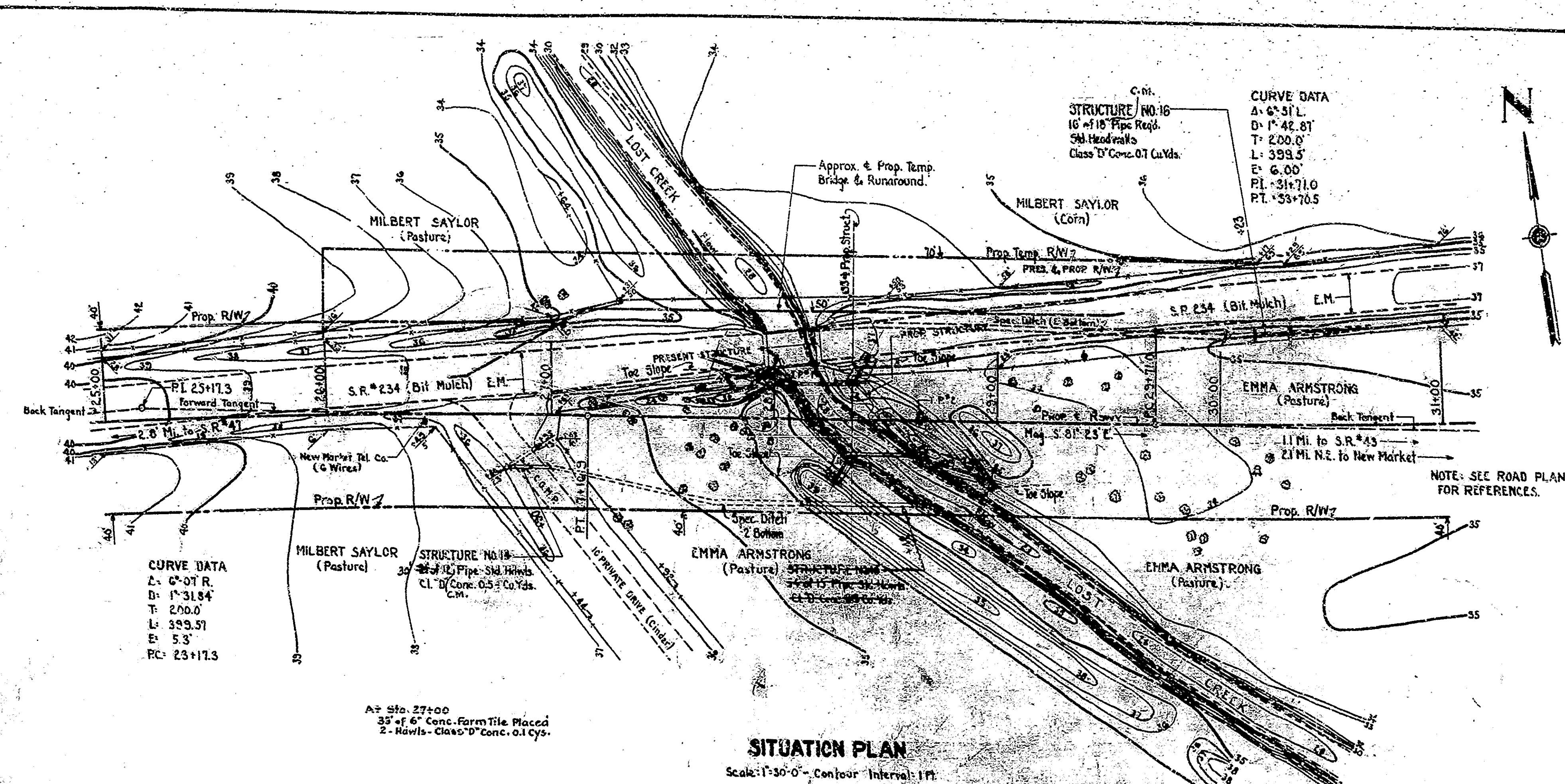

LAYOUT  
**REINFORCED CONCRETE BRIDGE**  
1 SPAN @ 32'-0" SK. 45'L  
OVER LOST CREEK  
28'-0" ROADWAY  
ON STATE ROAD-234-D

**STATE HIGHWAY COMMISSION OF INDIANA**  
MONTGOMERY COUNTY

SCALE: AS NOTED  
RECOMMENDED FOR APPROVAL: *[Signature]*  
PROJECT: 234  
SECTION: D  
DRAWING: C-1 OF 3

MARCH 1, 1937  
STATION: 28+35  
STRUCTURE NO. 3050  
BRIDGE CONTRACT NO. 1537

DESIGNED BY: H.H.W. 12-15-36  
DRAWN BY: H.H.W. 12-15-36  
CHECKED BY: H.H.W. 2-15-37

FIELD NOTES: Book BR-333 - Pg. 1-36

Revised Contract Changes - 4-24-37



BRIDGES OVER 20' SPAN					
FED. ROAD DIST. NO.	STATE	PROJ. NO.	SECTION	SHEET NO.	TOTAL SHEETS
7	IND.	234	1937	8	99

SECTION - D

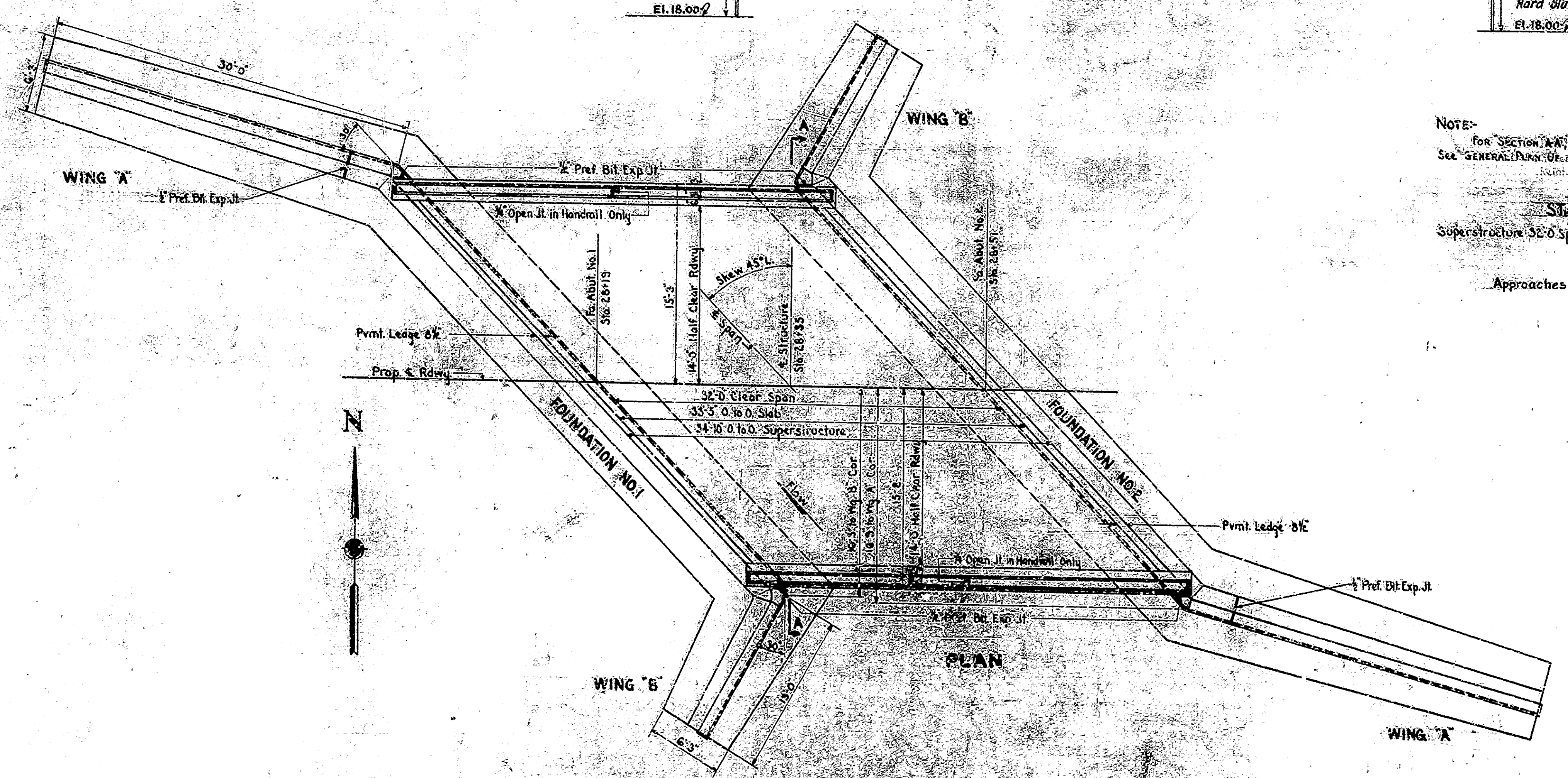
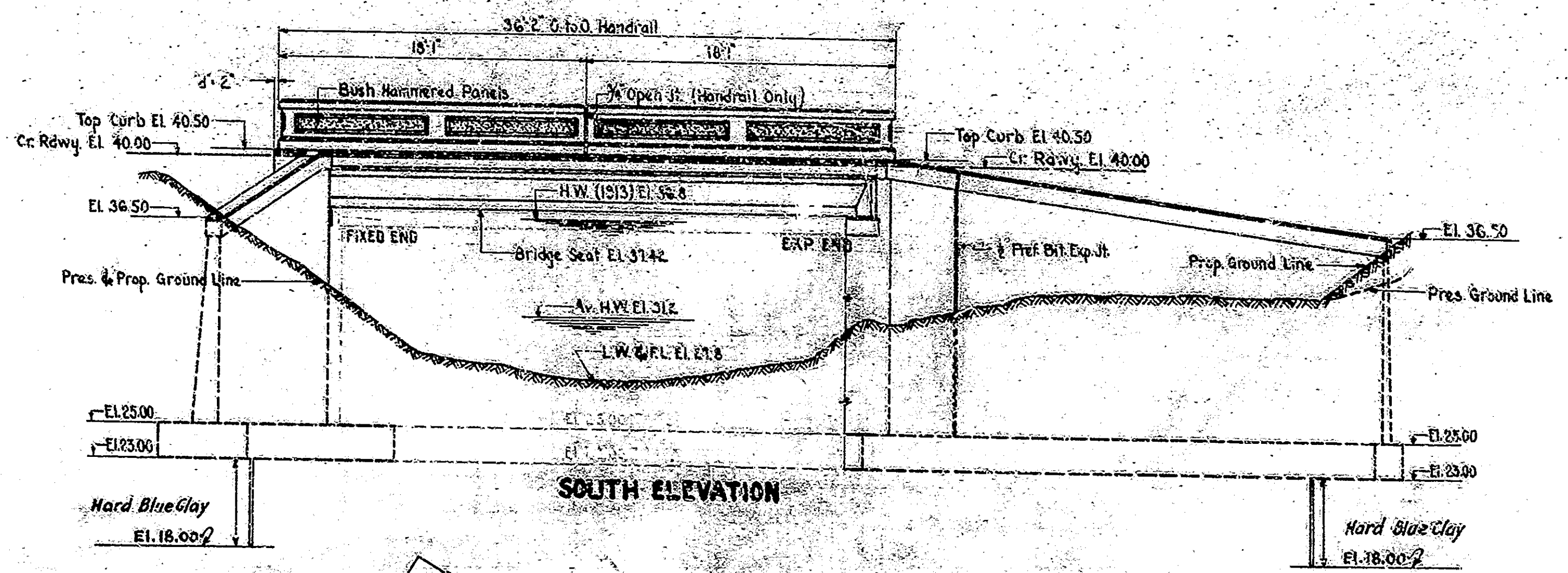

NOTE:  
 FOR SECTION A-A, TYPICAL APPROACH SECTION, AND GENERAL NOTES, SEE GENERAL DRAWING OF STRUCTURE No. 234-D-3043 ON DWG. C-1 (SHEET No. 4).  
**STANDARD DRAWINGS**  
 Superstructure: 32'-0" Span, Skew 45° L., 28'-0" Rdwy. Draw. Sid: 1023-A, dated Mar. 1, 1937.  
 Approaches Completed by Bridge Contractor -

GENERAL PLAN  
**REINFORCED CONCRETE BRIDGE**  
 1 SPAN @ 32'-0" SK. 45° L.  
 OVER LOST CREEK  
 28'-0" ROADWAY  
 ON STATE ROAD-234-D  
**STATE HIGHWAY COMMISSION OF INDIANA**  
 MONTGOMERY COUNTY  
 SCALE: 1/4" = 1'-0" EXCEPT AS NOTED  
 RECOMMENDED FOR APPROVAL: *[Signature]* MARCH 1, 1937  
 PROJECT: 234 STATION: 28+35  
 SECTION: D STRUCTURE NO. 9030  
 DRAWING: C2 OF 3  
 BRIDGE CONTRACT NO. 1537

DESIGNED BY: H. R. 2-9-37  
 DRAWN BY: E. R. 2-11-37  
 CHECKED BY: E. R. 3-1-37

