

LINCOLN STATE PARK

Cottage Floorplan 5, 9

Cabins 5 and 9 are not in a grouping of cabins and will sleep 6 guest. Each cabin has a picnic table, fire ring and parking for 2 vehicles. Cabin 9 is ADA accessible.

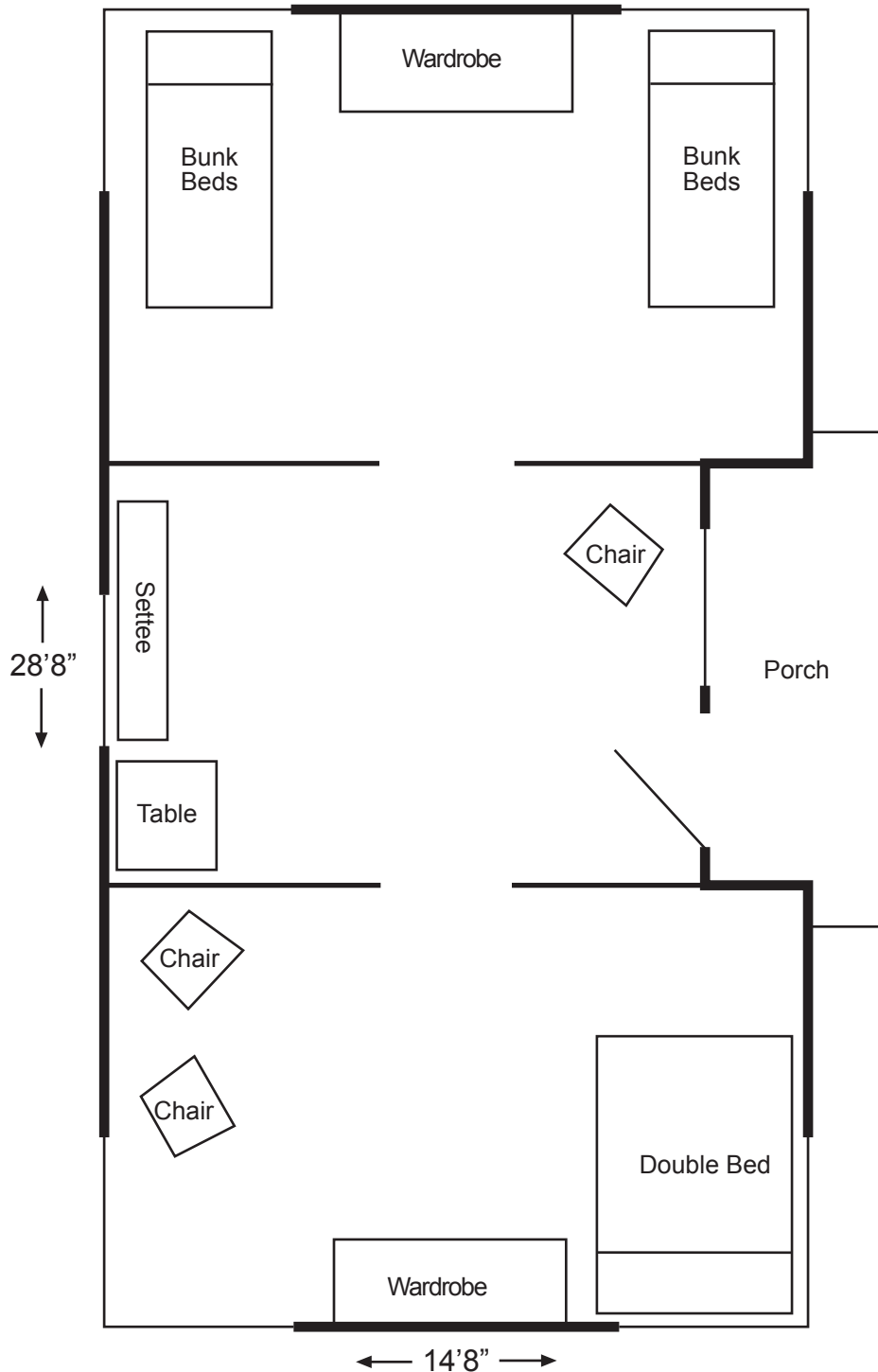

NEED ASSISTANCE DURING YOUR STAY?

Please contact the park office, gatehouse or other DNR personnel.

Park Office: (812) 937-4710

Dial 911 for all emergencies.

PARK OFFICE HOURS:

Mon.-Fri. 8:30 a.m.-4:00 p.m.

Weekend & seasonal hours vary.

CHECK IN/OUT TIMES (by local time)

Cabins Mon.-Sun. & holidays

Check-in: 4:00 p.m.

Check-out: 11:00 a.m.