

Munsee Woods Nature Preserve

County: Delaware Size: 36.324 acres
Ownership: Red-tail Land Conservancy



Location and Access

Parking and trails. From Muncie, take S Burlington Drive for 3.2 miles, turn left onto 266 S or E Inlow Springs Road, drive 1.8 miles, and continue straight onto E CR 322 S or E Windsor Road. Turn right onto S CR 475 E, go 0.5 miles, look for entrance on left.

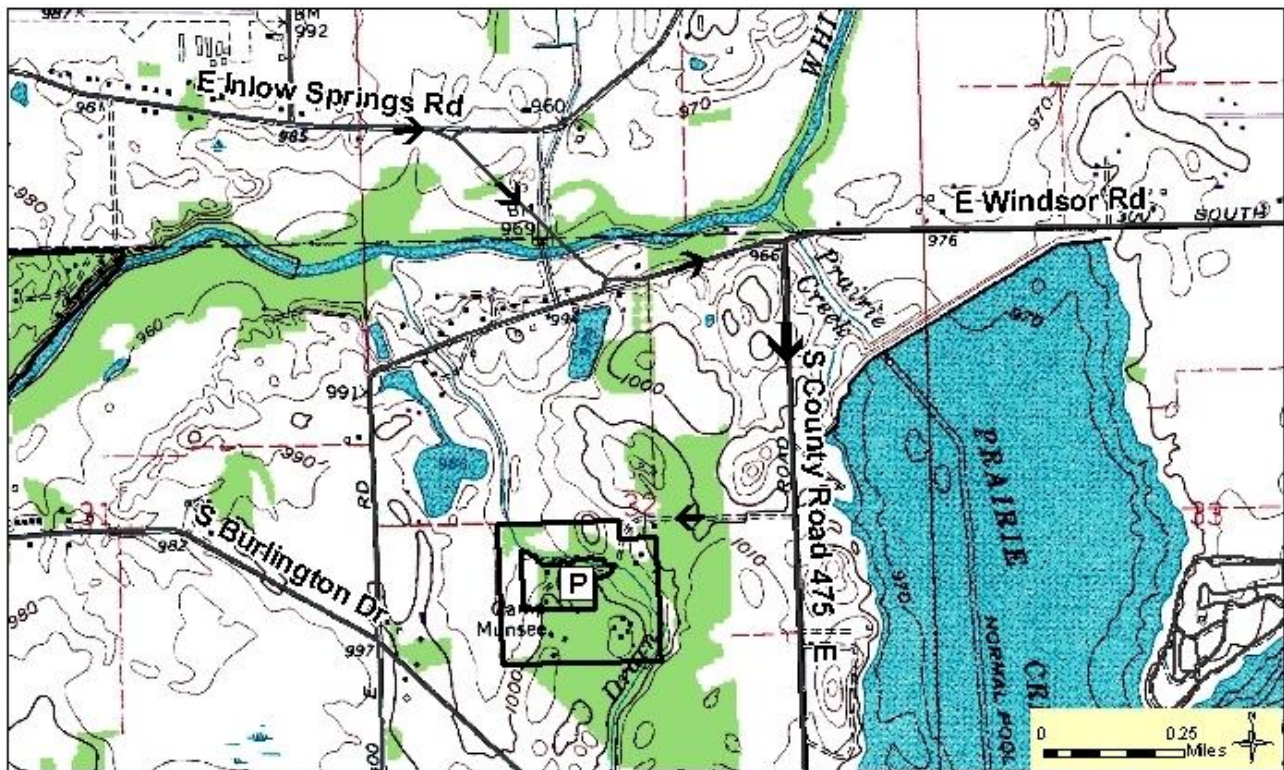

Description: This preserve occurs within a glacial meltwater valley with gentle forested uplands and spring-fed wetlands that sustain a small perennial tributary stream of the White River, West Fork. Munsee Woods was deeded to the Muncie Girls Scouts by the E. Arther Ball family in 1939. It served as a Girl Scout camp for several decades. The site has several plant communities, including old fields, successional woods, and upland mixed forests. Typical plants and wildflowers of both wetlands and uplands are found on the site. Munsee Woods NP represents an important habitat block in close proximity to both Prairie Creek reservoir and the White River.

Further information:

Division of Nature Preserves East Central Regional Ecologist, Ben Hess, BHess@dnr.in.gov