

Wing Haven Nature Preserve

County: Steuben Size: 250 acres
Ownership: ACRES Land Trust



Location and Access

Parking and trail. From north of Angola, on I-69/US 27 N, take exit 154 to SR 127S. Go a short distance to CR 400 N and turn left (east). The preserve and parking lot will be on the left (north). To visit the other 2 tracts, contact ACRES Land Trust.

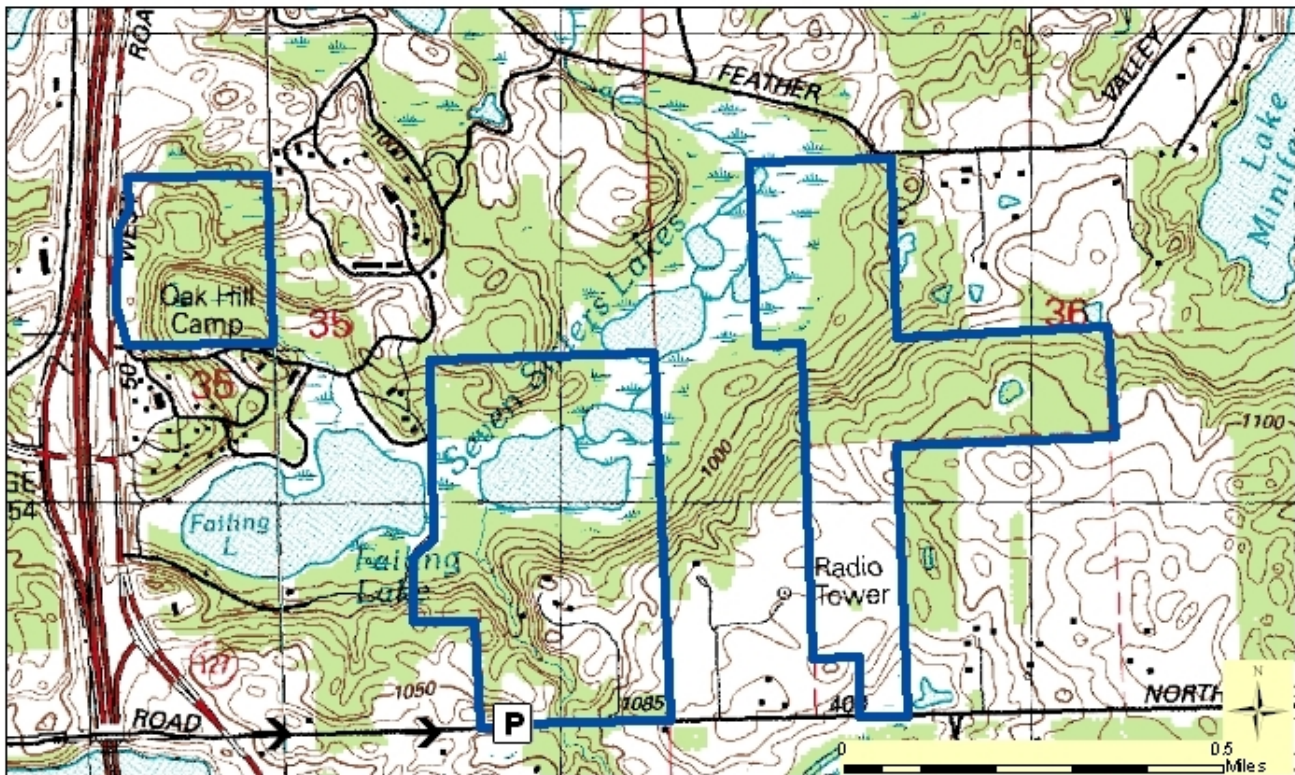

Description: A chain of beautiful small lakes, marshes, oak-hickory forests and rolling meadows make up this well-named preserve. Sandhill Crane, Marsh Wren, Red-tailed Hawk, Rose-breasted Grosbeak, Wood Thrush, and Blue-winged Warbler are some of the many birds. Of the three spring-fed lakes at the preserve, two are appropriately named Gentian and Little Gentian for the vibrant blue wildflower, the fringed gentian, which grows along the shore. This property was a gift from Helen Swensen, whose 19th century log buildings are used by the caretakers.

Further Information:

ACRES Land Trust, 1802 Chapman Rd, Hometown, IN 46748. (260) 637-2273. www.acreslandtrust.org
Division of Nature Preserves Northeast Regional Ecologist, Rich Dunbar: rdunbar@dnr.in.gov