

Fawn River Nature Preserve

County: LaGrange Size: 135 acres
Ownership: ACRES Land Trust



Location and Access:

Parking and trail. Located in NE LaGrange County, on the Michigan State Line, north of Indiana Toll Rd, I-90. From LaGrange, take US 20 east 12.5 miles to SR 327. Turn left (north), travel 8 miles through Orland, to state line/Greenfield Rd. Turn left (west), drive 3 miles to where Greenfield Rd turns north. At this junction, take the lane that continues west 800 feet to parking area on left.

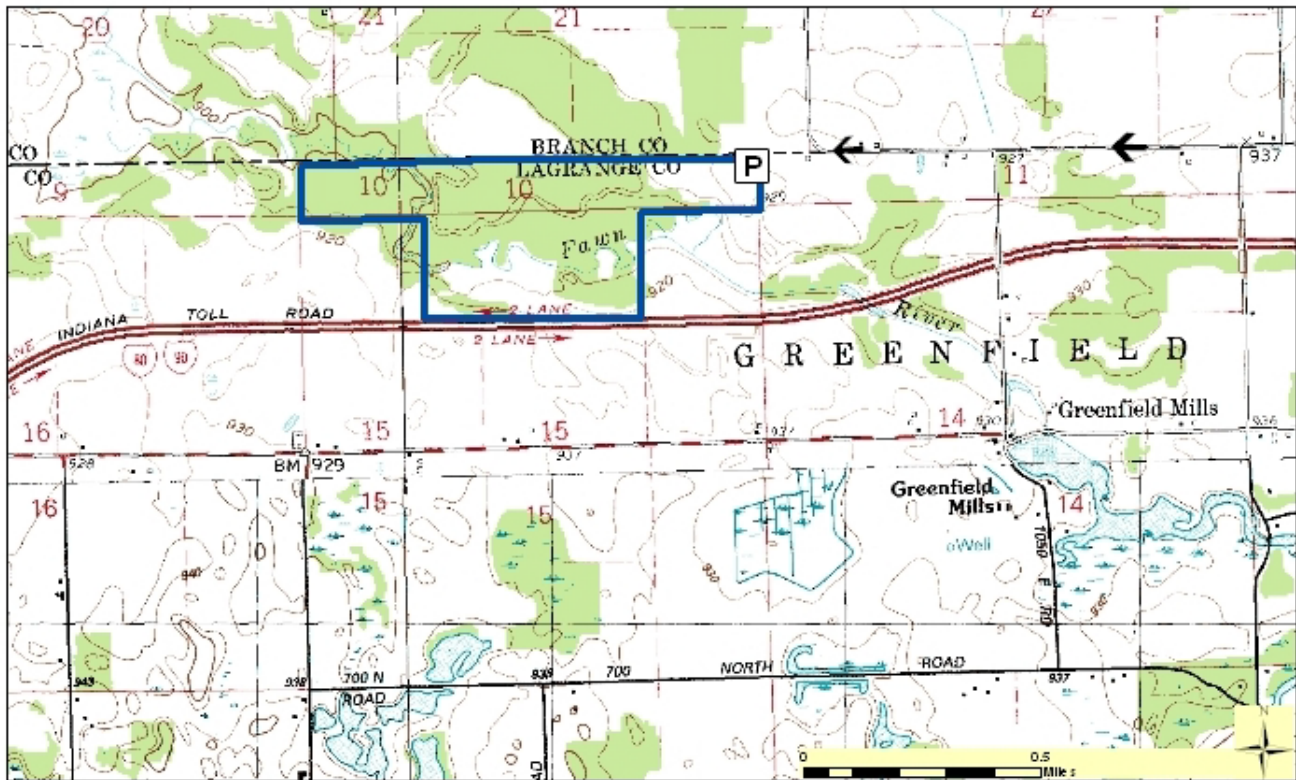

Description: The centerpiece of this preserve is the Fawn River. The Fawn River is one of Indiana's most natural rivers, and it meanders through the property. Because the soil is so sandy, it supports a type of floodplain forest not protected elsewhere in the nature preserve system. The dominant trees are oaks, including swamp white and pin oak. The lowland contains smaller areas of marsh and shrub swamp. The rolling uplands contain a diverse spring flora.

Further Information:

ACRES Land Trust, 1802 Chapman Rd, Hometown IN 46748. (260) 637-2273. www.acreslandtrust.org.
Division of Nature Preserves Northeast Regional Ecologist, Adam Balzer: abalzer@dnr.in.gov