

# Dobbs Memorial Nature Preserve (John G. Dobbs)

County: Vigo                      Size: 25 acres  
Ownership: Terre Haute City Park and Recreation Board



## Location and Access

**Parking and trails.** This preserve is located in Dobbs Park which is east of Terre Haute at the junction of SR 46 and SR 42 (Poplar St.). Trails pass through the preserve. There is a nature center in the park which offers guided tours of the preserve. Take the entrance road past the Nature Center. Park at the turn around. The trail is across from the turn around, to the north.

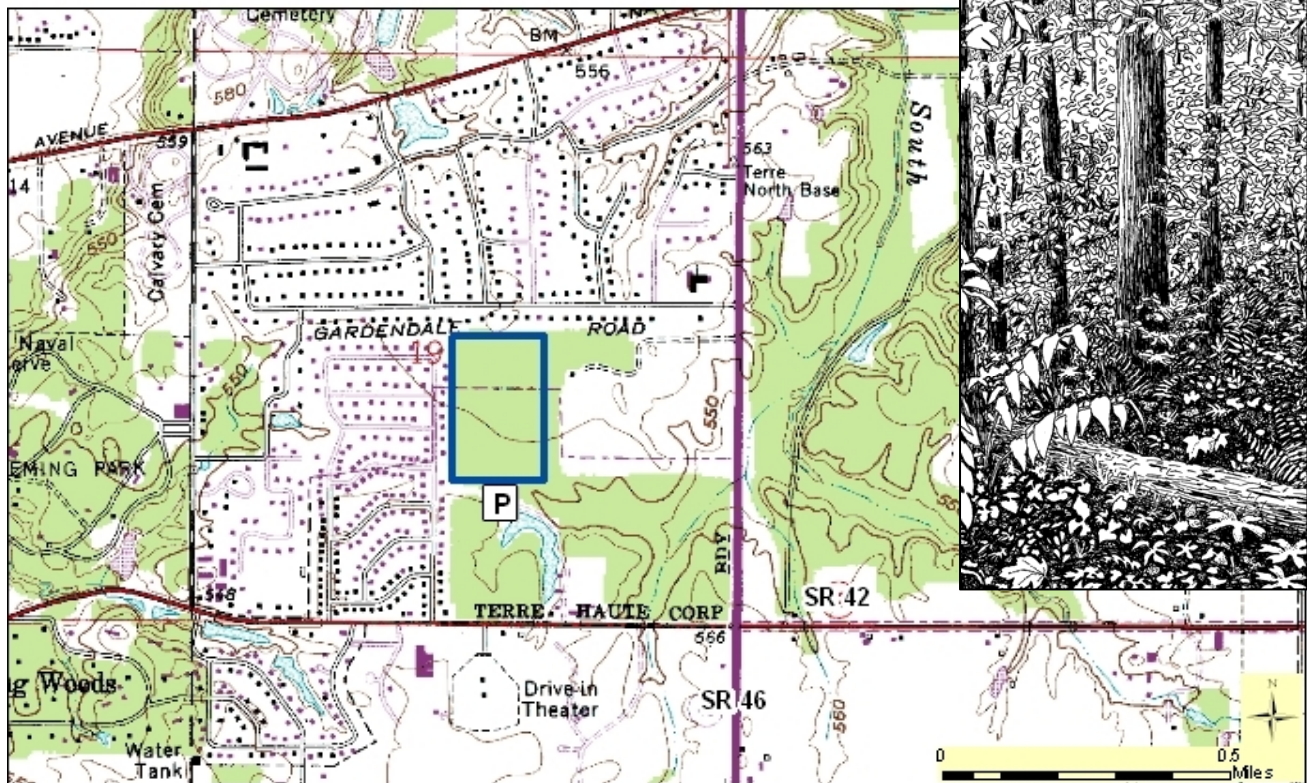

**Description:** The high species diversity within this comparatively small old second-growth woods is particularly noteworthy. Moderate changes in elevation result in great differences in species composition. In lower areas, where the soil is wet, trees such as swamp white oak and shellbark hickory can be found. On ground a few feet higher the soil is drier and beech-maple forest predominates. On still higher ground, beech-maple gives way to oak-hickory forest.

## Further Information:

Dobbs Park Nature Center, 5170 Poplar, Terre Haute, IN 47803. (812) 877-1095.  
Division of Nature Preserves Southwest Regional Ecologist, Ryan Keller: rkeller@dnr.in.gov