

INDIANA DEPARTMENT OF ADMINISTRATION (IDOA)
 INDIANA DEPARTMENT OF NATURAL RESOURCES (IDNR)

PROJECT No. ENG2201872270
 STONE LAKE PUBLIC ACCESS SITE - LOT PAVING
 CENTER TOWNSHIP, LAPORTE COUNTY, INDIANA
 SECTION 34, T-37-N, R-3-W

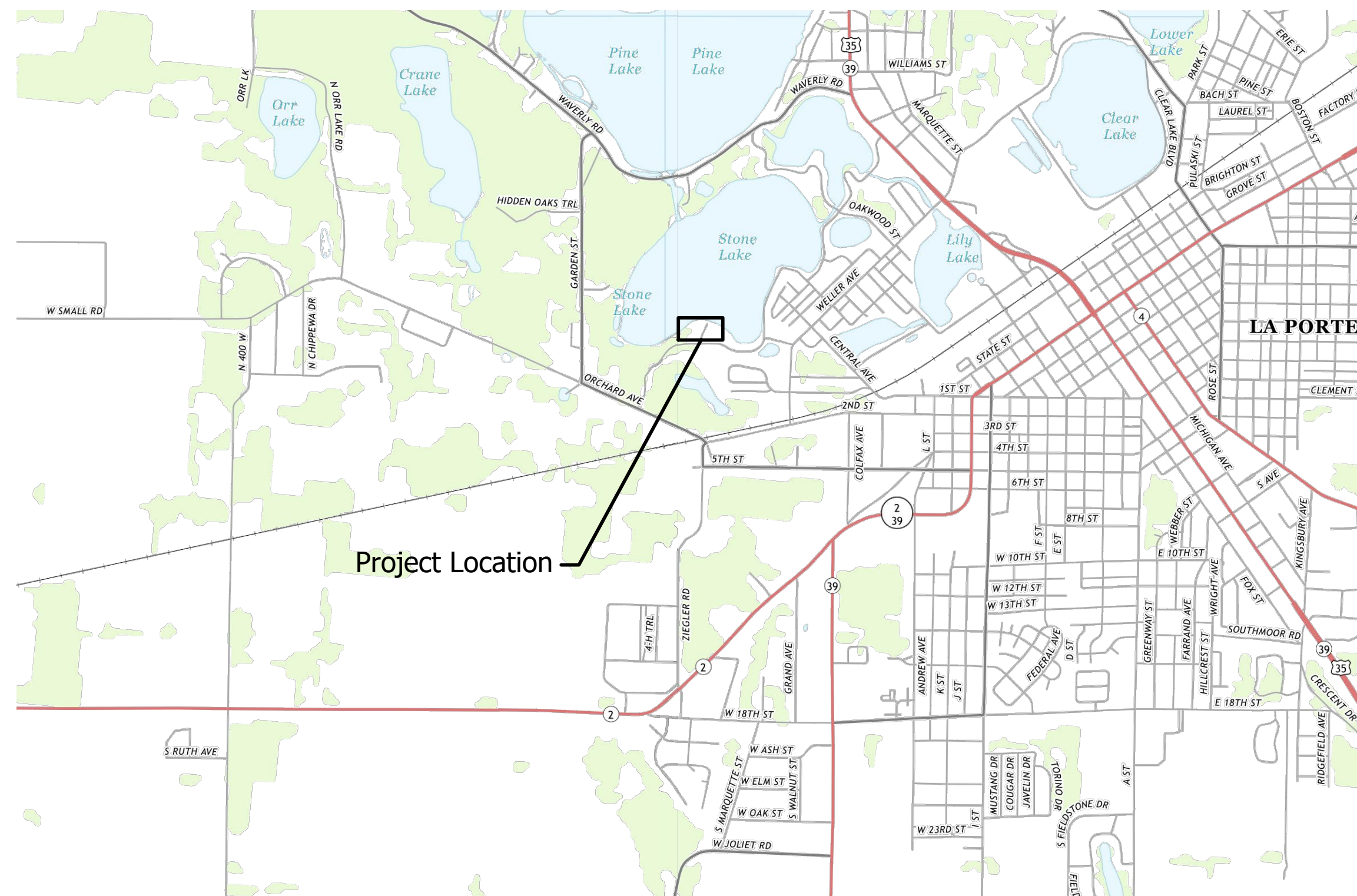

LOCATION MAP
 LAPORTE COUNTY

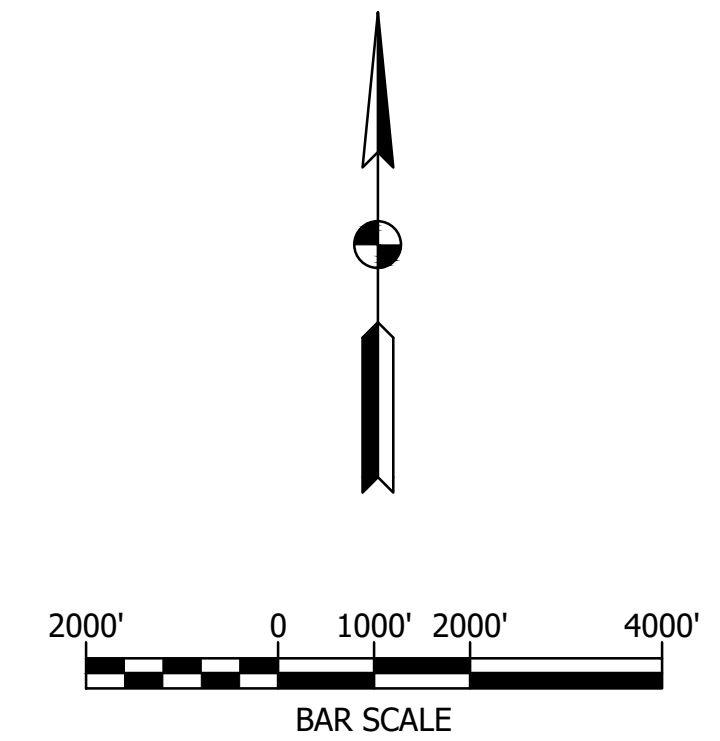

| DRAWING INDEX | |
|---------------|---|
| SHEET NO. | DESCRIPTION |
| 1 | TITLE SHEET |
| 2 | LEGEND AND GENERAL NOTES |
| 3 | EXISTING CONDITIONS PLAN AND SURVEY CONTROL |
| 4 | SITE PLAN |
| 5 | GRADING PLAN |
| 6 | EROSION CONTROL PLAN |

U:\2020\202042_10 IDNR Stone LK\Cad\Plan Set\Civil\204210TR_CS.dwg (TITLE SHEET)

LFA
 LAWSON-FISHER ASSOCIATES P.C.
 525 W. WASHINGTON AVENUE
 SOUTH BEND, INDIANA 46601
 PH. (574) 234-3167

PIPER C. TUTTLE
 No. 1970009
 STATE OF INDIANA
 PROFESSIONAL ENGINEER

Kevin J. Siedlecki
 12/17/21
 SIGNATURE DATE

Piper C. Tuttle
 12/17/21
 SIGNATURE DATE

KEVIN J. SIEDECKI
 No. 1100677
 STATE OF INDIANA
 PROFESSIONAL ENGINEER

INDIANA DEPT. OF NATURAL RESOURCES
 STONE LAKE PUBLIC ACCESS SITE
 LOT PAVING

TITLE SHEET

| |
|--------------|
| REVISIONS |
| DRAWN: JAJ |
| CHECKED: KJS |













| |
|-------------------------------|
| HORIZONTAL SCALE BAR SCALE |
| VERTICAL SCALE |
| SURVEY BOOK |
| DATE DECEMBER 2021 |

| |
|-----------------------------|
| PROJECT NUMBER 202042.10 |
| SHEETS 1 OF 6 |



U:\2020\202042_10 IDNR Stone LK\Cad\Plan Set\Civil\204210TR_IN.dwg (GENERAL NOTES AND LEGEND)

LEGEND:

SYMBOLS

-  Existing Benchmark
-  Existing Control Point
-  Existing Deciduous Tree
-  Existing Guy Anchor
-  Existing Light Pole
-  Existing Property Line
-  Existing Property Ownership Hook
-  Existing Post
-  Existing Power Pole
-  Existing Sign - Single Post
-  Existing Sign - Double Post
-  Water Surface Elevation

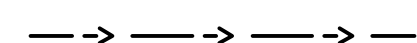
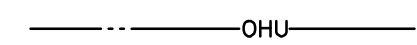
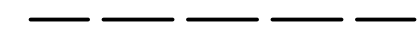
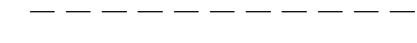
EXISTING PATTERNS

-  Existing Ditch Centerline
-  Existing Overhead Utility
-  Existing Property Line
-  Existing Top of Bank/Toe of Slope
-  Existing Vegetation Line

PUBLIC UTILITY

The existing utilities listed below and shown on these plans represent the best information available as obtained on our surveys. This information does not relieve the contractor of the responsibility to be satisfied as to its accuracy and the location of existing utilities.

| <u>OWNER</u> | <u>UTILITY</u> |
|--|----------------|
| City of LaPorte Joann Renz 2101 Boyd Blvd. LaPorte, IN 46350 | Communications |
| Nipsco Electric Phil Griffin 1039 E. Pennsylvania Ave. South Bend, IN 46601 (574) 284-2214 | Electric |
| Nipsco Gas Phil Griffin 1039 E. Pennsylvania Ave. South Bend, IN 46601 (574) 284-2214 | Gas |

GENERAL NOTES:

1. All items shown are existing unless otherwise indicated as required.
2. The contractor shall locate all underground utilities prior to starting work and shall conduct his operation in such manner as to insure that those utilities will not be disturbed.
3. Any damage to access roads, bridges, private or public property, and to existing structure not specified to be altered and caused by the contractor during construction shall be repaired at the expense of the contractor.
4. Prior to starting construction the contractor shall conduct check surveys on each aspect of the work as provided in the specifications. The results of the check surveys may affect the quantities.
5. If any errors become apparent, they shall be brought to the attention of the engineer prior to construction so that clarification or redesign may occur.
6. Contractor shall power wash all equipment upon arriving on site in order to decrease the spread of any invasive species.
7. Contractor shall not remove trees between April 1st to October 1st due to date restrictions with the endangered Indiana bat species.
8. Contractor shall seed and mulch all disturbed areas within the construction limits unless noted otherwise.
9. INDOT Standard Specification 2022 shall be used with these plans.



LFA
LAWSON-FISHER ASSOCIATES P.C.
525 W. WASHINGTON AVENUE
SOUTH BEND, INDIANA 46601
PH. (574) 234-3167



Kevin J. Siedlecki 12/17/21
SIGNATURE DATE

Blake Warner 12/17/21
SIGNATURE DATE



INDIANA DEPT. OF NATURAL RESOURCES
STONE LAKE PUBLIC ACCESS SITE
LOT PAVING

LEGEND AND GENERAL NOTES

| | | |
|--------------|------------------|----------------|
| REVISIONS | HORIZONTAL SCALE | PROJECT NUMBER |
| | VERTICAL SCALE | 202042.10 |
| DRAWN: JAJ | SURVEY BOOK | SHEETS |
| CHECKED: KJS | DATE | 2 OF 6 |
| | DECEMBER 2021 | |

BRW - 12/17/2021 3:21 PM - U:\2020\202042_10 IDNR Stone LK\Cad\Plan Set\Civil\204210TR_SPO1.dwg (204210TR_SPO1 - EXISTING CONDITIONS PLAN)

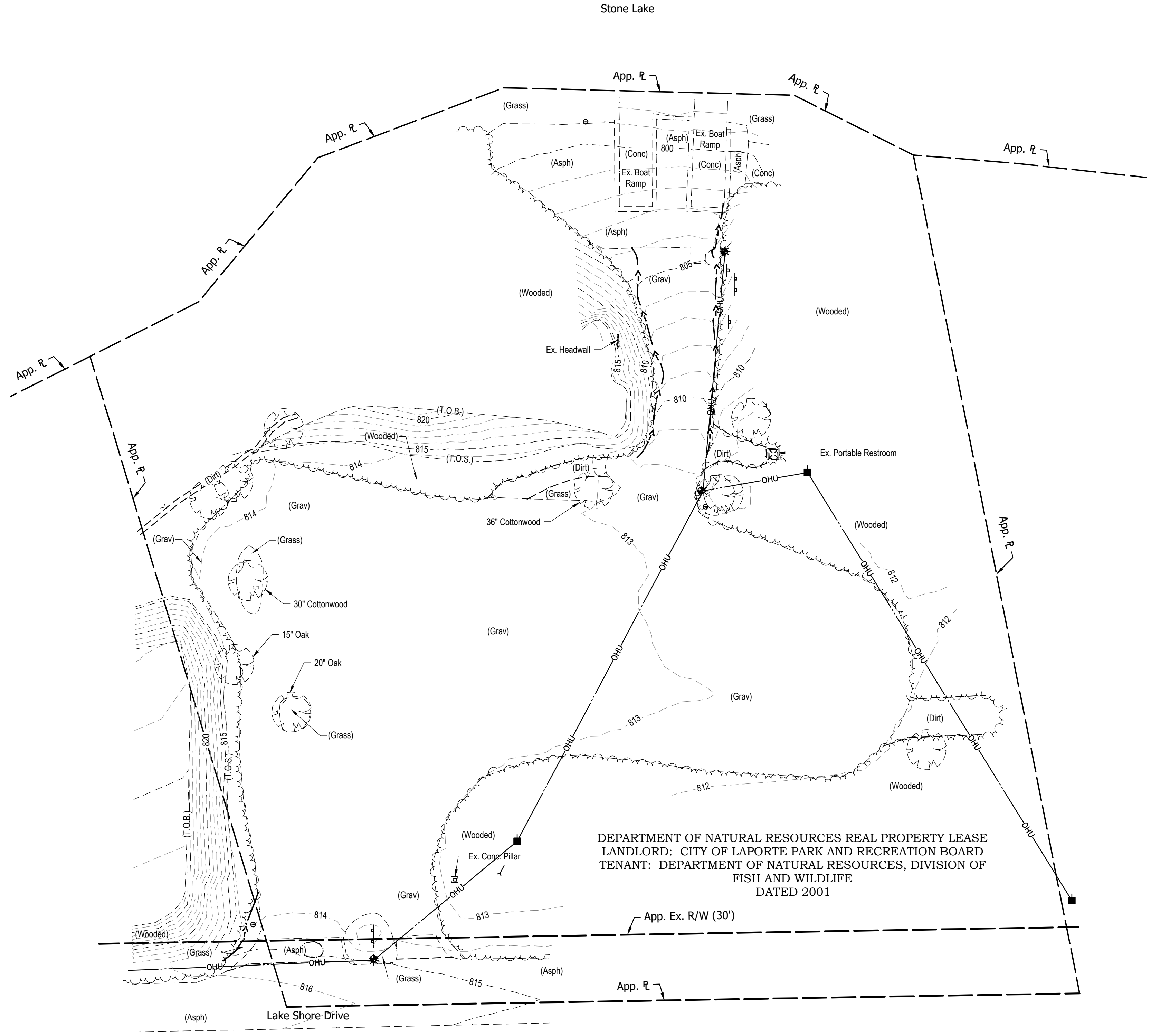

SURVEY NOTES:

1. Unless noted otherwise, all bearings, distances, areas, and coordinates shown hereon are based upon the Indiana State Plane Coordinate System's West Zone (InSPC-1302) per NAD 83 (2011) Epoch 2010.00 and are reported in U.S. Survey Feet and decimal parts thereof.
2. Unless noted otherwise, all elevations shown hereon are based upon the North American Vertical Datum of 1988 (NAVD 88) as established on National Geodetic Survey (NGS) Mark Q 152 (PID ME0905), elevation 817.000 (NAVD 88).
3. The project is located in Section 34, T37N R3W (Center Twp.), LaPorte County, State of Indiana
4. The horizontal datum was verified by Global Navigation Satellite Systems (GNSS) Real Time Kinematic (RTK) observations on NGS mark PPO A (PID DM4010). The Trimble Virtual Reference Station Network (VRS) was used as the correction source. The vertical datum was verified by GNSS (RTK) observations on NGS mark Q 152 (PID ME0905), elevation 817.000 (NAVD 88).
5. The location of underground utilities was facilitated by Indiana 811 under the following ticket number 2106222589. All utilities were marked clear at the site and no appurtenances of underground utilities were found at the time of survey.
6. The irons or spikes called for in the lease description and the 1985 survey were not recovered. The property line was placed using the south line and corners of the section.

HORIZONTAL CONTROL (INSPC - EAST ZONE // U.S. FEET)

| ID | Northing | Easting | Latitude | Longitude | Elevation (NAVD 88) | Marker |
|-------|--------------|--------------|------------------|------------------|---------------------|---|
| CP 1 | 2317151.4525 | 3044321.9520 | N41°36'33.16676" | W86°44'54.52147" | 813.89 | 1/2x18" Rebar w/ Blue Cap Stamped 'LAWSON-FISHER' |
| CP 2 | 2317340.4271 | 3044526.5494 | N41°36'35.02592" | W86°44'51.81847" | 812.63 | 1/2x18" Rebar w/ Blue Cap Stamped 'LAWSON-FISHER' |
| CP 3 | 2317514.6004 | 3044472.3950 | N41°36'36.74879" | W86°44'52.52245" | 799.32 | 1/2x18" Rebar w/ Blue Cap Stamped 'LAWSON-FISHER' |
| BALL1 | 2316812.5928 | 3044281.9273 | N41°36'29.82045" | W86°44'55.06567" | N/A | 1/2x18" Rebar w/ Blue Cap Stamped 'LAWSON-FISHER' |
| BALL2 | 2317083.6103 | 3044670.6870 | N41°36'32.48310" | W86°44'49.93419" | 808.34 | 1/2x18" Rebar w/ Blue Cap Stamped 'LAWSON-FISHER' |

Control point elevations are provided for reference. It should be understood that the markers used are subject to vertical movement due to frost heave, vehicle movements and other environmental factors. All horizontal control point elevations are superseded by bench mark elevations.

VERTICAL CONTROL (NAVD 88)

| ID | Elevation | Remarks | Northing | Easting | Latitude | Longitude |
|-------|-----------|---|-----------|-----------|---------------|---------------|
| TBM A | 816.06 | Cotton Gin Gear; N. Face LT. P. (565/137); 1.45' Above Grnd. Lvl. | 2317136.0 | 3044376.5 | N41°36'33.01" | W86°44'53.80" |
| TBM B | 813.82 | Cotton Gin Gear; W. Face LT. P. (No Id.); 1.15' Above Grnd. Lvl. | 2317347.7 | 3044524.6 | N41°36'35.10" | W86°44'51.84" |
| TBM C | 806.87 | Cotton Gin Gear; W. Face LT. P. (565/138); 1.4' Above Grnd. Lvl. | 2317456.0 | 3044535.0 | N41°36'36.17" | W86°44'51.70" |

Bench mark horizontal coordinates are provided for reference. It should be understood that the method and means used to establish the horizontal coordinates of the bench marks is not the same class and standard as those used to establish the horizontal control points. The coordinates only serve as an aid in locating the marks and are superseded by horizontal control point coordinates.

LFA
LAWSON-FISHER ASSOCIATES P.C.
525 W. WASHINGTON AVENUE
SOUTH BEND, INDIANA 46601
PH. (574) 234-3167

BLAKE WARNER
REGISTERED PROFESSIONAL ENGINEER
No. 12100459
STATE OF INDIANA

Kevin J. Siedlecki
12/17/21
SIGNATURE DATE

Blake Warner
12/17/21
SIGNATURE DATE

KEVIN J. SIEDECKI
REGISTERED PROFESSIONAL ENGINEER
No. 1100677
STATE OF INDIANA

INDIANA DEPT. OF NATURAL RESOURCES
STONE LAKE PUBLIC ACCESS SITE
LOT PAVING

EXISTING CONDITIONS PLAN
AND SURVEY CONTROL

| | | |
|--------------|------------------|----------------|
| REVISIONS | HORIZONTAL SCALE | PROJECT NUMBER |
| | VERTICAL SCALE | 202042.10 |
| DRAWN: JAJ | SURVEY BOOK | SHEETS |
| CHECKED: KJS | DATE | 3 OF 6 |
| | DECEMBER 2021 | |

BRW - 12/17/2021 3:22 PM - U:\2020\202042_10_IDNR Stone LK\Cad\Plan Set\Civil\204210TR_SP02.dwg (204210TR_SP02 - SITE PLAN)

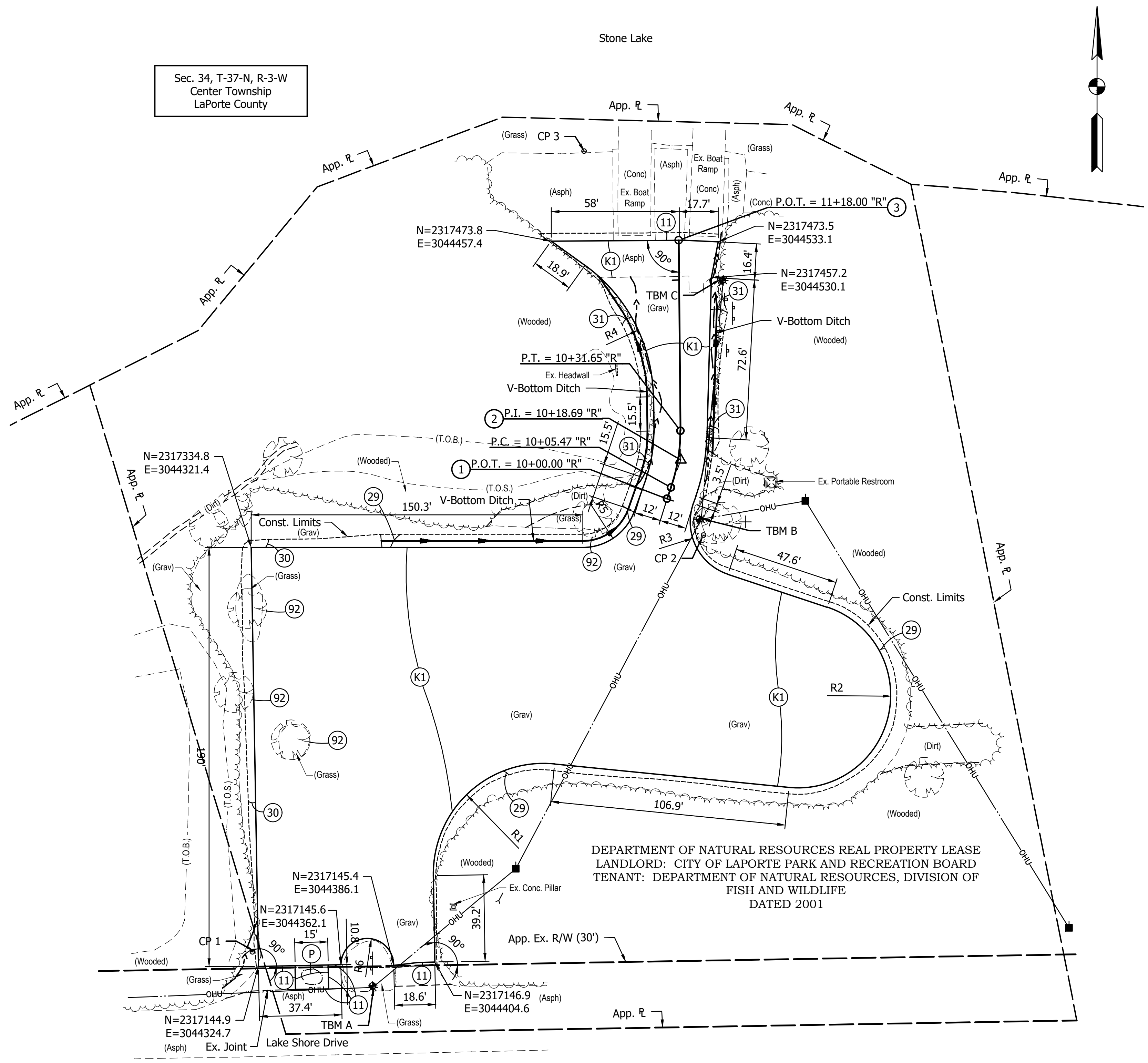

Sec. 34, T-37-N, R-3-W
Center Township
LaPorte County

| | NORTHING | EASTING |
|------|-------------|-------------|
| Pt 1 | 2317356.937 | 3044509.938 |
| Pt 2 | 2317362.092 | 3044511.760 |
| Pt 3 | 2317387.785 | 3044516.042 |

| | NORTHING | EASTING | RADIUS |
|----|------------|------------|--------|
| R1 | 2317175.16 | 304447.49 | 50' |
| R2 | 2317267.80 | 3044569.42 | 42' |
| R3 | 2317346.92 | 3044537.63 | 25' |
| R4 | 2317401.44 | 3044427.13 | 75' |
| R5 | 2317367.77 | 3044472.91 | 25' |
| R6 | 2317145.47 | 3044374.05 | 12' |

LEGEND:

- (K1) HMA Parking Lot Pavement, Type B
165 #/sys HMA, Type "B", Surface on
275 #/sys HMA, Type "B", Intermediate on
4-6" Compacted Aggregate, No. 53 on
Subgrade Treatment, Type III
- (P) HMA Patching (Match Thickness of Existing
Pavement)
- (11) Sawcut
- (29) Mulched Seeding, Type R
- (30) Cobblestone Trench
- (31) Revetment Riprap
- (92) Remove Tree

NOTE:

- Contractor shall be responsible for securing a right-of-way excavation permit from the City of La Porte prior to performing the pavement patch on the western driveway entrance in the City's right-of-way.

LFA
LAWSON-FISHER ASSOCIATES P.C.
525 W. WASHINGTON AVENUE
SOUTH BEND, INDIANA 46601
PH. (574) 234-3167

BLAKE WARNER
REGISTERED PROFESSIONAL ENGINEER
No. 12100459
STATE OF INDIANA

Kevin J. Siedlecki
SIGNATURE DATE 12/17/21

Blake Warner
SIGNATURE DATE 12/17/21

KEVIN J. SIEDECKI
REGISTERED PROFESSIONAL ENGINEER
No. 1100677
STATE OF INDIANA

INDIANA DEPT. OF NATURAL RESOURCES
STONE LAKE PUBLIC ACCESS SITE
LOT PAVING

SITE PLAN

| | | |
|--------------|------------------------------|------------------------------------|
| REVISIONS | HORIZONTAL SCALE 1" = 30' | PROJECT NUMBER 202042.10 |
| DRAWN: JAJ | SURVEY BOOK | SHEETS 4 OF 6 |
| CHECKED: KJS | DATE DECEMBER 2021 | |

BRW - 12/17/2021 3:22 PM - U:\2020\202042_10 IDNR Stone LK\Cad\Plan Set\Civil\204210TR_GP.dwg (204210TR_GP - GRADING PLAN)

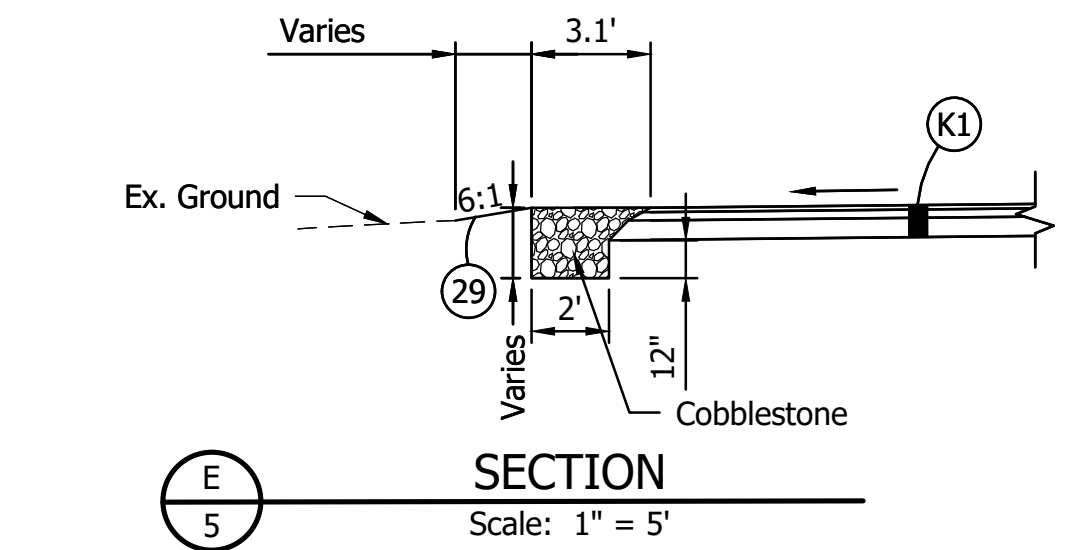
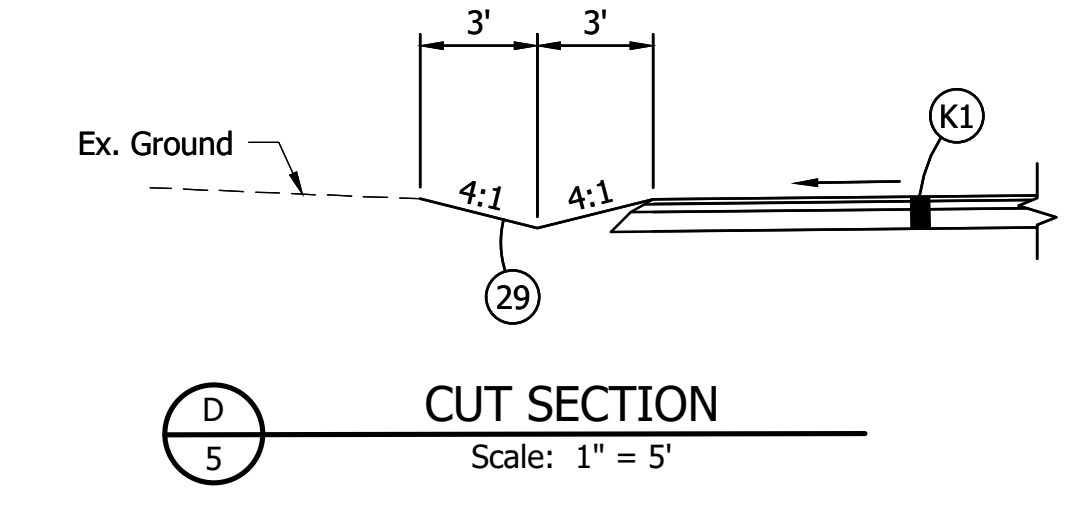
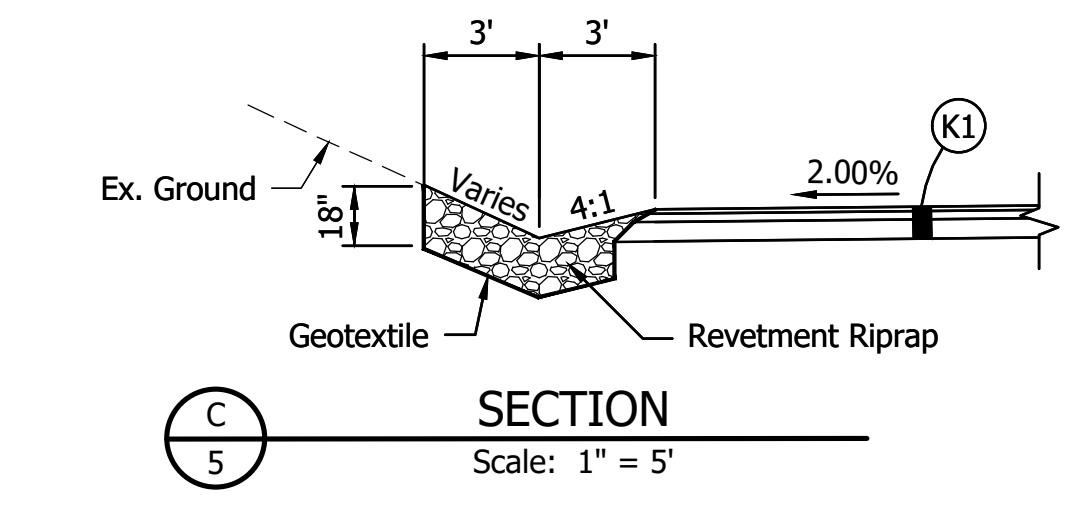
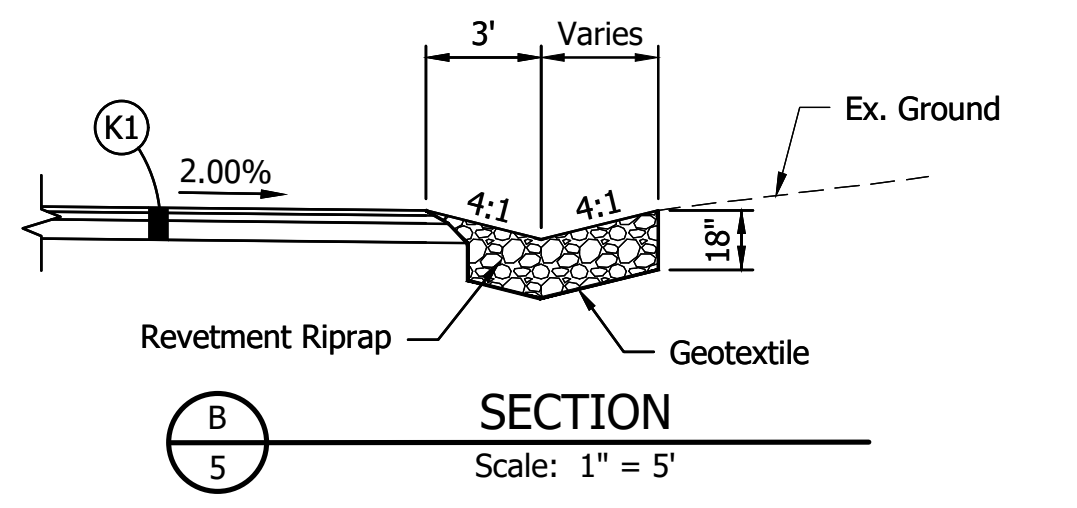
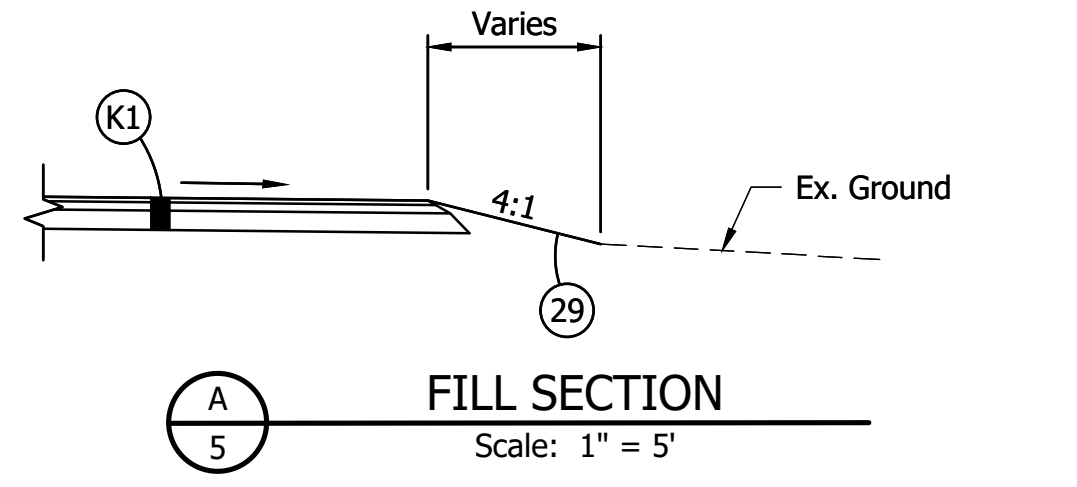
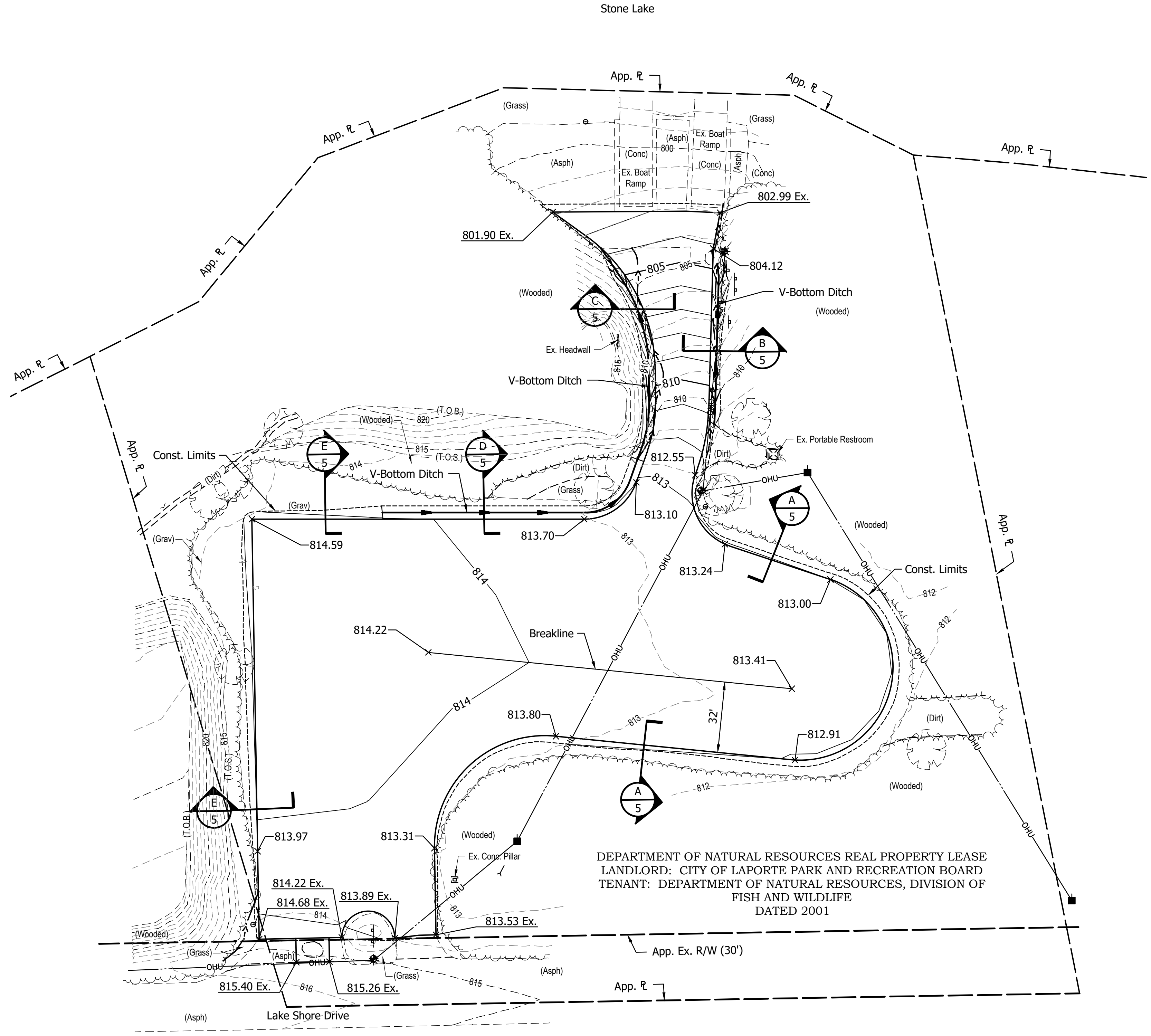

EARTHWORK BALANCE

| | |
|-----------|----------|
| Site | |
| Cut | = 27 cys |
| Fill +25% | = 25 cys |
| Waste | = 2 cys |

For information only. Contractor to confirm quantities.

- LEGEND:**
- (K1) HMA Parking Lot Pavement, Type B
165 #/sys HMA, Type "B", Surface on
275 #/sys HMA, Type "B", Intermediate on
4-6" Compacted Aggregate, No. 53 on
Subgrade Treatment, Type III
 - (29) Mulched Seeding, Type R
 - 700 — Proposed Contour
 - - 700 - - Existing Contour
 - √ 700 Proposed Spot Elevation
 - √ 700 Ex. Existing Spot Elevation

LFA
 LAWSON-FISHER ASSOCIATES P.C.
 525 W. WASHINGTON AVENUE
 SOUTH BEND, INDIANA 46601
 PH. (574) 234-3167

BLAKE WARNER
 REGISTERED PROFESSIONAL ENGINEER
 No. 12100459
 STATE OF INDIANA

Kevin J. Siedlecki
 12/17/21
 SIGNATURE DATE

Blake Warner
 12/17/21
 SIGNATURE DATE

KEVIN J. SIEDECKI
 REGISTERED PROFESSIONAL ENGINEER
 No. 1100677
 STATE OF INDIANA

INDIANA DEPT. OF NATURAL RESOURCES
 STONE LAKE PUBLIC ACCESS SITE
 LOT PAVING

GRADING PLAN

| | | |
|--------------|----------------------------|-----------------------------|
| REVISIONS | HORIZONTAL SCALE 1"=30' | PROJECT NUMBER 202042.10 |
| | VERTICAL SCALE | |
| DRAWN: JAJ | SURVEY BOOK | SHEETS |
| CHECKED: KJS | DATE DECEMBER 2021 | 5 OF 6 |

BRW - 12/17/2021 3:23 PM - U:\2020\202042_10 IDNR Stone LK\Cad\Plan Set\Civil\204210TR_EC01.dwg (EROSION CONTROL PLAN)

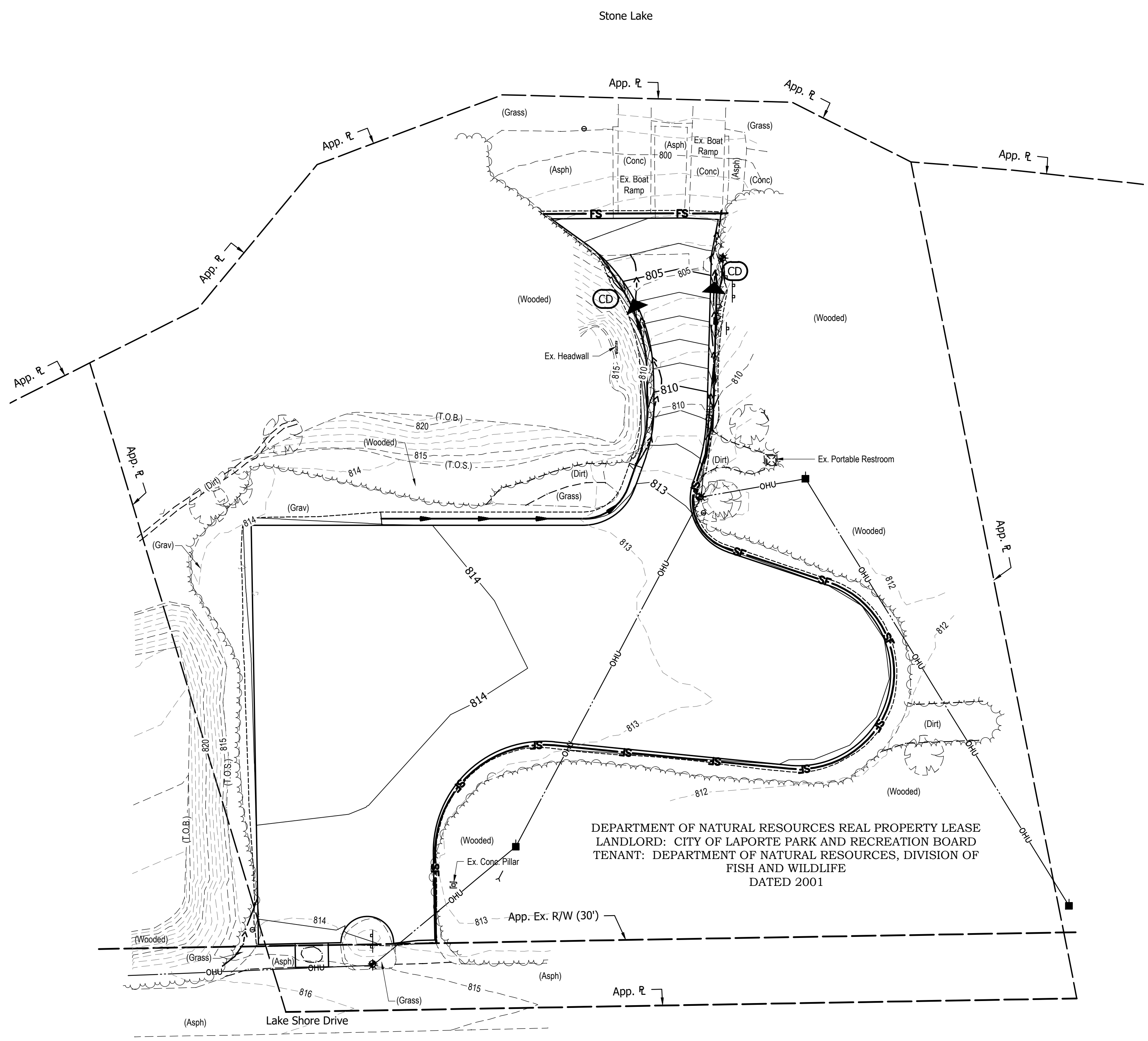

NOTES:

1. All erosion and sediment control devices are to be checked, maintained, and replaced when needed throughout the entire construction process.
2. The Contractor shall provide a stable construction entrance at the points where construction traffic will drive onto an existing roadway and at concrete washout pit/structures. These entrances will serve the purpose of preventing soil and concrete from leaving the construction area. The final location of the construction entrances/exists shall be determined by the Contractor.
3. Temporary perimeter silt fences or filter socks shall be placed throughout the project to serve as an erosion and sediment control protection measure for any runoff associated with sheet flow that has the potential of leaving the project site or entering the Waters of the U.S.

LEGEND:

- Temporary Check Dam
- Temporary Filter Sock
- Temporary Silt Fence

LFA
LAWSON-FISHER ASSOCIATES P.C.
525 W. WASHINGTON AVENUE
SOUTH BEND, INDIANA 46601
PH. (574) 234-3167

BLAKE WARNER
REGISTERED PROFESSIONAL ENGINEER
No. 12100459
STATE OF INDIANA

Kevin J. Stilleck
SIGNATURE DATE 12/17/21
Blake Warner
SIGNATURE DATE 12/17/21

KEVIN J. STILLECK
REGISTERED PROFESSIONAL ENGINEER
No. 1100677
STATE OF INDIANA

INDIANA DEPT. OF NATURAL RESOURCES
STONE LAKE PUBLIC ACCESS SITE
LOT PAVING
EROSION CONTROL PLAN

| | | |
|--------------|------------------------------|-----------------------------|
| REVISIONS | HORIZONTAL SCALE 1" = 30' | PROJECT NUMBER 202042.10 |
| DRAWN: JAJ | SURVEY BOOK | SHEETS |
| CHECKED: KJS | DATE DECEMBER 2021 | 6 OF 6 |