

OFFICE EXTERIOR RENOVATIONS
INDIANA DEPARTMENT OF NATURAL RESOURCES
JASPER PULASKI FORESTRY NURSERY
PROJECT NO. ENG2509662251

DRAWINGS INDEX

A-1 DRAWINGS INDEX, LOCATION MAP, FLOOR PLAN
A-2 ELEVATIONS

PROJECT INFORMATION

BUILDING ADDRESS: JASPER-PULASKI NURSERY
15508 West 700 North
Medaryville, IN 47957
Phone: 219-843-4827

COUNTY: PULASKI
BUILDING AREA TO BE REMODELED: N/A
SPRINKLER: N/A
OCCUPANCY: NO CHANGE TO EXISTING
CONSTRUCTION TYPE: NO CHANGE TO EXISTING

BUILDING CODE

BUILDING CODE EDITION: 2014 INDIANA BUILDING CODE (2012 IBC)
MECHANICAL CODE EDITION: 2014 INDIANA MECHANICAL CODE (2012 IMC)
ELECTRICAL CODE EDITION: 2009 INDIANA ELECTRICAL CODE (NFPA 70-2008)
FIRE PREVENTION CODE: 2014 INDIANA FIRE CODE (2012 IFC)
PLUMBING CODE EDITION: 2012 IPC W/ INDIANA AMMENDMENTS
ACCESSIBILITY CODE: 2014 INDIANA ACCESSIBILITY CODE
ENERGY CODE: INDIANA ENERGY CONSERVATION CODE
ANSI/ASHRAE 90.1 (2007)

SCOPE OF WORK

REMODEL OF EXISTING OFFICE BUILDING TO INCLUDE NEW SIDING, WINDOWS, AND DOORS.
NO ALTERATIONS TO EXISTING BUILDING OCCUPANCY

DESIGNERS OF RECORD

ARCHITECTURAL: STATE OF INDIANA
DEPARTMENT OF NATURAL RESOURCES
MECHANICAL: DIVISION OF FACILITIES, FLEET,
ELECTRICAL: ASSET MANAGEMENT, AND ENGINEERING
PLUMBING: ROOM 402 INDIANA GOVERNMENT CENTER SOUTH
INDIANAPOLIS, INDIANA 46204

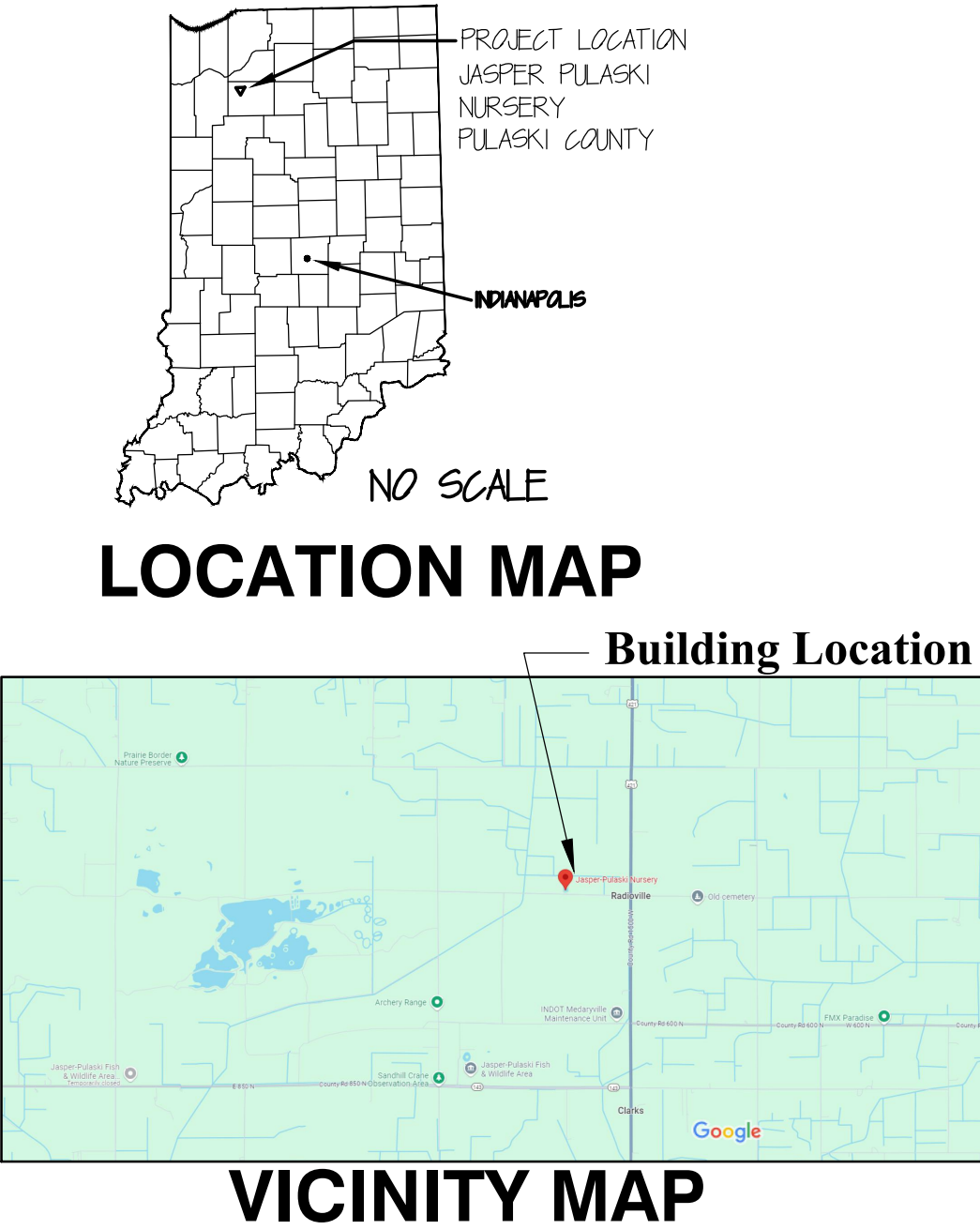

BUILDING FRONT - NORTH SIDE



DOOR EXAMPLE



NORTH WEST CORNER



SOUTH EAST CORNER

WINDOW SPECIFICATIONS

- NEW CONSTRUCTION. INSTALL PER MANUFACTURER'S STANDARDS INCLUDING ALL FLASHINGS FOR WEATHERTIGHT AND WARRANTIED INSTALLATION.
- STYLE: DOUBLE HUNG
- MATERIAL: VINYL
- COLOR: WHITE EXTERIOR. INTERIOR CASING TO MATCH EXISTING
- GLAZING: LOW-E GLASS W/ ARGON GAS
- SCREENS: FULL SCREENS
- PRODUCT: ATRIUM 450 SERIES - DOUBLE HUNG OR APPROVED EQUAL
- SIZE TO MATCH EXISTING
- REPAIR INTERIOR TRIM AS NEEDED FOR COMPLETE INSTALLATION

DOOR SPECIFICATIONS

- INSTALL PER MANUFACTURER'S STANDARDS INCLUDING ALL FLASHINGS FOR WEATHERTIGHT AND WARRANTIED INSTALLATION.
- STYLE: 9 LITE AT (3) FRONT LOCATIONS SHOWN ON PLAN
FLUSH DOOR AT (1) SOUTH SIDE LOCATION AS SHOWN ON PLAN.
- MATERIAL: STEEL
- POLYURETHANE CORE, ENERGY STAR QUALIFIED
- COLOR: OWNER TO CHOOSE FROM MANUFACTURER'S STANDARD COLORS.
- GLAZING: TRIPLE PANE GLASS
- SIZE AND SWING TO MATCH EXISTING
- PRODUCT: MASONITE OR APPROVED EQUAL
- LOCKSET BY OWNER
- SIZE AND SWING TO MATCH EXISTING
- REPAIR INTERIOR TRIM AS NEEDED FOR COMPLETE INSTALLATION

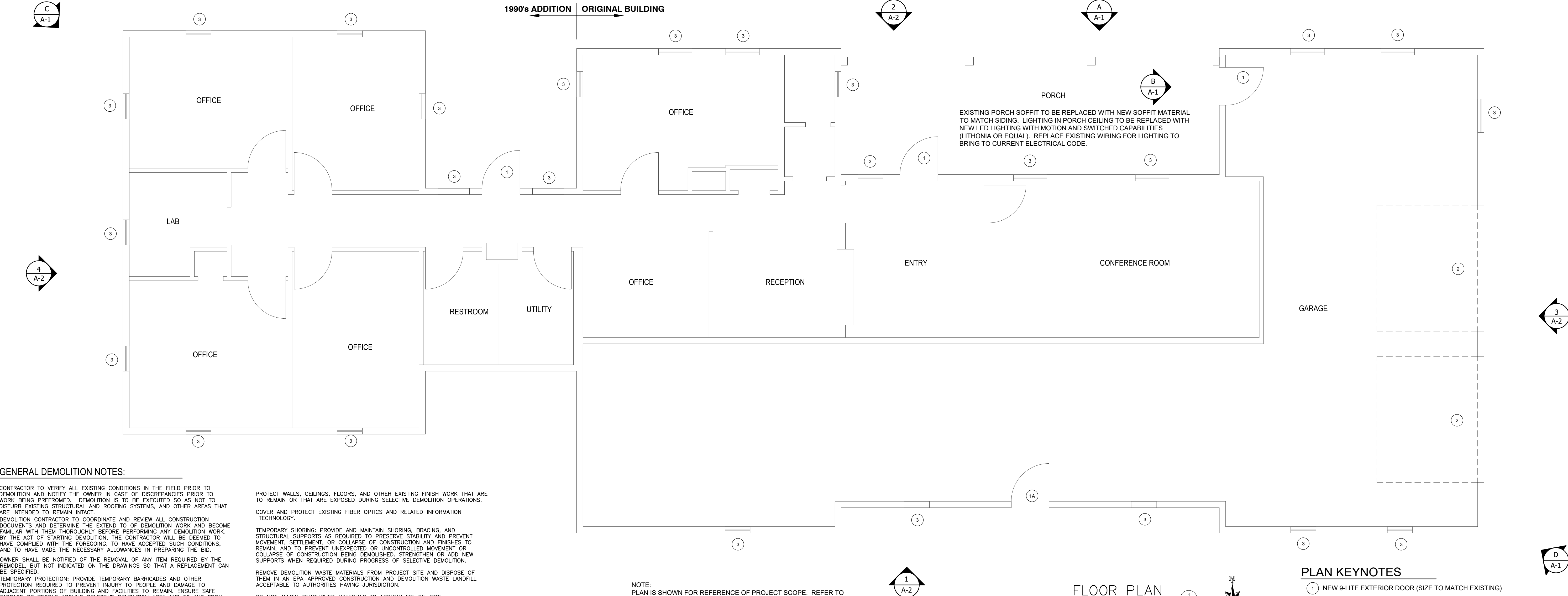

GENERAL DEMOLITION NOTES:

CONTRACTOR TO VERIFY ALL EXISTING CONDITIONS IN THE FIELD PRIOR TO DEMOLITION AND NOTIFY THE OWNER IN CASE OF DISCREPANCIES PRIOR TO WORK BEING PERFORMED. DEMOLITION IS TO BE EXECUTED SO AS NOT TO DISTURB EXISTING STRUCTURAL AND ROOFING SYSTEMS, AND OTHER AREAS THAT ARE INTENDED TO REMAIN INTACT.

DEMOLITION CONTRACTOR TO COORDINATE AND REVIEW ALL CONSTRUCTION DOCUMENTS AND DETERMINE THE EXTEND OF DEMOLITION WORK AND BECOME FAMILIAR WITH THEM THOROUGHLY BEFORE PERFORMING ANY DEMOLITION WORK. BY THE ACT OF STARTING DEMOLITION, THE CONTRACTOR WILL BE DEEMED TO HAVE COMPLIED WITH THE FOREGOING, TO HAVE ACCEPTED SUCH CONDITIONS, AND TO HAVE MADE THE NECESSARY ALLOWANCES IN PREPARING THE BID.

OWNER SHALL BE NOTIFIED OF THE REMOVAL OF ANY ITEM REQUIRED BY THE REMODEL, BUT NOT INDICATED ON THE DRAWINGS SO THAT A REPLACEMENT CAN BE SPECIFIED.

TEMPORARY PROTECTION: PROVIDE TEMPORARY BARRICADES AND OTHER PROTECTION REQUIRED TO PREVENT INJURY TO PEOPLE AND DAMAGE TO ADJACENT PORTIONS OF BUILDING AND FACILITIES TO REMAIN. ENSURE SAFE PASSAGE OF PEOPLE AROUND SELECTIVE DEMOLITION AREA AND TO AND FROM THE BUILDING.

PROTECT WALLS, CEILINGS, FLOORS, AND OTHER EXISTING FINISH WORK THAT ARE TO REMAIN OR THAT ARE EXPOSED DURING SELECTIVE DEMOLITION OPERATIONS.

TEMPORARY PROTECTION: PROVIDE TEMPORARY BARRICADES AND OTHER PROTECTION REQUIRED TO PREVENT INJURY TO PEOPLE AND DAMAGE TO ADJACENT PORTIONS OF BUILDING AND FACILITIES TO REMAIN. ENSURE SAFE PASSAGE OF PEOPLE AROUND SELECTIVE DEMOLITION AREA AND TO AND FROM THE BUILDING.

PROTECT WALLS, CEILINGS, FLOORS, AND OTHER EXISTING FINISH WORK THAT ARE TO REMAIN OR THAT ARE EXPOSED DURING SELECTIVE DEMOLITION OPERATIONS.

COVER AND PROTECT EXISTING FIBER OPTICS AND RELATED INFORMATION TECHNOLOGY.

TEMPORARY SHORING: PROVIDE AND MAINTAIN SHORING, BRACING, AND STRUCTURAL SUPPORTS AS REQUIRED TO PRESERVE STABILITY AND PREVENT MOVEMENT, SETTLEMENT, OR COLLAPSE OF CONSTRUCTION AND FINISHES TO REMAIN, AND TO PREVENT UNEXPECTED OR UNCONTROLLED MOVEMENT OR COLLAPSE OF CONSTRUCTION BEING DEMOLISHED. STRENGTHEN OR ADD NEW SUPPORTS WHEN REQUIRED DURING PROGRESS OF SELECTIVE DEMOLITION.

REMOVE DEMOLITION WASTE MATERIALS FROM PROJECT SITE AND DISPOSE OF THEM IN AN EPA-APPROVED CONSTRUCTION AND DEMOLITION WASTE LANDFILL ACCEPTABLE TO AUTHORITIES HAVING JURISDICTION.

DO NOT ALLOW DEMOLISHED MATERIALS TO ACCUMULATE ON-SITE.

REMOVE AND TRANSPORT DEBRIS IN A MANNER THAT WILL PREVENT SPILLAGE ON ADJACENT SURFACES AND AREAS.

BURNING: DO NOT BURN DEMOLISHED MATERIALS.

CLEAN ADJACENT AREAS OF DUST, DIRT, AND DEBRIS CAUSED BY SELECTIVE DEMOLITION OPERATIONS. RETURN ADJACENT AREAS TO CONDITION EXISTING BEFORE SELECTIVE DEMOLITION OPERATIONS BEGAN.

NOTE:
PLAN IS SHOWN FOR REFERENCE OF PROJECT SCOPE. REFER TO ELEVATIONS FOR MORE INFORMATION INCLUDING WINDOWS NOT SHOWN ON THIS PLAN. PLAN IS NOT TO BE USED FOR SIDING QUANTITIES. CONTRACTOR IS RESPONSIBLE FOR ALL FIELD VERIFICATION OF PROJECT QUANTITIES.

FLOOR PLAN

SCALE: 1/8" = 1'-0"



PLAN KEYNOTES

- NEW 9-LITE EXTERIOR DOOR (SIZE TO MATCH EXISTING)
- NEW FLUSH EXTERIOR DOOR (SIZE TO MATCH EXISTING)
- EXISTING OVERHEAD DOOR TO REMAIN
- NEW WINDOW (REFER TO ELEVATIONS FOR ALL WINDOWS), SIZE TO MATCH EXISTING.

Office Exterior Renovations
Jasper Pulaski Nursery
DEPT. OF NATURAL RESOURCES
15508 W 700 N
Medaryville, IN 47957



Revisions:

Project Number:
ENG2509662251

Requisition Number:
Requisition#

Designer: N/A
Drawing Date: 3/4/25

Drafter: N/A
Drawing Scale: AS NOTED

DNR Approval:

Client Approval:

File Number:
xxx-xxx

Drawing Number:
A-1

Sheet:
1 of 2

