

Reduced Speed Advance Warning Sign Assembly

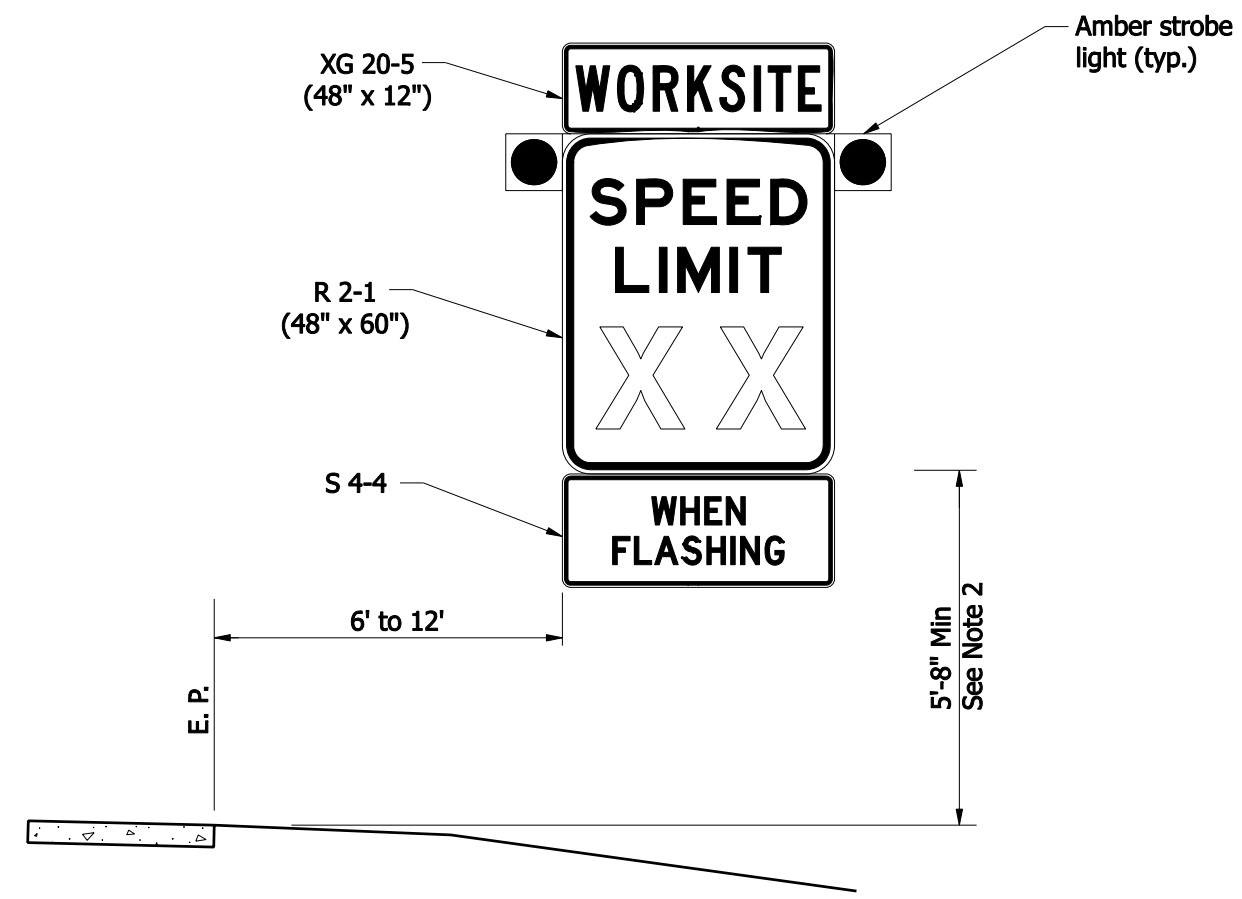

Worksite Speed Limit Sign Assembly

General Notes:

1. If not trailer mounted, signs and supports shall meet NCHRP 350 crash evaluation criteria.
2. Mounting height shall be 7' for interstate applications.
3. Advance Warning Sign speed shall match Worksite Sign.
4. The Work Site Speed Limit shall be 45 MPH, or 10 MPH below the posted speed limit for the roadway under construction, whichever is less.

INDIANA DEPARTMENT OF TRANSPORTATION
WORKSITE SPEED LIMIT SIGN ASSEMBLY

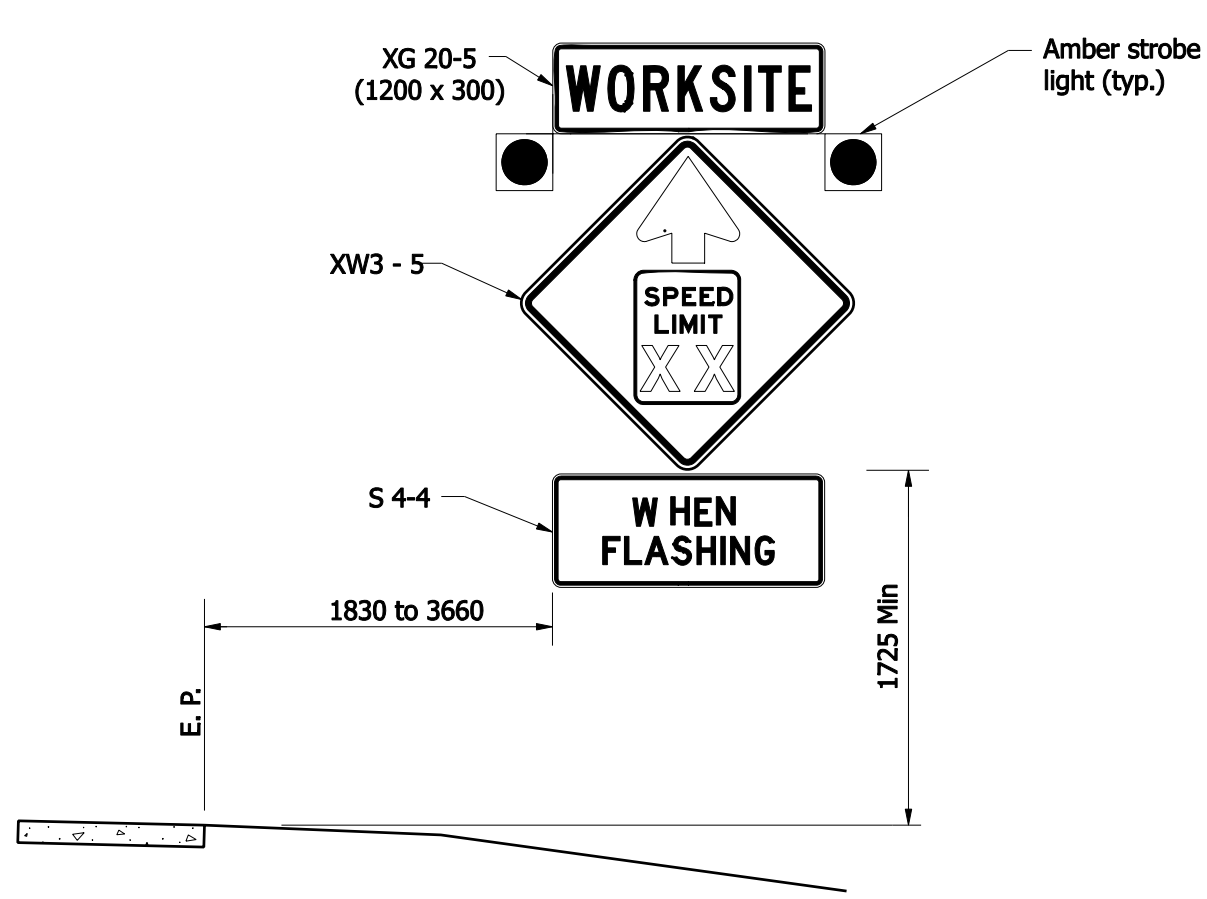

Reduced Speed Advance Warning Sign Assembly

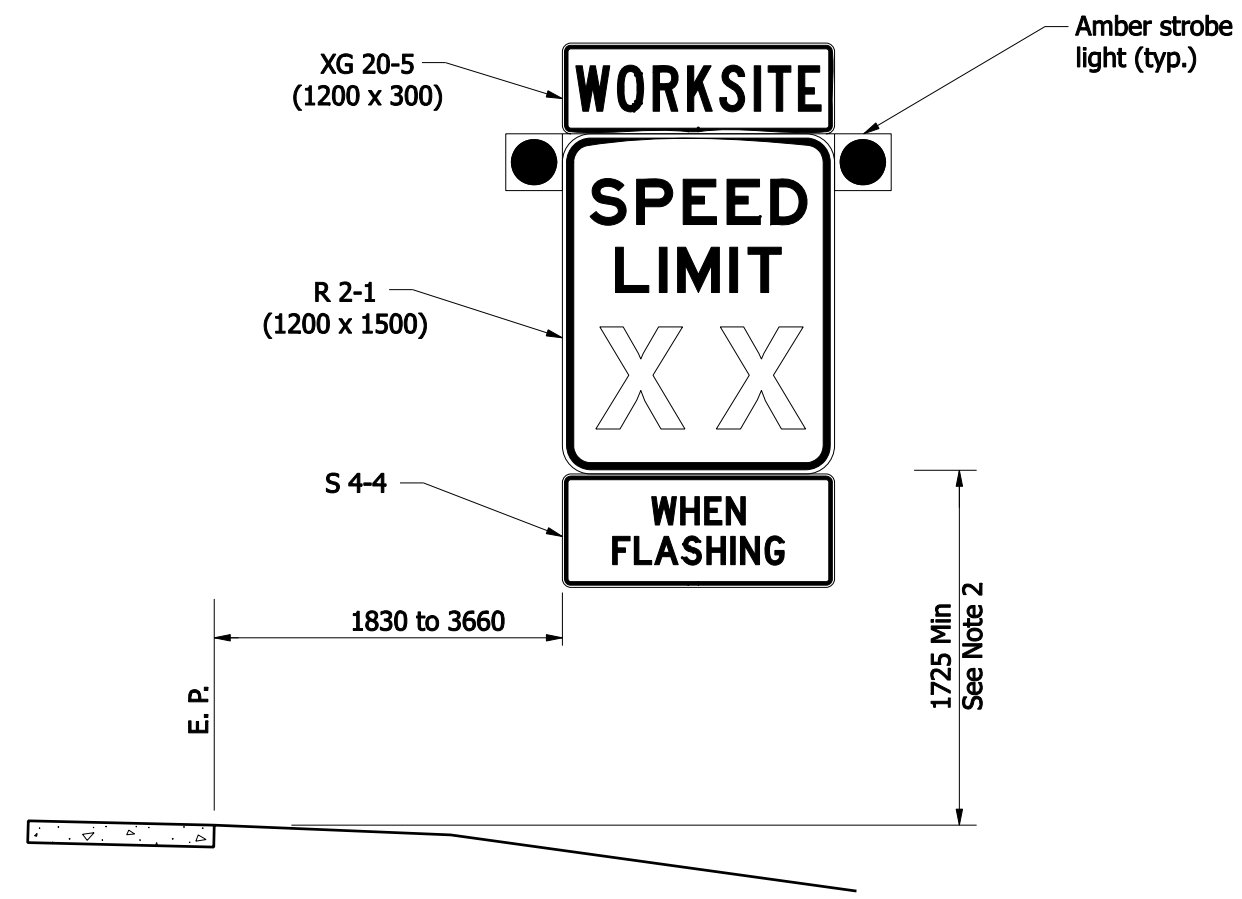

Worksite Speed Limit Sign Assembly

General Notes:

1. If not trailer mounted, signs and supports shall meet NCHRP 350 crash evaluation criteria.
2. Mounting height shall be 2130 for interstate applications.
3. Advance Warning Sign speed shall match Worksite Sign.
4. The Work Site Speed Limit shall be 45 MPH, or 10 MPH below the posted speed limit for the roadway under construction, whichever is less.

All Dimensions are in mm unless otherwise specified.

INDIANA DEPARTMENT OF TRANSPORTATION

WORKSITE SPEED LIMIT SIGN ASSEMBLY