

8 - 3/4" ϕ x 1'-2 long round head bolts in 7/8" ϕ holes. (4 ea. rail) Holes are to be slotted as required for expansion

8 - 3/16" ϕ x 1'-0 long round head bolts in 1/4" ϕ holes. (4 ea. rail) Holes are to be slotted as required for expansion.

* Field measure distance to holes on concrete transition.

ELEVATION

NOTES :

1. All chamfered edges shall be 1".
2. Intermediate railing splices shall be placed every 20' with center of connection at span quarter points.
3. See Standard Drawing E 706-BRPP-05 for railing tube details and Inner sleeve details.
4. See Standard Drawing E 706-BRPP-06 for base plate detail and reinforcing steel bar bends.
5. See Standard Drawing E 706-TTBP-07, -08 for Concrete Bridge Railing Transition, TPS-2.
6. See Standard Drawing E 703-BRST-01 for standard 180° bar bending details.
7. All reinforcing bars designated "E" shall be epoxy coated.
8. Reinforcing steel in sidewalk shall match that shown on the bridge plans.

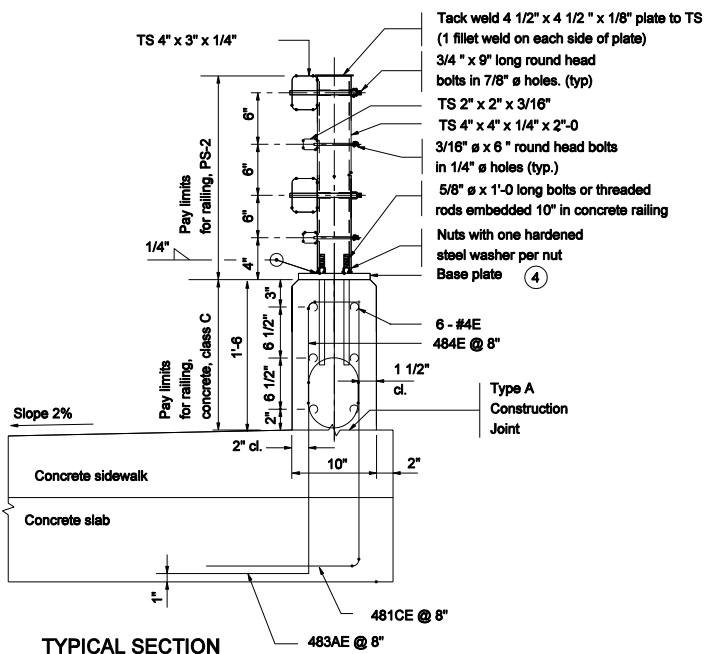

TYPICAL SECTION

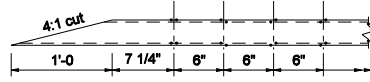

DETAIL A
(Plan view of larger railing tubes)

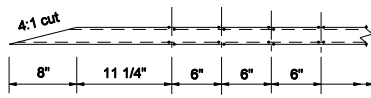

DETAIL A
(Plan view of smaller railing tubes)

INDIANA DEPARTMENT OF TRANSPORTATION	
RAILING, PS-2	
SEPTEMBER 2005	
STANDARD DRAWING NO. E 706-BRPP-04	
	<i>/s/ Richard L. VanCleave</i> 9-01-05 DESIGN STANDARDS ENGINEER DATE
	<i>/s/ Richard K. Smutzer</i> 9-01-05 CHIEF HIGHWAY ENGINEER DATE
DESIGN STANDARDS ENGINEER	