

**SPLICE PLATE ASSEMBLY DETAIL**

**GENERAL NOTES**

1. This sheet shall be used when guardrail end treatment type I is specified
2. The details on this sheet are for the assembly and the installation of the components of guardrail end treatment type I.

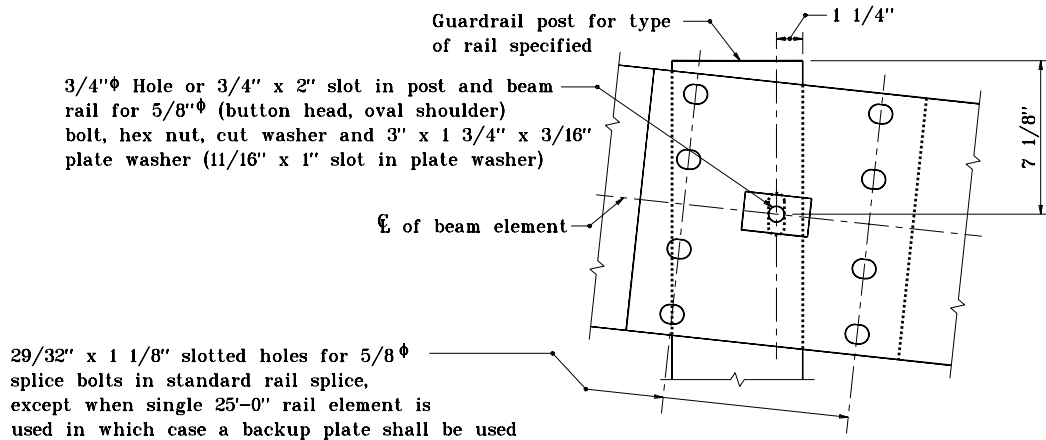

**POST NO. 2 CONNECTION DETAIL**

INDIANA DEPARTMENT OF TRANSPORTATION	
<b>GUARDRAIL END TREATMENT TYPE I</b>	
APRIL 1995	
<b>STANDARD DRAWING NO. E 601-GRET-04</b>	
	DETAILS PLACED IN THIS FORMAT 11-15-99 /s/ Anthony L. Uremovich 11-15-99 DESIGN STANDARDS ENGINEER DATE
DESIGN STANDARDS ENGINEER	/s/ Firooz Zandi 11-15-99 CHIEF HIGHWAY ENGINEER DATE ORIGINALLY APPROVED 4-03-95