

Wells Woods Nature Preserve

County: Jennings Size: 20 acres
Ownership: Nature Preserves - IDNR

Location and Access

No parking, no trail. Take S.R. 3 to the Commiskey turnoff. Turn right (west) and go about 0.5 mi to Commiskey and then turn left (south) at the first road past the railroad tracks. Go 0.25 mi and the road will turn sharply to the right. Shortly after you round this curve and before the road curves left (south) again, the preserve will be on your right.

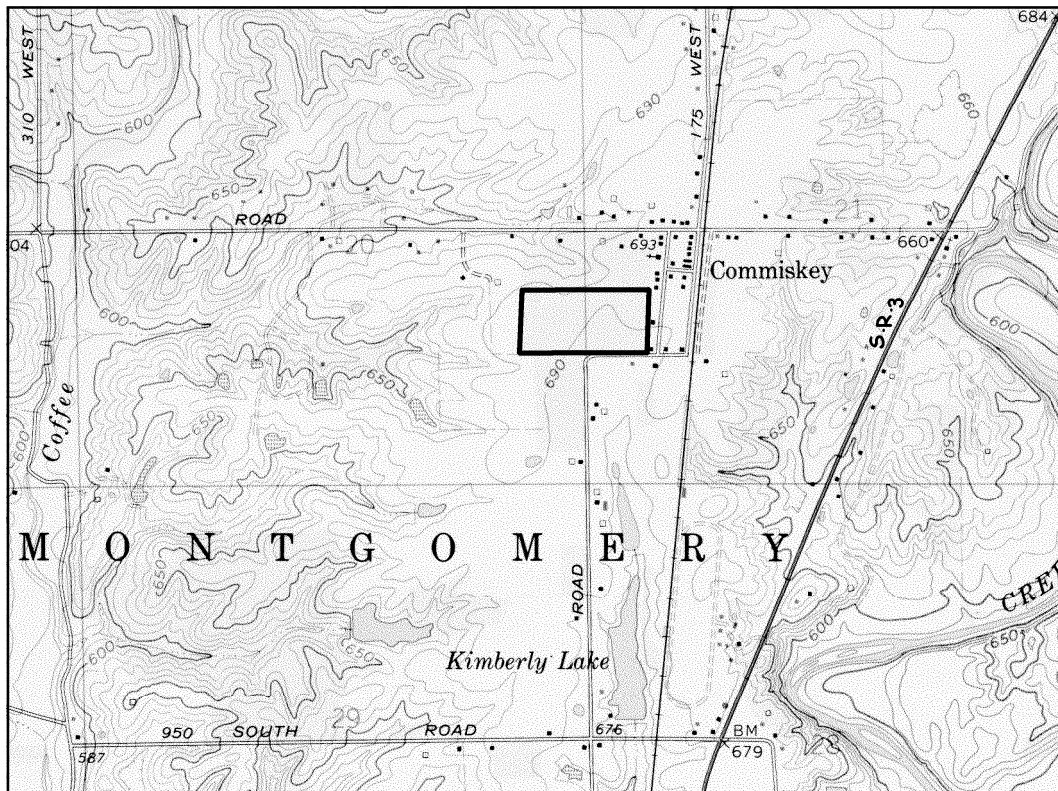
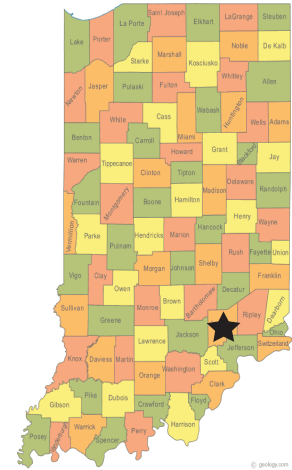

USGS Quad map: Deputy DeLorme ® page: 52

Description: Wells Woods is a tract of impressive old-growth forest in southeastern Indiana. The preserve is situated on what is locally called “the white clay flats,” which is level terrain consisting of Cobbsfork silt loam soil. The ground often ponds during the spring months and then dries to the point of cracking during the summer. This has helped Wells Woods develop an unusual species combination. Beech, sweetgum, red maple, black gum, white oak, and swamp chestnut oak are all important components of this preserve.

Further Information:

Division of Nature Preserves Southeast Regional Ecologist, Jason Larson: jl Larson@dnr.in.gov