

# Crooked Lake Nature Preserve and the Ralph F. Gates Addition

County: Whitley, Noble                      Size: 145 acres  
Ownership: Nature Preserves - IDNR; ACRES Land Trust

## Location and Access

**Parking lot and trail.** To reach the trails north of the lake: from the intersection of S.R. 9 and US 30, go north on S.R. 9 about 7 mi. to the Noble-Whitley County line. Go 0.5 mi. west on the county line road to a marked parking lot on the south side of the road. There are two trail loops through the preserve.

**Parking lot and trail.** To reach the trails south of Little Crooked Lake: from the intersection of S.R. 9 and U.S. 30, go north on S.R. 9 about 6 mi. to Co. Rd. 600N and go 0.5 mi. to Spear Road. Go north on Spear Road 0.5 mi. to a small parking area on the right. A trail loop circles eastward through this part of the preserve.

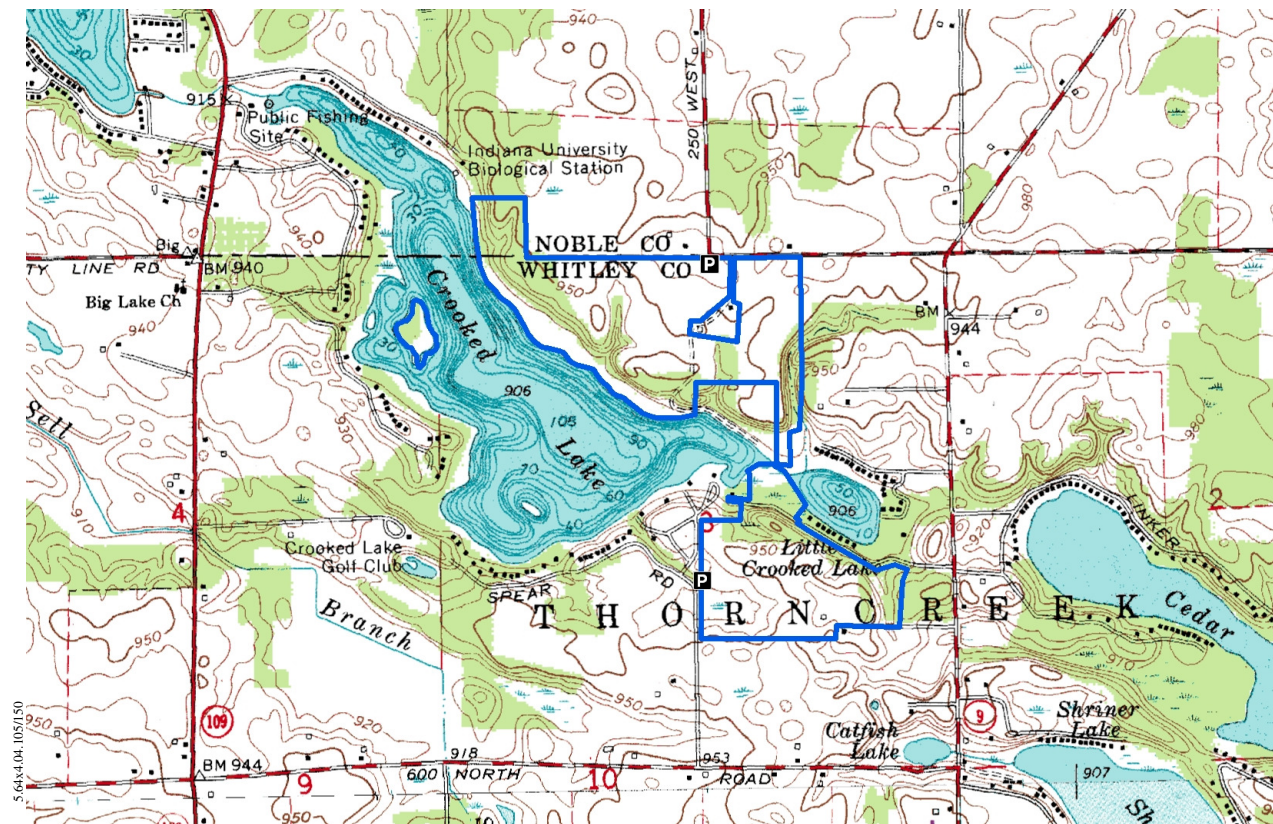
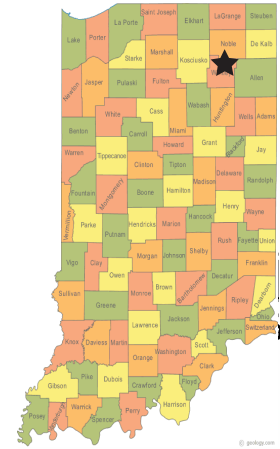

**Description:** This preserve contains over 0.5 mi. of undeveloped shoreline on one of Indiana's cleanest and deepest lakes. Forested slopes are dominated by beech and sugar maple associated with green ash, shagbark hickory, red oak, sassafras and white oak. The understory consists of sugar maple, ironwood, green ash, beech, and flowering dogwood. There are wetland habitats including marshes and calcareous seeps along the shore, and an island in the lake itself. Included in the preserve is one acre which serves as a memorial to former Governor of Indiana, Ralph F. Gates. This tract is owned by ACRES, Inc.

The portion of the preserve south of Little Crooked Lake includes wooded slopes, open field, and a large pond which is covered with spatterdock plants during the summer.

## Further Information:

Division of Nature Preserves Northeast Regional Ecologist, Rich Dunbar: [rdunbar@dnr.in.gov](mailto:rdunbar@dnr.in.gov)