

# Wintergreen Woods Nature Preserve

County: LaPorte

Size: 22.9 acres

Ownership: LaPorte County Conservation Trust, Inc.



## Location and Access

**Parking lot and trail.** From Michigan City, go north on SR 212 to Co. Rd. 900 N (about 2.7 mi). Turn right (east). The road jogs left, then right just before the preserve, becoming Co. Rd. 925 N. The preserve is just past the intersection of Co. Rd. 375 W and Co. Rd 925 N, on the north side of the road.

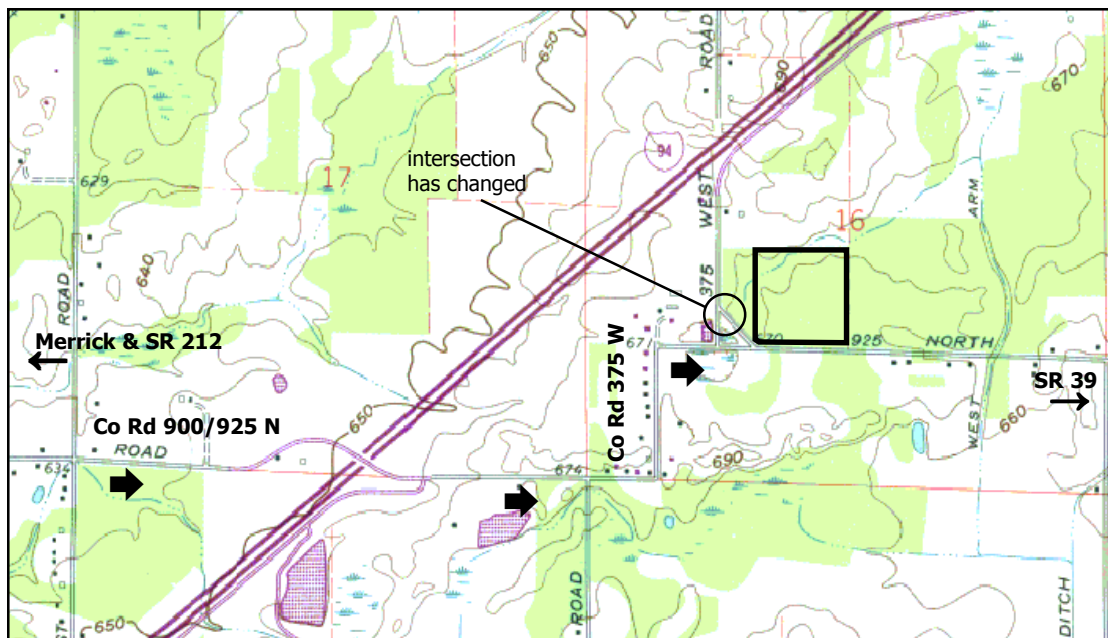

## Description:

This is a remnant northern boreal flatwoods natural community, which is a type of forest restricted to a narrow area just south of the Lake Michigan dunes. During wet seasons most of the preserve has standing water in it due to poorly drained areas on the preserve and the numerous “tip-ups” that occur when trees topple over during wind storms.

Plant species found here are usually found much farther north and include paper birch, a number of sedge species, goldthread, Canada mayflower, and starflower.

This preserve was an Indiana Heritage Trust project.

## Further Information:

LaPorte Co. Conservation Trust, Inc. 405 Maple Ave. LaPorte IN 46550. 219-778-2810. [www.lpcct.org/properties.html](http://www.lpcct.org/properties.html)  
Division of Nature Preserves. 402 W Washington St, Rm W267. Indianapolis, IN 46204-2243.

317-232-0209. [www.in.gov/dnr/naturepr](http://www.in.gov/dnr/naturepr)