

**MAJOR
MOVES**

**BUILDING ROADS
CREATING JOBS**



Contact Information

Aimee Kindred

Public Involvement Director
Production Management
100 North Senate Avenue
Room N642
Indianapolis IN 46204
(317) 234-4938 office
(317) 517-2166 mobile
(317) 233-4929 fax
akindred@indot.in.gov

We'd Like to Hear From You

The project team is committed to keeping the residents and business owners in Tippecanoe, Carroll and Cass Counties informed about this project. If there are subjects you would like to hear more about, please contact the public involvement team through

Aimee Kindred at
akindred@indot.in.gov or
317-234-4938

Representatives Available for Community Meetings

If your small group or organization would like a brief presentation or Q&A session about the SR25 Hoosier Heartland project, please contact the Public Involvement Director:

Aimee Kindred
akindred@indot.in.gov
317-234-4938.

Project Update

SR25 Hoosier Heartland
Tippecanoe, Carroll and Cass Counties
DES# 9802920

The Groundbreaking Ceremony for the SR25 Hoosier Heartland project took place on October 22, 2008 at the Faith Community Center in Lafayette. The first three contracts for this project have been awarded this year to meet Governor Daniels' accelerated schedule that was announced in February 2008.

The first contract was awarded to Walsh Construction on September 4, 2008. The limits of this contract are from just west of the Norfolk Southern Railroad to just east of the Tippecanoe/Carroll County line, and includes mainline construction of the new highway as well as twin bridges over the railroad and County Line Road.

On October 1, 2008, Milestone was awarded the CR1000E contract from just north of CR700N to just south of CR800N. This contract will bridge CR1000E over the new SR25 project.

Jack Isom Construction was awarded the third contract for this year on November 19 for CR625E from just north of CR400N to just south of CR450N. CR625E will be bridged over the new SR25 project and the Norfolk Southern Railroad.

A current contract schedule is included inside this newsletter as well as detour route maps for the three contracts that have been awarded. Please visit the recently updated project website at www.in.gov/indot/div/projects/sr25study

Questions and Answers

Q: How is right-of-way acquired by INDOT?

A: Log on to www.fhwa.dot.gov/realestate/realprop/index.html

Q: What happens if my house or business must be removed from the new right-of-way?

A: Log on to www.fhwa.dot.gov/realestate/rights/index.html

CONTRACT	2008	2009	2010	2011	2012	2013	2014
IB-30837			Bridge - CR300N over NSRR and SR 25				
IB-30838			Bridge - CR500E over NSRR and SR 25				
IB-30839			Bridge - CR625E over NSRR and SR 25				
IB-30841			Bridge - CR900E over NSRR and SR 25				
IB-30842			Bridge - CR1000E over SR 25				
IR-30840				Phase 1A - From I-45 to 0.1 mi E of CR750E			
IR-30843				Phase 1B - From 0.1 mi E of CR750E to 0.1 mi W of NSRR			
IR-30844			Phase 1C - From 0.1 mi W of NSRR to 0.42 mi E of County Line				
IR-30845				Phase 2A - From 0.42 mi E of County Line to 0.15 mi E of US421			
IR-30847				Phase 2B - From 0.15 mi E of US421 to 0.6 mi S of Main Street			
IR-30848					Phase 2C - From 0.6 mi S of Main Street to 0.21 mi E of SR218		
IR-30846					Phase 2D - From 0.21 mi E of SR218 to 0.48 mi E of CR400W		
IR-30849				Phase 3A - From 0.48 mi E of CR400W to 0.11 mi E of CR100W			
IR-30850					Phase 3B - From 0.11 mi E of CR100W to 0.16 mi E of CR505		
IR-30851			Phase 3C - From 0.16 mi E of CR505 to 0.61 mi E of CR325W				
IB-30855					Bridge - SR25 over Old SR25 and NSRR		
IB-30854					Bridge - SR25 over Kokomo Pkwa		
IR-30853					Phase 4A - From 0.61 mi E of CR325W to 0.21 mi E of CR115W		
IR-30852					Phase 4B - From 0.21 mi E of CR115W to US34/US35		

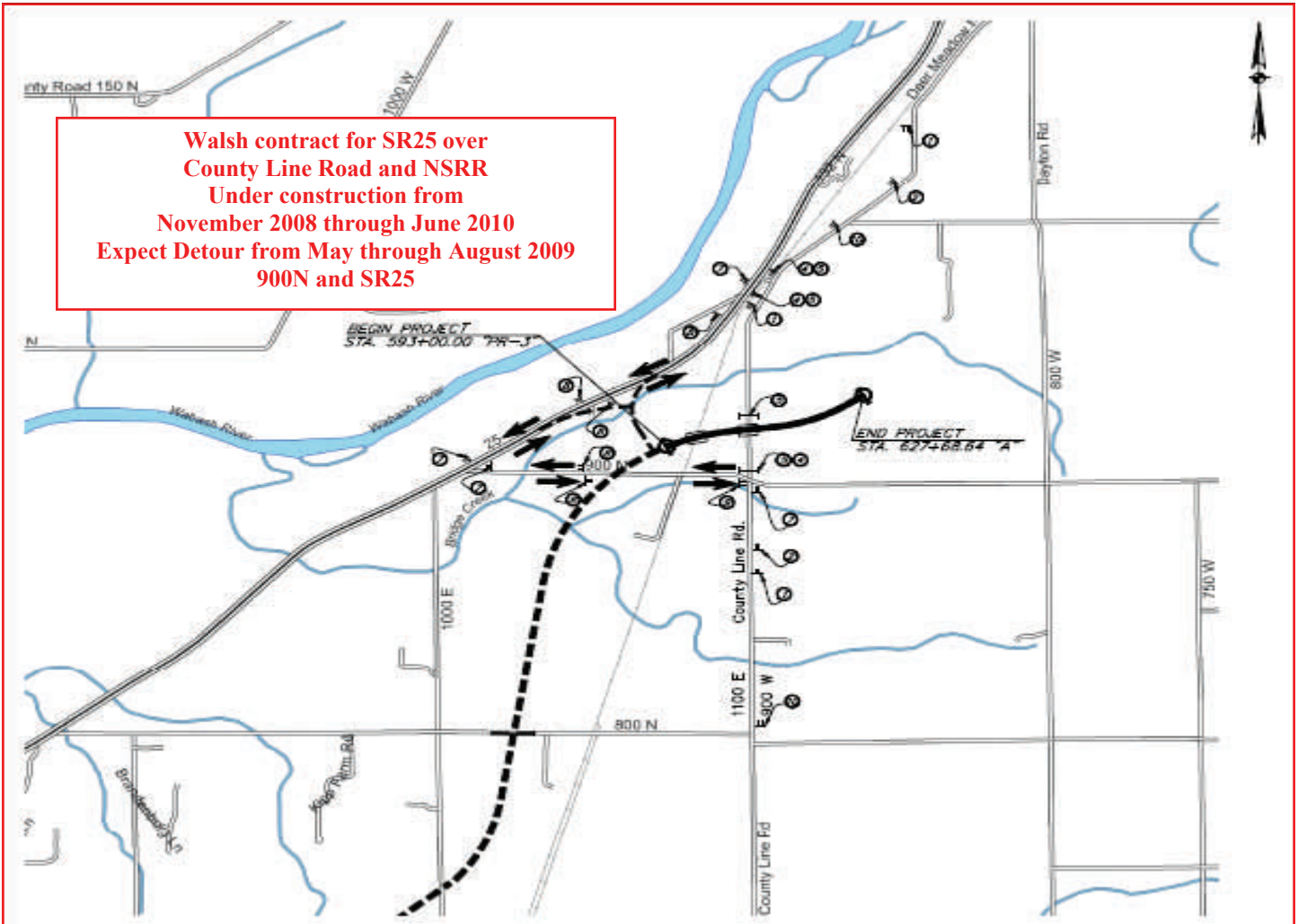

**Milestone contract for CR1000E
under construction from
December 2008 through October 2009
Detour 700N, 900E & 800N**

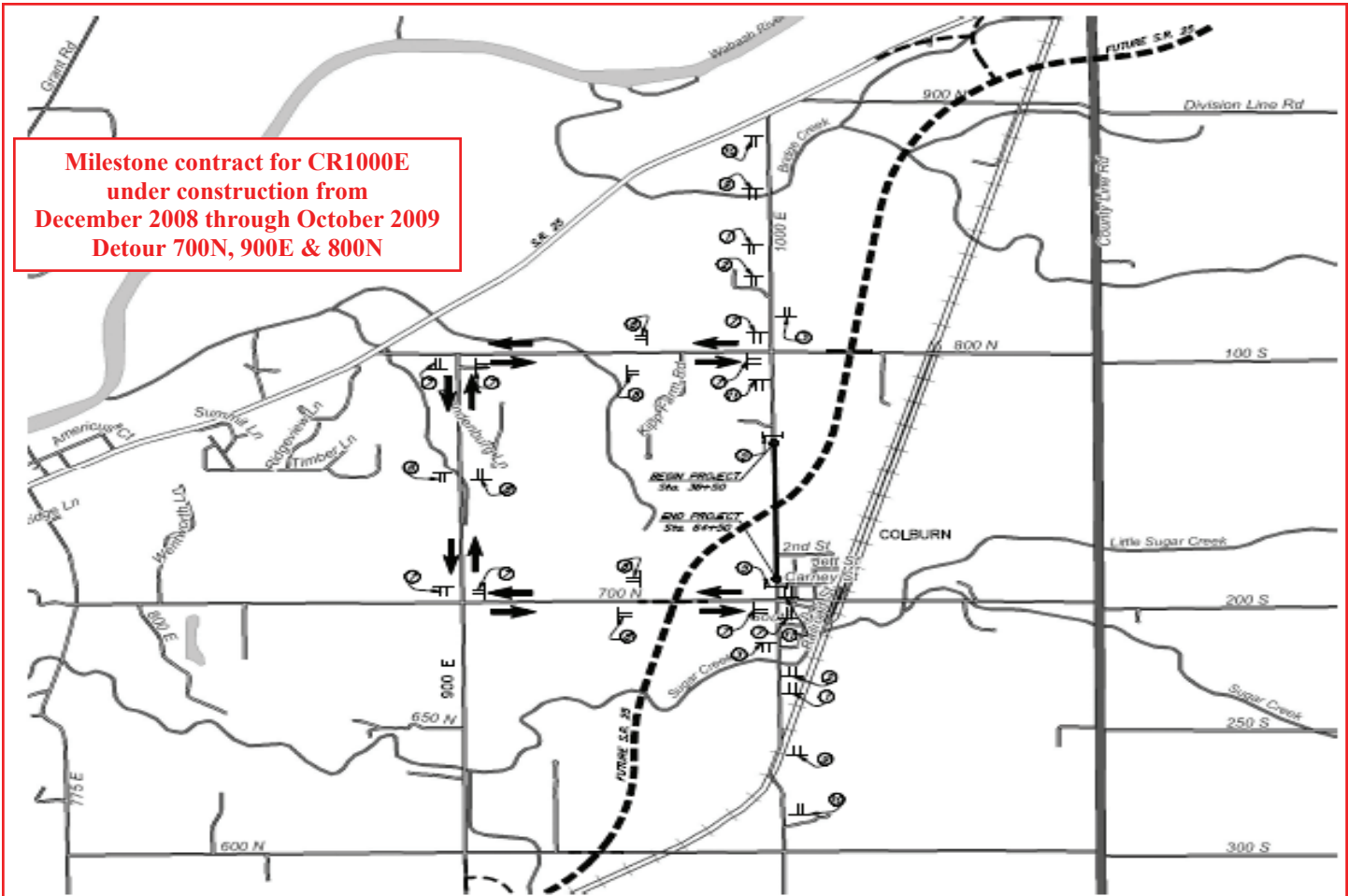

**Jack Isom contract for CR625E
Under construction from
March 2009 through November 2010
Detour 450N, 750E & 300N**

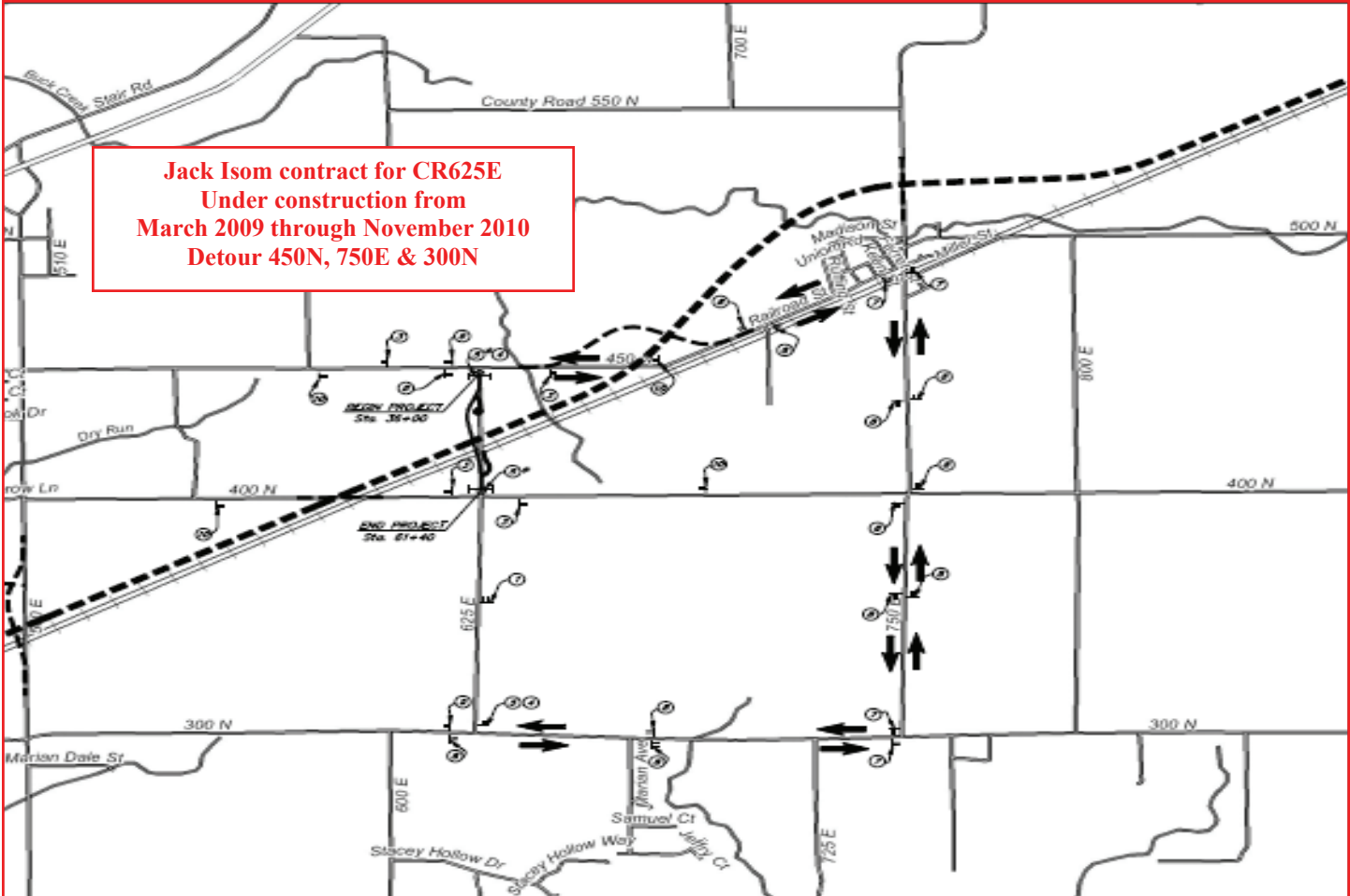



Indiana Department of Transportation
Attn: Aimee Kindred
Division of Production Management
100 North Senate Avenue N642
Indianapolis, Indiana 46204

RETURN SERVICE REQUESTED



INDIANA DEPARTMENT OF TRANSPORTATION
Driving Indiana's Economic Growth