

# DEKALB

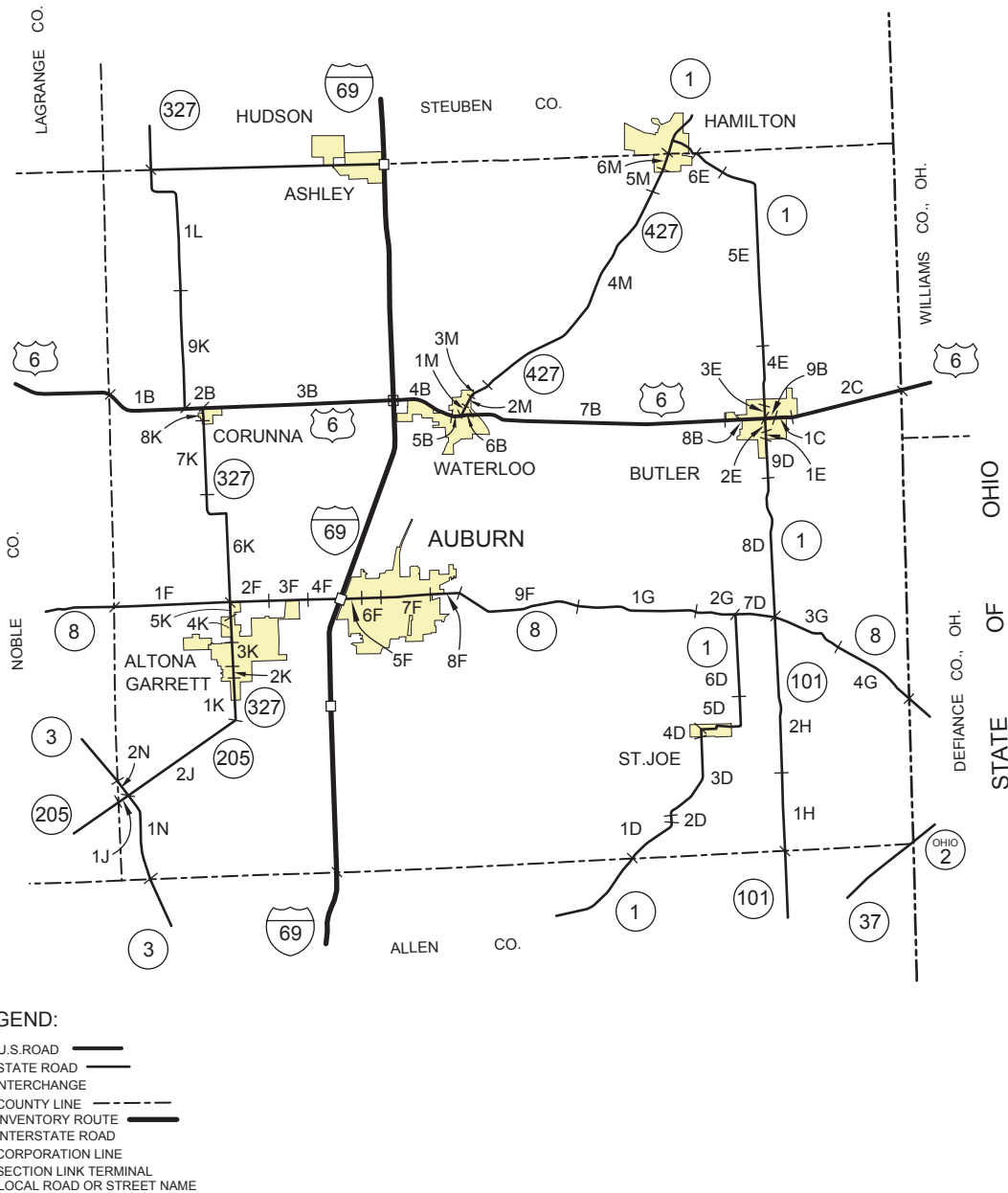

- LEGEND:**
- U.S. ROAD
  - STATE ROAD
  - INTERCHANGE
  - COUNTY LINE
  - INVENTORY ROUTE
  - INTERSTATE ROAD
  - CORPORATION LINE
  - SECTION LINK TERMINAL
  - LOCAL ROAD OR STREET NAME

ROAD NO.	CODE NO.	DAILY TRAFFIC VOLUME	DESCRIPTION OF SECTION LINK TERMINI	ROAD NO.	CODE NO.	DAILY TRAFFIC VOLUME	DESCRIPTION OF SECTION LINK TERMINI							
I-69	1B-9B		NOTE: For Interstate Volumes Please See Current Interstate Flow Map		SR-8	1F	5830	Noble County Line						
						2F	9750	SR-327						
						3F	11850	IR-13 (CR-15)						
						4F	13270	IR-17 (CR-19)						
						5F	18360	I-69 Interchange						
						6F	14100	Indiana Ave.(Auburn)						
						7F	14100	Union St.(Auburn)						
						8F	6230	CR-40A (Auburn-Butler Rd.)						
						9F	3600	IR-35 (CR-35)						
						1G	2910	IR-51 (CR-51)						
						2G	2320	IR-59 (CR-59)						
						US-6	1C-2C				SR-101	1H	1590	SR-1 (Jct.South)
												2H	1770	(SR-8 follows over SR-1)
3G	2190	SR-1(Jct.N.) & SR-101(Jct.S.)												
4G	1980	SR-1(Jct.N.) & SR-101(Jct.S.)												
SR-1	1D-6E				SR-205							1J	3240	Allen County Line
												2J	3260	IR-10 (CR-64)
												3D	3270	SR-8 / SR-1
												4D	2410	Noble County Line
												5D	1310	SR-3
												6D	940	SR-327 (Jct.North)
												7D	2270	SR-205 (Jct.South)
												8D	3060	IR-226 (CR-54)
												9D	3290	IR-2 (CR-5)
						1E	3850	IR-226 (CR-54)						
						2E	5210	5th Ave.(Garrett)						
						3E	3860	2nd Ave.(Garrett)						
						4E	1660	Quincy St.(Garrett)						
5E	1340	High St.(Garrett)												
6E	1270	US-6												
SR-3	1N-2N				SR-327	1K	5410	SR-8						
						2N	12380	SR-8						
SR-427	1M-6M				SR-427	1L	4250	IR-140 (CR-32)						
						2M	4720	South St.(Corunna)						
						3M	4100	US-6 (Jct.East)						
						4M	2230	(SR-327 follows over US-6)						
						5M	2310	US-6 (Jct.West)						
						6M	4290	US-6 (Jct.West)						
						Allen County Line SR-205 Noble County Line								
						Allen County Line IR-8 (CR-59) IR-6 (CR-68) IR-12 Spencer St.(St.Joe) IR-20 (CR-56) SR-8 (Jct.West) SR-8(Jct.E.) & SR-101(Jct.S.) IR-46 (CR-34) Jones Rd.(Butler) Depot St.(Butler) US-6 Monroe St.(Butler) IR-166 (CR-20) IR-67 (CR-65A) Steuben County Line								