

# White Oak Cemetery Nature Preserve

County: Jay                      Size: 39.64 acres  
Ownership: Nature Preserves - IDNR



## Location and Access

**Parking and trails.** From US 27 take the exit for 18 W and drive for 3.6 miles. Turn right onto N 250 W and continue for a mile then turn left at the 1<sup>st</sup> cross street onto W 850 N. Parking will be on the right. A short trail leads to the cemetery.

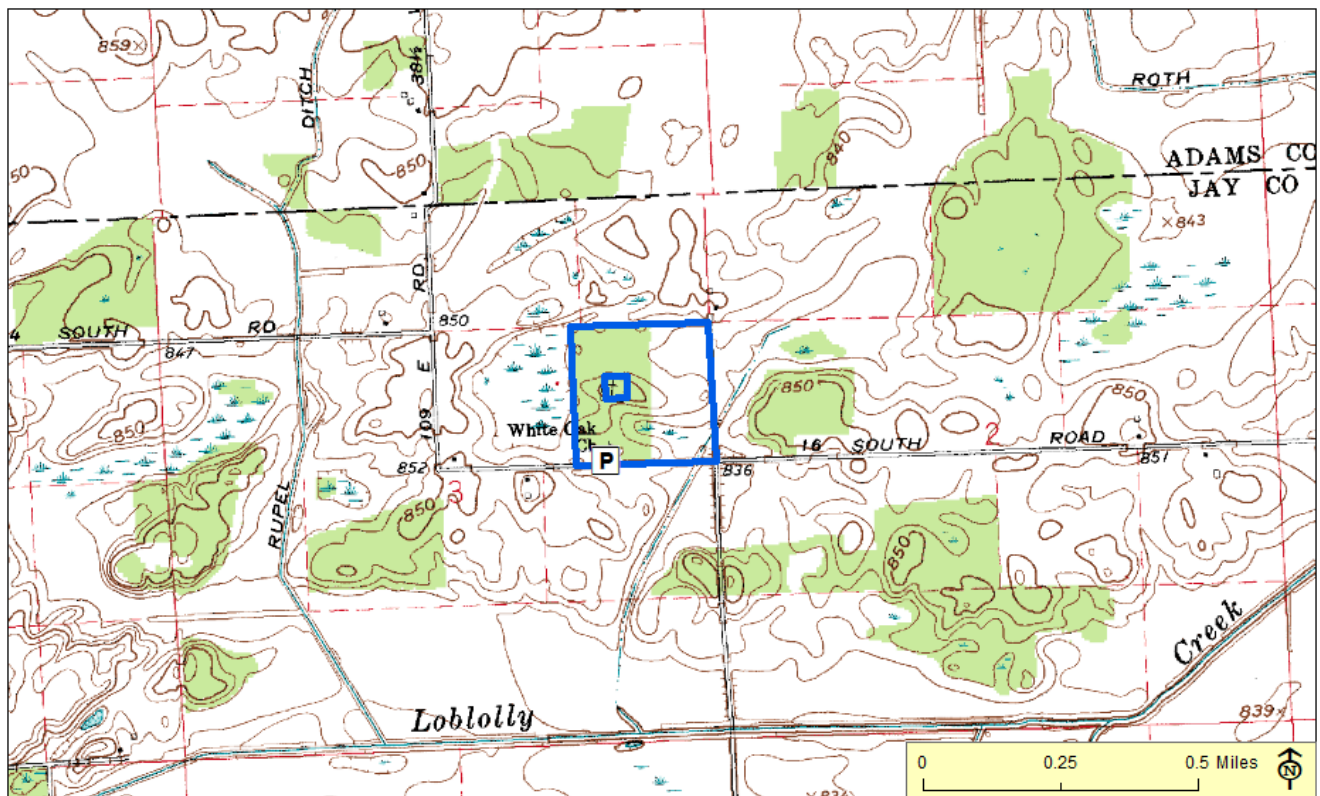

**Description:** The property contains a mesic upland forest and associated natural community. The site is an open oak woodland dominated by oaks and hickories, primarily white oak and shagbark hickory. The understory is rich in wildflowers, grasses, and a variety of sedges. The cemetery includes several local Civil War veterans.

## Further Information:

Division of Nature Preserves East Central Regional Ecologist, Ryan Smith: rysmith1@dnr.in.gov