



"Hardwood Ecosystem Experiment"

What is the HEE?

A unique 100-year collaborative study researching short- and long-term impacts on State Forest plant and wildlife communities.

Who is involved in the HEE?

Many research universities across the Midwest are involved with the HEE, including Purdue University, Ball State University, Indiana State University, Drake University, and the University of Indianapolis.

Harvesting methods studied & used on State Forests

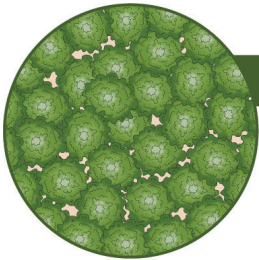

No Harvest

No removal of trees.

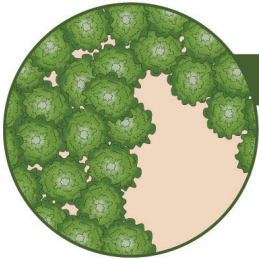

Clearcuts

Removal of all trees from one specific area.

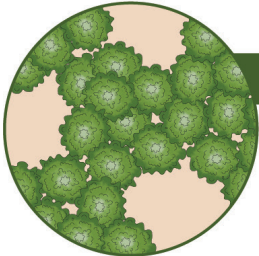

Patch cuts

Removal of trees in multiple small, patch-like areas.

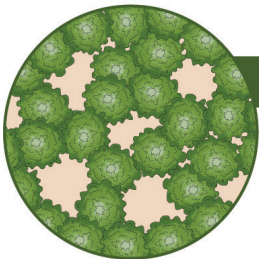

Single tree

Removal of individual trees on a single basis.

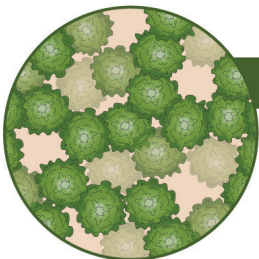

Shelterwood

Removal of trees gradually and over a length of time.

What is studied at the HEE?

Dozens of topics are studied at the HEE. Below is a list of some of those topics:



The HEE in Numbers



240 field technicians have worked on the HEE since its initiation in 2006.



57 articles have been published in peer-reviewed journals.



30 graduate students have completed their degree with their HEE research.



26 different research topics have been investigated since 2006.



13 years of data collected (including 2018).



8 institutions have had researchers involved.