

**APPLICATION FOR VARIANCE**State Form 44400 (R7 / 10-13)
Approved by State Board of Accounts, 2013INDIANA DEPARTMENT OF HOMELAND SECURITY
CODE SERVICES SECTION
302 West Washington Street, Room W246
Indianapolis, IN 46204-2739
http://www.in.gov/dhs/fire/fp_bs_comm_code/**INSTRUCTIONS:** Please refer to the attached four (4) page instructions.
Attach additional pages as needed to complete this application.

Variance number (Assigned by department)

16-01-01

1. APPLICANT INFORMATION (Person who would be in violation if variance is not granted; usually this is the owner)		
Name of applicant	Title	
Gregory Pardieck	Vice President	
Name of organization	Telephone number	
Chateau Di Pique	(812) 523-9911	
Address (number and street, city, state, and ZIP code)		
6361 N CR 760 E Seymour, IN 47274		
2. PERSON SUBMITTING APPLICATION ON BEHALF OF THE APPLICANT (If not submitted by the applicant)		
Name of applicant	Title	
THOMAS L POTTSCHMIDT, P.E.	ENGINEER	
Name of organization	Telephone number	
POTTSCHMIDT ENGINEERING	(317) 995-1965	
Address (number and street, city, state, and ZIP code)		
7301 CHESTNUT HILLS BLVD INDIANAPOLIS, IN 46278		
3. DESIGN PROFESSIONAL OF RECORD (If applicable)		
Name of design professional	License number	
Thomas L. Pottschmidt, P.E.	PE60900391	
Name of organization	Telephone number	
Pottschmidt Engineering	(317) 995-1965	
Address (number and street, city, state, and ZIP code)		
7301 Chestnut Hills Blvd Indianapolis, IN 46278		
4. PROJECT IDENTIFICATION		
Name of project	State project number	County
Chapel at Winery	N/A	Jackson
Address of site (number and street, city, state, and ZIP code)		
6361 N CR 760 E Seymour, IN 47274		
Type of project		
<input type="checkbox"/> New <input type="checkbox"/> Addition <input type="checkbox"/> Alteration <input checked="" type="checkbox"/> Change of occupancy <input type="checkbox"/> Existing		
5. REQUIRED ADDITIONAL INFORMATION		
The following required information has been included with this application (check as applicable):		
<input checked="" type="checkbox"/> A check made payable to the Indiana Department of Homeland Security for the appropriate amount. (see instructions)		
<input checked="" type="checkbox"/> One (1) set of plans or drawings and supporting data that describe the area affected by the requested variance and any proposed alternatives.		
<input checked="" type="checkbox"/> Written documentation showing that the local fire official has received a copy of the variance application.		
<input checked="" type="checkbox"/> Written documentation showing that the local building official has received a copy of the variance application.		
6. VIOLATION INFORMATION		
Has the Plan Review Section of the Division of Fire and Building Safety issued a Correction Order?		
<input type="checkbox"/> Yes (If yes, attach a copy of the Correction Order.) <input checked="" type="checkbox"/> No		
Has a violation been issued?		
<input type="checkbox"/> Yes (If yes, attach a copy of the Violation and answer the following.) <input checked="" type="checkbox"/> No		
Violation issued by:		
<input type="checkbox"/> Local Building Department <input type="checkbox"/> State Fire and Building Code Enforcement Section <input type="checkbox"/> Local Fire Department		

7. DESCRIPTION OF REQUESTED VARIANCE

Name of code or standard and edition involved	Specific code section
IN BC (675 IAC 13-2.6)	903.2.1.3

Nature of non-compliance (Include a description of spaces, equipment, etc. involved as necessary.)
 Assembly area for marriage ceremonies is on the second floor of multi-use building. Wine and Beer tasting is on the ground level. The assembly area will not have permanent seating and will have two exits. This variance is a request to not install an automatic sprinkler system on the second floor to allow occasional wedding ceremonies. The building is a non-smoking building and candles are not permitted. The construction of the building is of heavy timber. Due to the occasional nature of this area of the building an automatic sprinkler system is cost prohibitive.

8. DEMONSTRATION THAT PUBLIC HEALTH, SAFETY, AND WELFARE WILL BE PROTECTED

Select one of the following statements:

Non-compliance with the rule will not be adverse to the public health, safety or welfare; or

Applicant will undertake alternative actions in lieu of compliance with the rule to ensure that granting of the variance will not be adverse to public health, safety, or welfare. Explain why alternative actions would be adequate (be specific).

Facts demonstrating that the above selected statement is true:
 Currently, there exists in the State of Indiana at least 14 other venues where wedding ceremonies are held in the second floor of wood barns without automatic sprinklers and code compliant exits and therefore we are seeking equal treatment. A second exit will be added for the safe egress of occupants in case an emergency would occur. Several of these barns are in direct competition and therefore couples are traveling outside of the Jackson County area to get married to enjoy the ambiance of a rustic wedding.

9. DEMONSTRATION OF UNDUE HARDSHIP OR HISTORICALLY SIGNIFICANT STRUCTURE

Select at least one of the following statements:

Imposition of the rule would result in an undue hardship (unusual difficulty) because of physical limitations of the construction site or its utility services.

Imposition of the rule would result in an undue hardship (unusual difficulty) because of major operational problems in the use of the building or structure.

Imposition of the rule would result in an undue hardship (unusual difficulty) because of excessive costs of additional or altered construction elements.

Imposition of the rule would prevent the preservation of an architecturally or a historically significant part of the building or structure.

Facts demonstrating that the above selected statement is true:
 Only small groups of people will be gathering on the second floor of the building (150 or less) with the square footage of 2,640. One new exit will be added for a total of two exits. Also, as mentioned above, no smoking, candles, or any flame type of ignition source is permitted within the building and within 15 feet of the building's exterior. It will cost \$61,750 to install a sprinkler system and with only a half dozen ceremonies a year with a net income of \$700 each it would take approximately 15 years to payback (not taking into account interest) such an investment. Other barns that are used for this purpose within the State of Indiana that do not have sprinkler systems provide a higher degree of rustic appeal than a barn that would have a ceiling with a system of pipes.

10. STATEMENT OF ACCURACY

I hereby certify under penalty of perjury that the information contained in this application is accurate.

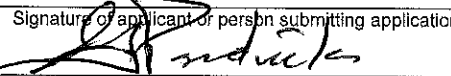
Signature of applicant or person submitting application	Please print name	Date of signature (month, day, year)
	Gregory Pardieck	12/4/2015
Signature of design professional (if applicable)	Please print name	Date of signature (month, day, year)
	Thomas L Pottschmidt	

11. STATEMENT OF AWARENESS (If the application is submitted on the applicant's behalf, the applicant must sign the following statement.)

I hereby certify under penalty of perjury that I am aware of this request for variance and that this application is being submitted on my behalf.

Signature of applicant	Please print name	Date of signature (month, day, year)
	Gregory Pardieck	

General Notes

SECOND FLOOR PLAN

No.	Revision/Issue	Date

Firm Name and Address
ENGINEER:
 THOMAS L. POTTSCHMIDT, P.E.
 7301 CHESTNUT HILLS BLVD
 INDIANAPOLIS, IN 46278

Project Name and Address
 Chateau Di Pique Winery
 6361 N CR 760 E
 Seymour, IN

Project Winery Chapel	Sheet A101
Date 6/3/15	Scale NTS

NOTES:
 SQUARE FOOTAGE: 2640 TOTAL
 2260 NET
 OCCUPANT LOAD:
 FIXED SEATING: 160
 CHAIRS NOT FIXED: 320
 ASSEMBLY GROUP A-3 CLASSIFICATION

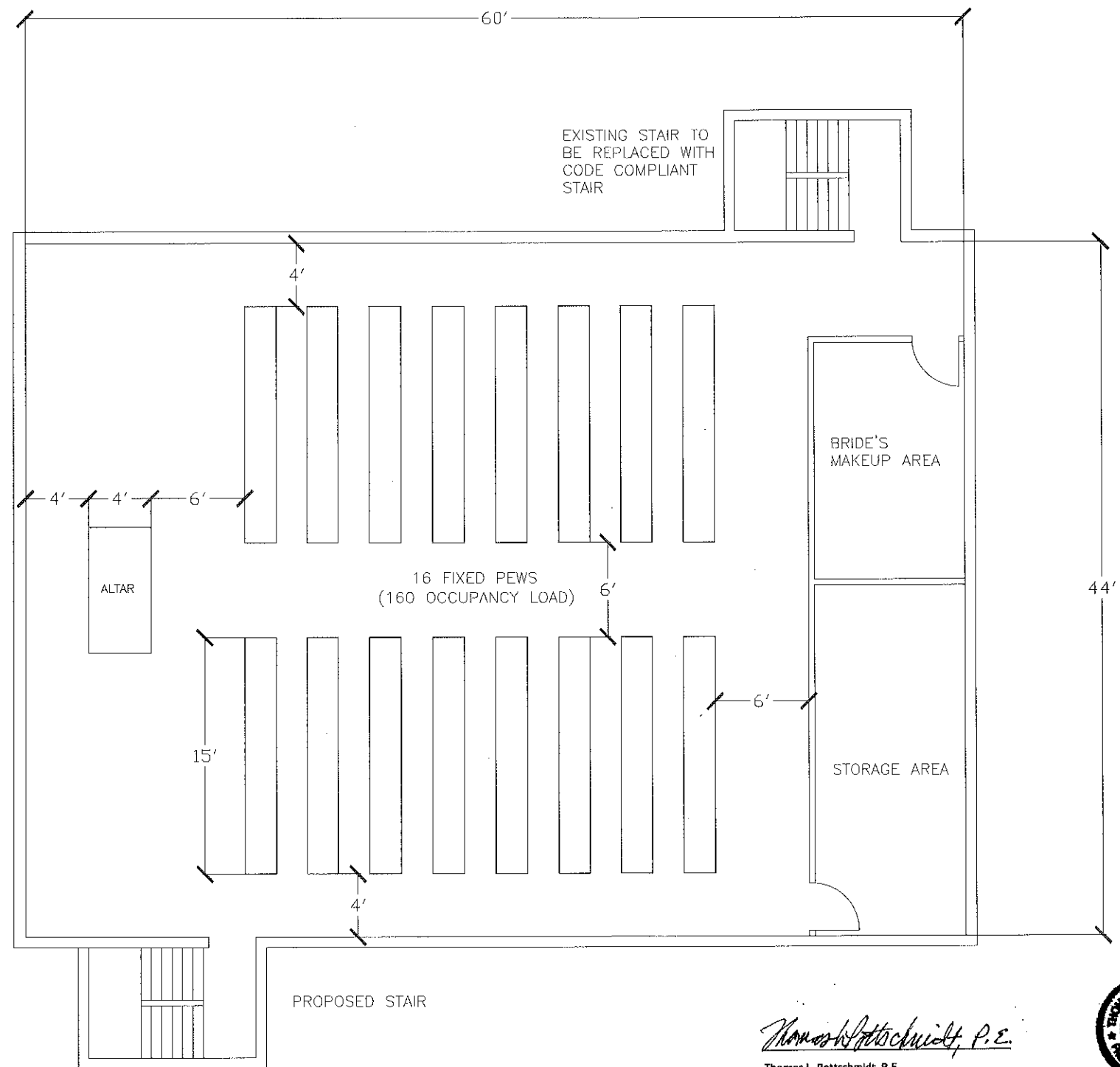

Thomas L. Potts Schmidt, P.E.
 Thomas L. Potts Schmidt, P.E.
 IN PE#60900391

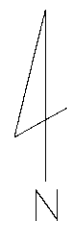

General Notes

SECOND FLOOR LIFE SAFETY PLAN

No.	Revision/Issue	Date

Firm Name and Address
 ENGINEER:
 THOMAS L. POTTSCHMIDT, P.E.
 7301 CHESTNUT HILLS BLVD
 INDIANAPOLIS, IN 46278

Project Name and Address
 Chateau Di Pique Winery
 6361 N CR 760 E
 Seymour, IN

Project Winery Chapel	Sheet A102
Date 6/3/15	
Scale NTS	

NOTES:

SQUARE FOOTAGE: 2640 TOTAL
2260 NET

OCCUPANT LOAD:
FIXED SEATING: 160
CHAIRS NOT FIXED: 320

ASSEMBLY GROUP A-3 CLASSIFICATION

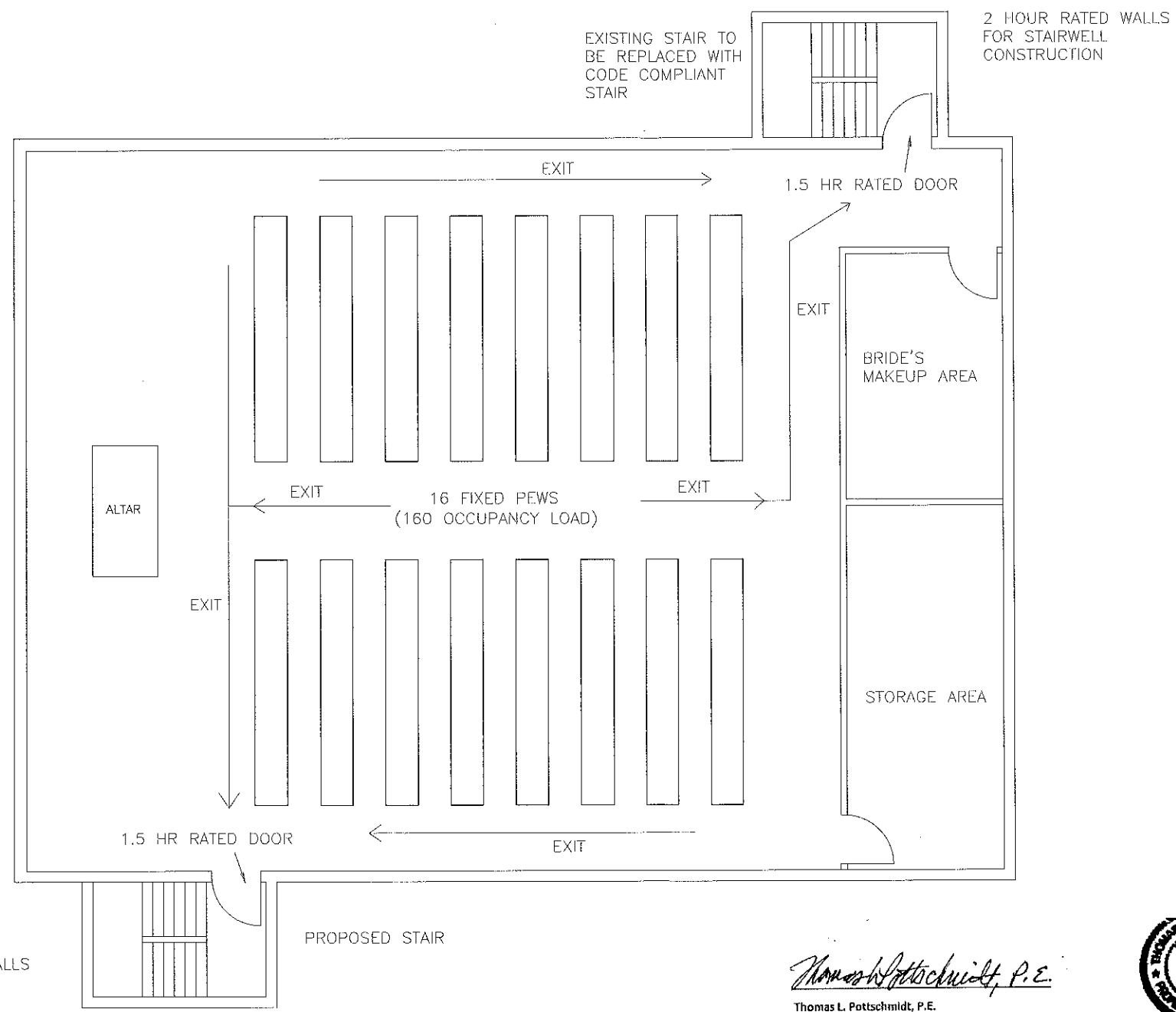

2 HOUR RATED WALLS
FOR STAIRWELL
CONSTRUCTION

EXISTING STAIR TO
BE REPLACED WITH
CODE COMPLIANT
STAIR

2 HOUR RATED WALLS
FOR STAIRWELL
CONSTRUCTION

Thomas L. Potts Schmidt, P.E.
 Thomas L. Potts Schmidt, P.E.
 IN PE#60900391

