

Ober Savanna Nature Preserve

County: Starke Size: 59 acres
Ownership: The Nature Conservancy

Location and Access

Small parking area; no trails. From the intersection of US 35 and CR 200S, south of Knox, go east about 4.5 miles. The preserve is on the north side of the road and there is a small pull-off for 1-2 cars to park.

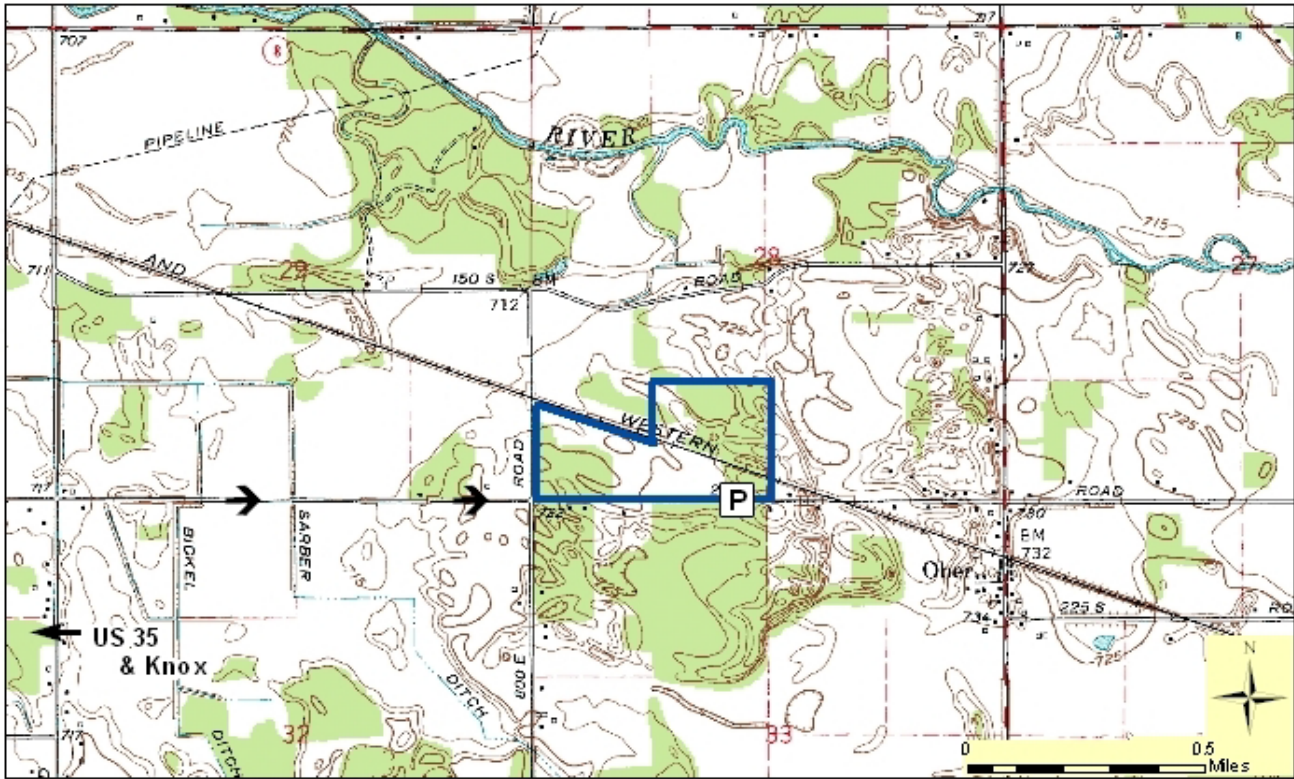
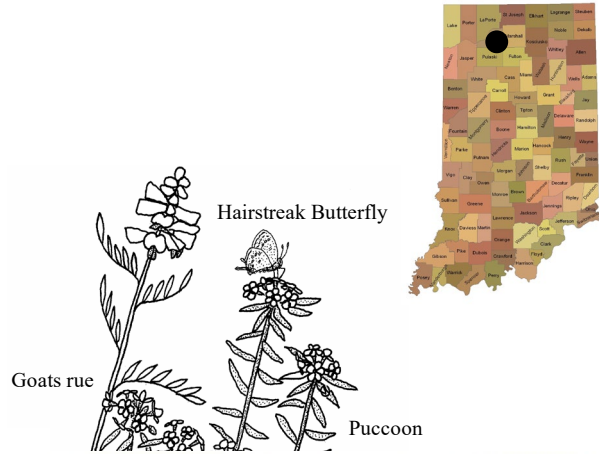

Description: This preserve protects a high quality example of a black oak sand savanna. Large black oaks are scattered throughout the area with a diverse herbaceous layer of wildflowers and grasses underneath. Among these are characteristic flowers such as lupines, puccoons, flax-leaved asters, dwarf dandelion, and prickly pear cactus, as well as June grass, porcupine grass, Indian grass, and the bluestem grasses. Numerous butterflies and insects are found among the abundant wildflowers. The old field that was farmed a number of years ago is slowly reverting to more native vegetation. Clumps of prairie grass can be seen in the field. Prescribed burning will be used to enhance this process.

Further Information:

The Nature Conservancy, Efroymsen Conservation Center, 620 E. Ohio St, Indianapolis, IN 46202.

(317) 951-8818. www.nature.org

Division of Nature Preserves Northwest Regional Ecologist, Matt Beatty: mbeatty1@dnr.in.gov