

# Fisher Oak Savanna Nature Preserve

County: Jasper  
Ownership: NICHES Land Trust

Size: 220 acres

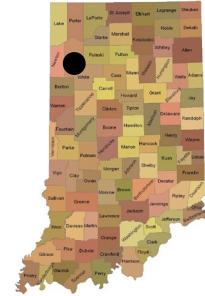

## Location and Access

**Parking and trail.** If driving on I-65, get off at Exit 193 and go north on US 231 to Wolcott in White County. About a half mile north of railroad crossing in Wolcott, highways 231 and 24 turn to the west. DO NOT turn west (left) on highways 231 and 24; instead go straight ahead on 900W, (turns into Road 20E in Jasper County), about 6 miles until you come to an older white farm house on a rise on the left side of the road. Drive ahead about 1/8 mile to the gravel parking area on the west (left) side of the road. 1.5 miles of easy natural surface trail. No facilities at this location.

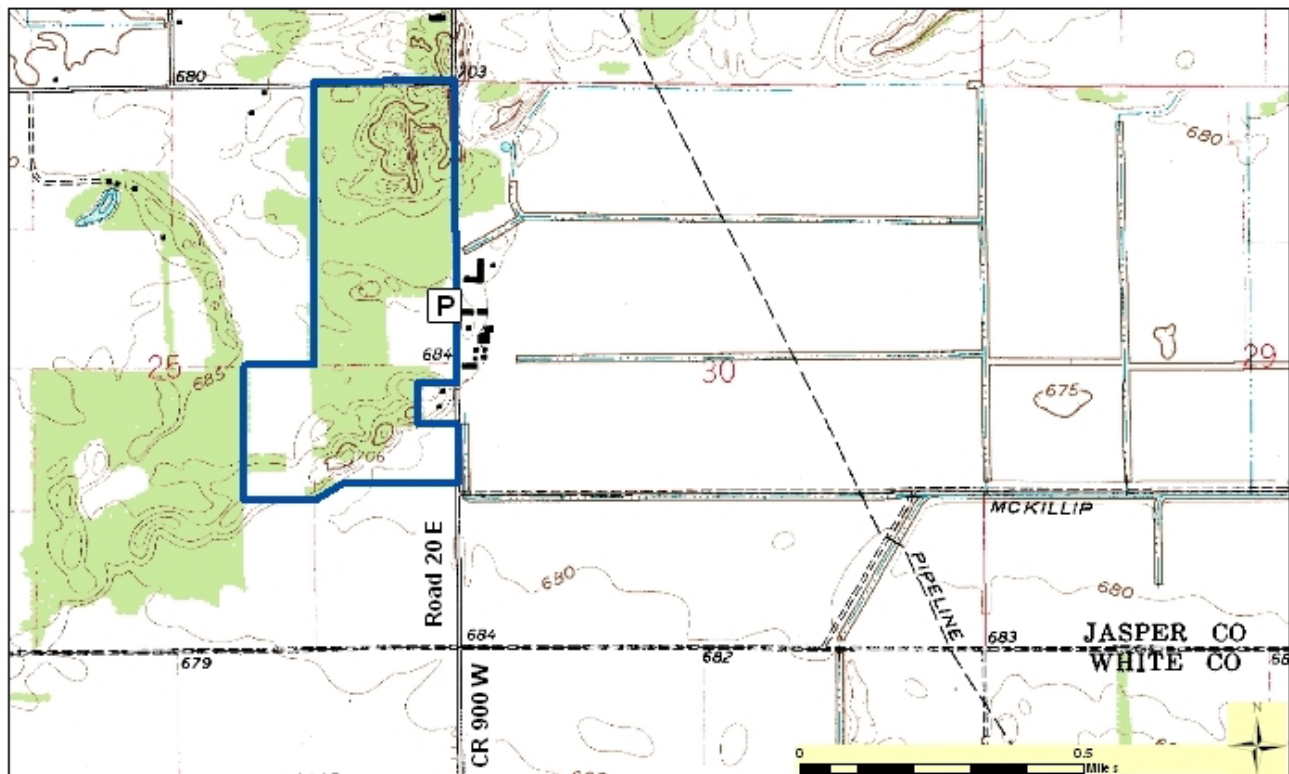

**Description:** Three habitat types meet on this preserve: pin oak flatwoods, sand prairie/savanna, and wet black soil prairie. The pin oak flatwoods supports black, white, and pin oaks. Blueberry and a variety of herbaceous plants are also present in the pin oak flatwoods. Restoration work is underway in a portion of the sand prairie/ savanna and the entire black soil prairie.

## Further information:

NICHES Land Trust, Box 2790, West Lafayette, IN 47996. (765) 423-1605. [www.nicheslandtrust.org](http://www.nicheslandtrust.org)  
Division of Nature Preserves Northwest Regional Ecologist, Matt Beatty: [mbeatty1@dnr.in.gov](mailto:mbeatty1@dnr.in.gov)