

| | |
|----------|-------------|
| PROJECT | DESIGNATION |
| 1800163 | 1800163 |
| CONTRACT | |
| R-41452 | |

INDIANA DEPARTMENT OF TRANSPORTATION

ROAD PLANS

S.R. 145
PROJECT NO. 1800163 P.E.
1800163 R/W
1800163 CONST.

SLIDE CORRECTION LOCATED APPROXIMATELY 1.69 MILES SOUTH
(RP 16+34) OF S.R. 62 ROAD JUNCTION PERRY COUNTY, INDIANA

GROSS LENGTH: 0.051 MILES
NET LENGTH: 0.051 MILES

SCALES:
PLAN LONG: 1" = 20'
TRANS: 1" = 20' HORIZ: 1" = 20'
VERT: 1" = 5' MAX. GRADE: +6.77 %

LOCATION:
LATITUDE: 38° 12' 05" N
LONGITUDE: 86° 41' 16" W

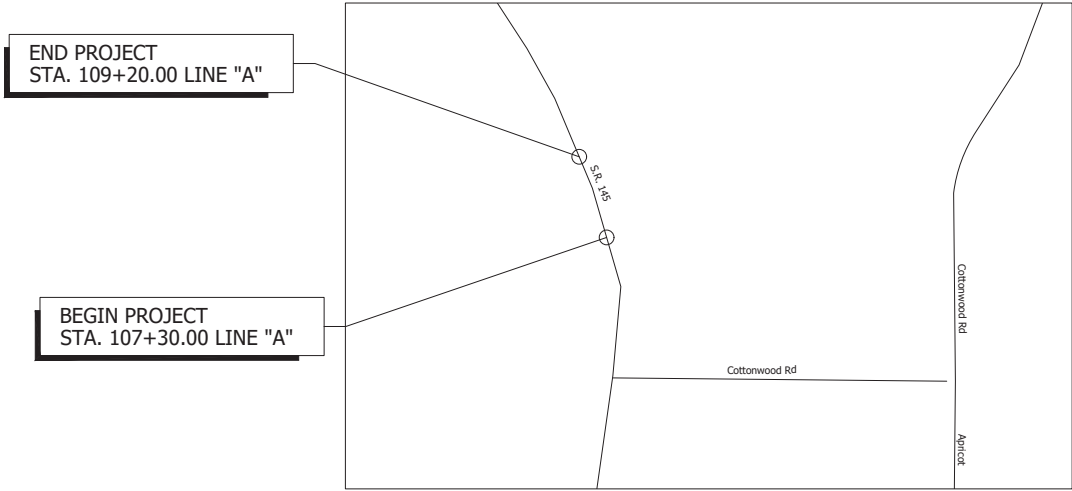

LOCATION MAP
PERRY COUNTY

| TRAFFIC DATA | | S.R. 145 | |
|---------------------------|-----------|-----------------------|------------|
| A.A.D.T. (2023) | PROJECTED | 418 | V.P.D. |
| A.A.D.T. (2043) | PROJECTED | 427 | V.P.D. |
| D.H.V. (2043) | | 54 | V.P.H. |
| DIRECTIONAL DISTRIBUTION | | 51 | % |
| TRUCKS | | 11 | % A.A.D.T. |
| | | 21 | % D.H.V. |
| DESIGN DATA | | | |
| DESIGN SPEED | | 45 | MPH |
| PROJECT DESIGN CRITERIA | | SR (NON-FREEWAY) | |
| FUNCTIONAL CLASSIFICATION | | RURAL MAJOR COLLECTOR | |
| RURAL/URBAN | | RURAL | |
| TERRAIN | | LEVEL | |
| ACCESS CONTROL | | NONE | |

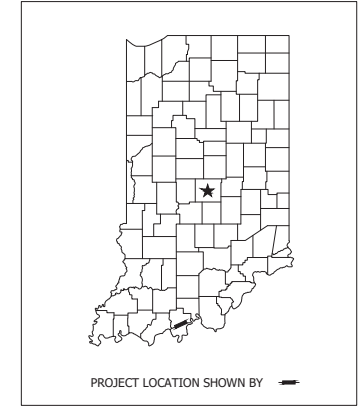

H.U.C. 14 DIGIT CODE NO.: 05090203150090

PFC PLANS

[INDIANA DEPARTMENT OF TRANSPORTATION
STANDARD SPECIFICATIONS DATED 2020 TO
BE USED WITH THESE PLANS]

| | | |
|-----------------------|--------------------------------------|---------------------------|
| PLANS PREPARED BY: | VS ENGINEERING, INC. | FAX: (317) 293-4737 |
| | | TEL: (317) 293-3542 |
| | | PHONE NUMBER |
| CERTIFIED BY: | XXXX, P.E. | INDIANA REG. NO. XXXXXXXX |
| APPROVED FOR LETTING: | | DATE |
| | INDIANA DEPARTMENT OF TRANSPORTATION | DATE |

Preliminary

| | |
|-------------|-------|
| DESIGNATION | |
| 1800163 | |
| SHEETS | |
| 1 | of 19 |
| CONTRACT | |
| R-41452 | |
| PROJECT | |
| 1800163 | |

DIRECTORY...F:\2019\19-40256 SR 145 at SR 62 Slide 1800163\30 SheetDrawings\01 Title and Index
 FILE.....19-40256 TITLE.dwg
 DIMSCALE..1 ITS SCALE.....1000
 PLOTTED BY...jschoosal
 DATE.....04/2021 - 2:49pm

DIRECTORY: F:\2019\19-40254-SR-145-SR-63-Side 1800163\30 SheetDrawings\10 MOT\10 MOT Plans
 FILE: 19-40254-SR-145-SR-63-Side 1800163.dwg
 DIMSCALE: 1/16" = 1" SCALE: 1/16" = 1" SCALE: 1/16" = 1"
 PLOTTED BY: jshofstall
 DATE: 04/20/21 - 2:50pm

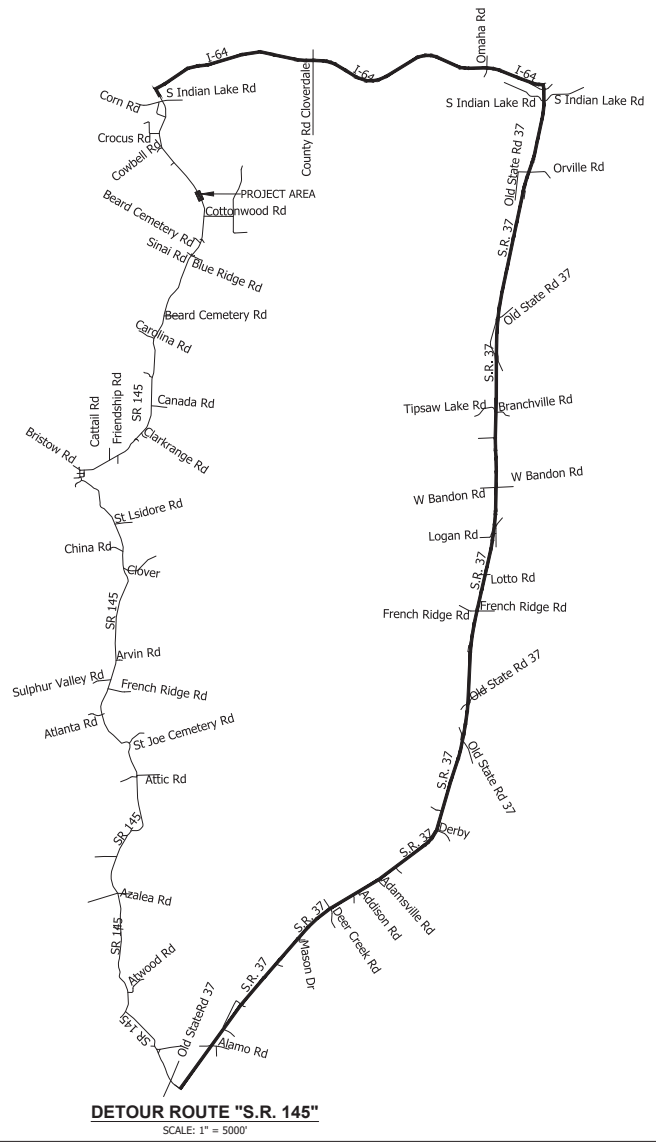

DETOUR ROUTE "S.R. 145"
 SCALE: 1" = 5000'



| LEGEND | |
|--------|---|
| | CONSTRUCTION SIGN W/TYPE "A" LIGHT |
| | DIRECTION OF DETOUR |
| | CONSTRUCTION SIGN |
| | BARRICADE TYPE III-A OR TYPE III-B AS NOTED |
| | DETOUR ROUTE |

NOTES:
 See Sheet 6 for Traffic Detour Details,
 Road Closure Details, and M.O.T. Quantities.

Preliminary

| | | |
|--------------------------|-----------------|------|
| RECOMMENDED FOR APPROVAL | DESIGN ENGINEER | DATE |
| DESIGNED: EA | DRAWN: EA | |
| CHECKED: MH | CHECKED: MH | |

| | |
|---|--|
| INDIANA DEPARTMENT OF TRANSPORTATION | |
| DETOUR ROUTE | |

| | |
|------------------|-------------|
| HORIZONTAL SCALE | BRIDGE FILE |
| AS NOTED | N/A |
| VERTICAL SCALE | DESIGNATION |
| N/A | 1800163 |
| SURVEY BOOK | SHEETS |
| | 6 of 19 |
| CONTRACT | PROJECT |
| R-41452 | 1800163 |

DIRECTORY: F:\2019\19-40254-SR-145-36-SR-63-Slide 1800163\30 SheetDrawings\10 MOT\10 MOT Plans.dwg
 FILE: 19-40254-SR-145-36-SR-63-Slide 1800163.dwg
 DIMSCALE: 1/8"=1'-0"
 PLOTTED BY: jshofstall
 DATE: 04/20/21 2:50pm

CONSTRUCTION SIGN LEGEND

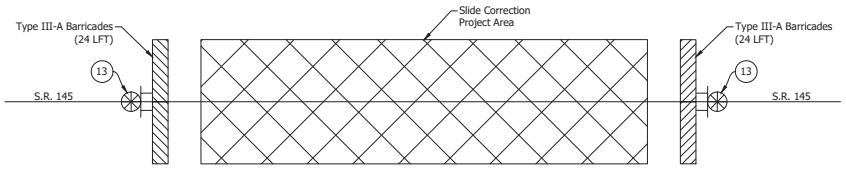
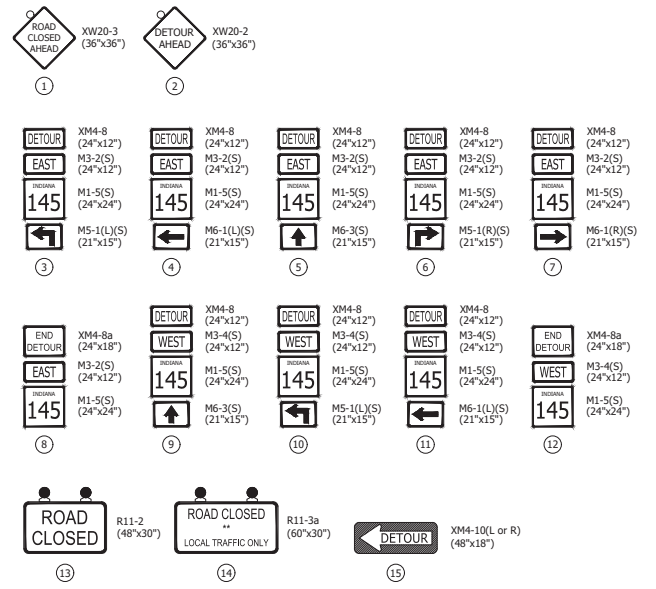

TYPICAL ROAD CLOSURE AT SLIDE CORRECTION
SCALE: NOT TO SCALE

M.O.T. QUANTITIES

| | | |
|------------------------------|----|------|
| MAINTAINING TRAFFIC | 0 | LSUM |
| CONSTRUCTION SIGN, A | 0 | EACH |
| CONSTRUCTION SIGN, B | 0 | EACH |
| ROAD CLOSURE SIGN ASSEMBLY | 0 | EACH |
| DETOUR ROUTE MARKER ASSEMBLY | 0 | EACH |
| TYPE III-A BARRICADE | 00 | LFT |
| TYPE III-B BARRICADE | 00 | LFT |

NOTES:

- CONTRACTOR SHALL MAINTAIN AND PROTECT VEHICULAR TRAFFIC DURING ALL OPERATIONS. VEHICULAR ACCESS TO PUBLIC/PRIVATE DRIVEWAYS SHOULD BE MAINTAINED AT ALL TIMES.
- CONTRACTOR SHALL COMPLY WITH THE LATEST EDITION OF "INDIANA MANUAL ON UNIFORM TRAFFIC CONTROL DEVICES FOR STREETS AND HIGHWAYS" DURING WORK OPERATIONS AND FOR THE DURATION OF THE PROJECT.
- THE CONTRACTOR SHOULD REFER TO INDOT STANDARDS AND THE "INDIANA MANUAL FOR UNIFORM TRAFFIC CONTROL DEVICES FOR STREETS AND HIGHWAYS" TO PROVIDE SAFE AND EFFICIENT TEMPORARY TRAFFIC CONTROL.
- THE CONTRACTOR SHALL BE RESPONSIBLE TO COORDINATE WITH ANY ADJACENT OR OVERLAPPING PROJECTS AND CHECK COMPATIBILITY OF TRAFFIC CONTROL.
- THE CONTRACTOR SHALL BE RESPONSIBLE FOR NOTIFYING LOCAL EMERGENCY PERSONNEL, SCHOOLS, AND LOCAL AND COUNTY OFFICIALS OF ANY CHANGES TO THE TRAFFIC PATTERNS THROUGHOUT THE LENGTH OF THE PROJECT.

LEGEND

| | | | |
|--|---|--|---------------------|
| | CONSTRUCTION SIGN W/TYPE "A" LIGHT | | DIRECTION OF DETOUR |
| | CONSTRUCTION SIGN | | |
| | BARRICADE TYPE III-A OR TYPE III-B AS NOTED | | |
| | DETOUR ROUTE | | |

Preliminary

| | | |
|--------------------------|-----------------|------|
| RECOMMENDED FOR APPROVAL | DESIGN ENGINEER | DATE |
| DESIGNED: EA | DRAWN: EA | |
| CHECKED: MH | CHECKED: MH | |

INDIANA
DEPARTMENT OF TRANSPORTATION

MAINTENANCE OF TRAFFIC DETAILS

| | |
|------------------|-------------|
| HORIZONTAL SCALE | BRIDGE FILE |
| AS NOTED | N/A |
| VERTICAL SCALE | DESIGNATION |
| N/A | 1800163 |
| SURVEY BOOK | SHEETS |
| | 7 of 19 |
| CONTRACT | PROJECT |
| R-41452 | 1800163 |

